

TOPENS CASAR800

TOPENS CASAR800 Garage Door Opener Instruction Manual

Model: CASAR800

1. INTRODUCTION

This manual provides detailed instructions for the installation, operation, and maintenance of your TOPENS CASAR800 garage door opener. Please read this manual thoroughly before installation and use to ensure proper function and safety.

Important Notes:

- The CASAR800 garage door opener operates **ONLY** on AC 220-240V electricity. It does **NOT** support battery backup.
- This opener is designed for use with horizontal tracks only (not vertical). For canopy doors, an **EXTRA** Chamberlain bow arm is required (not included).
- Smartphone/mobile phone control is not supported with this traditional design.
- The integrated safety light activates automatically during operation. It will turn off automatically if no remote or push button is pressed within 3 minutes.

2. SAFETY INSTRUCTIONS

Always prioritize safety during installation, operation, and maintenance of the garage door opener. Failure to follow these instructions may result in serious injury or property damage.

General Safety:

- Read and understand all instructions before installation and use.
- Keep the garage door area clear of people and objects while the door is in motion.
- Do not allow children or pets to play with or near the garage door opener or its controls.
- Ensure the garage door is balanced and in good working condition before installing the opener.
- Disconnect power to the opener before performing any maintenance or repairs.

Electrical Safety:

- The unit requires AC 220-240V/50Hz power. Ensure your electrical supply matches these requirements.
- All electrical connections must comply with local codes and regulations.
- If you are unsure about electrical wiring, consult a qualified electrician.

3. PACKAGE CONTENTS

Verify that all components listed below are present in your package. If any items are missing or damaged, please contact TOPENS customer support.

- 1 x Garage Door Opener with 1.5m Power Cable
- 2 x M12 Remote Control Transmitters
- 4 x 0.75m Rail Sections
- 3 x Connection Sleeves
- 1 x 6m Chain
- 1 x Manual Release Rope & Handle
- 1 x Full Set of Required Installation Hardware
- 1 x English User Manual

Dimensions

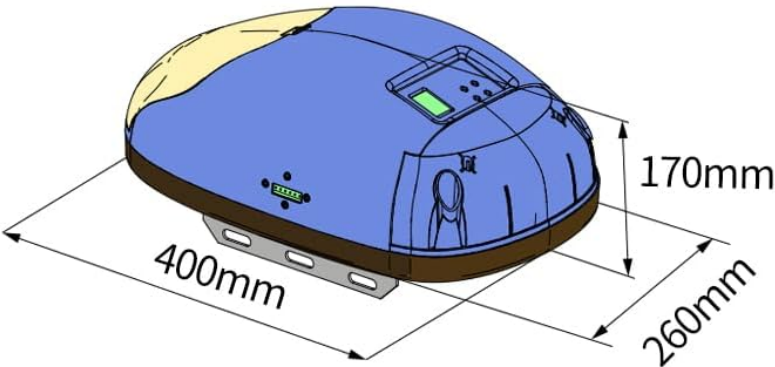

Parts List

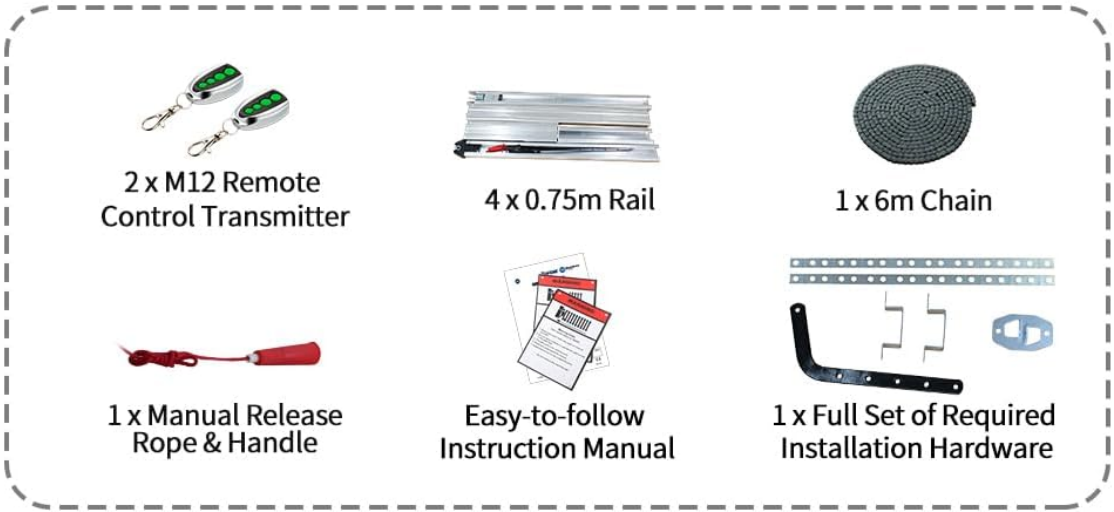

Figure 3.1: The image displays the TOPENS CASAR800 garage door opener unit, two M12 remote controls, four 0.75m rail sections, a 6m chain, a manual release rope and handle, and a full set of installation hardware. This illustrates the complete package contents.

4. SPECIFICATIONS

The following table outlines the technical specifications for the TOPENS CASAR800 garage door opener:

Specification	Value
Product Model	CASAR800 Garage Door Opener
Pulling Force	800N
Input Voltage	AC 220-240V/50Hz
Motor Voltage	DC 24V

Specification	Value
Rated Power	120W
Standby Power	3W
Max. Door Height	2.3m
Max. Door Area	12 m ²
Required Headroom	30mm
Door Moving Speed	120 mm/s
Open/Close Time	Approx. 16 seconds
Remote Control Range	20m
Frequency	433.92 MHz (Rolling Code)
Max. Remotes Supported	8 pcs (up to 250 pcs with external ERM12 receiver, sold separately)
Working Temperature	-30°C to +60°C
Noise Level	<60 dB
Light Power	230V, 15W
Motor Dimensions	400 x 260 x 170 mm
Product Weight	13.64 kg
Material	Alloy Steel
UPC	703063918861



Figure 4.1: The main unit of the TOPENS CASAR800 garage door opener, showcasing its compact design and blue and white casing.

5. INSTALLATION

The CASAR800 is designed for DIY-friendly installation. Refer to the included user manual for detailed, step-by-step instructions and diagrams. The following provides an overview of compatible door types and key considerations.

Compatible Door Types:

- **One-piece door with horizontal track:** The opener can be directly used.
- **Sectional door with curved track:** The opener can be directly used.
- **One-piece door without track (jamb hardware) or one-piece door without track (pivot hardware):** An additional Bow Arm needs to be purchased to function properly.

Key Installation Points:

- Ensure a minimum headroom clearance of 30mm above the highest point of travel for the door.
- The opener is suitable for garage doors up to a maximum height of 2.3 meters.
- The robust chain drive system and reinforced steel rail ensure durable operation. The solid sleeve connection rail system eliminates the need for additional welding.

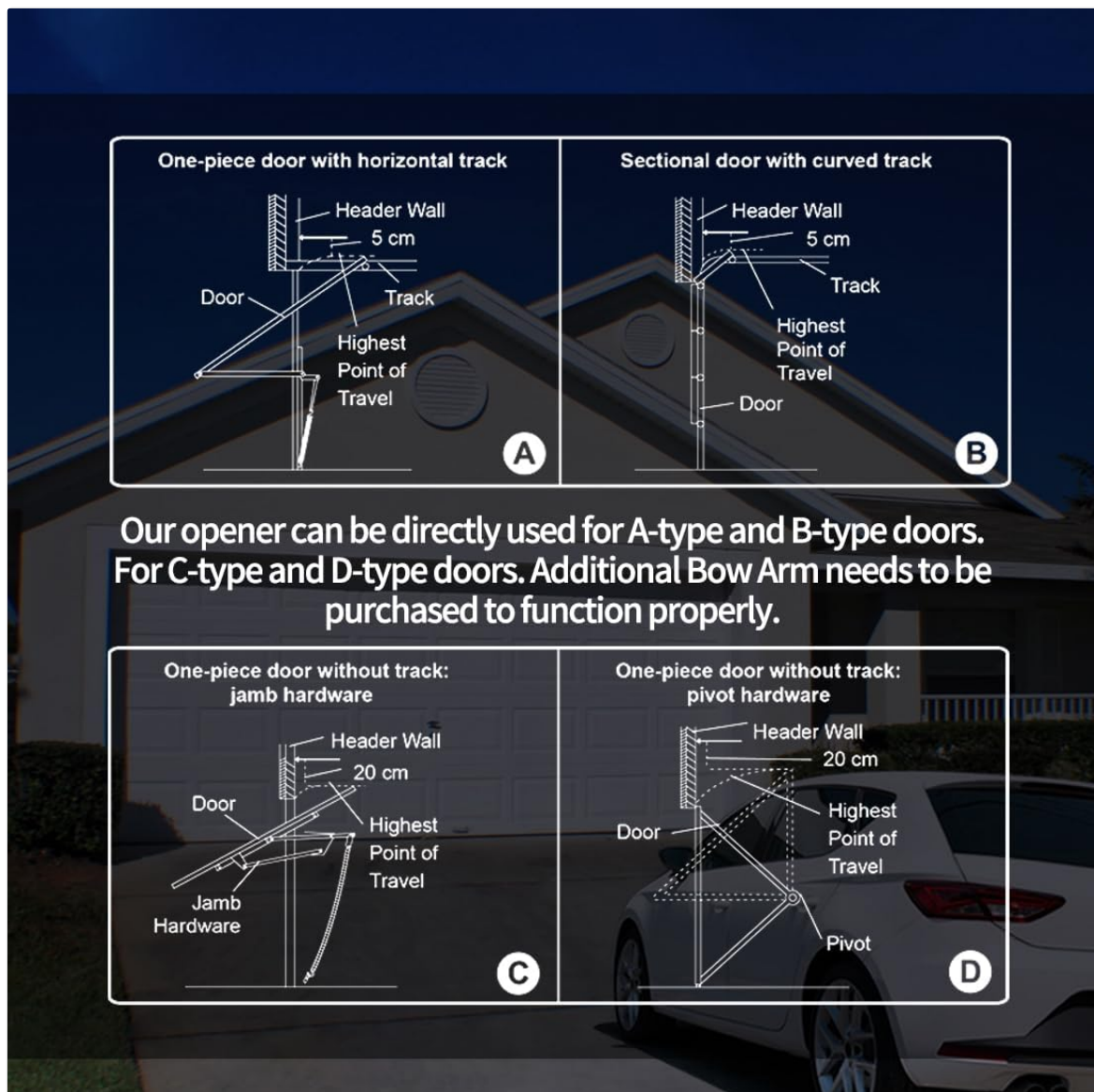

Figure 5.1: This image displays diagrams of various garage door configurations, including one-piece doors with horizontal tracks, sectional doors with curved tracks, and one-piece doors requiring jamb or pivot hardware, indicating compatibility and additional accessory needs.

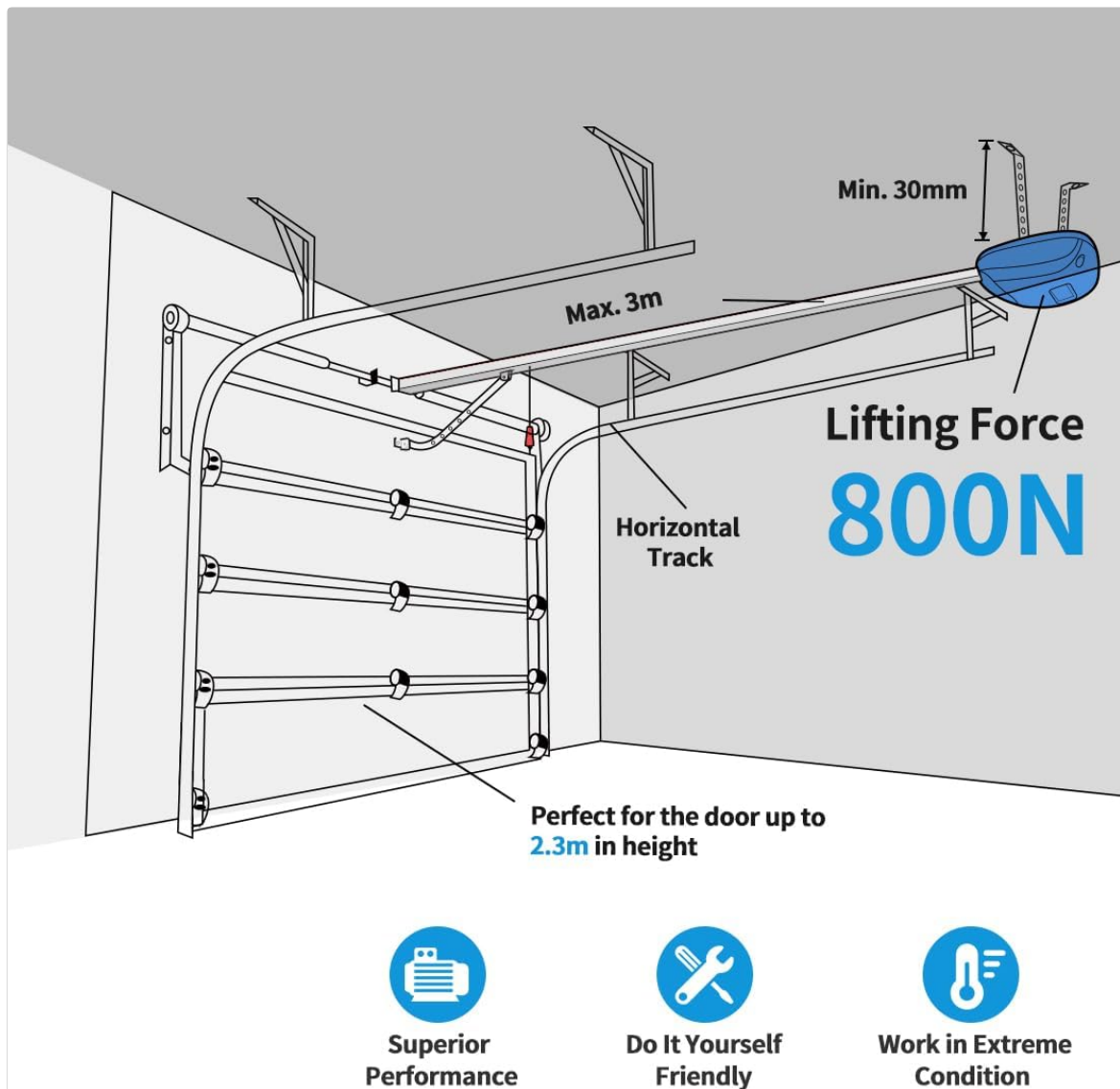

Figure 5.2: An installation diagram illustrating the garage door opener mounted above a garage door, highlighting the 800N lifting force, suitability for doors up to 2.3m in height, and the minimum 30mm clearance requirement.

6. OPERATION

The CASAR800 garage door opener offers quiet, smooth, and reliable operation with several user-friendly features.

Basic Operation:

- Press a button on the remote control to open or close the garage door.
- The opener features a soft start and soft stop mechanism for smoother operation and extended motor life.
- An integrated digital display guides you through all setting steps.

Remote Control:

- The included 4-button remote controls are pre-programmed and can control up to 4 separate garage door openers.
- The system uses rolling code technology to prevent unauthorized access.

Safety and Convenience Features:

- **Electronic Travel Limit:** Easily adjusted to automatically remember open/close positions.
- **Obstruction Detection:** The garage door automatically reverses if an obstruction is detected while closing.
- **Adjustable Auto-Close Time:** Set the door to automatically close after 1 to 9 minutes.
- **Adjustable Open/Close Force:** Customize the force settings for optimal performance.
- **Automatic Lock:** The door automatically locks during a power cut.
- **Manual Release:** In case of power failure or lost remote, use the manual release cord and handle to operate the door manually.

Compatible Accessories

Available at TOPENS Online Store



TC196 Tuya WiFi Remote Control



TC188 Universal Keypad



TC175P Wired Keypad



TKP3 Wireless Keypad



TRF3 Reflection Photocell Sensor



TC102 Photo Eye Beam Sensor



M12 Remote Control Transmitter



ERM12 Universal External Receiver



TC147 Wired Push Button



TC148 Waterproof Wired Push Button



TC173 Wireless Push Button



CKMJ2A Control Panel

Figure 6.1: This image depicts a person using a remote control from inside a car to operate a garage door, emphasizing the quiet, smooth, and reliable operation of the opener.

TIME TO EXPECT MORE FROM YOUR GARAGE DOOR

DC Motor

Traditional DC motor provides quieter and safer operations compared with AC motors of other brands.

Long-lasting Performance

Soft start & soft stop technology allows for longer motor life.

Multiple Protection

Reliable electronic limit with travel memory is easy to adjust.



Figure 6.2: A diagram illustrating the internal components of the garage door opener, highlighting the DC motor for quieter and safer operations, soft start/stop technology for longer motor life, and reliable electronic limits for multiple protection.

7. MAINTENANCE

Regular maintenance ensures the longevity and safe operation of your TOPENS CASAR800 garage door opener.

Monthly Checks:

- Inspect the garage door for proper balance. If the door is unbalanced, contact a professional for adjustment.
- Check the chain tension. Adjust if too loose or too tight according to the detailed instructions in the full user manual.
- Ensure all mounting hardware is secure. Tighten any loose bolts or screws.
- Test the obstruction detection feature by placing an object in the door's path while it is closing. The door should reverse.

Cleaning:

- Keep the opener unit and tracks clean from dust and debris.
- Do not use harsh chemicals or abrasive cleaners on any part of the opener.

8. TROUBLESHOOTING

This section addresses common issues you might encounter with your CASAR800 garage door opener. For more detailed troubleshooting steps, refer to the comprehensive user manual.

Common Issues and Solutions:

- **Opener not responding to remote:**
 - Check remote battery.
 - Ensure the remote is within the operating range (20m).
 - Reprogram the remote control if necessary (refer to manual for programming steps).
- **Door does not close completely or reverses:**
 - Check for obstructions in the door's path.
 - Verify that the electronic travel limits are set correctly.
 - Adjust the closing force if the door is encountering resistance.
- **Light does not turn on/off:**
 - Check the light bulb.
 - Ensure the unit is receiving power.
- **Unusual noises during operation:**
 - Inspect the chain and tracks for debris or misalignment.
 - Lubricate moving parts as recommended in the full manual.

If these basic troubleshooting steps do not resolve the issue, please consult the detailed troubleshooting guide in your user manual or contact TOPENS customer support.

9. WARRANTY AND SUPPORT

TOPENS is committed to providing high-quality products and excellent customer service.

Warranty Information:

- The TOPENS CASAR800 garage door opener comes with a 12-month warranty from the date of purchase.
- We offer a 30-day hassle-free exchange and return policy.

Technical Support:

- Lifetime technical support is available for all TOPENS products.
- For further assistance, detailed user manuals, installation videos, or personalized support, please

visit the official TOPENS website.

- If you have any questions or require professional assistance, our specialists are ready to help you find a timely solution.

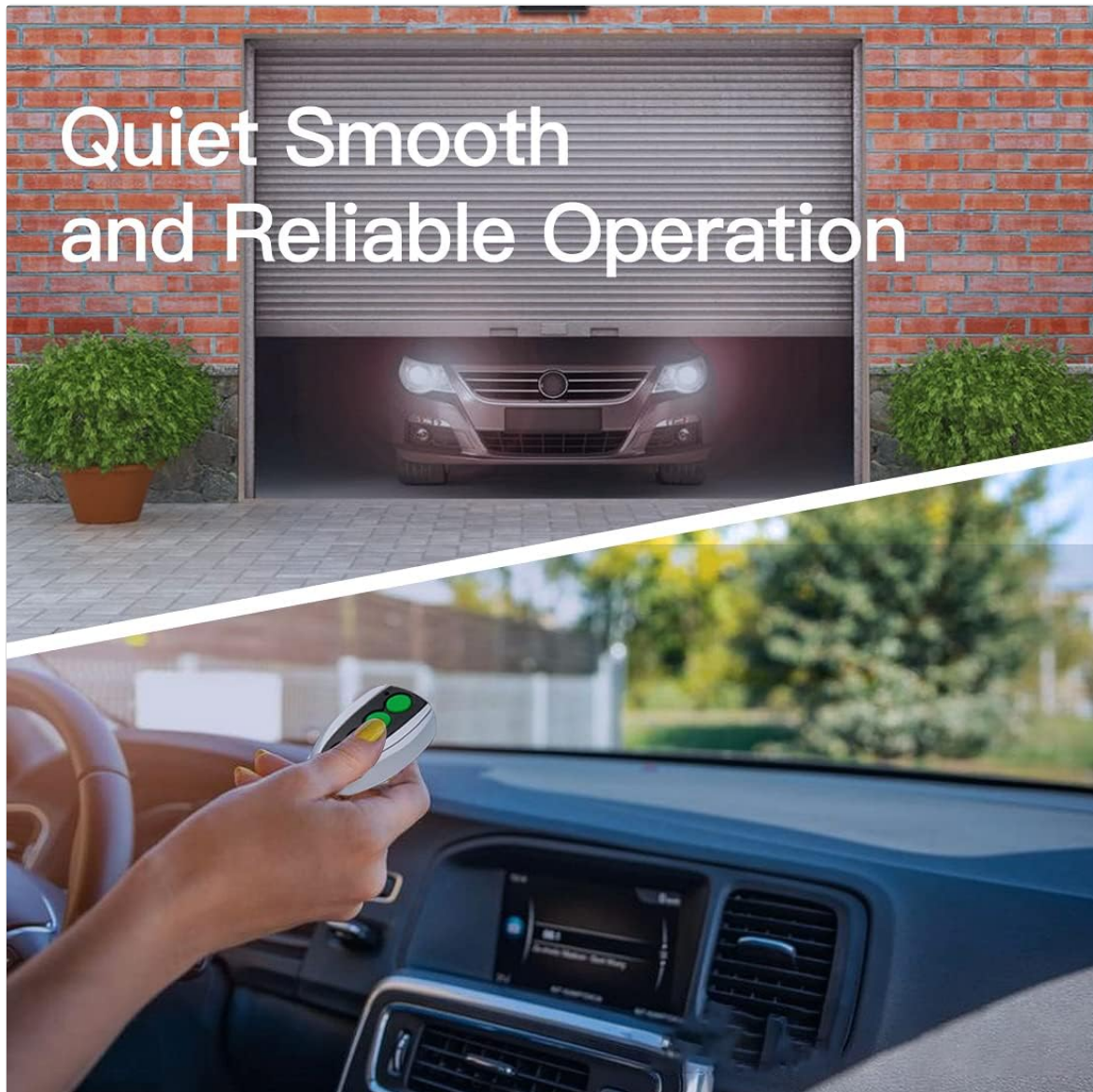

Figure 9.1: An image representing customer support, featuring an email icon and text, indicating available assistance for users.