

Itomoro AML017

Itomoro Baby Car Mirror Instruction Manual

MODEL: AML017

1. PRODUCT OVERVIEW

The Itomoro Baby Car Mirror is designed to provide parents with a clear and safe way to monitor their infant in a rear-facing car seat without needing to turn around while driving. Featuring a wide 149° viewing angle and 360° camera rotation, it ensures optimal visibility. The upgraded night vision function allows for clear viewing even in low-light conditions. Its plug-and-play design makes installation straightforward, enhancing vehicle safety and providing peace of mind.



Figure 1.1: Itomoro Baby Car Mirror system, showing the display and camera unit.

Traditional Baby Car Mirror

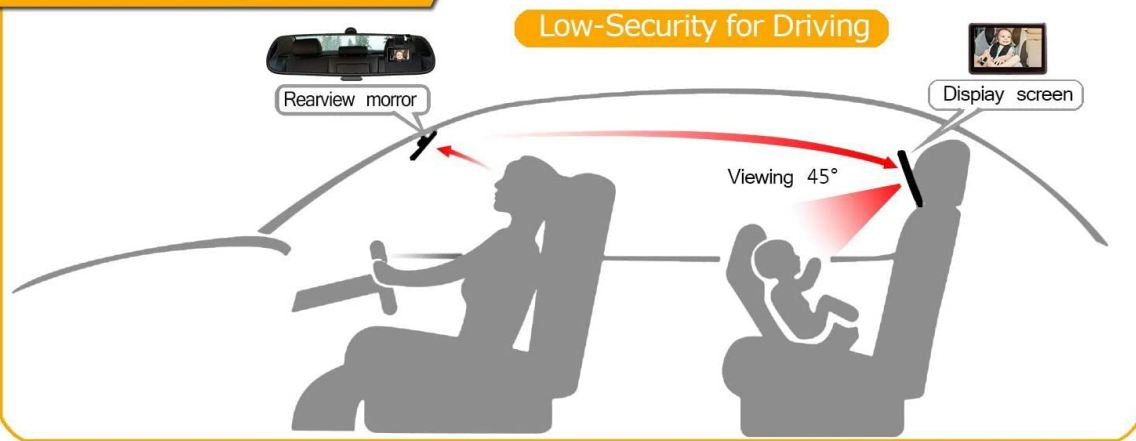

Itomoro baby car camera

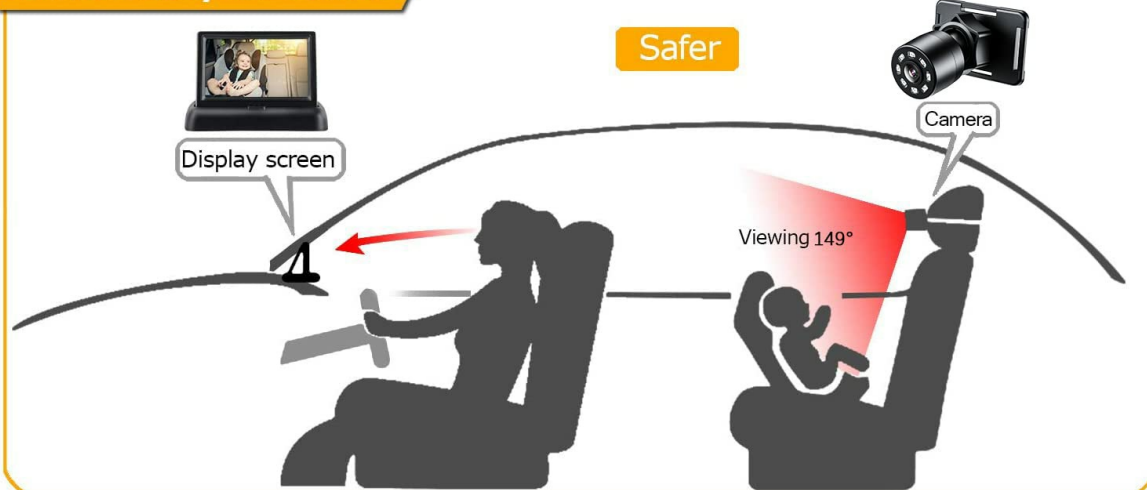

Figure 1.2: Comparison illustrating the wider and safer viewing angle provided by the Itomoro camera system compared to a traditional rearview mirror.

2. WHAT'S IN THE BOX

- Camera unit
- Display monitor
- Power cable with cigarette lighter adapter
- Video cable
- Mounting straps/accessories

3. SETUP AND INSTALLATION

Follow these steps for proper installation of your Itomoro Baby Car Mirror system:

1. **Install the Camera:** Secure the camera unit to the headrest of the rear seat using the provided straps. Ensure it is firmly attached and positioned to capture your baby in the rear-facing car seat.

The camera can be adjusted 360° for the optimal angle.

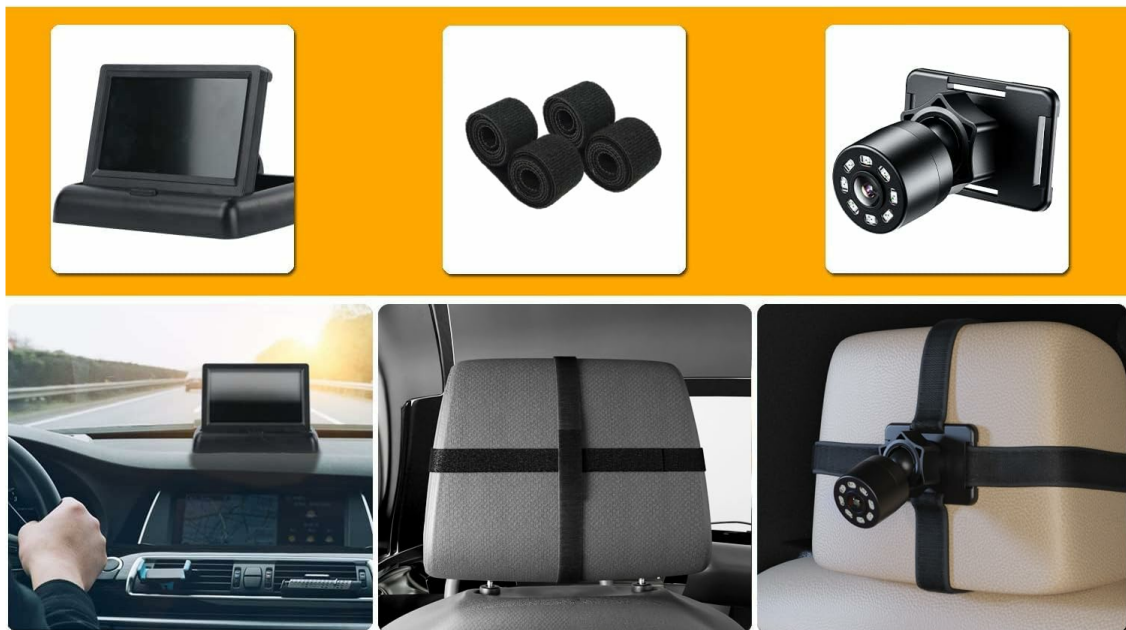
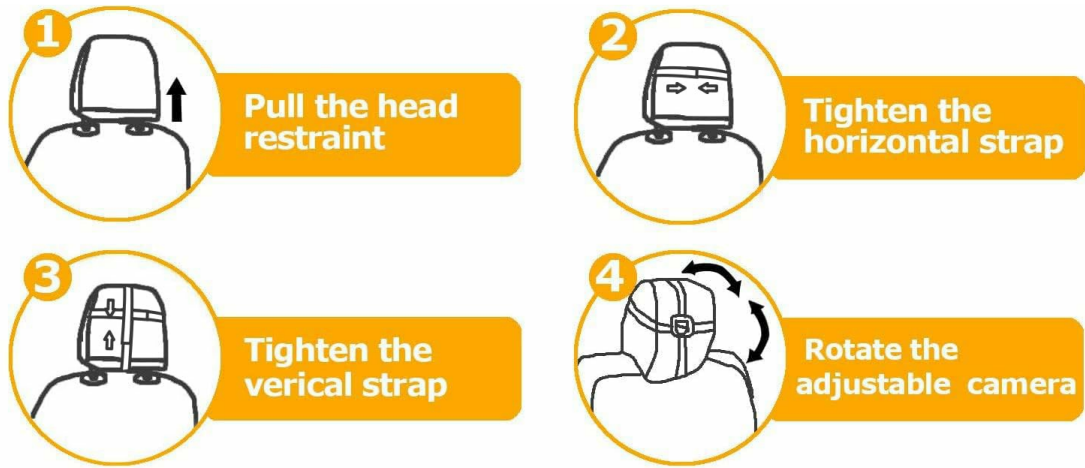

Figure 3.1: Detailed steps for securing the camera to the headrest.

- 2. Position the Display Monitor:** Place the display monitor on the center console or dashboard of your car. The monitor is designed to sit stably and provide a clear view without obstructing your driving.



Figure 3.2: The display monitor positioned on the center console for easy viewing.

3. **Connect the Cables:** Connect the camera to the display monitor using the video cable. Then, connect the power cable from the display monitor to your car's cigarette lighter socket.



Figure 3.3: Wiring connections for the system.

4. **Power On:** Once connected, the monitor will automatically turn on and switch to the rear seat view.

Video 3.1: Demonstration of the installation process for the Itomoro Baby Car Camera.

4. OPERATING INSTRUCTIONS

The Itomoro Baby Car Mirror system is designed for simple operation:

- **Automatic Activation:** The monitor automatically powers on and displays the camera feed when connected to the car's power supply.
- **Adjusting View:** The camera can be manually rotated 360° to achieve the desired viewing angle of your child. The wide 149° angle ensures comprehensive coverage.
- **Night Vision:** The system features an upgraded night vision function, providing clear and bright images of your child even when driving at night. This eliminates the need for additional lighting.
- **Monitor Control:** The display monitor has a button to easily open and close the screen, allowing you to hide it when not in use.

Video 4.1: Overview of the baby car camera in operation, showing clear daytime and nighttime views.

5. KEY FEATURES

- **Enhanced Safety & Durability:** Designed to be placed on the center console, increasing vehicle safety by eliminating the need to look back. The camera remains stable during driving, preventing vibrations and shakes.
- **Upgraded Night Vision:** Provides a clear and bright display even in dark conditions, allowing parents to monitor their child's status at night without worry.
- **Perfect Vision with Wide Angle:** The camera offers a 360° rotation and an expanded 149° wide-angle view, ensuring a complete and distortion-free image of your baby.
- **Easy Installation:** No assembly required. The camera straps easily to the headrest, and the monitor activates automatically upon power connection.

6. TROUBLESHOOTING

If you encounter any issues with your Itomoro Baby Car Mirror, please refer to the following common solutions:

- **No Image on Display:**
 - Ensure all cables (power and video) are securely connected.
 - Verify the cigarette lighter socket is providing power.
- **Fuzzy or Distorted Image:**
 - Check that the camera lens is clean and free from obstructions.
 - Adjust the camera angle to ensure it is properly focused on your child.
- **Monitor Not Turning On:**
 - Confirm the power cable is fully inserted into the cigarette lighter.
 - Test the cigarette lighter with another device to ensure it is functional.

For further assistance, please contact Itomoro customer support.

7. PRODUCT SPECIFICATIONS

Specification	Detail
Brand	Itomoro
Model Number	AML017

Item Dimensions (L x W x H)	8.46 x 5.9 x 3.74 inches
Item Weight	15.8 ounces
Auto Part Position	Center
Mounting Type	Seat Belt
Special Feature	HD Resolution, Night Vision
Screen Display Size	4.3 Inches
Lens Curvature Description	Convex
Power Source	AC/DC (via cigarette lighter)
Included Components	Camera, Display
UPC	016071446180

8. WARRANTY AND SUPPORT

Itomoro products are designed for reliability and customer satisfaction. For any questions, technical support, or warranty inquiries regarding your Baby Car Mirror, please contact Itomoro customer service through their official channels. Please refer to the product packaging or official Itomoro website for the most up-to-date contact information and warranty details.

We are committed to providing high-quality products and support to ensure your baby's safety and your peace of mind.