

## Nixplay W10F

# Nixplay Smart Digital Picture Frame User Manual

Model: W10F | Brand: Nixplay

## 1. INTRODUCTION

The Nixplay Smart Digital Picture Frame is designed to keep you connected with your loved ones by allowing you to easily share photos and videos from anywhere in the world. This 10.1-inch WiFi-enabled frame offers a vibrant display for your cherished memories, supporting shared family playlists and content preloading for gifting. It's recognized as a leader in digital picture frame design and software innovation, connecting millions of families globally.



Figure 1: The Nixplay Smart Digital Picture Frame, showcasing its sleek design and the flexible stand that allows for both portrait and landscape orientation.

## 2. SETUP GUIDE

Setting up your Nixplay Smart Digital Picture Frame is a straightforward process designed for ease of use. Follow these simple steps to get your frame up and running quickly:

1. **Download the Nixplay App:** Begin by downloading the Nixplay app on your iOS or Android smartphone. The app provides full control over your frame.
2. **Plug In the Frame:** Connect the power adapter to your frame and plug it into a power outlet. The frame will power on automatically.
3. **Follow On-Screen Instructions:** The frame's display will guide you through connecting to your WiFi network and linking it to your Nixplay account created via the app.
4. **Invite Family and Friends:** Once connected, you can invite multiple users to upload photos and videos to your frame, fostering a shared family experience.

# Effortless Setup & Sharing

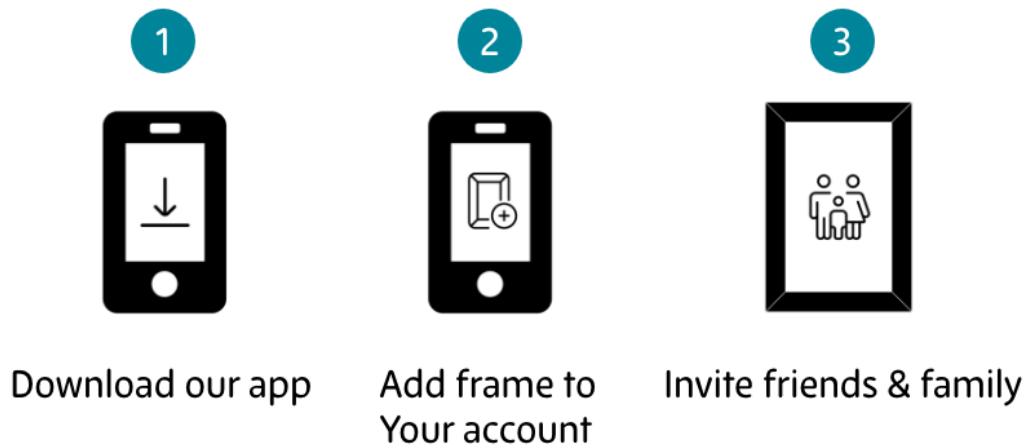

Figure 2: The three simple steps for effortless setup and sharing with your Nixplay frame.

## Setup Video Tutorial

Your browser does not support the video tag.

Video 1: Official guide on how to set up your Nixplay Smart Photo Frame, provided by Creedon Technologies USA LLC.

## 3. OPERATING INSTRUCTIONS

The Nixplay frame offers a variety of features to enhance your photo and video viewing experience. Manage your content and frame settings directly from the Nixplay mobile app or through the web interface.

### Adding and Sharing Content

Easily connect and transfer photos and videos from various sources such as Apple Photos, Facebook, Instagram, and Google Photos (subscription may be required for Google Photos). You can also email photos directly to the frame. The app allows you to send unique photos or playlists to separate frames, perfect for sharing with different family members.

# Share & Connect From Anywhere in the World

Have full control of your frame from your smartphone with the Nixplay app.



Figure 3: The Nixplay mobile app allows you to share and connect from anywhere in the world, managing your photo and video playlists.

## Smart Features

- **AI-Enhanced Display:** Experience perfectly centered images with AI-driven smart-centering. The frame also features automatic rotation, seamlessly switching between landscape and portrait modes for dynamic content display.
- **Motion Sensor:** The smart motion sensor automatically turns the frame on or off when you enter or leave the room, conserving energy and ensuring your memories are displayed when you're present.
- **NixCast:** Effortlessly cast photos and videos from your Nixplay app to your smart TV.
- **NixEvents:** This feature allows guests at events to easily contribute their photos to a shared album, creating real-time slideshows.

## niX-Smart Face Framing Intelligent A.I.

Puts faces center-frame.

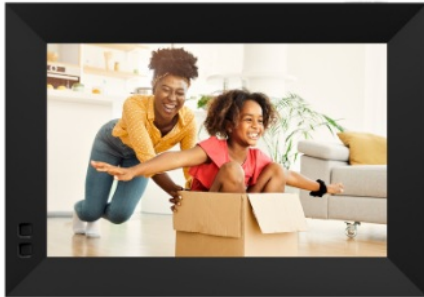

## niX-SenseMe Smart Sensor

Detects when you're in the room.  
Conveniently turns on/off.



Figure 4: The Nixplay frame features intelligent AI for face framing and a smart motion sensor for convenient power management.

### Audio and Design

The frame boasts a sophisticated design with built-in stereo speakers, making it ideal for video playback. Its sleek profile and black finish allow it to blend seamlessly with any home decor.

# Sophisticated Design with Stereo Speakers

Ideal for video playback.



Figure 5: The sophisticated design of the Nixplay frame includes integrated stereo speakers for enhanced video playback.

## 4. MAINTENANCE

To ensure the longevity and optimal performance of your Nixplay Smart Digital Picture Frame, regular maintenance is recommended:

- **Cleaning the Screen:** Use a soft, lint-free cloth to gently wipe the screen. For stubborn smudges, slightly dampen the cloth with water or a screen-safe cleaner. Avoid abrasive materials or harsh chemicals.
- **Cleaning the Frame:** Wipe the frame's exterior with a dry, soft cloth.
- **Dusting:** Regularly dust the frame and its surroundings to prevent dust buildup in vents or around connections.

- **Placement:** Place the frame in a location away from direct sunlight, extreme temperatures, and high humidity to prevent damage to the display and internal components.

## 5. TROUBLESHOOTING

If you encounter any issues with your Nixplay Smart Digital Picture Frame, try the following troubleshooting steps:

- **Frame Not Turning On:** Ensure the power adapter is securely connected to both the frame and a working power outlet. Try a different outlet if necessary.
- **No Display/Blank Screen:** Check if the motion sensor is enabled and if there is movement in the room. If the frame is set to a sleep schedule, verify the current time. A simple restart by unplugging and re-plugging the power adapter can often resolve display issues.
- **Cannot Connect to WiFi:** Verify your WiFi password. Ensure the frame is within range of your router. Try restarting your router and the frame. If issues persist, check the Nixplay app for network diagnostic tools.
- **Photos Not Appearing:** Confirm that photos have been successfully uploaded to your playlists in the Nixplay app. Check your internet connection. Ensure the correct playlist is selected for display on the frame.
- **Poor Image Quality:** Ensure the uploaded photos are of high resolution. The frame's AI-enhanced features optimize display, but low-resolution source images will appear pixelated.

For further assistance, please refer to the Warranty and Support section.

## 6. SPECIFICATIONS

Feature	Detail
Product Dimensions	7.36 x 1.22 x 0.99 inches
Item Weight	1.3 pounds
Item Model Number	W10F
Batteries	1 Lithium Metal batteries required (included)
Manufacturer	Nixplay
Language Support	English, French, German, Japanese
Color	Black
Resolution	1280x800
Compatible Devices	Personal Computer, Tablet, Smartphone



Feature	Detail
Screen Size	10.1 Inches

## 7. WARRANTY AND SUPPORT

Your Nixplay Smart Digital Picture Frame comes with a**One-Year Warranty** covering parts and labor, ensuring peace of mind with your purchase.

Nixplay is committed to providing excellent customer support. If you have any questions, need assistance with setup, or encounter any issues, you can reach out for direct customer support.

- **Online Support:** Visit the Nixplay support website for FAQs, troubleshooting guides, and live chat options.
- **Email Support:** Send your inquiries via email for detailed assistance.

Nixplay prioritizes your privacy and data security. All cloud storage is located in the USA on secure, CCPA & GDPR-compliant, encrypted servers, ensuring your photos and memories are kept safe and secure.



# Private Network with Secure Storage

Your content is safely stored on encrypted, private servers based in the U.S.A (AES 2560bit encryption).



CCPA  
Compliant



GDPR  
Compliant



Figure 6: Nixplay ensures a private network with secure storage for all your content, adhering to strict data protection standards.





## Related Documents - W10F



Universal Nixplay  
WiFi Cloud Frame  
User Guide  
nixplay

### [Nixplay WiFi Cloud Frame User Guide: Setup, Features, and Support](#)

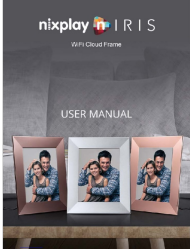
Comprehensive guide to the Universal Nixplay WiFi Cloud Frame. Learn setup, photo management, cloud sharing, mobile app usage, frame settings, and troubleshooting. Connect with family and friends.

	<p><a href="#">Nixplay W15F Wifi Digital Photo Frame User Guide</a></p> <p>A comprehensive guide to setting up, using, and troubleshooting your Nixplay W15F Wifi Digital Photo Frame. Learn about the remote control, Wi-Fi connection, account creation, wall mounting, and photo sharing features.</p>
	<p><a href="#">Nixplay Smart Photo Frame: Quick Start Guide and Setup</a></p> <p>Comprehensive guide to setting up and using your Nixplay Smart Photo Frame, including remote control functions, wall mounting, app connection, and app features.</p>
	<p><a href="#">Nixplay Iris WiFi Cloud Frame User Manual</a></p> <p>Comprehensive user manual for the Nixplay Iris WiFi Cloud Frame, covering setup, photo management, playlists, settings, and important safety information.</p>
	<p><a href="#">Nixplay Cloud Frame User Manual: Setup, Features, and Operation</a></p> <p>Comprehensive user manual for the Nixplay Cloud Frame, guiding users through setup, connecting to WiFi, managing photos and slideshows via Nixplay account, utilizing USB/SD card input, adjusting frame settings, and important safety information.</p>
	<p><a href="#">Nixplay W13D-06 Wifi Digital Photo Frame User Guide</a></p> <p>A comprehensive guide to setting up, using, and mounting your Nixplay W13D-06 Wifi Digital Photo Frame, including remote control operation and account creation.</p>