

## KuWiFi CPF905

# KuWiFi CPF905 4G LTE Outdoor Router

## Instruction Manual

### 1. PRODUCT OVERVIEW

The KuWiFi CPF905 is an outdoor 4G LTE CPE router designed to provide internet access via UMTS/HSPA/LTE networks. It offers both indoor and outdoor WiFi coverage and supports surveillance camera projects. This router converts a 4G cellular signal into a WiFi hotspot, making it suitable for various environments including homes, offices, factories, warehouses, gardens, and parking lots.

Key features include a CAT4 LTE module for speeds up to 150 Mbps, IP66 waterproof rating for the main unit, dual high-gain external antennas (one for 4G, one for WiFi), and a wireless transmission speed of 300 Mbps. It supports various Ethernet modes and WPA2-PSK security protocol.

# KuWfi

WiFi 4G



Figure 1: Front view of the KuWFi CPF905 4G LTE Outdoor Router with antennas.

## 2. PACKAGE CONTENTS

Verify that all items are present in your package:

- KuWFi CPF905 Router (x1)
- External Antennas (x2)
- DC Power Adapter (x1)
- Ethernet Cable (x1)
- User Manual (x1)

# KuWfi



Figure 2: Contents of the KuWFi CPF905 product package.

## 3. SETUP GUIDE

### 3.1 SIM Card Installation

1. Ensure the router is powered off.
2. Locate the SIM card slot on the device. This is typically found under a protective cover on the underside or side of the router.
3. Before inserting, ensure your Micro SIM card's PIN code is disabled. This can usually be done using a mobile phone. The router does not support virtual SIMs or IoT SIMs.
4. Insert the Micro SIM card into the slot until it clicks into place. Refer to the diagram for correct orientation.
5. Close the protective cover securely.



Figure 3: DC power, Micro USB port, SIM slot, WAN/LAN port, and Reset button on the router.

### 3.2 Antenna Connection

Screw the two external antennas firmly into their designated ports on the router. One antenna is for 4G signal reception, and the other is for WiFi signal transmission. Ensure they are securely attached for optimal performance.

### 3.3 Power Connection

Connect the provided DC power adapter to the router's DC power input port and then plug it into a standard electrical outlet. The router can also be powered via its Micro USB port using a 12V power bank for outdoor or remote use.

### 3.4 Initial Access and Configuration

1. Power on the router. Wait for the indicator lights to stabilize.
2. Connect your computer or mobile device to the router's WiFi network. The default WiFi name (SSID) and password are usually printed on a label on the router itself. Alternatively, connect your computer to the router via an Ethernet cable.

3. Open a web browser and enter the default IP address for the router's web interface. This is typically **192.168.199.1**. The default login password is often **admin**.
4. Once logged in, navigate to the **Network Settings** section, then select **APN**.
5. Configure the correct APN settings for your SIM card's mobile operator. If you are unsure of the APN details, contact your service provider. Save the settings and restart the router for changes to take effect.

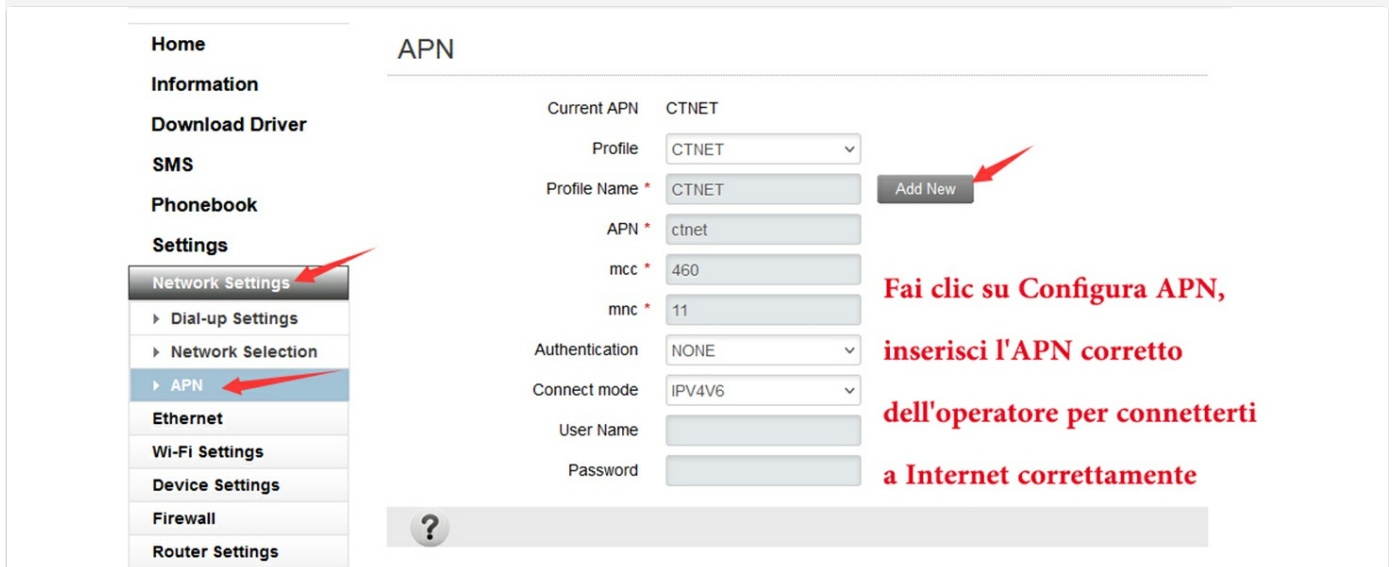

Figure 4: Web interface for APN configuration. Ensure correct APN details are entered for your SIM card.

## 4. OPERATING INSTRUCTIONS

### 4.1 Connecting Devices

After successful setup, your router will broadcast a WiFi signal. You can connect up to 10 devices simultaneously via WiFi. For wired connections, use the WAN/LAN Ethernet port.

### 4.2 Signal Indicators

The router features LED indicators that display the signal strength, WiFi connection status, and internet availability. Observe these indicators to ensure proper operation and optimal signal placement.

### 4.3 Network Bands Supported

The CPF905 is compatible with a wide range of 4G network bands. Before purchasing a SIM card, verify that its frequency bands are compatible with the router:

- **FDD-LTE:** B1, B3, B5, B7, B8, B20
- **TDD-LTE:** B38, B39, B40, B41
- **WCDMA:** B1, B5, B8
- **EVDO:** BC0
- **GSM:** 900/1800 MHz

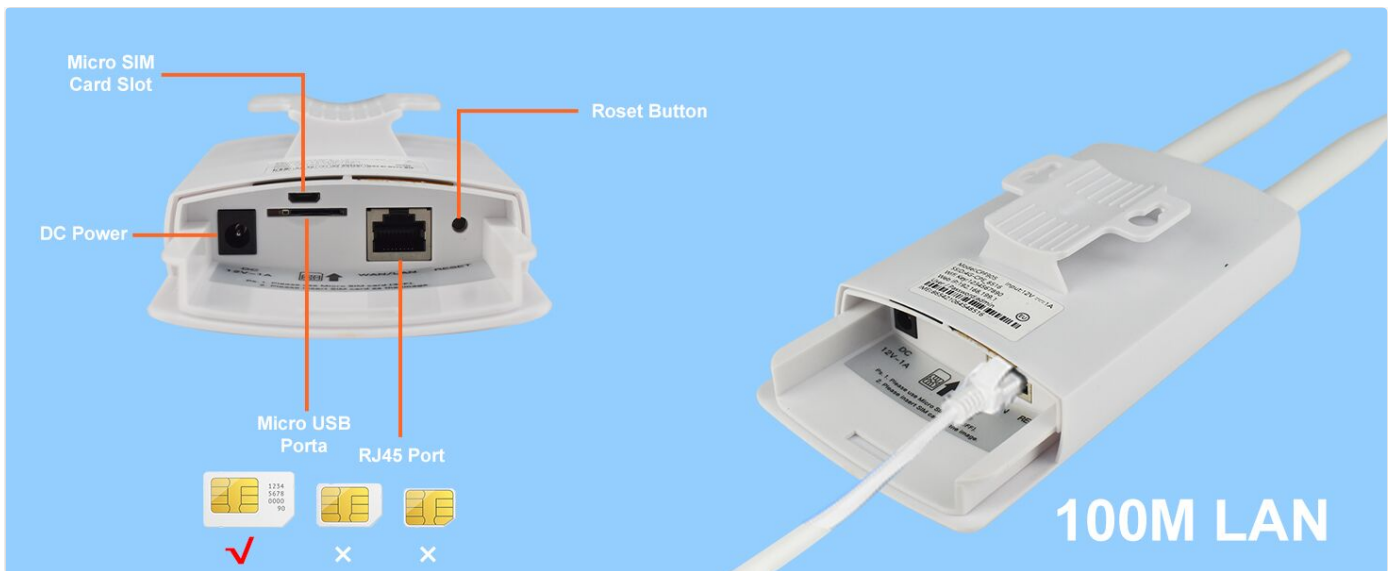

Figure 5: The router supports connection for multiple devices simultaneously.

## 5. MAINTENANCE

### 5.1 Cleaning

To maintain optimal performance, periodically clean the exterior of the router with a soft, dry cloth. Avoid using liquid cleaners or abrasive materials.

### 5.2 Environmental Considerations

While the router unit itself has an IP66 waterproof rating, the power adapter is not designed for outdoor exposure. Ensure the power adapter is protected from rain, snow, and direct sunlight. For outdoor installations, consider using a weather-resistant enclosure for the power supply or a power source specifically designed for outdoor use.



Figure 6: The router is designed to withstand various outdoor weather conditions.

## 6. TROUBLESHOOTING

### 6.1 No Internet Connection

- **Check SIM Card:** Ensure the SIM card is active, has data, and its PIN code is disabled.

- **APN Settings:** Verify that the APN settings in the router's web interface are correct for your mobile operator.
- **Signal Strength:** Check the signal indicator LEDs. If the signal is weak, try repositioning the router or adjusting antenna orientation.
- **Network Coverage:** In rural areas, signal coverage can be inconsistent. Ensure you are within a service area.

## 6.2 Slow Speeds or Frequent Disconnections

- **Signal Strength:** A weak 4G signal will result in slower speeds. Optimize router placement.
- **Network Congestion:** Performance can be affected by network traffic from your service provider.
- **Device Limit:** The router supports up to 10 devices. Exceeding this limit may degrade performance.
- **Reboot:** Sometimes, a simple reboot of the router can resolve connectivity issues.

## 6.3 Resetting the Device

If you encounter persistent issues, you can perform a factory reset. Locate the 'RESET' button (often a small pinhole) on the router. Use a paperclip or similar pointed object to press and hold the button for approximately 5-10 seconds until the indicator lights flash. This will restore the router to its default factory settings, including WiFi name, password, and login credentials.

## 7. SPECIFICATIONS

Feature	Description
Model Name	CPF905-ES
Brand	KuWiFi
Wireless Standard	802.11n
Data Transfer Rate (LTE)	Up to 150 Mbps (downlink), 50 Mbps (uplink)
Wireless Transmission Rate (WiFi)	300 Mbps
Frequency Bands	FDD: B1, B3, B5, B7, B8, B20; TDD: B38, B39, B40, B41; WCDMA: B1, B5, B8; EVDO BC0; GSM: 900/1800 MHz
Ports	1x WAN/LAN Ethernet, 1x Micro USB (for power)
Antennas	2x External High-Gain (1x 4G, 1x WiFi)
Security Protocol	WPA2-PSK
Power Input	DC 12V
Dimensions (LxWxH)	21.5 x 17 x 6 cm
IP Rating	IP66 (Router unit)
Max Connected Devices	10

## 8. WARRANTY AND SUPPORT

## 8.1 Product Warranty

The KuWiFi CPF905 router comes with a 12-month warranty covering quality-related issues from the date of purchase. This warranty ensures that any manufacturing defects or malfunctions under normal use will be addressed through replacement or a full refund.

## 8.2 Return Policy

You may return your KuWiFi product in its intact condition for a full refund within 30 days from the date of purchase.

## 8.3 Customer Support

For any questions, technical assistance, or warranty claims, please contact KuWiFi customer service through the platform where the product was purchased. Provide your purchase details and a clear description of the issue for prompt support.