

VSEER ac5afe30-c93e-49b7-a986-4cc115c83d58

VSEER Universal 2-Prong Angled Power Cord Instruction Manual

Model: Universal 2-Prong Angled Power Cord (6 Feet White)

1. INTRODUCTION

Thank you for choosing the VSEER Universal 2-Prong Angled Power Cord. This cable is designed to provide a reliable power connection for various electronic devices, featuring a space-saving 90-degree angled plug. It is compatible with devices requiring an IEC320 C7 (Figure 8) connector, such as certain models of scanners, printers, LED TVs, projectors, powered speakers, and laser printers.

This manual will guide you through the features, setup, operation, and maintenance of your new power cord to ensure safe and efficient use.

2. PRODUCT FEATURES

- **Universal Compatibility:** Replacement C7 power cord with a 90-degree angle, suitable for devices with a removable power cord and a 2-prong Figure 8 shotgun power connector (IEC320 C7).
- **Space-Saving Design:** The 90-degree angled plug minimizes protrusion from wall outlets, requiring only 0.8 inches of space when plugged in, compared to standard plugs that may extend 1.8 inches.
- **Safety Certified:** UL Listed & CSA certified, ensuring adherence to safety standards.
- **Durable Construction:** Features SPT-2 18AWG (0.824mm²) 105C 300V VW-1 cable type with high-quality mold injection molding for maximum safety, durability, and long life.
- **Electrical Rating:** Rated to carry 7A 125V or 2.5A 250V.



Figure 2.1: Overview of the VSEER Universal 2-Prong Angled Power Cord, showing both ends of the cable.



Figure 2.2: Close-up view of the angled NEMA 1-15P wall plug and the angled IEC320 C7 (Figure 8) device connector.

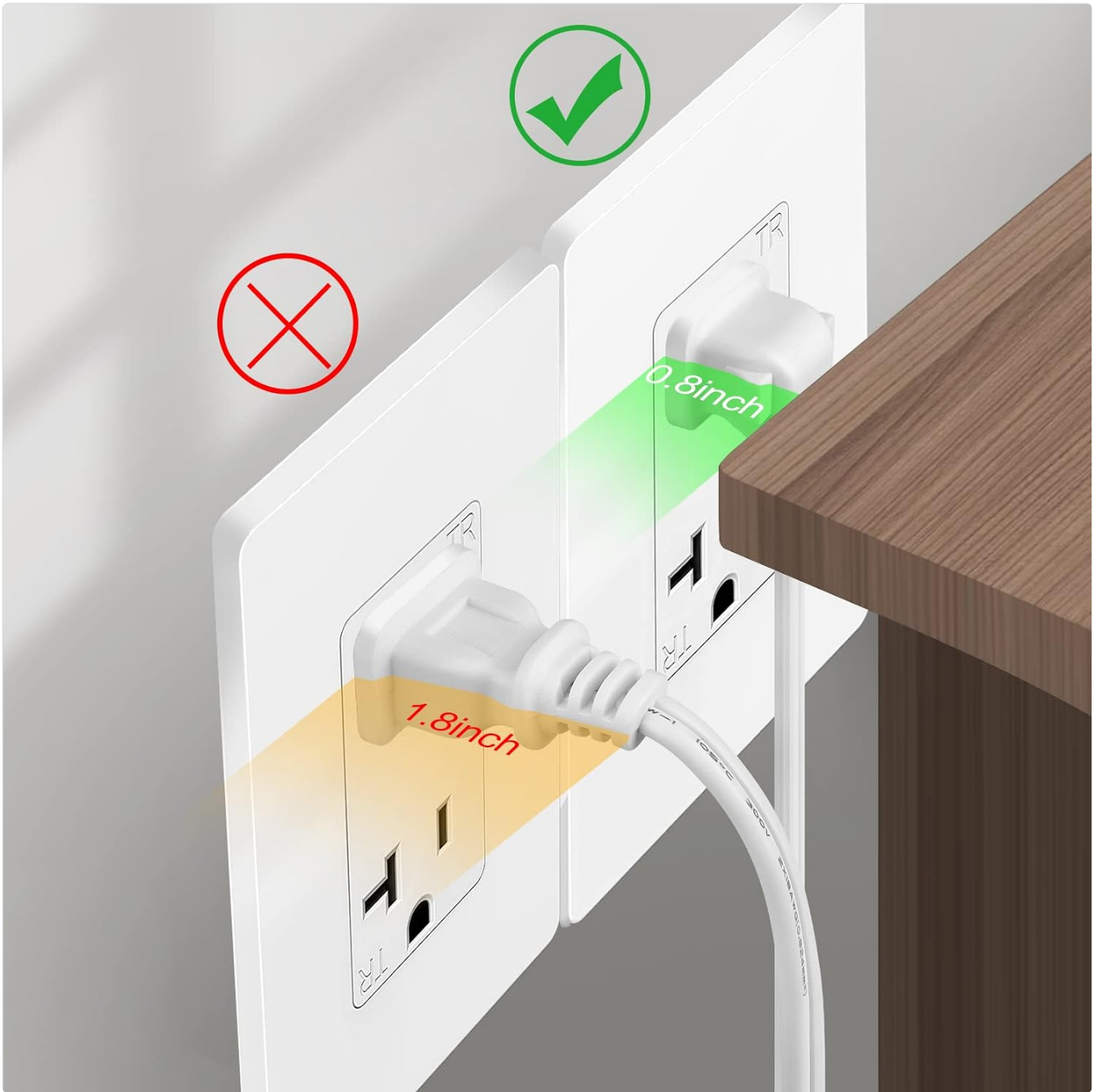

Figure 2.3: Illustration demonstrating the space-saving benefit of the 90-degree angled plug, reducing protrusion from the wall outlet to 0.8 inches compared to a standard 1.8-inch plug.



Figure 2.4: Certification logos for UL Listed and RoHS Compliant, indicating product safety and environmental standards adherence.

3. SETUP INSTRUCTIONS

- 1. Identify Device Compatibility:** Ensure your electronic device requires a 2-prong Figure 8 (IEC320 C7) power connector. This cord is designed for non-polarized C7 inputs.
- 2. Power Off Device:** Before connecting, ensure your electronic device is turned off and unplugged from its current power source, if any.
- 3. Connect to Device:** Insert the angled IEC320 C7 (Figure 8) connector into the corresponding power input port on your device. Ensure a snug and secure fit.
- 4. Connect to Power Outlet:** Plug the NEMA 1-15P (2-prong) angled plug into a standard wall outlet. The angled design allows for a flush fit, minimizing protrusion.
- 5. Verify Connection:** Once both ends are securely connected, you may power on your device.

4. OPERATING INSTRUCTIONS

The VSEER Universal 2-Prong Angled Power Cord operates passively to supply power to your compatible electronic devices. Once properly connected as per the setup instructions, the cord will transmit electrical power from the wall outlet to your device. No additional operational steps are required for the cord itself.

- Always ensure the power cord is fully inserted into both the device and the wall outlet.
- Avoid bending or crimping the cord excessively, especially near the connectors, to prevent damage.
- Do not overload the power cord beyond its rated capacity (7A 125V / 2.5A 250V).

5. MAINTENANCE

To ensure the longevity and safe operation of your VSEER power cord, follow these simple maintenance guidelines:

- **Cleaning:** Disconnect the power cord from both the wall outlet and the device before cleaning. Wipe the cord and connectors with a dry, soft cloth. Do not use liquid cleaners or abrasive materials.
- **Storage:** When not in use, store the power cord in a cool, dry place, away from direct sunlight and extreme temperatures. Avoid tightly coiling the cord to prevent internal wire damage.
- **Inspection:** Periodically inspect the cord for any signs of damage, such as cuts, fraying, exposed wires, or bent/loose prongs. If any damage is observed, discontinue use immediately and replace the cord.
- **Handling:** Always grasp the plug housing when inserting or removing the cord from an outlet or device. Do not pull on the cable itself.

6. TROUBLESHOOTING

If you encounter issues with your VSEER power cord, refer to the following common troubleshooting steps:

Problem	Possible Cause	Solution
Device not receiving power.	Loose connection; Power outlet issue; Damaged cord.	Ensure both ends of the cord are securely plugged in. Test the outlet with another device. Inspect the cord for damage; replace if necessary.
Cord feels hot during use.	Overloaded circuit; Damaged cord; Device drawing too much power.	Immediately unplug the cord. Ensure the device's power requirements do not exceed the cord's rating. Inspect for damage. If the issue persists, consult a qualified electrician.

Problem	Possible Cause	Solution
Angled plug does not fit flush.	Obstruction around the outlet; Outlet type incompatibility.	Ensure there are no physical obstructions. Verify the outlet is a standard NEMA 1-15R receptacle.

If troubleshooting steps do not resolve the issue, please contact VSEER customer support.

7. SPECIFICATIONS

Attribute	Detail
Product Type	Universal 2-Prong Angled Power Cord
Model Number	ac5afe30-c93e-49b7-a986-4cc115c83d58
Cable Type	SPT-2 18AWG (0.824mm ²) 105C 300V VW-1
Connector 1 (Wall)	NEMA 1-15P (2-Prong Angled Male)
Connector 2 (Device)	IEC320 C7 (Figure 8 Angled Female)
Rated Voltage	125V (7A) / 250V (2.5A)
Length	6 Feet
Color	White
Certifications	UL Listed, CSA Certified
Product Dimensions	7 x 4 x 0.6 inches
Item Weight	3.52 ounces

8. WARRANTY AND SUPPORT

VSEER stands behind the quality of its products. If you have any questions or encounter any issues with your Universal 2-Prong Angled Power Cord, please contact our customer service directly. We are committed to resolving any problems promptly to ensure a positive shopping experience.

For support, please refer to the contact information provided with your purchase or visit the official VSEER website.

