

DLYFULL JS-ENDOSCOPE-12-4-153

Dlyfull Universal Battery Tester User Manual

Model: JS-ENDOSCOPE-12-4-153

1. INTRODUCTION

The Dlyfull Universal Battery Tester is a compact and efficient device designed to quickly and accurately assess the health of various household batteries. It features a clear LCD screen that indicates whether a battery is in poor, weak, or good condition, helping users identify usable batteries and dispose of depleted ones. This device is an essential tool for managing your battery inventory, saving money by preventing unnecessary battery purchases, and prolonging the lifespan of your existing batteries.

Dlyfull is a professional manufacturer with over 18 years of experience in battery, charger, and outdoor products, committed to providing reliable and smart charging solutions.



Figure 1: Dlyfull Universal Battery Tester (Front and Back View)

2. SETUP

2.1 Battery Installation (for the Tester)

1. Locate the battery compartment on the back of the Dlyfull Universal Battery Tester.
2. Slide open the battery compartment cover.
3. Insert one AAA battery into the compartment, ensuring correct polarity (+ and - ends match the indicators). An AAA battery is included with the tester.

4. Close the battery compartment cover securely.

The tester is now powered and ready for use.

3. OPERATING INSTRUCTIONS

The Dlyfull Universal Battery Tester is designed for ease of use. Simply place the battery into the appropriate slot or contact points, and the LCD screen will display its charge status.

3.1 Compatible Battery Types

This tester supports a wide range of battery types, including:

- **Cylindrical Batteries:** AA, AAA, C, D, N, CR123A, CR2, CRV3, 2CR5, CR-P2
- **9V Batteries:** Standard 9V (6LR61)
- **Button Cell Batteries:** Various 1.5V/3V button cells (e.g., CR2032)



Figure 2: The Dlyfull Battery Tester is compatible with 12 different battery sizes, including various cylindrical, 9V, and button cell types.

3.2 Reading the LCD Screen

The LCD screen provides a clear visual indication of the battery's charge level using a bar graph and categorized labels:

- **POOR:** The battery is depleted and should be disposed of or recycled.
- **WEAK:** The battery has low power. It may be suitable for low-drain devices but should be replaced soon.
- **GOOD:** The battery is fully charged or has sufficient power for continued use.

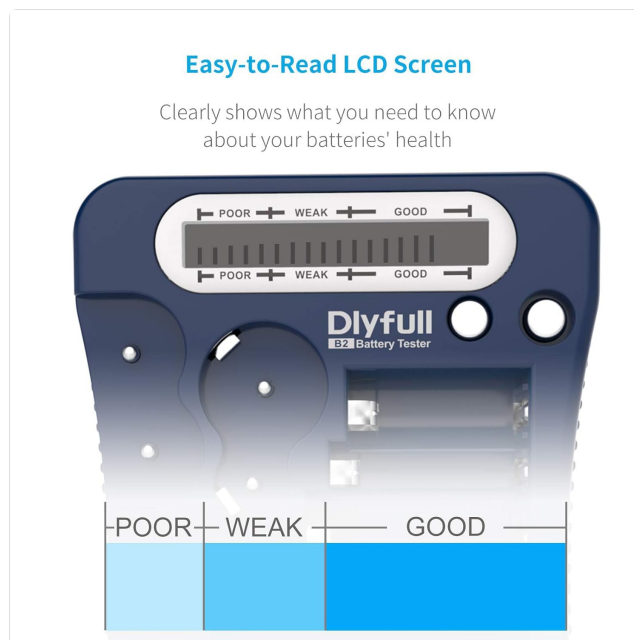

Figure 3: The easy-to-read LCD screen clearly displays the battery's health, indicating 'Poor', 'Weak', or 'Good' status.

3.3 Testing Different Battery Types

To test a battery, simply slide it into the appropriate slot or make contact with the designated terminals. The LCD screen will instantly show the result.

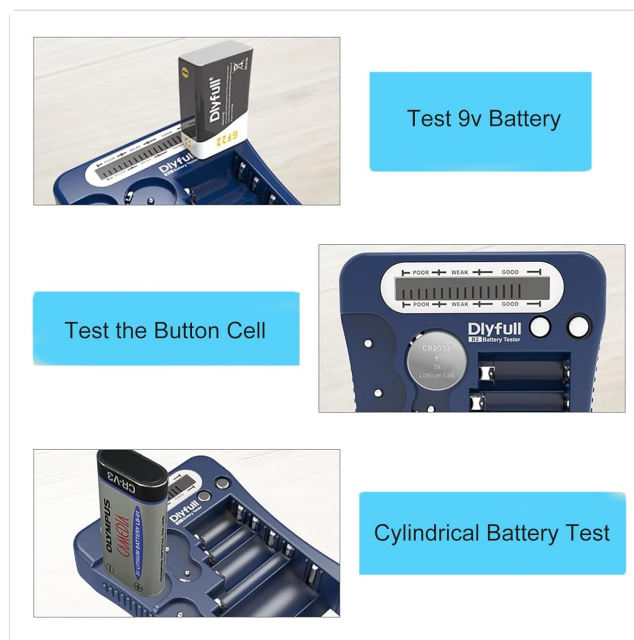

Figure 4: Visual guide for testing 9V batteries, button cells, and cylindrical batteries using the Dlyfull tester.

3.4 Instructional Video

Watch this official video from DlyfullDirect for a quick demonstration on how to use the battery tester with various battery types.

Video 1: Demonstration of the Dlyfull Battery Tester in action, showing how to test different battery sizes including cylindrical, 9V, and button cell batteries. (Source: DlyfullDirect)

4. MAINTENANCE

To ensure the longevity and accurate performance of your Dlyfull Universal Battery Tester, follow these simple

maintenance guidelines:

- Keep the device clean and dry. Wipe with a soft, dry cloth.
- Avoid exposing the tester to extreme temperatures or direct sunlight.
- Do not attempt to disassemble the device.
- If the LCD screen becomes dim or unresponsive, replace the internal AAA battery.
- The robust, anti-smudge casing and premium components are designed to protect against scratches, scrapes, bumps, and drops.



Figure 5: The Dlyfull Battery Tester features a durable design, built to withstand typical impacts and maintain functionality.

5. TROUBLESHOOTING

If you encounter issues with your Dlyfull Universal Battery Tester, consider the following common solutions:

- **No Display:** Ensure the internal AAA battery is correctly installed and has sufficient charge. Replace if necessary.
- **Inaccurate Readings:** Verify that the battery being tested is making proper contact with the tester's terminals. Clean the terminals if there is any visible dirt or corrosion.
- **Tester Not Responding:** Remove and reinsert the internal AAA battery to reset the device. If the issue persists, contact customer support.
- **Cannot Test Rechargeable Batteries:** This tester is designed for non-rechargeable batteries only. Do not attempt to test rechargeable batteries.

6. SPECIFICATIONS

Feature	Detail
Model Number	JS-ENDOSCOPE-12-4-153
Brand	DLYFULL
Power Source	1x AAA Battery (included)

Feature	Detail
Compatible Battery Types	AA, AAA, C, D, 9V, CR2032, CR123A, CR2, CRV3, 2CR5, CRP2, 1.5V/3V Button Cell
Display Type	LCD Screen (Bar Graph)
Color	Blue
Item Weight	9.07 g (0.32 ounces)
Package Dimensions	5.51 x 3.7 x 1.14 inches
Date First Available	June 19, 2019

7. WARRANTY AND SUPPORT

Dlyfull provides an 18-month worry-free warranty for this Universal Battery Tester, along with friendly customer service. For any inquiries, support, or warranty claims, please refer to the contact information provided in your product packaging or visit the official Dlyfull store on Amazon:

[Visit the DLYFULL Store](#)