

Anpviz PTZIP204WX4IR

Anpviz 4MP PoE PTZ IP Camera (Model PTZIP204WX4IR) User Manual

Comprehensive instructions for setup, operation, and maintenance.

1. INTRODUCTION

This manual provides detailed instructions for the installation, configuration, and operation of your Anpviz 4MP PoE PTZ IP Camera, model PTZIP204WX4IR. Please read this manual thoroughly before using the product to ensure proper functionality and safety. This camera is designed for surveillance applications, offering high-resolution video, pan-tilt-zoom capabilities, and smart detection features.

2. SAFETY INFORMATION

- Ensure the power supply voltage is correct before connecting the camera.
- Do not expose the camera to extreme temperatures, humidity, or corrosive environments.
- Avoid pointing the camera lens directly at strong light sources for extended periods.
- Handle the camera with care; avoid dropping or subjecting it to strong vibrations.
- Installation should be performed by qualified personnel in accordance with local electrical codes.
- Disconnect power before performing any maintenance or cleaning.

3. PACKAGE CONTENTS

Verify that all items are present in your package:

- 1x Anpviz 4MP PTZ PoE IP Camera (Model PTZIP204WX4IR)
- 1x Waterproof Lid
- 1x Screw Kit for mounting
- 1x User Manual
- 1x After-sales Card

4. PRODUCT OVERVIEW

The Anpviz PTZIP204WX4IR is a 4-megapixel Power over Ethernet (PoE) Pan-Tilt-Zoom (PTZ) dome camera

designed for both indoor and outdoor surveillance. It features 4x optical zoom, infrared night vision, and advanced video compression.



Figure 4.1: Front view of the Anpviz 4MP PoE PTZ IP Camera.

Key Features:

- **4MP HD Resolution:** Captures video at 2560x1440 pixels at 30 frames per second.
- **4X Optical Zoom:** Allows for detailed magnification without loss of image quality.
- **PTZ Functionality:** 330° pan and 90° tilt for wide area coverage.
- **IR Night Vision:** Provides clear black and white video up to 67 feet in low-light conditions.
- **H.265/H.265+ Compression:** Efficient video compression to reduce bandwidth and storage requirements.
- **Built-in Microphone:** For audio capture (one-way audio).
- **Micro SD Card Slot:** Supports up to 256GB for local storage (card not included).
- **IP67 Weatherproof:** Suitable for outdoor use, protected against dust and temporary immersion in water.
- **Smart Detection:** Includes perimeter protection (intrusion and line crossing detection) and motion detection.



Figure 4.2: Visual representation of key features including 4MP resolution, IP67 waterproof rating, IR night vision, one-way audio, pan/tilt, 4X optical zoom, H.265+ compression, and 120dB Wide Dynamic Range.

5. SETUP

5.1 Mounting the Camera

The camera supports both ceiling and wall mounting. A wall mount may require an additional bracket (not included). Use the provided screw kit for secure installation. Ensure the mounting surface is stable and can support the camera's weight.



Figure 5.1: Example of the Anpviz PTZIP204WX4IR camera mounted on the exterior of a building, connected to an NVR via network cable.

5.2 Power and Network Connection

The camera offers flexible connectivity options:

1. **Power over Ethernet (PoE) Switch:** Connect the camera directly to a PoE switch using an Ethernet cable. The switch will provide both power (48V-52V) and network access.
2. **Anpviz H Series NVR (Plug & Play):** For seamless integration, connect the camera to an Anpviz H Series NVR's PoE port. The NVR will manage power, recording, and network access.
3. **DC 12V Power Adapter:** If not using PoE, connect a 12V DC power adapter (not included) to the camera's power input and an Ethernet cable to a standard router or switch for network access.



Guarding Vision

Free **Guarding Vision** app available on mobile devices.



Never Miss a Moment.



Monitor What Matters.



Always Stay Alert.



Access from Anywhere.

Figure 5.2: Connection diagrams for PoE switch, Anpviz H Series NVR, and 12V DC power adapter.

5.3 Initial Configuration

After connecting the camera, you can access it via the Guarding Vision app (smartphone), iVMS PC client, or a web browser (requires plugin for Windows browsers like Edge, Firefox, Chrome). You may need to activate the camera and set an initial password for security. Refer to the specific software's user guide for detailed configuration steps.

6. OPERATION

6.1 Pan, Tilt, and Zoom Control

The camera features 330° horizontal pan and 90° vertical tilt, allowing you to adjust the viewing angle remotely. The 4x optical zoom provides clear magnification of distant objects. These functions are controlled through the Guarding Vision app or iVMS PC client.



Figure 6.1: The camera's pan and tilt capabilities, illustrating 330° pan and 90° tilt movement.



Figure 6.2: Demonstrates the clarity difference between a normal view and a 4X optical zoom view.

6.2 Smart Detection Features

The camera includes advanced detection capabilities:

- **Motion Detection:** Configurable to detect movement within the camera's field of view and trigger alerts.
- **Perimeter Protection:** Allows you to define specific areas for intrusion detection or line crossing detection. When an event occurs, the camera can send immediate alerts via the app or email.



Figure 6.3: Illustration of motion detection triggering an alarm and app push notification.

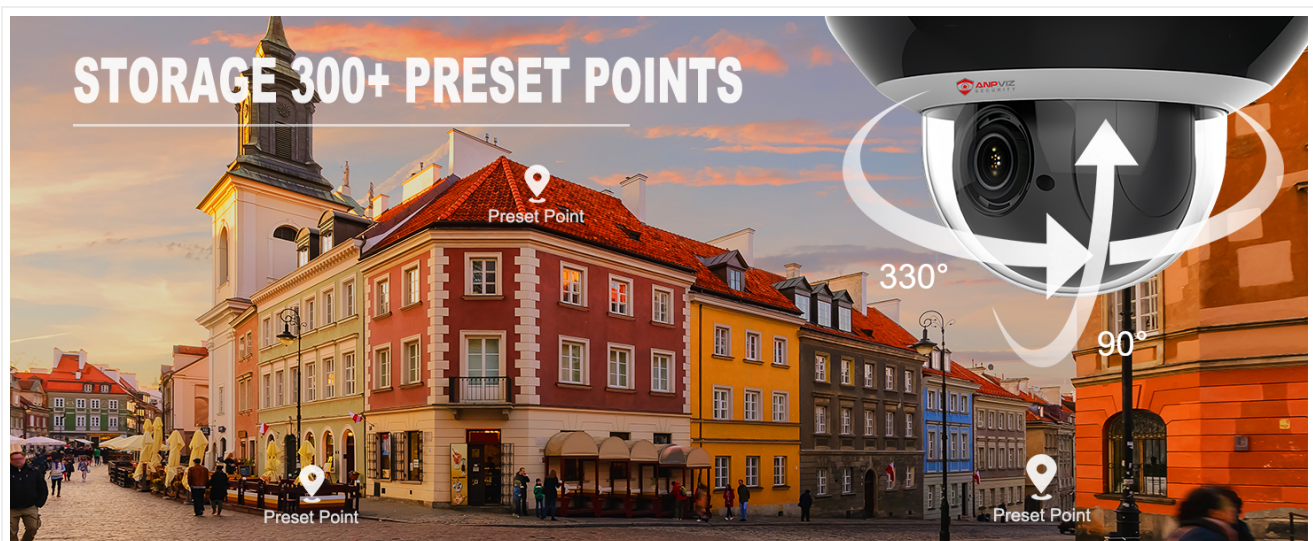



Figure 6.4: Visual explanation of configurable line crossing and intrusion detection areas.

6.3 Recording and Storage

The camera supports various recording and storage methods:

- **Micro SD Card:** Insert a Micro SD card (up to 256GB, not included) into the camera's slot for local video storage. Configure recording schedules (continuous, motion-triggered) via the app or PC client.
- **Network Video Recorder (NVR):** Connect to a compatible NVR for centralized recording and management.
- **Network Attached Storage (NAS) / FTP:** The camera supports NAS and FTP for network-based storage solutions.

Built-in Micro SD Card Slot

 Up to 256G

 No Monthly Fee



Built-In Microphone

Micro SD Card

256G

(Not Included)



Figure 6.5: The camera features a built-in Micro SD card slot supporting up to 256GB for local storage.

The camera utilizes H.265/H.265+ video compression, which significantly reduces file sizes by up to 75% compared to H.264, optimizing storage space and bandwidth usage while maintaining video quality.



FLEXIBLE STORAGE OPTIONS

Depends what you have, store what you want, where you want with secure and convenient storage options.



Figure 6.6: Overview of flexible storage options for the camera.



Figure 6.7: H.265+ compression efficiency compared to H.264.

6.4 Remote Access

Monitor your property from anywhere using the following platforms:

- **Guarding Vision App**: Available for iOS and Android devices. Provides live view, playback, and camera control.

- **iVMS PC Client:** Desktop software for Windows and macOS for comprehensive management.
- **Web Browser:** Access the camera's interface directly via a web browser (Edge, Firefox, Chrome on Windows require a plugin).



2560x1440
@25fps



IP67
Waterproof



IR Night
Vision 67FT



One Way Audio
Built-in Micro



Pan:0°-330°
Tilt:0°-90°



4X Optical
Zoom



H.265+ HEVC
Compression



120dB Wide
Dynamic Range

Figure 6.8: The Guarding Vision app interface for mobile monitoring.



Figure 6.9: Remote access options across various devices.

7. MAINTENANCE

- **Cleaning:** Gently wipe the camera lens and body with a soft, dry cloth. For stubborn dirt, use a cloth lightly dampened with water. Avoid harsh chemicals or abrasive cleaners.
- **Firmware Updates:** Periodically check the Anpviz website or your monitoring software for available firmware updates. Keeping the firmware updated ensures optimal performance and security.
- **Environmental Protection:** While the camera is IP67 rated, ensure its mounting location minimizes direct exposure to extreme weather conditions to prolong its lifespan.

8. TROUBLESHOOTING

Problem	Possible Cause	Solution
No image/video feed	<ul style="list-style-type: none">◦ No power to the camera.◦ Network cable disconnected or faulty.◦ Incorrect IP address or network settings.	<ul style="list-style-type: none">◦ Check power connection (PoE switch, NVR, or 12V adapter).◦ Verify Ethernet cable connection and integrity.◦ Ensure camera's IP address is within your network range and not conflicting. Use the Anpviz client software to discover devices.
PTZ control not responding	<ul style="list-style-type: none">◦ Software/app issue.◦ Network latency.	<ul style="list-style-type: none">◦ Restart the viewing software/app.◦ Ensure a stable network connection.◦ Verify PTZ settings in the software (e.g., for Blue Iris, select "Hikvision DS-2DE/2DF-AE" as the camera type).
Poor image quality at night	<ul style="list-style-type: none">◦ IR illuminators obstructed.◦ Insufficient IR range for the distance.	<ul style="list-style-type: none">◦ Clear any obstructions from the camera's view.◦ Ensure the night vision range (67 feet) is adequate for the monitored area.
Camera attempts to "phone home" (unauthorized network connections)	<ul style="list-style-type: none">◦ Default settings allowing external connections.	<ul style="list-style-type: none">◦ It is recommended to configure your network firewall to restrict the camera's internet access, allowing it to communicate only with your local NVR or specific authorized services if necessary.

9. SPECIFICATIONS

Feature	Detail
Model Name	PTZIP204WX4IR

Feature	Detail
Video Capture Resolution	4MP (2560x1440)
Frame Rate	30 frames per second
Optical Zoom	4x
Pan Range	330 degrees
Tilt Range	90 degrees
Night Vision Range	67 Feet (Infrared)
Video Compression	H.265/H.265+
Audio	Built-in Microphone (one-way)
Storage	Micro SD Card (up to 256GB, not included)
Connectivity	Wired (PoE), ONVIF, RTSP
Power Source	Corded Electric (PoE or 12V DC)
Power Consumption	5 watts
Weather Resistance	IP67 Waterproof
Operating Temperature	-22°F to 140°F (-30°C to 60°C)
Dimensions (L x W x H)	5 x 4 x 4 inches
Item Weight	1.83 pounds
Compatible Devices	Anpviz NVRs, ONVIF-compatible NVRs/software (e.g., Blue Iris, Synology)
Control Method	App (Guarding Vision), PC Client (iVMS-4200), Web Browser
Photo Sensor Technology	CMOS
Alert Type	Motion Only
Light Source Type	Infrared
Video Capture Format	MP4
Specific Uses For Product	Surveillance

10. WARRANTY AND SUPPORT

Anpviz provides a **2-Year Warranty** for this product. Additionally, **Lifetime Technical Support** is available to assist with any questions or issues you may encounter.

For technical assistance or warranty claims, please contact Anpviz support:

- **Email:** support@anpviz.com
- **Operating Hours:** Monday - Friday, 9:00 AM - 6:00 PM (Time Zone not specified, assume PST/EST based on Amazon.com context)

IP67 Waterproof



Rated as IP67 weatherproof, the camera continues to function even being immersed in 1 m of water .



Figure 10.1: Anpviz customer support contact details.

Related Documents - PTZIP204WX4IR

	<p>ANPVIZ IP Dome Camera Quick Start Guide</p> <p>This guide provides essential information for setting up and operating ANPVIZ IP Dome Cameras, covering package contents, connection methods, web and mobile access, and troubleshooting tips.</p>
	<p>ANPVIZ HK Series Network Dome Camera User Manual</p> <p>This user manual provides comprehensive instructions for the ANPVIZ HK Series Network Dome Camera, covering installation, activation, operation via PC browser and mobile app, and connection to NVRs.</p>
	<p>Anpviz Smart WIFI PTZ Camera User Manual</p> <p>User manual for Anpviz Smart WIFI PTZ Camera, covering product introduction, setup, mobile app connection, computer access, and FAQs. Supports PTZ, Bullet, and Dome IP cameras.</p>

	<p>Anpviz IP Dome Camera Quick Start Guide</p> <p>Quick start guide for Anpviz IP Dome Cameras, covering installation, connection, configuration, and mobile app usage.</p>
	<p>Anpviz NVR PoE Camera Setup Guide: Parameters and Configuration</p> <p>Learn how to set up Anpviz NVR PoE cameras, configure IP parameters, use the SADP tool, and adjust image settings for optimal performance. This guide covers essential steps for Anpviz U-Series IP cameras.</p>
	<p>Anpviz IPC-D360W-ST 6MP IP Camera Specifications and Features</p> <p>Detailed specifications and features for the Anpviz IPC-D360W-ST 6MP Human & Vehicle Detection IR & Colorvu Two-way Audio IP camera, including technical details on image sensor, resolution, video encoding, network capabilities, and operating conditions.</p>

Documents - Anpviz – PTZIP204WX4IR

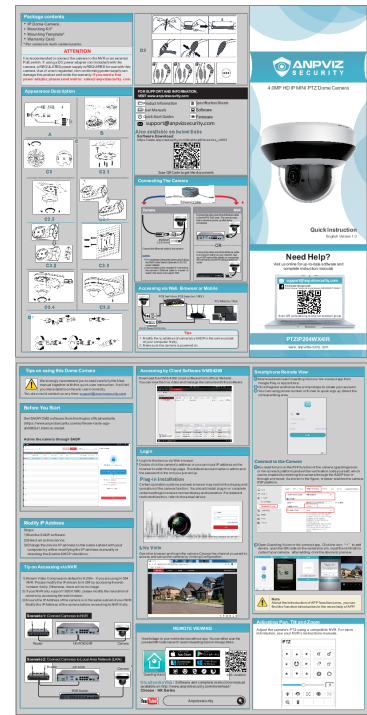

[pdf] User Manual Quick Start Guide Instructions Warranty

PTZ cdr Administrators0 Instructions for Use IFU Anpviz 4 0MP 2560x1440 POE IP Dome Camera
Compatible with Hikvision 4X Optical 16X Digital Zoom H 265 Outdoor Security Alarm Pan Tilt SD Card
Slot Electronics C1G mVwR0OS m media amazon images I Need Help 4MP PoE 2560x1440@30fps
Perimeter Protection Built in Audio 330° 90° Guarding Vision SeriesPTZIP204WX4IR Series
B07T62VCY3Anpviz Electronicscm mVwR0OSm |||
Package contents IP Dome Camera. Mounting Kit* Mounting Template* Warranty
Card * Per camera in ... nload: <https://www.facebook.com/groups/532338207739441>
Scan QR code adding to Anpviz facebook group **PTZIP204WX4IR**
www.anpvizsecurity.com Tips on using this Dome Camera We strongly recommend
you to re...

lang:en score:31 filesize: 7.48 M page_count: 1 document date: 2021-04-13

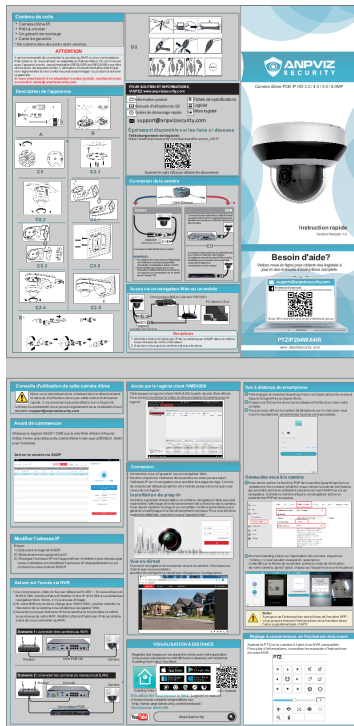

[pdf]

PTZ cdr Administrators0 Besoin d aide Anpviz Security Vous devez activer la fonction P2P de caméra guardingvision ou plateforme hik connect et définir vous même le code vérification bb30b38b8b anpvizsecurity u file 2104 19 |||

Contenu du colis Camra dme IP. Prt--monter Un gabarit de montage Carte de garantie

* Par camra d ... nload: <https://www.facebook.com/groups/532338207739441> Scan QR code adding to Anpviz facebook group **PTZIP204WX4IR** www.anpvizsecurity.com Conseils d utilisation de cette camra dme Nous vous recommando...

lang:fr score:26 filesize: 7.3 M page_count: 1 document date: 2021-02-26



[pdf] Borchure Catalog

2023 ANPVIZ Catalog cdr brochure pub mediabox storage rxweb prd exhibitor document exh e3f0d674 e9c3 483a 9537 87feab69d537 243ab8dc db7 450c 934f 0467eaecb80c |||

CCTV Products Catalog About Anpviz Anpviz was established in 2014 and has been a top rated securit ... 140 www.anpvizsecurity.com 10 Smart PTZ Cameras www.anpvizsecurity.com 11 PTZ IP Cameras SKU **PTZIP204WX4IR** PTZIP3A404WG-E PTZIP4A425XIR PTZIP8C842XIR PTZIP4C425XIR PTZIP4C425XIR-P Picture ...

lang:en score:22 filesize: 3.94 M page_count: 37 document date: 2023-09-12