



Manuals.plus /

› Aucma /

› Aucma 6.5-QT 660W 6-Speed Tilt-Head Stand Mixer Instruction Manual (Model SM-1518N)

Aucma SM-1518N

Aucma 6.5-QT 660W 6-Speed Tilt-Head Stand Mixer Instruction Manual

Model: SM-1518N

1. INTRODUCTION

Thank you for choosing the Aucma 6.5-QT 660W 6-Speed Tilt-Head Stand Mixer. This manual provides essential information for the safe and efficient operation, maintenance, and care of your new kitchen appliance. Please read all instructions carefully before first use and retain this manual for future reference.

2. IMPORTANT SAFETY INSTRUCTIONS

When using electrical appliances, basic safety precautions should always be followed, including the following:

- Read all instructions before operating the mixer.
- To protect against risk of electrical shock, do not immerse the mixer base in water or other liquid.
- Close supervision is necessary when any appliance is used by or near children.
- Unplug from outlet when not in use, before putting on or taking off parts, and before cleaning.
- Avoid contact with moving parts. Keep hands, hair, and clothing, as well as spatulas and other utensils, away from beaters during operation to reduce the risk of injury to persons and/or damage to the mixer.
- Do not operate any appliance with a damaged cord or plug, or after the appliance malfunctions or has been dropped or damaged in any manner.
- The use of attachments not recommended or sold by the manufacturer may cause fire, electric shock, or injury.
- Do not use outdoors.
- Do not let cord hang over edge of table or counter.
- Do not let cord contact hot surfaces, including the stove.
- Always ensure the mixer head is locked down before operating.

3. PRODUCT OVERVIEW

Familiarize yourself with the components of your Aucma Stand Mixer:

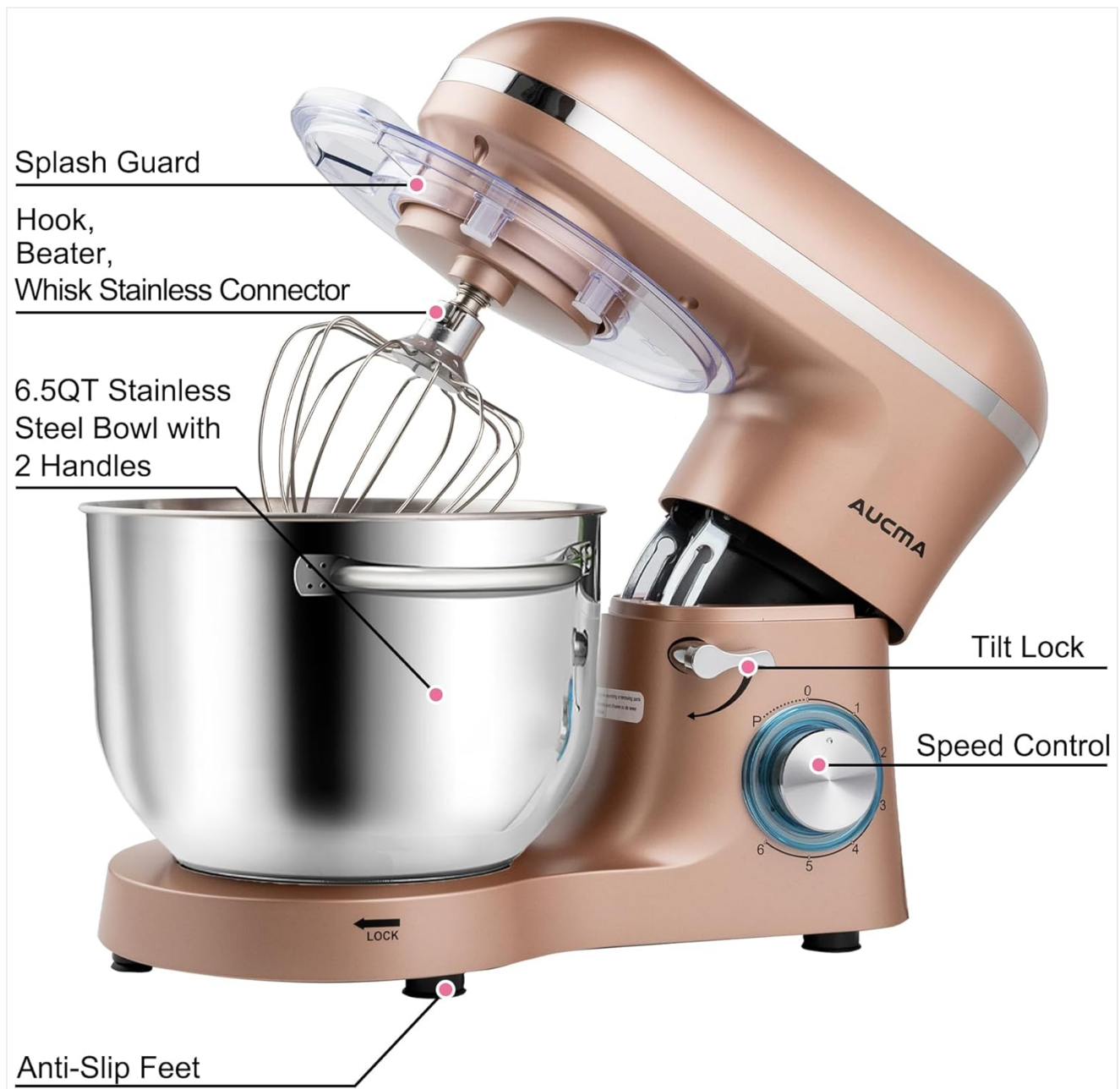

Figure 3.1: Overview of the Aucma Stand Mixer with key components labeled, including the splash guard, whisk, dough hook, beater, 6.5QT stainless steel bowl with handles, tilt lock, speed control, and anti-slip feet.

Components:

- **Mixer Head:** Contains the motor and attachment hub.
- **Tilt Lock:** Secures the mixer head in place during operation and releases it for access to the bowl and attachments.
- **Speed Control Knob:** Adjusts mixing speed from 0 (off) to 6, plus a Pulse (P) function. Features a blue LED light indicator.
- **6.5-Quart Stainless Steel Bowl:** Large capacity mixing bowl with dual handles for easy handling.
- **Splash Guard:** Transparent cover with an access hatch to prevent splatters and allow ingredient addition during mixing.
- **Attachments:**
 - **Wire Whip:** Ideal for light mixtures like cream, egg whites, and sauces.
 - **Dough Hook:** Designed for heavy mixtures such as bread and pizza dough.
 - **Mixing Beater:** Suitable for medium-heavy mixtures like cookies, cakes, and crepes.

- **Anti-Slip Suction Feet:** Located on the base to ensure stability during operation.



Figure 3.2: The three primary attachments: whisk for light mixtures, dough hook for heavy mixtures, and beater for medium-heavy mixtures.

4. SETUP

1. **Unpacking:** Carefully remove all components from the packaging. Ensure all parts listed in the Product Overview section are present.
2. **Placement:** Place the mixer on a clean, dry, and stable surface. The anti-slip suction feet will help secure the unit.
3. **Attaching the Mixing Bowl:**
 - Ensure the mixer head is in the raised position (see Operating Instructions for tilting).
 - Place the stainless steel bowl onto the base, aligning the groove on the bowl with the locking mechanism on the base.
 - Twist the bowl clockwise until it locks securely into place.
4. **Attaching an Accessory:**

- With the mixer head raised, insert the desired attachment (whisk, dough hook, or beater) into the attachment shaft.
 - Push the attachment upwards and twist clockwise until it clicks into place.
5. **Lowering the Mixer Head:** Push the tilt lock lever towards the mixer base and gently lower the mixer head until it locks into the operating position.
 6. **Attaching the Splash Guard:** Place the splash guard over the mixing bowl, ensuring it fits snugly around the mixer head and bowl rim. The access hatch allows for adding ingredients.

5. OPERATING INSTRUCTIONS

Before operating, ensure the mixer is properly set up and plugged into a suitable power outlet (120V~, 60Hz).

Speed Control:

The mixer features 6 optimized speeds and a pulse function, indicated by a blue LED light on the speed control knob.

- **Speed 0:** Off position.
- **Speed 1-3 (Low):** Ideal for heavy mixtures like dough (use dough hook).
- **Speed 2-4 (Medium):** Suitable for medium-heavy mixtures like batters and cookies (use beater).
- **Speed 5-6 (High):** Best for light mixtures such as whipping cream and egg whites (use wire whip).
- **Pulse (P):** Provides short bursts of power at maximum speed. Turn the knob to 'P' and hold for intermittent mixing. Release to stop.

Designed to transform your baking experience



6.5QT

Large Capacity Bowl

Large enough to handle big batches



660W

Pure Copper Motor

Powerful Performance & Lower noise

Figure 5.1: Visual guide for speed settings and corresponding attachments for optimal mixing results.

General Operation:

1. Add ingredients to the mixing bowl.
2. Select the appropriate attachment and speed setting for your recipe.
3. Turn the speed control knob to the desired setting. Start at a lower speed and gradually increase to prevent splashing.

4. Use the planetary mixing action for thorough and consistent mixing.
5. To stop the mixer, turn the speed control knob back to '0'.
6. To remove the bowl or change attachments, ensure the mixer is off and unplugged. Push the tilt lock lever to raise the mixer head.

Video 5.1: Demonstration of the Aucma Stand Mixer's tilt-head function, attachment installation, and speed control. This video highlights the ease of use and the secure locking mechanism of the bowl and mixer head.

6. CLEANING AND MAINTENANCE

Proper cleaning and maintenance will extend the life of your Aucma Stand Mixer.

Cleaning:

- Always unplug the mixer before cleaning.
- **Mixing Bowl and Attachments:** The stainless steel bowl, wire whip, dough hook, and mixing beater are dishwasher safe for easy cleaning. Alternatively, wash them in warm, soapy water and rinse thoroughly.
- **Splash Guard:** The splash guard can be washed by hand in warm, soapy water.
- **Mixer Base:** Wipe the mixer base with a damp cloth. Do not immerse the base in water or any other liquid.
- Ensure all parts are completely dry before reassembling or storing.

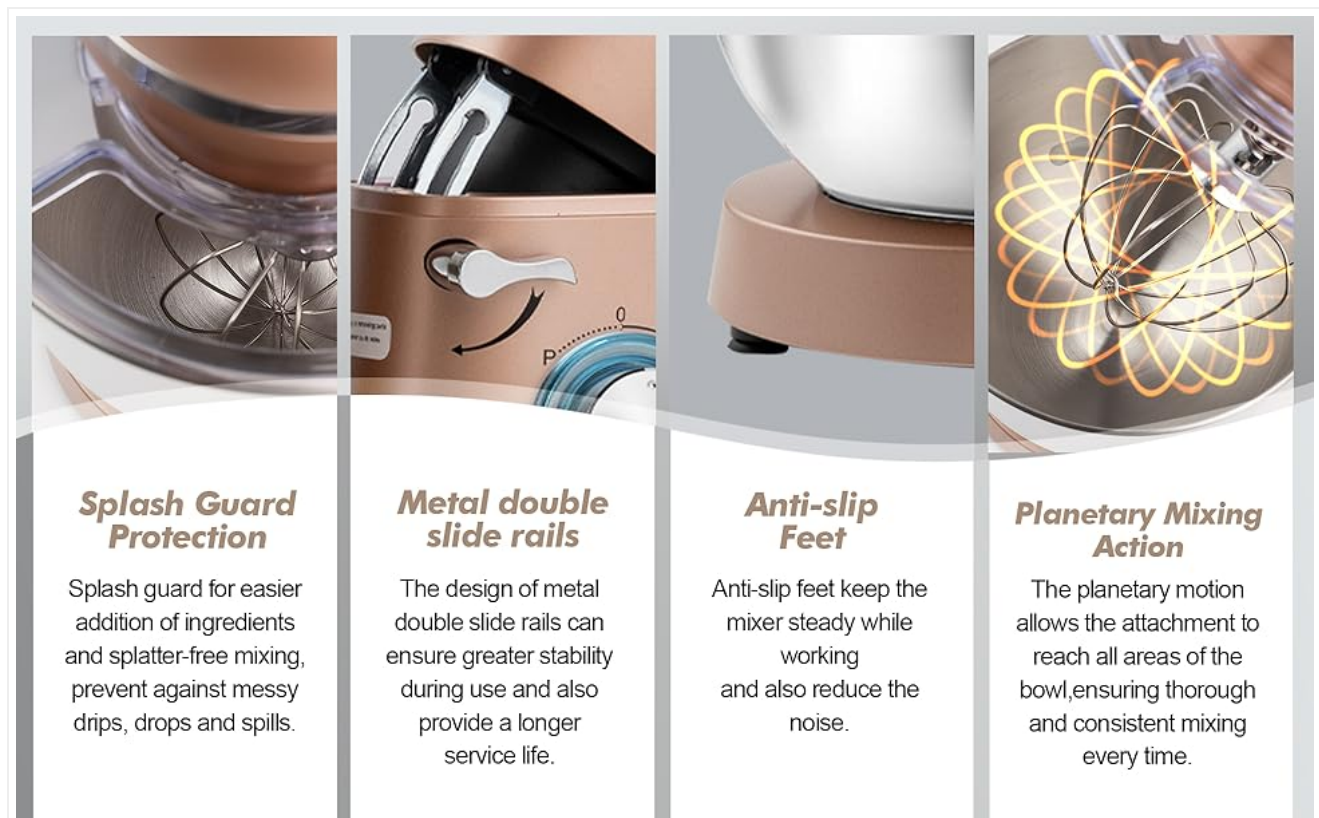

Figure 6.1: All mixing accessories and the bowl are dishwasher safe, simplifying cleanup after use.

Storage:

Store the mixer and its accessories in a clean, dry place. The attachments can be stored inside the mixing bowl for convenience.

7. TROUBLESHOOTING

If you encounter any issues with your Aucma Stand Mixer, please refer to the following common problems and solutions:

Problem	Possible Cause	Solution
Mixer does not turn on.	Not plugged in; power outlet malfunction; mixer head not locked.	Ensure the power cord is securely plugged in. Check the power outlet with another appliance. Make sure the mixer head is fully lowered and locked into position.
Attachments do not fit or detach easily.	Incorrect alignment; debris in the attachment hub.	Ensure the mixer head is fully raised. Align the attachment correctly with the shaft and twist firmly. Check for any obstructions in the attachment hub.
Mixer is shaking excessively during operation.	Bowl not locked; uneven surface; mixture too heavy.	Ensure the mixing bowl is securely locked onto the base. Place the mixer on a flat, stable surface. Reduce the quantity of ingredients or use a lower speed for very heavy mixtures.
Loud noise during operation.	Normal operation noise; heavy load.	Some noise is normal, especially at higher speeds or with heavy loads. If the noise is unusual or excessive, discontinue use and contact customer support.

8. SPECIFICATIONS

- **Brand:** Aucma
- **Model Name:** stand mixer
- **Item Model Number:** SM-1518N
- **Power:** 660W (Pure copper motor)
- **Voltage:** 120V~, 60Hz
- **Speed Control:** Rotary 6 speeds + Pulse function
- **Capacity:** 6.5 Quarts (Stainless Steel Bowl with Dual Handles)
- **Special Features:** Tilt Head Mixers, Sturdy ABS housing, Full metal gears for driven mechanism, Low operation noise (≤ 76 dB), Blue LED light power indicator.
- **Product Dimensions:** 15.2"D x 9.4"W x 12.4"H
- **Item Weight:** 13.9 pounds
- **Dishwasher Safe:** Yes (Bowl and attachments)



Figure 8.1: Key dimensions of the Aucma Stand Mixer for placement and storage reference.

9. WARRANTY AND SUPPORT

For warranty information or technical support, please refer to the product packaging or contact Aucma customer service directly. Keep your purchase receipt as proof of purchase.

If you have any questions or require assistance, please do not hesitate to contact us. Our customer service team is available to help.

