

KRUPS MS-5370781

KRUPS MS-5370781 Seal and Guide User Manual

For Automatic Espresso Machines (EA6..., EA8..., XP7... Series)

[Introduction](#) [Product](#)

[Overview](#) [Compatibility](#) [Installation](#) [Maintenance](#) [Troubleshooting](#) [Specifications](#) [Support](#)

1. INTRODUCTION

This manual provides essential information for the KRUPS MS-5370781 Seal and Guide, a genuine spare part designed for various KRUPS fully automatic espresso machines. Proper installation and maintenance of this component are crucial for the optimal performance and longevity of your appliance. Please read these instructions carefully before attempting any installation or replacement.

2. PRODUCT OVERVIEW

The MS-5370781 is a critical component that includes both a guide and a seal, essential for the internal mechanism of your KRUPS automatic espresso machine. It ensures proper water flow and pressure within the brewing unit, preventing leaks and maintaining consistent coffee quality. This part is manufactured to KRUPS' high standards, guaranteeing a perfect fit and reliable operation.



Figure 1: Front view of the KRUPS MS-5370781 Seal and Guide. This image shows the main body of the guide with the integrated black rubber seal clearly visible in the circular opening.



Figure 2: Angled view of the KRUPS MS-5370781 Seal and Guide. This perspective highlights the elongated guide arm and the structural supports, with the seal visible from a different angle.

3. COMPATIBILITY

The MS-5370781 Seal and Guide is compatible with a wide range of KRUPS fully automatic espresso machines. Please verify your machine's model number against the list below to ensure proper fitment.

Compatible KRUPS Models:

- **EA6 Series:** EA6910, EA6930, EA6990
- **EA7 Series:** EA7200
- **EA8 Series:** EA8000, EA8010, EA801S, EA8025, EA8038, EA8050, EA8080, EA8108, EA8200, EA8245, EA8250, EA8251, EA8255, EA8260, EA8280, EA8320, EA8321, EA8322, EA8340
- **XP7 Series:** XP7180, XP7200, XP720, XP7230, XP7240, XP7250, XP7260

If your model is not listed, please consult your machine's original manual or contact KRUPS customer support for compatibility verification.

4. INSTALLATION INSTRUCTIONS

Replacing the seal and guide requires careful handling and basic technical understanding. If you are unsure about any step, it is recommended to seek assistance from a qualified technician.

1. **Safety First:** Always unplug your espresso machine from the power outlet and allow it to cool completely before beginning any maintenance or repair work.
2. **Access the Brewing Unit:** Depending on your specific KRUPS model, you may need to remove the back panel or side panels to access the internal brewing unit where the seal and guide are located. Refer to your machine's service manual for detailed disassembly instructions.
3. **Locate the Old Part:** Identify the existing seal and guide assembly. It is typically part of the water distribution system within the brewing mechanism.
4. **Remove the Old Part:** Carefully detach the old seal and guide. This may involve releasing clips, unscrewing fasteners, or gently prying it out. Note the orientation of the old part to ensure correct installation of the new one.
5. **Clean the Area:** Before installing the new part, clean any residue, coffee grounds, or mineral deposits from the surrounding area to ensure a proper seal and smooth operation.
6. **Install the New Part:** Position the new MS-5370781 Seal and Guide into place, ensuring it aligns correctly with all connection points and the seal is seated properly. Gently press or secure it until it is firmly in position.
7. **Reassemble the Machine:** Carefully reassemble the espresso machine, ensuring all panels and screws are securely fastened.
8. **Test for Leaks:** After reassembly, fill the water tank and perform a test cycle (e.g., a rinse cycle or brewing a cup of hot water) to check for any leaks or unusual noises before brewing coffee.

***Disclaimer:** These instructions are general guidelines. Specific steps may vary by model. Always prioritize safety and consult professional help if needed.*

5. MAINTENANCE

To prolong the life of your MS-5370781 Seal and Guide and ensure consistent performance of your espresso machine, consider the following maintenance tips:

- **Regular Descaling:** Follow your espresso machine's descaling instructions regularly to prevent mineral buildup, which can harden seals and affect the guide's movement.
- **Cleaning:** Periodically clean the brewing unit area as per your machine's manual. While the seal and guide are internal, keeping the surrounding components clean helps prevent premature wear.
- **Inspection:** If you notice any leaks, reduced coffee flow, or unusual noises from the brewing unit, it may indicate wear on the seal or guide. Inspect the part if accessible, or consult a technician.

6. TROUBLESHOOTING

If you experience issues after replacing the MS-5370781 Seal and Guide, or if you suspect the original part is failing, consider these common problems:

- **Water Leaks:** If water leaks from inside the machine, especially around the brewing unit, it often indicates a faulty or improperly installed seal. Recheck the installation of the MS-5370781.
- **Reduced Coffee Flow/Pressure:** A worn guide or seal can lead to pressure loss, resulting in weak coffee or slow dispensing.

- **Unusual Noises:** Grinding or straining noises from the brewing unit might suggest the guide is not moving smoothly, possibly due to wear or obstruction.
- **Machine Not Brewing:** In severe cases, a completely failed seal or guide can prevent the machine from completing a brewing cycle.

If troubleshooting steps do not resolve the issue, contact KRUPS customer support or a certified service center.

7. SPECIFICATIONS

Attribute	Detail
Part Number	MS-5370781
Brand	KRUPS
Type	Seal and Guide (Spare Part)
Material	Durable Plastic / Rubber Seal
Compatibility	KRUPS EA6, EA7, EA8, XP7 Series Automatic Espresso Machines
Color	Typically White/Cream with Black Seal

8. WARRANTY AND SUPPORT





As a spare part, the warranty for the MS-5370781 Seal and Guide typically aligns with the warranty terms provided by the retailer or KRUPS for replacement parts. Please retain your proof of purchase.

For further assistance, technical support, or to inquire about professional installation services, please visit the official KRUPS website or contact their customer service department. You can often find contact information and support resources on the [KRUPS Store on Amazon](#) or through the main KRUPS website.

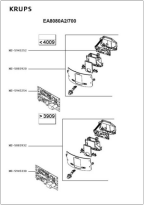
© 2023 KRUPS. All rights reserved. Information subject to change without notice.

Related Documents - MS-5370781

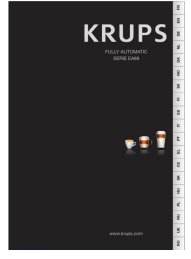
	<p>Krups EA8080A2/700 Coffee Machine Parts Diagram</p> <p>Detailed exploded view parts diagram for the Krups EA8080A2/700 espresso coffee machine, listing all identifiable part numbers for maintenance and repair purposes.</p>
---	---

	<p>Krups EA9000 Espresso Automatic User Manual</p> <p>Comprehensive user manual for the Krups EA9000 Espresso Automatic coffee machine, covering setup, operation, maintenance, and troubleshooting.</p>
	<p>Krups Sensation Milk EA91 Range Quick Start Guide</p> <p>Concise guide to setting up, using, and maintaining your Krups Sensation Milk EA91 Range automatic coffee machine. Learn how to make coffee and milk-based drinks, clean, and descale the appliance.</p>
	<p>KRUPS Espresso Automatic EA815, EA816, EA817 User Manual and Guide</p> <p>Comprehensive user manual for the KRUPS EA815, EA816, and EA817 automatic espresso machines. Learn how to make coffee, maintain your machine, and troubleshoot issues.</p>
	<p>KRUPS Espresso Automatic EA89 Series User Manual</p> <p>Comprehensive user manual for the KRUPS Espresso Automatic EA89 Series fully automatic coffee machine. This guide covers setup, operation, drink preparation, maintenance, and troubleshooting for your KRUPS EA89 coffee maker.</p>
	<p>KRUPS EA898 EVIDENCE HOT & COLD Automatic Coffee Machine User Manual</p> <p>A comprehensive guide for the KRUPS EA898 EVIDENCE HOT & COLD automatic coffee machine, covering setup, operation, beverage customization, maintenance, and cleaning procedures.</p>

Documents - KRUPS – MS-5370781

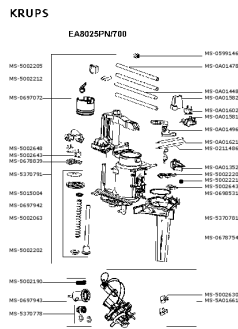

[pdf]

MS 5002643 0678839 0678836 0A01322 0A01356 0A01320A 0A01473 0A01481 0A01471 0A01456A 0A01373 0A01544 4A01302A KRUPS EA8025PN700 Despiece recambiosyaccesoriosonline es despieces krups ea8025pn700 |||

MS-5002205 MS-5002212 MS-0697072 MS-5002648 MS-5002643 MS-0678839 MS-5370791 MS-5015004 MS-0697942 M ... MS-0A01581 MS-0A01496 MS-0A01621 MS-0211486 MS-0A01352 MS-5002220 MS-5002221 MS-5002643 MS-0698531 **MS-5370781** MS-0678754 MS-5002630 MS-5A01661 Kaffee-Vollautomat Espresseria EA8025PN/700 Erstausta...

lang:it score:20 filesize: 146.4 K page_count: 10 document date: 2012-01-29

