

Beghelli 19432

Beghelli 19432 LED Emergency Lamp User Manual

Model: 19432

INTRODUCTION

This manual provides essential information for the safe and efficient use of your Beghelli 19432 LED Emergency Lamp. Please read this manual thoroughly before installation, operation, or maintenance to ensure proper functioning and to prevent damage or injury.

The Beghelli 19432 is a high-performance LED emergency lamp designed for reliable illumination during power outages or emergency situations. It features a robust polycarbonate construction and a powerful 1200 lumen LED light source with Li-Fe battery technology.

SAFETY INFORMATION

Always adhere to the following safety guidelines to prevent electric shock, fire, or injury:

- Ensure the power supply is disconnected before installation or maintenance.
- Installation should be performed by a qualified electrician in accordance with local electrical codes.
- Do not expose the lamp to excessive moisture or extreme temperatures.
- Do not attempt to open or modify the lamp housing, as this may void the warranty and pose a safety risk.
- Keep packaging materials away from children.

PACKAGE CONTENTS

Verify that all components are present and undamaged:

- Beghelli 19432 LED Emergency Lamp unit
- Integrated Li-Fe Battery
- Mounting accessories (screws, wall plugs)
- User Manual (this document)

SETUP AND INSTALLATION

The Beghelli 19432 emergency lamp is designed for wall mounting. Follow these steps for proper installation:

1. **Choose a Location:** Select a suitable location for installation, typically near an exit or in a common area, ensuring the light can illuminate the required path during an emergency. The lamp is designed for indoor use in commercial or emergency exit applications.
2. **Prepare the Mounting Surface:** Ensure the wall surface is clean, dry, and capable of supporting the lamp's weight.
3. **Mark Drilling Points:** Use the lamp's mounting holes as a template to mark the drilling points on the wall.
4. **Drill Holes:** Drill holes at the marked points using an appropriate drill bit for the wall plugs.
5. **Insert Wall Plugs:** Insert the provided wall plugs into the drilled holes.
6. **Mount the Lamp:** Secure the lamp to the wall using the provided screws. Ensure it is firmly attached.
7. **Connect Power:** Connect the lamp to the main power supply according to the wiring diagram (refer to the diagram usually found inside the lamp's cover or on a separate sheet, not provided here). Ensure correct polarity and secure connections. The lamp is battery-operated but requires a constant power supply to keep the battery charged and for automatic operation.
8. **Initial Charge:** After installation, allow the lamp to charge for at least 24 hours before its first use to ensure the battery is fully charged.



Image: The Beghelli 19432 LED Emergency Lamp, featuring its sleek white polycarbonate housing and the transparent light diffuser, designed for efficient light distribution.

OPERATING INSTRUCTIONS

The Beghelli 19432 operates automatically:

- **Normal Operation:** When connected to the main power supply, the lamp's battery will charge, and the lamp will remain off (or in standby mode, depending on configuration).
- **Emergency Mode:** In the event of a power failure, the lamp will automatically switch on, providing 1200 lumens of illumination from its internal Li-Fe battery.
- **Return to Normal:** Once main power is restored, the lamp will automatically switch off and begin recharging its battery.

- **Test Button (if applicable):** Some models may include a test button to manually check the emergency function. Press and hold the button to simulate a power outage and verify the lamp illuminates. Release the button to return to normal operation. (*Note: Specific button location and function may vary; refer to product labeling if present*)

MAINTENANCE

Regular maintenance ensures the longevity and reliability of your emergency lamp:

- **Cleaning:** Clean the lamp's exterior with a soft, dry cloth. Do not use abrasive cleaners or solvents.
- **Battery Check:** Perform a monthly functional test by simulating a power outage (e.g., by pressing the test button or temporarily disconnecting power) to ensure the battery holds a charge and the lamp illuminates for the specified duration.
- **Annual Discharge Test:** Annually, perform a full discharge test. Disconnect the main power supply and allow the lamp to operate until the battery is fully depleted. Then, reconnect power and allow it to recharge for 24-48 hours. This helps maintain battery health.
- **Battery Replacement:** The integrated Li-Fe battery has a long lifespan but will eventually require replacement. This should only be performed by qualified personnel. Contact Beghelli support for authorized service.
- **Lamp Replacement:** The LED light source is designed for long-term use and is generally not user-replaceable. If the LEDs fail, the entire unit may need replacement.

TROUBLESHOOTING

Refer to the table below for common issues and their solutions:

Problem	Possible Cause	Solution
Lamp does not illuminate during power outage.	Battery not charged or faulty. Incorrect wiring. Lamp fault.	Ensure lamp has been connected to power for at least 24 hours. Check wiring connections. If problem persists, contact qualified service personnel.
Lamp remains on constantly.	Main power supply issue. Internal fault.	Verify main power supply is stable. Disconnect and reconnect power. If issue persists, contact qualified service personnel.
Reduced illumination duration.	Battery degradation. Insufficient charging.	Perform annual full discharge/recharge cycle. Ensure continuous power supply for charging. Battery may need replacement by qualified personnel.

If you encounter issues not listed here or if the suggested solutions do not resolve the problem, please contact Beghelli customer support.

SPECIFICATIONS

Feature	Detail
Model Number	19432
Brand	Beghelli

Feature	Detail
Light Source	LED
Luminous Flux	1200 lumens
Power Consumption	24 Watt
Battery Type	Li-Fe (Lithium Iron)
Material	Policarbonato (Polycarbonate)
Color	White
Application Area	Commercial, Emergency Exit
Mounting Type	Wall Mount (Parete)
Switch Type	Automatic
First Available	May 16, 2019

WARRANTY AND SUPPORT

For warranty information, please refer to the documentation provided with your purchase or visit the official Beghelli website. Beghelli products are designed for durability and performance.

For technical support, service, or inquiries regarding replacement parts, please contact Beghelli customer service through their official channels. Contact information can typically be found on the Beghelli website or on the product packaging.

Recycling Information: For information on recycling this product, particularly the lamp and battery components, please refer to local regulations and recycling guidelines. Specific information regarding lamp recycling and disposal of broken or damaged lamps can often be found on the manufacturer's website or through local waste management services.

© 2024 Beghelli. All rights reserved.
This manual is subject to change without notice.

Related Documents - 19432

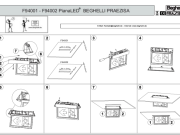
	<p>Beghelli Acciaio Emergenza Emergency Lighting - Technical Specifications and Applications</p> <p>Detailed technical specifications, performance data, and application guidelines for the Beghelli Acciaio Emergenza emergency lighting luminaire. Features include ATEX compliance, various mounting options, and high-transmission micro-prismatic glass.</p>
	<p>F94001 - F94002 PianaLED Beghelli Praezisa Installation Guide</p> <p>Installation instructions and warranty information for the Beghelli PianaLED F94001 and F94002 emergency lighting fixtures. Includes diagrams and multilingual warnings.</p>

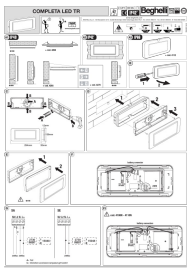

[Beghelli Completa LED TR Emergency Luminaire Installation and Technical Guide](#)

Installation and technical guide for the Beghelli Completa LED TR emergency LED luminaire. Details IP ratings (IP40, IP42, IP66), wiring, model specifications, operation, and safety warnings.



[Beghelli Giornale - March-June 2020 Edition](#)

This edition of Beghelli Giornale features new products and offers from the Beghelli Group, including the Cloud Beghelli platform for managing lighting and emergency lighting systems, the Archieco emergency lighting line, and various lighting fixtures like LED panels, floodlights, and strip LEDs.

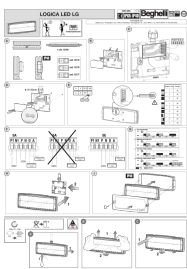

[Beghelli Logica LED LG Emergency Lighting Fixture - Installation and Technical Manual](#)

A comprehensive guide to the Beghelli Logica LED LG emergency lighting fixture, covering installation, wiring, technical specifications, LED status indicators, and safety warnings. This manual provides essential information for installers and maintenance personnel.

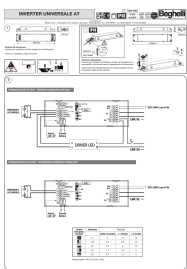

[Beghelli Inverter Universale AT: Installation and Settings Guide](#)

Comprehensive guide to installing and configuring the Beghelli Inverter Universale AT emergency lighting conversion kit, including wiring diagrams, technical specifications, and operational settings.