

PDP 500-134-NA-CM00

PDP Gaming Faceoff Deluxe+ Audio Wired Controller for Nintendo Switch - Instruction Manual

Model: 500-134-NA-CM00

INTRODUCTION

The PDP Gaming Faceoff Deluxe+ Audio Wired Controller is designed for use with the Nintendo Switch. It features a 3.5mm audio jack for in-game audio and USB chat, customizable programmable back buttons, and interchangeable faceplates. This manual provides instructions for setting up, operating, and maintaining your controller.



Image: Front view of the PDP Gaming Faceoff Deluxe+ Audio Wired Controller in Black Camo.

SETUP

1. Initial Connection

1. Ensure your Nintendo Switch console is docked and powered on.
2. Connect the controller's fixed USB cable to an available USB port on the Nintendo Switch dock.
3. The controller should automatically be recognized by the console.

2. Audio Setup

- Plug your 3.5mm headset into the audio jack located at the bottom center of the controller.
- In-game audio will now be routed through your headset. USB chat is supported for compatible titles.



Image: A user playing with the PDP Gaming Faceoff Deluxe+ Audio Wired Controller, demonstrating the headset connection.

OPERATING THE CONTROLLER

1. Button Layout and Functions

Familiarize yourself with the controller's button layout for optimal gameplay.



Image: Detailed view of the controller with key buttons labeled for easy identification.

- **View Button:** Typically used for in-game menus or map access.
- **Home Button:** Returns to the Nintendo Switch HOME Menu.
- **Volume Control:** Adjusts headset audio volume.
- **Function Button:** Used in conjunction with other buttons for specific features (refer to game instructions).
- **Analog Sticks:** Provide precise movement and camera control. Features low friction rings for smooth performance.

2. Programmable Back Buttons

The controller features dual programmable paddle-style buttons on the back, allowing for customized gameplay. These can be mapped to other buttons on the controller to suit your play style.



Image: The back of the controller highlighting the programmable paddle buttons.

3. Adjusting Audio Volume

Volume can be adjusted directly on the controller using the D-pad while holding the Function button (refer to the labeled image above for button location).

4. Faceplate Customization

The unique interchangeable design allows you to swap out and snap in different Faceoff faceplates to personalize your controller's appearance.



Interchangeable faceplate design

Image: Illustration demonstrating the interchangeable faceplate design of the controller.

MAINTENANCE

- Keep the controller clean by wiping it with a soft, dry cloth.
- Avoid exposing the controller to extreme temperatures, humidity, or direct sunlight.
- Do not attempt to disassemble the controller, as this may void the warranty.

TROUBLESHOOTING

- **Controller not responding:** Ensure the USB cable is securely connected to the Nintendo Switch dock. Try a different USB port.
- **No audio through headset:** Verify the headset is fully plugged into the controller's 3.5mm jack. Check the volume settings on the controller and the Nintendo Switch console.
- **Buttons not working correctly:** Ensure the controller's firmware is up to date (if applicable, check PDP's official website). If issues persist, try restarting the Nintendo Switch console.

SPECIFICATIONS

Feature	Detail
Model Number	500-134-NA-CM00
Connectivity	Wired (10-foot fixed USB cable)
Audio Jack	3.5mm (supports in-game audio and USB chat)
Customization	Interchangeable faceplates, dual programmable paddle-style back buttons
Dimensions	0.35 x 0.12 x 0.83 inches
Weight	14.1 ounces
Compatibility	Nintendo Switch
Manufacturer	PDP



Image: Controller dimensions for reference.

OFFICIAL PRODUCT VIDEO

Your browser does not support the video tag.

Video: An honest review of the PDP Gaming Wired Nintendo Switch Controller, showcasing its features and

functionality.

WARRANTY AND SUPPORT

For warranty information and customer support, please refer to the documentation included with your product or visit the official PDP website.

You can also visit the [PDP Store on Amazon](#) for additional product information and support resources.

Related Documents - 500-134-NA-CM00

	<p>REMATCH Wired Controller for Nintendo Switch Quick Start Guide</p> <p>A quick start guide for the REMATCH Wired Controller for Nintendo Switch, detailing setup, audio configuration, volume controls, back button programming, and interchangeable parts.</p>
	<p>PDP REMATCH Wired Controller for Nintendo Switch: Quick Start Guide</p> <p>Concise guide to setting up and using the PDP REMATCH Wired Controller for Nintendo Switch, covering initial setup, audio, volume, and back button programming.</p>
	<p>Afterglow Wireless Deluxe Controller for Nintendo Switch - Quick Start Guide & Features PDP</p> <p>Get started with your PDP Afterglow Wireless Deluxe Controller for Nintendo Switch. Learn how to pair, charge, customize lights, program back buttons, and understand the limited warranty.</p>
	<p>REALMz™ Wired Controller Quick Start Guide for Nintendo Switch</p> <p>Quick start guide for the REALMz™ Wired Controller for Nintendo Switch. Learn setup, audio, volume, and LED lighting features.</p>
	<p>PDP Rock Candy Wired Controller for Nintendo Switch Quick Start Guide</p> <p>This guide provides instructions for setting up and using the PDP Rock Candy Wired Controller for Nintendo Switch. It includes warranty information and contact details for customer support.</p>

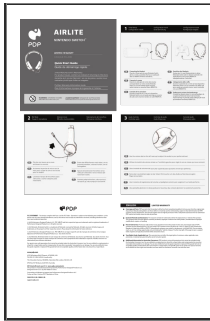

[PDP AIRLITE Wired Headset for Nintendo Switch: Quick Start Guide](#)

Get started quickly with the PDP AIRLITE Wired Headset for Nintendo Switch. This guide covers initial setup, connecting the headset, mic mute, audio controls, and warranty information.