



Manuals.plus /

- › Jocuu /
- › Jocuu Slow Masticating Juicer Machine User Manual

## Jocuu Juicer Machines217

# Jocuu Slow Masticating Juicer Machine User Manual

Model: Juicer Machines217 | Brand: Jocuu

## INTRODUCTION

---

The Jocuu Slow Masticating Juicer Machine is designed for efficient and quiet juicing of various fruits and vegetables. Its slow masticating process ensures maximum nutrient extraction and high juice yield with minimal oxidation. This manual provides detailed instructions for safe and effective use, maintenance, and troubleshooting.



The Jocuu Slow Masticating Juicer Machine in gray, assembled and ready for use, with a glass of green juice and pulp container.

## PRODUCT COMPONENTS

---

Familiarize yourself with the main components of your Jocuu juicer:

- Motor Base
- Feeding Chute / Hopper
- Auger (Spiral System)
- Filter (Fine Mesh)
- End Cap
- Juice Cup
- Pulp Container
- Pusher
- Cleaning Brush

## | Super Fine Mesh Filter

Separate the pulp and juice to get a purer juice



All components of the Jocuu Slow Masticating Juicer Machine laid out, including the motor base, auger, filter, juice cup, and pulp container.

### SETUP AND ASSEMBLY

---

Follow these steps to assemble your juicer before first use:

#### Step-by-Step Assembly

1. Insert the auger into the main body of the juicer.
2. Place the fine mesh filter securely over the auger.
3. Attach the end cap to the juicer body and twist it clockwise until it locks into place.
4. Position the feeding chute on top of the assembled juicing parts.

5. Place the juice cup under the juice spout and the pulp container under the pulp spout.

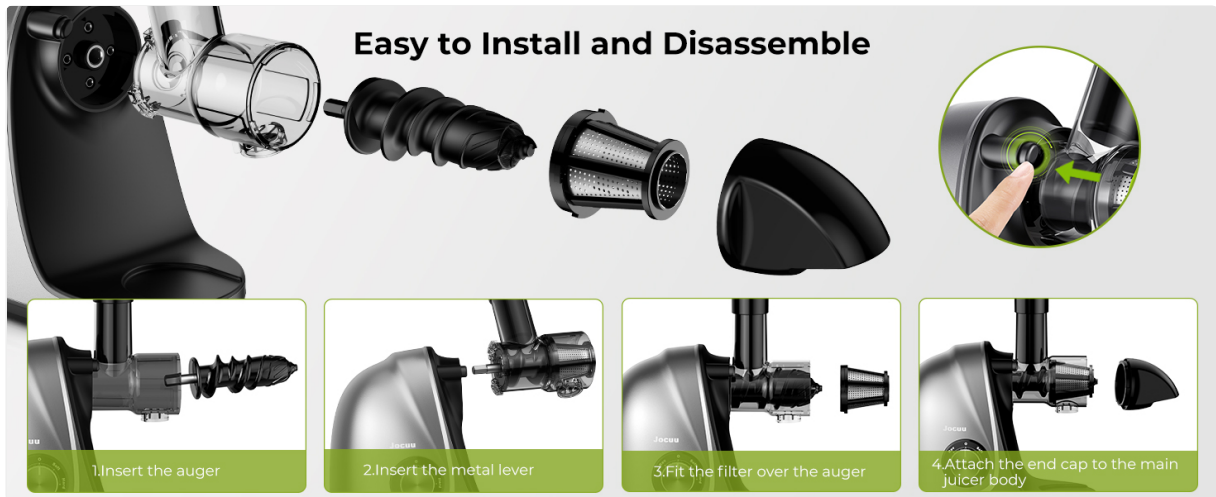

Diagram showing the easy installation and disassembly of the Jocuu juicer components.

## OPERATING INSTRUCTIONS

---

### Preparing Ingredients

Wash all fruits and vegetables thoroughly. Cut ingredients into smaller chunks (approximately 1.96 inches or smaller) to prevent clogging and ensure efficient juicing. Remove hard pits or large seeds.

# | Safe Feed Port

Preventing hand injury

## Masticating Juicer



- ✓ Safe Feed Port
- ✓ Avoid Injury
- ✓ Maximum Nutrient



- ✗ Big Feed Port
- ✗ Vulnerable to Injury
- ✗ Nutrient Loss

## Centrifugal Juicer



Cut ingredients into smaller chunks for optimal juicing and to fit the safe feed port.

## Juicing Process

Place the juice cup and pulp container under their respective spouts. Select the appropriate speed mode using the control dial:

- **Soft Mode (50-60 RPM):** Ideal for softer fruits and vegetables such as oranges, grapes, watermelon, and celery.
- **Hard Mode (100-110 RPM):** Recommended for harder ingredients like ginger, carrots, beets, and apples.

Slowly feed the prepared ingredients into the feeding chute. Use the pusher to gently guide ingredients down, but never force them.

## Reverse Function

If the juicer becomes clogged, switch the dial to the "Rev" (Reverse) position and hold for 3 seconds to clear any blockages. Release the dial to return to the "0" (Off) position before resuming juicing.

# 4-IN-1 Machine

## SLOW MASTICATING JUICER



### COARSE SHREDDER



Perfect for getting thin strips of carrots, celery, onions, fruits and potatoes.



### SLICER



Shred cucumbers, carrots, zucchini and radish into thin slices.



### FINE SHREDDER



Finely shred nuts, dry bread and cheese.



**NOTE:** These three Jocuu Slicer Shredder Attachments are not included, need to buy separately

Select Soft or Hard mode based on your ingredients for optimal juicing.

# Quiet Operation with Less Noise

Low decibel motor



The juicer operates with a quiet motor, ensuring a peaceful juicing experience.

## MAINTENANCE AND CLEANING

Regular cleaning ensures optimal performance and longevity of your juicer.

### Disassembly for Cleaning

1. Turn the juicer off and unplug it from the power outlet.
2. Remove the pusher and feeding chute.
3. Twist and unlock the end cap, then carefully remove it.
4. Remove the filter and auger from the main body.

5. Empty the juice cup and pulp container.

## | Easy to Disassemble and Clean

Equipped with a special brush to clean the filter



The juicer features a one-button disassembly design for easy cleaning.

### **Cleaning the Components**

All detachable parts are dishwasher safe. For manual cleaning, rinse all parts under running water. Use the provided cleaning brush to remove any pulp residue from the filter and other components.

## | 3 Modes to Meet Different Needs



### SOFE MODE :

50 to 60 RPM



### HARD MODE :

100 to 110 RPM



**REV MODE:** Avoid getting stuck twist to REV direction for 3 seconds

Detachable parts are dishwasher safe for convenient cleaning.

### Reassembly

Reassemble the juicer by following the setup steps in reverse order. Ensure all parts are securely locked into place before use.

### TROUBLESHOOTING

---

| Issue                          | Possible Cause  | Solution  |
|--------------------------------|---|---|
| Juicer stops during operation  | Overload protection activated;<br>Ingredients too large/hard. | Turn off, clear blockage, cut ingredients smaller, wait 20 minutes before restarting. |
| Low juice yield /<br>Wet pulp  | Incorrect speed mode;<br>Ingredients not cut properly.        | Use appropriate speed (Soft/Hard); Cut ingredients smaller.                           |
| Excessive noise /<br>Vibration | Improper assembly.  | Ensure all parts are correctly assembled and locked.                                  |

## SPECIFICATIONS

---

- **Brand:** Jocuu
- **Model Name:** Juicer Machines
- **Item Model Number:** Juicer Machines217
- **Color:** Gray
- **Product Dimensions:** 6.5"D x 15"W x 14.5"H
- **Item Weight:** 8.18 pounds
- **Maximum Power:** 150.00 Watts
- **Voltage:** 230 Volts
- **Number of Speeds:** 2 (Soft/Hard)
- **Special Features:** Overheat Protection, Quiet Motor
- **Blade Material:** Stainless Steel
- **Product Care Instructions:** Dishwasher Safe (accessories only)
- **Controller Type:** Button

## WARRANTY AND CUSTOMER SUPPORT

---

Jocuu offers comprehensive after-sales service for your juicer:

- 2-year motor coverage
- 2-year accessory replacement coverage
- Lifetime technical support
- 24-hour quality service

For any issues or inquiries, please contact Jocuu customer support through the official channels provided at the time of purchase or on the product packaging.