

## Manuals+

[Q & A](#) | [Deep Search](#) | [Upload](#)

Manuals.plus /

› [Anker](#) /

› Anker PowerWave 10 Stand with 2 USB-A Ports Multi-Device Wireless Charging Station User Manual

## Anker A2573 + A2612

# Anker PowerWave 10 Stand with 2 USB-A Ports Multi-Device Wireless Charging Station User Manual

Model: A2573 + A2612

## 1. PRODUCT OVERVIEW

---

The Anker PowerWave 10 Stand is a versatile 3-in-1 wireless charging station designed to power multiple devices simultaneously. It features a wireless charging stand for compatible smartphones and two additional USB-A ports for charging other devices. This unit supports various wireless charging speeds and allows for flexible device placement.



Image 1.1: Anker PowerWave 10 Stand with 2 USB-A Ports and included 36W DC adapter. The image highlights the two USB-A ports on the side of the charging stand.

## PowerWave 10 Stand with 2 USB-A Ports

Charge your phone wirelessly while charging 2 more devices simultaneously.

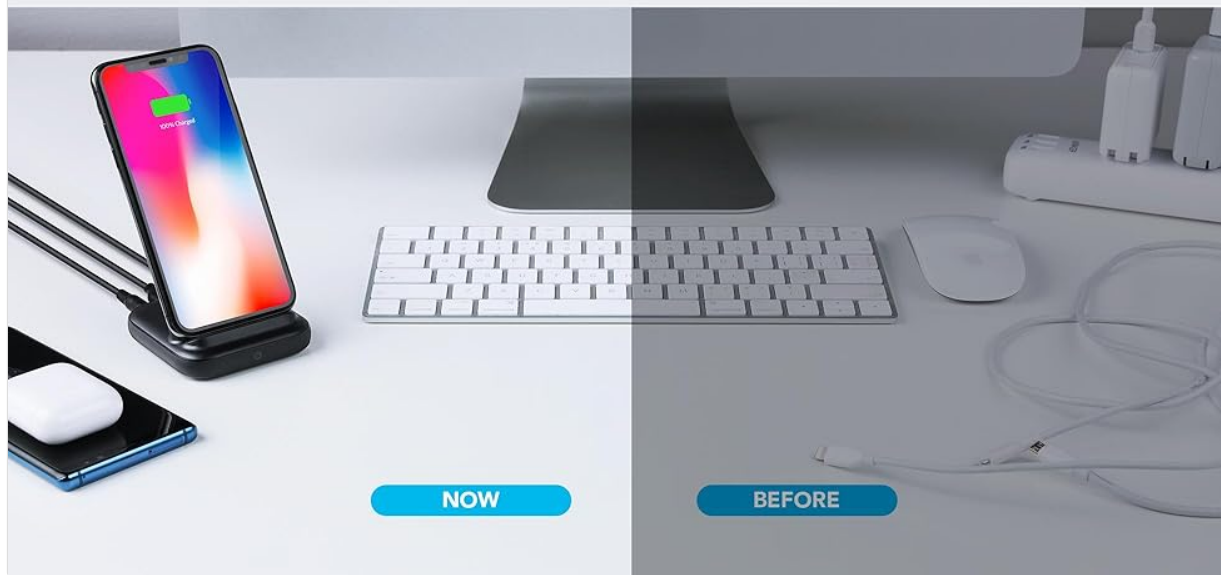

Image 1.2: This image illustrates the benefit of the PowerWave 10 Stand by comparing a desk with the charging station (labeled 'NOW') and a desk with multiple charging cables (labeled 'BEFORE'). The 'NOW' side shows a smartphone wirelessly charging on the stand, with earbuds and another device connected via USB-A ports, resulting in a tidy setup.

## 2. PACKAGE CONTENTS

Verify that all items are present in your package:

- PowerWave 10 Stand with 2 USB-A Ports
- 36W DC adapter with 5 ft cable
- Welcome Guide

## 3. SETUP INSTRUCTIONS

1. **Connect the Power Adapter:** Insert the DC connector of the 36W power adapter into the power input port on the back of the PowerWave 10 Stand.
2. **Plug into Power Outlet:** Plug the other end of the power adapter into a functional wall outlet.
3. **Power Indicator:** The LED indicator on the front of the stand will illuminate briefly, indicating that the device is powered on and ready for use.

## 4. OPERATING INSTRUCTIONS

### 4.1 Wireless Charging

Place your Qi-compatible smartphone on the charging surface of the stand. The device will begin charging automatically. The LED indicator will show the charging status.

- **10W Fast Charge Mode:** For compatible Samsung Galaxy S series (S20, S10, S9+, S9, S8, S8+, S7 edge, S7, S6 edge+) and Note series (Note 10, Note 9, Note 8, Note 7) devices.
- **7.5W Fast Charge Mode:** For compatible iPhone models (SE, 11, 11 Pro, 11 Pro Max, XS Max, XR, XS, X, 8, 8 Plus).

- **5W Standard Charge Mode:** For all other Qi-enabled phones and devices, including Pixel 3 / Pixel 3XL (may display 'Charging slowly').



Image 4.1: This image displays the Anker PowerWave 10 Stand with two smartphones, illustrating the different wireless charging speeds. One phone is shown receiving 10W charging (typical for Samsung devices), and another is shown receiving 7.5W charging (typical for iPhone devices).

## 4.2 Vertical and Horizontal Charging

The PowerWave 10 Stand supports both vertical and horizontal placement of your smartphone during wireless charging. This allows for continued use of the device, such as watching videos or checking messages, without interrupting the charging process.



Image 4.2: This image demonstrates the versatility of the Anker PowerWave 10 Stand, showing a smartphone charging vertically (suitable for social media or facial recognition) and horizontally (ideal for watching videos).

## 4.3 USB-A Port Charging

In addition to wireless charging, the stand includes two USB-A ports on the back, providing a combined output of 12W (5V/2.4A max for each port). These ports can be used to charge other devices simultaneously, such as smartwatches, earbuds, or other smartphones that are not Qi-compatible.



Image 4.3: A close-up view of the two USB-A ports located on the side of the Anker PowerWave 10 Stand, highlighting their combined 12W total output for charging additional devices.

## 4.4 Case Compatibility

The PowerWave 10 Stand is designed to charge directly through most protective cases up to 5 mm thick. This includes cases made of rubber, plastic, or TPU. Magnetic and metal attachments, or cards placed between the phone and the case, will prevent charging and should be removed.



Image 4.4: This diagram illustrates the case compatibility of the wireless charger, showing that it can charge through cases up to 5 mm thick. It also indicates that magnetic and metal attachments or cards will interfere with charging.

## 5. COMPATIBLE DEVICES

The Anker PowerWave 10 Stand is compatible with a wide range of devices:

- **Wireless Charging:** All Qi-enabled phones and devices. Specific compatible phone models include: iPhone SE / 11 / 11 Pro / 11 Pro Max / XS Max / XR / XS / X / 8 / 8 Plus; Samsung Galaxy S20 / S10 / S10+ / S10e / S9+ / S9 / S8 / S8+ / S7 edge / S7 / S6 edge+; Samsung Note 10 / Note 9 / Note 8 / Note 7; LG G7 / G7+ / V30+ / V30 / V35; Sony XZ2.
- **USB-A Ports:** Any device that charges via a standard USB-A cable, such as smartwatches, earbuds, power banks, and other smartphones.

## 6. SPECIFICATIONS

Feature	Specification
Model Number	A2573 + A2612
Input	36W 12V/3A
Wireless Output	10W (Samsung), 7.5W (iPhone), 5W (Standard Qi)
USB-A Port Output	5V/2.4A max per port, 12W total
Connectivity Technologies	Wireless + USB Connectivity
Dimensions	3.31 x 2.91 x 4.49 inches
Item Weight	15.3 ounces
Color	Black

## 7. MAINTENANCE

- **Cleaning:** Disconnect the charger from the power outlet before cleaning. Use a soft, dry cloth to wipe

the surface. Do not use corrosive cleaners or sprays.

- **Storage:** Store the device in a cool, dry place when not in use.
- **Handling:** Avoid dropping the device or subjecting it to strong impacts.

## 8. TROUBLESHOOTING

---

- **Device not charging wirelessly:**
  - Ensure your device is Qi-compatible.
  - Check that the phone is centered on the charging stand.
  - Remove any metal attachments, magnetic cases, or credit cards from your phone case.
  - Ensure your phone case is not thicker than 5 mm.
  - Verify the power adapter is securely connected to both the stand and the wall outlet.
- **Slow charging:**
  - Ensure you are using the included 36W DC adapter. Using a lower-power adapter may result in slower charging.
  - Some phone models (e.g., Pixel 3/3XL) are designed to charge at standard speeds on third-party wireless chargers.
  - Environmental factors like high temperature can affect charging speed.
- **USB-A ports not working:**
  - Ensure the PowerWave 10 Stand is properly powered on.
  - Try a different USB cable to rule out cable issues.
  - Ensure the device you are trying to charge is compatible with USB-A charging.
- **LED indicator behavior:**
  - Solid blue: Device is charging.
  - Flashing blue: Foreign object detected or device misalignment. Reposition your device or remove any obstructions.
  - No light: Stand is not powered or is in standby mode without a device charging.

## 9. SAFETY INFORMATION

---

- Do not expose the device to liquids, moisture, or extreme temperatures.
- Do not disassemble, modify, or repair the device yourself.
- Avoid placing metal objects or magnetic cards on the wireless charging surface.
- Keep out of reach of children.
- Use only the provided power adapter.

## 10. WARRANTY AND SUPPORT

---

This Anker PowerWave 10 Stand comes with a worry-free 18-month warranty. For technical support or customer service, please refer to the contact information provided in your welcome guide or visit the official Anker support website.

