

COMFEE' AM720C2RA-G

COMFEE' AM720C2RA-G Retro 0.7 Cu Ft 700W Countertop Microwave Oven User Manual

Model: AM720C2RA-G

IMPORTANT SAFEGUARDS

When using electrical appliances, basic safety precautions should be followed, including the following:

1. Read all instructions before using the appliance.
2. Do not operate the microwave oven when empty.
3. Do not heat liquids or other foods in sealed containers as they are liable to explode.
4. Do not use corrosive chemicals or vapors in this appliance.
5. Close supervision is necessary when the appliance is used by or near children.
6. Do not attempt to service or repair the appliance yourself. Contact qualified service personnel for assistance.
7. Ensure the appliance is properly grounded.
8. Do not immerse cord, plugs, or appliance in water or other liquid.
9. Do not allow the cord to hang over the edge of a table or counter, or touch hot surfaces.
10. Always ensure the turntable and roller ring are correctly positioned before operation.

PRODUCT OVERVIEW

The COMFEE' AM720C2RA-G Retro Microwave Oven combines a classic aesthetic with modern functionality. This compact 0.7 cubic feet, 700-watt microwave is designed for efficiency and ease of use in smaller living spaces.

Key Features:

- **9 Preset Menus:** Convenient options for common foods like popcorn, potato, pizza, frozen vegetable, beverage, meat, pasta, soup, and reheat.

- **10 Power Levels:** Offers flexibility for various cooking needs.
- **Position-Memory Turntable:** Ensures the turntable returns to its original position after cooking for easy removal of items.
- **Mute Function:** Allows for silent operation, ideal for quiet environments.
- **Energy Saving Eco Mode:** Reduces power consumption during standby.
- **Child Safety Lock:** Prevents unintended operation by children.
- **LED Digital Display:** Bright and easy-to-read interface.
- **30 Seconds Express Cooking:** Quick start function for immediate heating.



Figure 1: Multifunctional Control Panel. This image displays the microwave's control panel, highlighting features such as 9 pre-set programs, 10 power levels, ECO mode, Easy Defrost, and a +30 seconds quick start button.



Figure 2: 9 Pre-Set Menus. This image illustrates the nine pre-set menu options available on the microwave: Beverage, Popcorn, Vegetable, Meat, Pizza, Potato, Pasta, Soup, and Reheat.

SETUP

Unpacking and Placement:

1. Remove all packing materials and accessories. Inspect the oven for any damage such as dents or a broken door. Do not operate the oven if it is damaged.
2. Place the microwave oven on a flat, stable surface that can support its weight and the heaviest food item likely to be cooked in it.
3. Ensure adequate ventilation. Leave a minimum of 3 inches (7.5 cm) of space on the top, sides, and rear of the oven for proper airflow. Do not block any ventilation openings.
4. Keep the oven away from hot air, steam, or splashing liquids.

Turntable Assembly:

1. Place the roller ring in the center of the oven cavity.
2. Place the glass turntable on top of the roller ring, ensuring it sits securely in the center support.



Figure 3: Compact Footprint. This image shows the external dimensions of the microwave (17.3" W x 13.0" D x 10.2" H), illustrating its compact design suitable for small spaces.



Figure 4: Internal Dimensions. This image displays the internal dimensions of the microwave (11.95" W x 12.04" D x 8.11" H) and shows examples of food items that fit, such as a 10" pizza, 6 cupcakes, or 8 chicken wings.

OPERATING INSTRUCTIONS

Basic Microwave Cooking:

1. Place food in a microwave-safe container on the glass turntable.
2. Close the oven door.
3. Turn the dial to set the desired cooking time.
4. Press the 'Start/+30Sec.' button to begin cooking.
5. To adjust power levels, press the 'Microwave' button repeatedly to cycle through options before starting or during cooking.



Figure 5: Setting Cooking Time. A hand is shown turning the central dial to adjust the cooking time or select a preset menu.

Using Preset Menus:

1. Press the 'Auto Menu' button. The display will show 'A-1'.
2. Turn the dial to select the desired preset menu (A-1 to A-9). Refer to the label inside the door for

specific menu items and quantities.

3. Press the 'Start/+30Sec.' button to confirm and begin cooking.

Defrost Function:

1. Place the frozen food on the turntable.
2. Press the 'Defrost' button.
3. Turn the dial to select the weight of the food.
4. Press the 'Start/+30Sec.' button to begin defrosting.



Figure 6: Defrosting Function. This image visually demonstrates the defrosting capability, showing a frozen chicken breast on the left and a thawed one on the right.

Mute Function:

To activate or deactivate the mute function, press and hold the 'Mute' button (often indicated by a speaker icon with a slash) for 3 seconds. The display will confirm the change.



Figure 7: Mute Function in Use. A woman is shown opening the microwave door, with a sleeping cat nearby, emphasizing the quiet operation provided by the mute function.

Child Safety Lock:

The microwave features a two-step child safety lock. To activate, press the 'Stop/Clear' button three times. To deactivate, press the 'Stop/Clear' button three times again. The display will show 'LOC' when activated.

TWO-STEP CHILD LOCK

Due to changes in the applicable third-party safety standard, all manufacturers are required to add this two-step child lock safety feature to all countertop microwaves sold in the USA or Canada to comply with the standard.

HOW TO UNLOCK THE DOOR

When cooking:

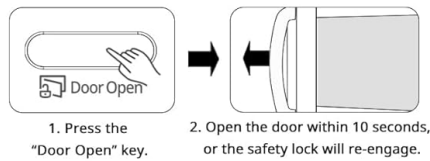

After cook:

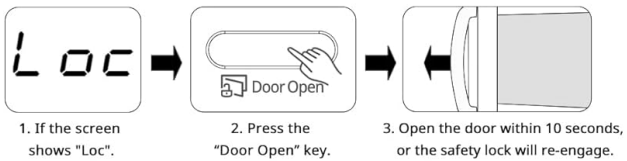

HOW TO DEACTIVATE THE SAFETY LOCK

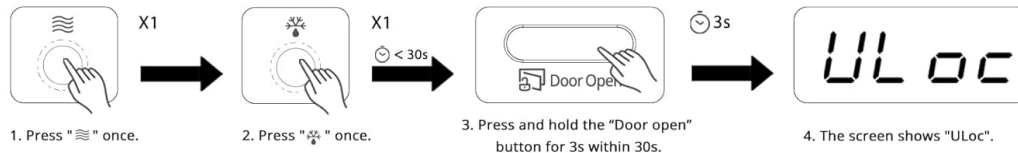

HOW TO REACTIVATE THE SAFETY LOCK

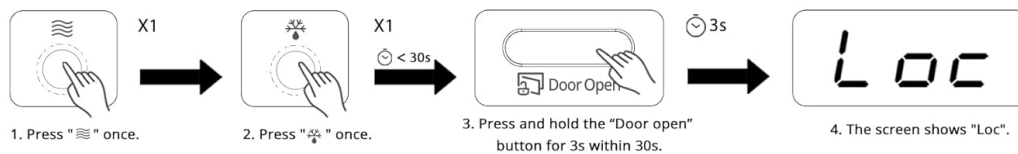

Figure 8: Two-Step Child Lock. This diagram provides visual instructions on how to activate and deactivate the child safety lock, including how to unlock the door during and after cooking, and how to deactivate/reactivate the safety lock.

MAINTENANCE AND CLEANING

Regular cleaning and maintenance will ensure the longevity and optimal performance of your microwave oven.

Cleaning the Exterior:

- Wipe the exterior with a damp cloth and mild soap.
- Avoid using abrasive cleaners or solvents.

Cleaning the Interior:

- Wipe the interior cavity with a damp cloth after each use to prevent food buildup.
- For stubborn stains, place a bowl of water with lemon slices inside and microwave for 2-3 minutes. The steam will loosen the grime, making it easier to wipe away.

Turntable and Roller Ring:

- The glass turntable and roller ring can be removed for cleaning.
- Wash them in warm, soapy water or in the dishwasher.
- Ensure they are completely dry before placing them back in the oven.

Conveniently Clean Within Seconds



Figure 9: Convenient Cleaning. This image shows three steps for cleaning the microwave: wiping the right panel, removing and cleaning the glass plate, and wiping the interior of the door.

TROUBLESHOOTING

Problem	Possible Cause	Solution
Oven will not start	Power cord not plugged in; Door not closed properly; Child lock activated.	Ensure power cord is securely plugged in; Close door firmly; Deactivate child lock.
Food not heating	Incorrect cooking time/power level; Food not microwave-safe.	Adjust time/power; Use microwave-safe cookware.
Turntable not rotating	Turntable or roller ring not positioned correctly; Obstruction.	Reposition turntable and roller ring; Remove any obstructions.
Excessive noise	Turntable or roller ring not positioned correctly; Loose parts.	Check turntable and roller ring; Contact customer support if noise persists.

SPECIFICATIONS

Feature	Detail
Model Number	AM720C2RA-G
Capacity	0.7 Cubic Feet

Feature	Detail
Wattage	700 Watts
Voltage	110 Volts
Product Dimensions (W x D x H)	17.3" x 13.0" x 10.2"
Item Weight	23.4 Pounds
Color	Green
Material	Plastic
Special Feature	Child Safety Lock
Installation Type	Countertop

WARRANTY AND SUPPORT

For warranty information and customer support, please refer to the documentation included with your product or visit the official COMFEE' website. You may also contact customer service at 866-646-4332 for additional assistance.