

Manitowoc IDT0450A-161

Manitowoc IDT0450A-161 Indigo NXT Series Modular Air-Cooled Ice Dice Cube Maker Machine

User Manual

Model: IDT0450A-161 | Brand: Manitowoc

1. INTRODUCTION

This manual provides comprehensive instructions for the installation, operation, and maintenance of the Manitowoc IDT0450A-161 Indigo NXT Series Modular Air-Cooled Ice Dice Cube Maker Machine. Designed for commercial use in environments such as hotels, restaurants, pubs, and bars, this machine is engineered to produce high-quality dice ice cubes efficiently. Please read this manual thoroughly before operating the machine to ensure safe and optimal performance.

The Manitowoc IDT0450A-161 is part of the Indigo NXT series, featuring advanced diagnostics and intelligent controls for reliable ice production.

2. SAFETY INFORMATION

Always adhere to the following safety precautions to prevent injury or damage to the equipment:

- Ensure the machine is properly grounded to prevent electrical shock.
- Disconnect power before performing any maintenance, cleaning, or service.
- Do not operate the machine with damaged cords or plugs.
- Keep hands and foreign objects away from moving parts.
- Only qualified personnel should perform installation and major repairs.
- Use only potable water for ice production.
- This product contains chemicals known to the State of California to cause cancer and birth defects or other reproductive harm.

3. PRODUCT OVERVIEW

The Manitowoc IDT0450A-161 is a modular air-cooled ice machine designed for high-volume ice production. It

produces hard, clear dice ice cubes with a 100% ice to water ratio, ensuring efficient cooling and slow melt rates.



Figure 3.1: Front-left view of the Manitowoc IDT0450A-161 Indigo NXT Ice Machine.



Figure 3.2: Front view of the Manitowoc IDT0450A-161 Indigo NXT Ice Machine, showcasing the easyTouch display.



Figure 3.3: Rear view of the ice machine, showing water inlet, drain, and air filter.



Figure 3.4: The modular ice machine shown stacked on a compatible ice storage bin (bin sold separately).

Key Features:

- **Ice Mastery:** Produces hard, clear dice ice cubes with a 100% ice to water ratio for maximum cooling efficiency and slow melt rates.
- **Smart Interface:** Features a 2.8-inch Intelligent easyTouch Display with an icon-based interface for intuitive control and programming.
- **Smart Guard:** Advanced diagnostics provide 24-hour preventative maintenance and diagnostic feedback, minimizing downtime.
- **Precision Programming:** Customizable ice making schedule based on specific on/off times or desired ice volume.
- **DuraTech Finish:** Protective coating over an aluminum alloy construction enhances durability and resists fingerprints and scratches.

Manitowoc[®] INDIGO[®] NXT

Manitowoc Indigo NXT: the next generation ice machine



Figure 3.5: The Manitowoc Indigo NXT series is designed to meet the demands of commercial beverage service.



Ice Bin Sold Separately

Figure 3.6: Important note: The ice storage bin is a separate purchase and not included with the ice machine head.



Figure 3.7: A close-up view of the clear, rhomboid-shaped dice ice cubes produced by the machine.



Figure 3.8: The machine produces full dice ice, ideal for various beverage applications.

4. SETUP AND INSTALLATION

Proper installation is crucial for the performance and longevity of your ice machine. Due to the complexity and commercial nature of this equipment, professional installation by a certified technician is highly recommended.

4.1 Unpacking and Inspection

- Carefully remove the machine from its packaging.
- Inspect for any shipping damage. Report any damage to the carrier immediately.
- Ensure all components listed in the packing list are present.

4.2 Location Requirements

- Install in a well-ventilated area with ambient temperatures between 50°F (10°C) and 90°F (32°C).
- Maintain adequate clearance around the machine for proper airflow, especially for the air intake and exhaust.
- Ensure the floor is level and capable of supporting the machine's weight (195 lbs) plus the weight of ice and any associated bin.

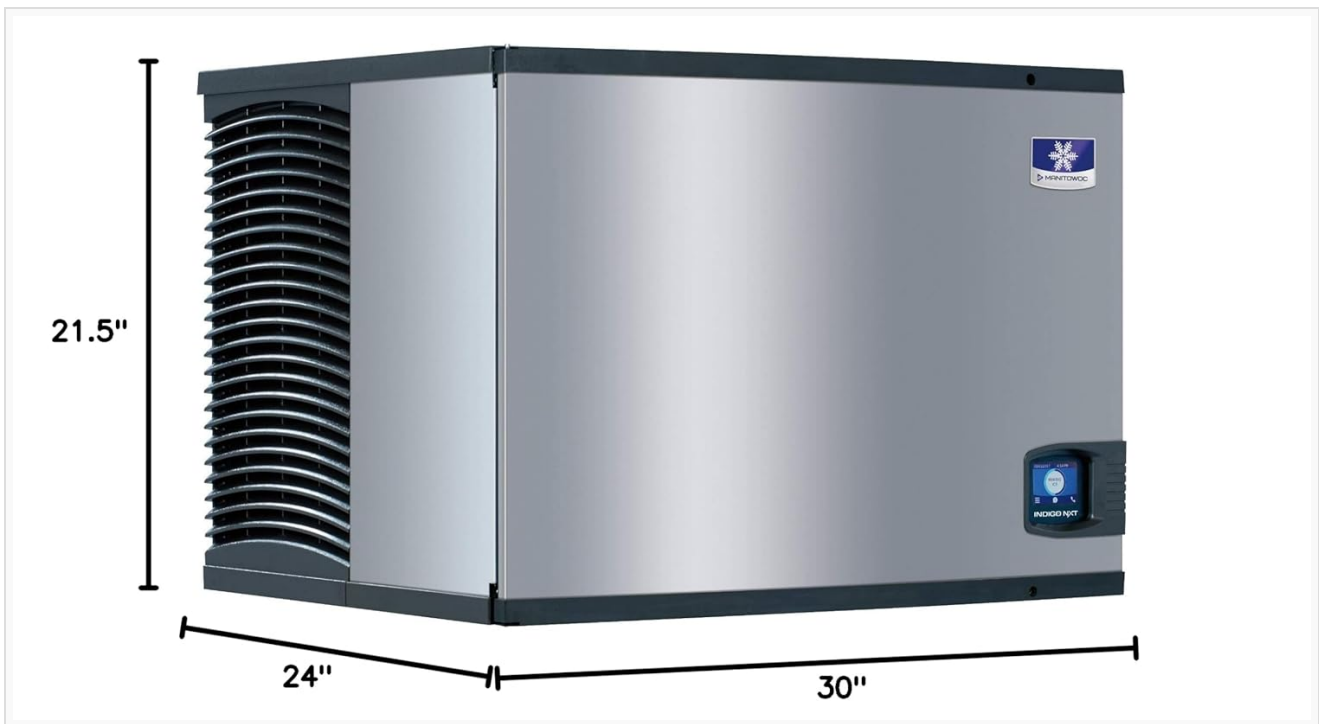

Figure 4.1: Dimensions of the Manitowoc IDT0450A-161: 24"D x 30"W x 21.5"H.

4.3 Utility Connections

- **Electrical:** Connect to a dedicated 115V power supply as specified on the machine's data plate.
- **Water:** Connect to a potable water supply with appropriate pressure and filtration.
- **Drain:** Ensure proper drainage for melted ice and wastewater.

Refer to the detailed installation guide provided with the product for specific plumbing and electrical requirements.

5. OPERATING INSTRUCTIONS

The Manitowoc IDT0450A-161 features an intuitive easyTouch Display for simple operation and programming.



Figure 5.1: The easyTouch Display provides real-time status and access to settings.



NEXT LEVEL OF SIMPLICITY



Figure 5.2: Detailed breakdown of the easyTouch Display interface, including Home Screen Status, Alerts & Messages, Asset Info, Start-Up Wizard, Lock, and Sanitation functions.

5.1 Initial Startup

- After installation, power on the machine.
- The easyTouch Display will guide you through the initial setup process using the Start-Up Wizard.
- Allow the machine to complete its first ice-making cycle. Discard the first batch of ice.

5.2 Programming Ice Production

- Access the programming menu via the easyTouch Display.
- Set desired on/off times for ice production to match your operational needs.
- Adjust ice volume settings if applicable.

5.3 Monitoring Performance

- The Home Screen Status provides real-time information on ice production.
- Check the Alerts & Messages section for any notifications or warnings.
- The Smart Guard system continuously monitors performance and provides diagnostic feedback.



Figure 5.3: Use a dedicated ice scoop for hygienic ice retrieval from the bin.

6. MAINTENANCE

Regular maintenance is essential to ensure the efficiency, hygiene, and longevity of your Manitowoc ice machine.

6.1 Daily/Weekly Cleaning

- Wipe down the exterior surfaces with a clean, damp cloth. The DuraTech finish resists fingerprints and scratches.
- Ensure the ice scoop is clean and stored hygienically.



Figure 6.1: Regularly clean the exterior surfaces of the machine.

6.2 Monthly/Quarterly Maintenance

- **Clean Air Filter:** The air filter should be cleaned regularly to maintain optimal airflow and efficiency. Remove and wash with warm, soapy water, then rinse and dry thoroughly before reinstallation.
- **Sanitation Cycle:** Utilize the machine's built-in sanitation cycle as indicated by the easyTouch Display. This helps prevent scale buildup and ensures hygienic ice production.



Figure 6.2: The evaporator plate is where ice forms and should be part of regular sanitation.

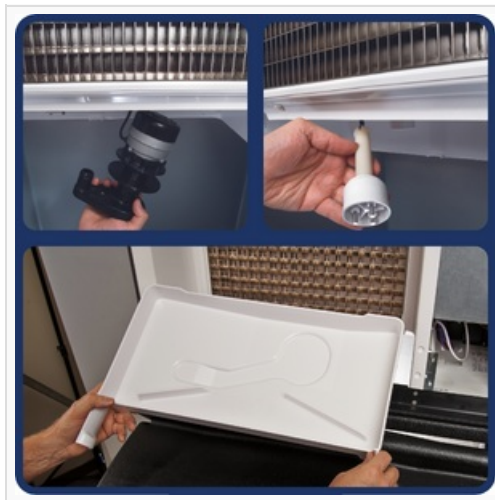

Figure 6.3: Periodic internal cleaning, including removal of components like the water tray, is necessary for thorough maintenance.

6.3 Annual Professional Service

It is recommended to have a certified Manitowoc service technician perform annual maintenance, including deep cleaning, inspection of components, and calibration.

7. TROUBLESHOOTING

The Smart Guard system provides advanced diagnostics to help identify and resolve issues. Consult the easyTouch Display for error codes and recommended actions.



Figure 7.1: The machine's diagnostic capabilities allow for easy access to information and potential software updates via USB.

Common Issues and Solutions:

- **No Ice Production:** Check power supply, water supply, and ensure the machine is not in a programmed off cycle. Consult the display for error messages.
- **Low Ice Production:** Clean the air filter, check water pressure, and ensure ambient temperature is within operating limits.
- **Poor Ice Quality:** Perform a sanitation cycle. Check water filtration system.
- **Unusual Noises:** Power off and inspect for obstructions. If noise persists, contact a service technician.

For issues not resolved by basic troubleshooting, contact Manitowoc customer support or a certified service technician.

8. SPECIFICATIONS

Specification	Value
Model Number	IDT0450A-161
Product Dimensions (D x W x H)	24" x 30" x 21.5"
Weight	195 Pounds
Ice Production Capacity	470 lb Ice/24hrs
Voltage	115v
Wattage	30 watts
Ice Type	Dice Cube
Cooling Type	Air-Cooled
Material	DuraTech Coated Steel

9. WARRANTY AND SUPPORT

For detailed warranty information, please refer to the warranty card included with your product or visit the official Manitowoc website. Warranty terms typically cover manufacturing defects for a specified period.

Customer Support:

If you require technical assistance, parts, or service, please contact Manitowoc customer support directly. Have your model number (IDT0450A-161) and serial number ready when contacting support.

You can find contact information on the official Manitowoc website or through your authorized dealer.