

Earthtec R86855

Earthtec 10-Pack Red Flat Tip Magnetic Pocket Screwdrivers R86855 Instruction Manual

Model: R86855

1. PRODUCT OVERVIEW

The Earthtec R86855 Pocket Screwdrivers are designed for precision tasks and portability. Each screwdriver features a flat tip, a magnetic top for secure screw handling, and a durable red plastic and steel construction. They are ideal for various applications requiring a compact and reliable tool.

Product Size



Figure 1: Product Dimensions. The screwdriver measures 5.4 inches in total length, with a 2.84-inch handle and a 2.58-inch shaft and tip.

Key features include:

- **Compact Size:** Total length of 5.4 inches, designed for easy portability.
- **Magnetic Tip:** Securely holds small screws, preventing loss and simplifying work.
- **Durable Construction:** Made from quality plastic and steel for long-lasting performance.
- **Pocket Clip:** Allows for convenient carrying in a shirt or pant pocket.
- **High Visibility:** Bright red color makes the screwdriver easy to locate.

2. SETUP AND UNBOXING

Your Earthtec Pocket Screwdrivers come individually packaged to ensure protection during transit. No assembly is required.

1. Carefully remove each screwdriver from its protective packaging.
2. Inspect each screwdriver for any visible damage. If any damage is found, contact customer support.
3. The screwdrivers are ready for immediate use.

Your browser does not support the video tag.

Video 1: Unboxing and initial inspection of the Earthtec Pocket Screwdriver. This video demonstrates the product's appearance and packaging.

3. OPERATING INSTRUCTIONS

These pocket screwdrivers are designed for various light-duty tasks, particularly with flat-head screws and as a mini pry tool.

3.1 Using the Flat Tip

- Align the flat tip of the screwdriver with the slot of the screw head.
- Apply gentle downward pressure and rotate the screwdriver clockwise to tighten, or counter-clockwise to loosen.
- Ensure the tip is fully engaged in the screw slot to prevent stripping.

Use of the product

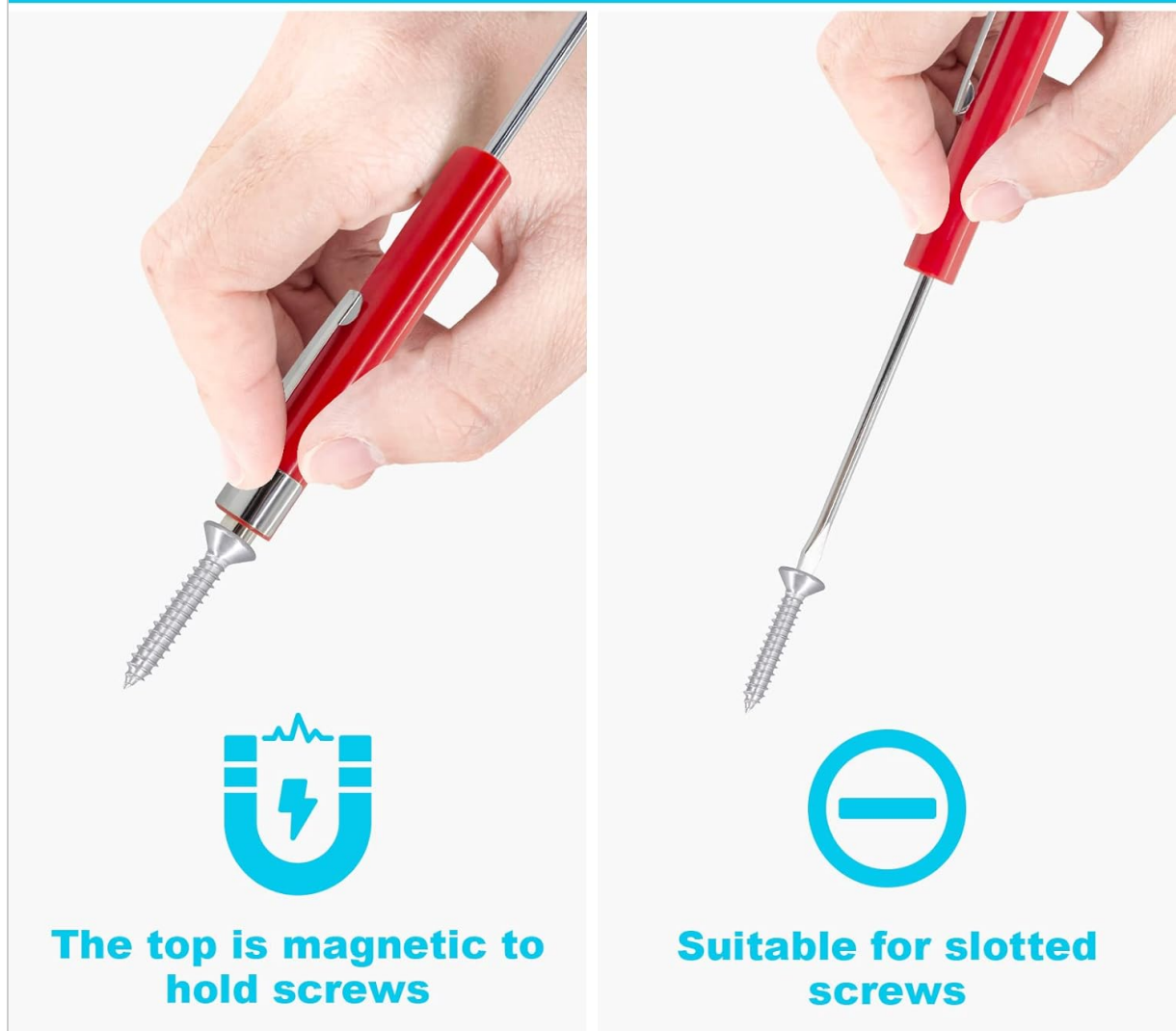

Figure 2: Magnetic Tip and Flat Tip Use. The image illustrates the magnetic tip holding a screw and the screwdriver's application for slotted screws.

3.2 Utilizing the Magnetic Tip

The magnetic tip helps in handling small metal screws. Simply touch the tip to the screw head, and the

magnetic force will hold it in place, making it easier to start or retrieve screws in confined spaces.

3.3 Carrying with the Pocket Clip

The integrated pocket clip allows you to conveniently carry the screwdriver in your shirt or pant pocket, ensuring it's always accessible when needed.



Figure 3: Pocket Clip Functionality. The screwdriver is shown clipped into a pocket for easy transport.

3.4 General Applications

These screwdrivers are suitable for tasks such as:

- Tightening or loosening flat-head screws in electronics, small appliances, or automotive interiors.
- As a mini pry tool for delicate components or electrical clips.
- Retrieving small metal objects due to the magnetic tip.



Figure 4: Versatile Applications. Examples of the screwdriver being used for electronics repair, machinery, and automotive tasks.

4. MAINTENANCE AND CARE

Proper maintenance ensures the longevity and performance of your Earthtec Pocket Screwdrivers.

- **Cleaning:** Wipe the metal shaft and tip with a clean, dry cloth after each use to remove dirt, grease,

or debris.

- **Storage:** Store screwdrivers in a dry place to prevent rust. The included screwdriver bag can be used for organized storage.
- **Inspection:** Periodically check the tip for wear or damage. A worn tip can lead to screw stripping.
- **Magnetic Tip Care:** Avoid exposing the magnetic tip to strong demagnetizing fields, which could reduce its effectiveness.

5. TROUBLESHOOTING

If you encounter issues while using your screwdriver, consider the following common solutions:

- **Screw Slipping:** Ensure the screwdriver tip is correctly sized for the screw slot and fully engaged. Apply firm, consistent downward pressure while turning.
- **Magnetic Tip Not Holding:** The magnetic force may weaken over time or with exposure to strong magnetic fields. Ensure the screw is made of a ferrous material for magnetic attraction.
- **Difficulty Reaching Screws:** For very deep or obstructed screws, a longer shaft screwdriver may be required. These pocket screwdrivers are designed for accessibility in tight spaces but have a limited reach.

6. SPECIFICATIONS

Feature	Detail
Brand	Earthtec
Model Number	R86855
Head Style	Flat Tip
Material	Alloy Steel, Plastic Handle
Color	Red
Special Feature	Magnetic Tip, Pocket Clip
Total Length	Approximately 5.4 inches
Item Weight (each)	Approximately 0.38 ounces (3.84 ounces for 10-pack)
Package Quantity	10 Screwdrivers

7. WARRANTY AND SUPPORT

For any questions, concerns, or support regarding your Earthtec Pocket Screwdrivers, please contact the seller or manufacturer directly through your purchase platform. Please refer to your purchase documentation for specific warranty details, if applicable.

