

[manuals.plus](#) /

› [COSOOS](#) /

› [MiBOXER 8-Bay Smart Battery Charger User Manual](#)

COSOOS c8 battery charger

MiBOXER 8-Bay Smart Battery Charger User Manual

Model: c8 battery charger

1. PRODUCT OVERVIEW

The MiBOXER 8-Bay Smart Battery Charger is designed for efficient and safe charging of various rechargeable cylindrical batteries. It features an automatic LCD display that provides real-time charging data and multiple safety protections.

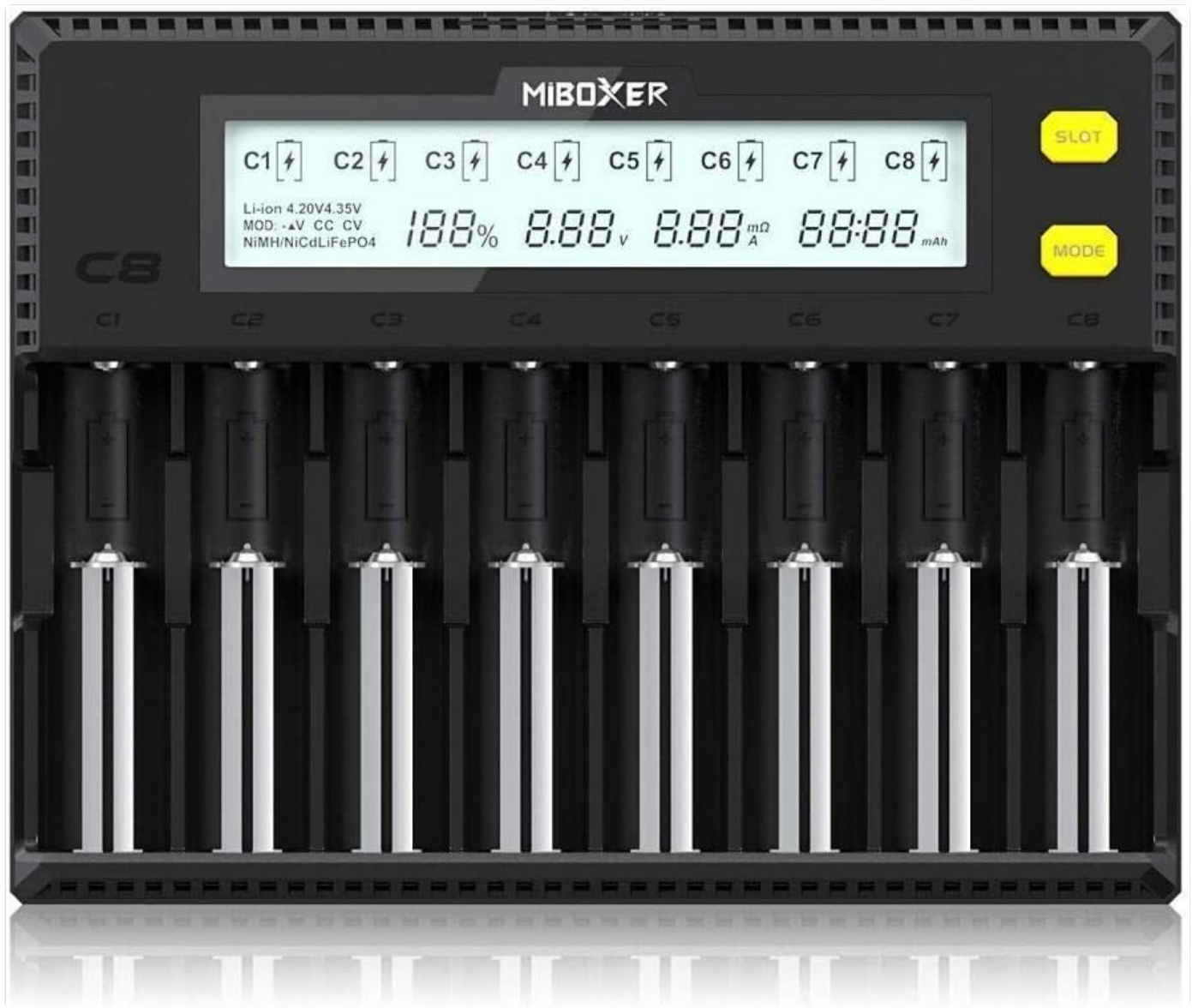

Figure 1.1: Front view of the MiBOXER 8-Bay Smart Battery Charger, showing the LCD display and eight individual battery slots.

2. SAFETY INFORMATION

To ensure safe operation and prolong the life of your charger and batteries, please observe the following safety guidelines:

- The charger is constructed from PC Fire retardant material, designed for enhanced safety and heat dissipation.
- The charger includes electronic circuit design to prevent damage from improper use.
- In case of battery reversal or short-circuit, the LCD display will show an error symbol, and charging will automatically cease.
- The smart charger automatically stops charging once batteries are fully charged to prevent overcharging.
- The charger can activate over-discharged batteries. However, if a battery is damaged, the LCD will indicate an error, and charging will stop.
- Ensure proper ventilation around the charger during operation.
- Do not attempt to charge non-rechargeable batteries.

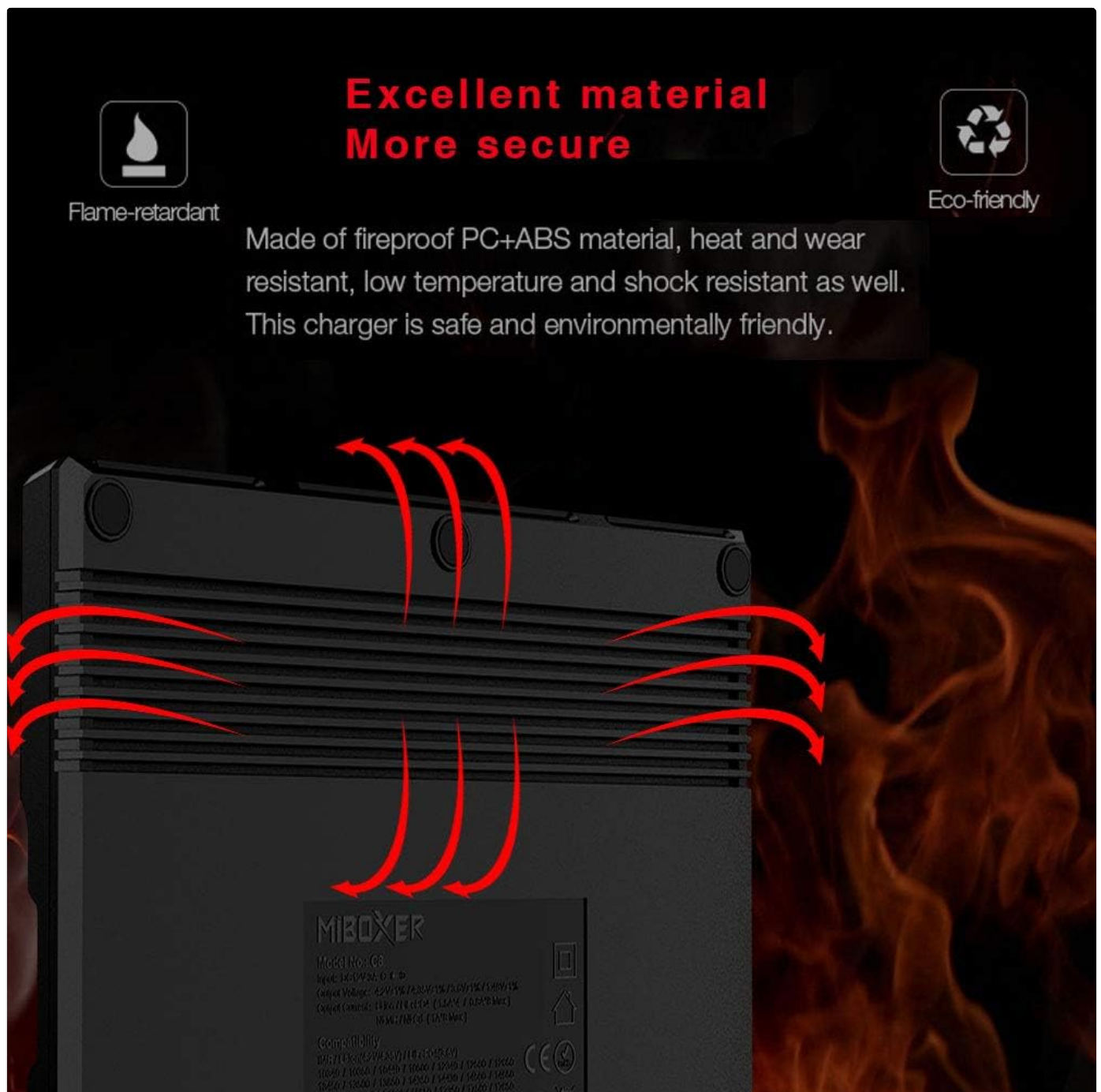

Figure 2.1: Illustration of the charger's flame-retardant material and heat dissipation design, emphasizing safety and durability.

3. PACKAGE CONTENTS

Upon opening the package, verify that all items listed below are present:

- 1 x MiBOXER 8-Bay Smart Battery Charger (Batteries not included)
- 1 x Power Adapter
- 1 x User Manual

Package Content

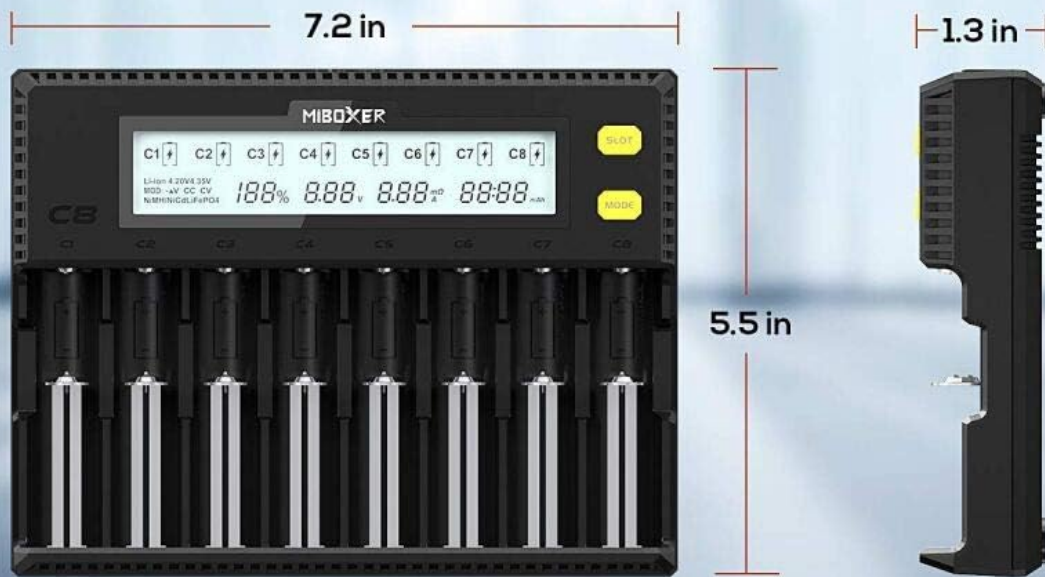

1 x Smart Battery Charger (Battery not included)
1 x US Wall Charger Cable
1 x User Manual



Figure 3.1: Contents of the MiBOXER Smart Charger package, including the charger unit, power adapter, and user manual.

4. PRODUCT FEATURES

The MiBOXER Smart Battery Charger offers a range of advanced features for optimal battery charging:

- **8-Bay Independent Charging:** Charges up to eight different types of cylindrical batteries simultaneously without affecting each other.
- **Automatic LCD Display:** Large screen displays real-time information including voltage, current, charging time, mode, battery type, internal resistance, and charged capacity. The backlight dims after 1 minute of inactivity.
- **Fast Charging:** Single-channel charging current can be set up to 1.5A maximum.
- **Intelligent Current Selection:** Automatically or manually selects the optimum charge current for inserted batteries.
- **Battery Activation:** Capable of activating over-discharged batteries.
- **Comprehensive Protection:** Includes protection against reverse polarity, short-circuiting, and overheating. Automatically stops charging upon full charge or detection of a damaged battery.
- **Wide Compatibility:** Supports a broad range of Li-ion, LiFePO4, Ni-MH, and Ni-Cd battery types.

- **Dual Power Input:** Supports DC 12V/3A input, allowing for car charging (car charger not included).



Figure 4.1: Visual representation of key features including automatic repair for "0V" batteries, short circuit protection, automatic current selection, overheat protection, battery capacity measurement, and the 8-slot design.

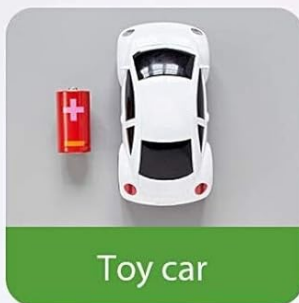

Toy car



wireless mouse



Flashlight



Clock



Remote control



Electric shaver



Microphone



Camera

MiBOXER

Charger battery application



C8 SMART CHARGER



Figure 4.2: Examples of common applications for batteries charged by the MiBOXER charger, such as toy cars, wireless mice, flashlights, and cameras.



Figure 4.3: The charger's compatibility with DC 12V car charging, offering portability (car charger sold separately).

5. SETUP

Follow these steps to set up your MiBOXER Smart Battery Charger:

1. Unpack the charger and all accessories from the box.
2. Connect the provided power adapter to the DC 12V/3A input port on the back of the charger.
3. Plug the power adapter into a standard wall outlet. The LCD display will illuminate.
4. Carefully insert rechargeable batteries into the charging slots, ensuring correct polarity (positive (+) and negative (-) terminals align with the markings in the slots). The charger will automatically detect the battery type for Li-ion (4.2V) and Ni-MH/Ni-Cd (1.48V) batteries.

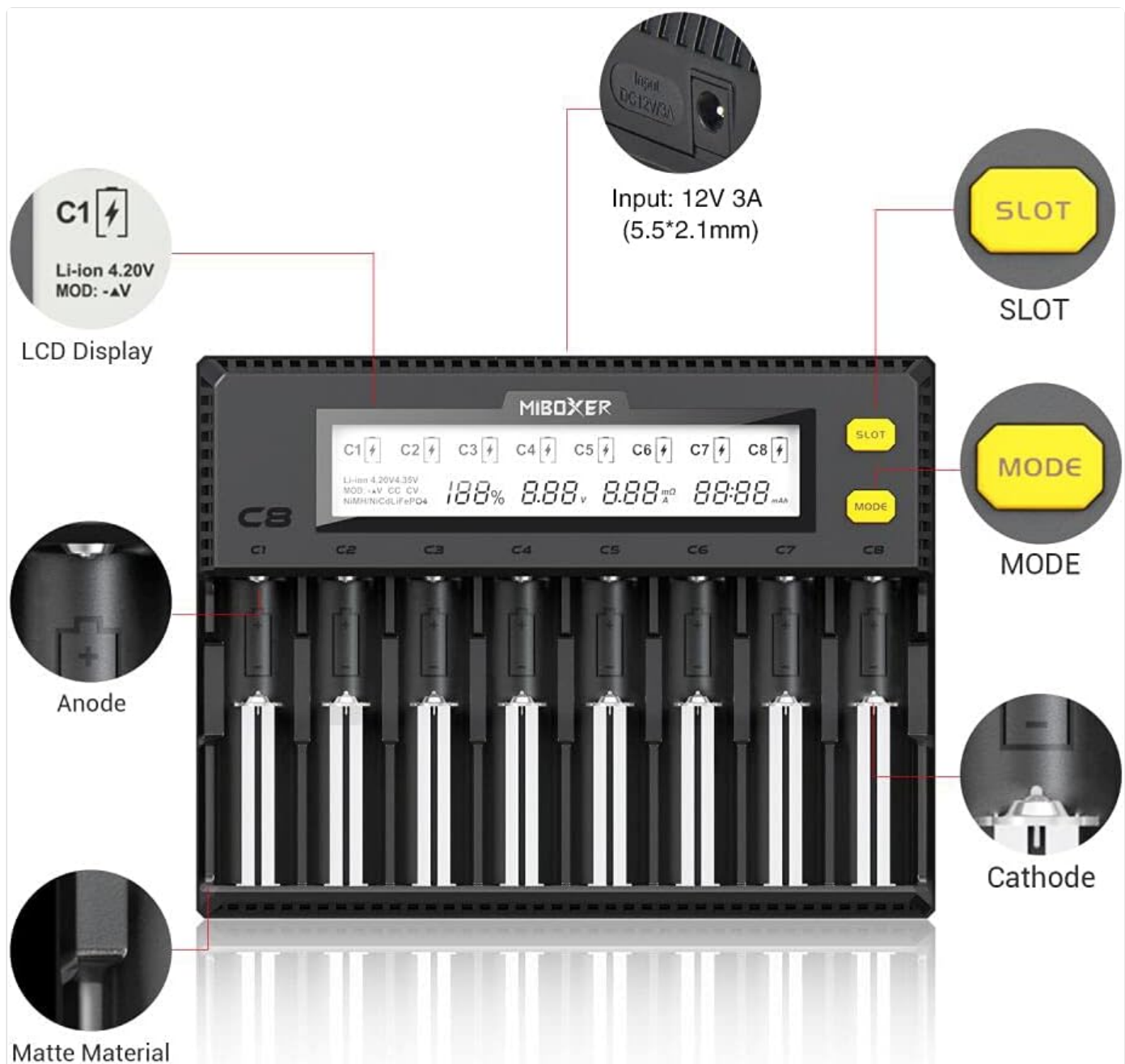

Figure 5.1: Detailed diagram showing the input port, LCD display, battery anode and cathode contacts, and the 'SLOT' and 'MODE' buttons.

6. OPERATION

Operating the MiBOXER Smart Battery Charger is intuitive:

6.1. Automatic Battery Detection

For Li-ion (4.2V) and Ni-MH/Ni-Cd (1.48V) batteries, the charger will automatically detect the battery type and begin charging. The LCD will display relevant charging information.

6.2. Manual Battery Type Selection

For Li-ion (4.35V) and LiFePO4 (3.6V) batteries, you need to manually select the battery type:

1. Insert the battery into the desired slot.
2. Press the **SLOT** button to select the corresponding channel (C1-C8).
3. Press and hold the **MODE** button to cycle through the battery types (Li-ion 4.35V, LiFePO4 3.6V). Release the button when the correct type is displayed.

4. The charger will then begin charging with the selected parameters.

6.3. Understanding the LCD Display

The LCD provides detailed information for each charging slot:

- **Voltage (V):** Current voltage of the battery.
- **Current (A/mA):** Charging current being applied.
- **Charging Time:** Duration of the current charging cycle.
- **Mode:** Indicates the charging mode (e.g., CC for Constant Current, CV for Constant Voltage).
- **Battery Type:** Displays the detected or selected battery chemistry (e.g., Li-ion, Ni-MH, LiFePO4).
- **Internal Resistance:** Shows the internal resistance of the battery.
- **Capacity (mAh):** Displays the accumulated charged capacity.
- **Percentage (%):** Indicates the approximate charge level.

7. BATTERY COMPATIBILITY

The MiBOXER Smart Battery Charger is compatible with a wide range of cylindrical rechargeable batteries:

7.1. Li-ion / IMR / INR / ICR / LiFePO4 (3.6V) Batteries

10340, 10350, 10440, 10500, 12340, 12500, 12650, 13450, 13500, 13650, 14350, 14430, 14500, 14650, 16500, 16340 (RCR123), 16650, 17350, 17500, 17650, 17670, 18350, 18490, 18500, 18650, 18700, 20700, 21700 (up to 73mm long), 22500, 22650, 25500, 26500, 26650.

7.2. Ni-MH / Ni-Cd (1.48V) Batteries

AA, AAA, AAAA, C, SC.

Wide Compatible, Convenient Choice

Li-ion (4.2V/4.35V) / LiFePO4 (3.6V)

10340 10350 10440 10500 12340 12500 12650 13450 13500 13650 14350 14430
14500 14650 16500 16650 17350 17500 17650 17670 18350 18490 18500 **18650**
18700 20700 **21700** 22500 22650 25500 26500 26650 16340(RCR123)

Ni-MH / Ni-Cd (1.48V)

A / AA / AAA / AAAA / C / SC



MiBOXER

Figure 7.1: Visual guide to the extensive range of Li-ion and Ni-MH/Ni-Cd battery sizes compatible with the charger.

8. TROUBLESHOOTING

If you encounter issues with your MiBOXER Smart Battery Charger, refer to the following common problems and solutions:

Problem	Possible Cause	Solution
LCD shows error symbol / Charging stops unexpectedly	Battery inserted with reversed polarity. Battery is short-circuited. Battery is damaged.	Ensure battery polarity is correct. Remove the battery and check for external damage or shorting. Replace the damaged battery.

Problem	Possible Cause	Solution
Battery not charging (no display activity)	Charger not powered. Battery is severely over-discharged. Incorrect battery type selected (for manual types).	Check power adapter connection and wall outlet. The charger may attempt to activate over-discharged batteries; allow time. If activation fails, the battery may be unrecoverable. Ensure correct battery type is manually selected for Li-ion (4.35V) or LiFePO4.
LCD backlight dims quickly	Normal operation.	The LCD backlight is designed to dim after 1 minute of inactivity to save power. This is not a fault.

9. SPECIFICATIONS

Key technical specifications for the MiBOXER 8-Bay Smart Battery Charger:

- **Model:** c8 battery charger
- **Brand:** COSOOS
- **Product Dimensions:** 7.2 x 5.5 x 1.3 inches (18.3 x 14 x 3.3 cm)
- **Item Weight:** 13.4 ounces (0.38 kg)
- **Input Voltage:** DC 12V/3A
- **Output Voltage:** 1.48V (Ni-MH/Ni-Cd), 4.2V (Li-ion), 4.35V (Li-ion), 3.6V (LiFePO4)
- **Max Charging Current:** 1.5A per channel (user selectable/automatic)
- **Material:** PC Fire retardant material
- **Number of Bays:** 8 independent charging bays

10. WARRANTY AND SUPPORT





For product support, technical assistance, or warranty inquiries, please contact the manufacturer, COSOOS. Refer to the product packaging or the official COSOOS website for the most current contact information. COSOOS is committed to providing quality products and customer satisfaction. Please retain your purchase receipt for warranty purposes.

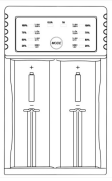
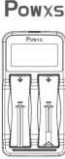

© 2023 COSOOS. All rights reserved.
MiBOXER is a trademark of its respective owner.

Related Documents - c8 battery charger

	<p>Dlyfull M4S Battery Charger User Manual</p> <p>User manual for the Dlyfull M4S battery charger, detailing its features, specifications, operating instructions, and protection functions for various rechargeable battery types.</p>
--	---

 <p>The image is a photograph of a Smart Universal Battery Charger. It is a white, rectangular device with two vertical slots for inserting batteries. The top of the device has a digital display and several buttons. The text 'Smart Universal Battery Charger' is printed at the top.</p>	<p>Smart Universal Battery Charger User Manual</p> <p>User manual for the Smart Universal Battery Charger, detailing its features, specifications, charging modes, and compatibility with various battery types.</p>
 <p>The image is a photograph of a POWXS Universal Battery Charger. It is a white, rectangular device with two vertical slots for inserting batteries. The top of the device has a digital display and several buttons. The text 'POWXS' is printed at the top.</p>	<p>POWXS Universal Battery Charger User Manual</p> <p>User manual for the POWXS universal battery charger, detailing specifications, compatible batteries, features, usage instructions, safety precautions, and warranty information.</p>
 <p>The image is a photograph of a POWXS Battery Charger. It is a white, rectangular device with two vertical slots for inserting batteries. The top of the device has a digital display and several buttons. The text 'POWXS' is printed at the top.</p>	<p>POWXS Battery Charger User Manual - Features, Specifications, and Safety Instructions</p> <p>Comprehensive user manual for the POWXS intelligent battery charger. Learn about its features, specifications, how to use it, capacity testing, and important safety guidelines for charging Li-ion, Ni-MH, and Ni-Cd batteries.</p>
 <p>The image is a photograph of a LiitoKala Lii-402 Battery Charger. It is a white, rectangular device with two vertical slots for inserting batteries. The top of the device has a digital display and several buttons. The text 'LiitoKala' is printed at the top.</p>	<p>LiitoKala Lii-402 Battery Charger User Manual</p> <p>User manual for the LiitoKala Lii-402 battery charger, detailing its features, specifications, functions, and safety precautions for charging various battery types.</p>
 <p>The image is a photograph of a LiitoKala Lii-100 Smart Multifunctional Battery Charger. It is a white, rectangular device with two vertical slots for inserting batteries. The top of the device has a digital display and several buttons. The text 'LiitoKala' is printed at the top.</p>	<p>LiitoKala Lii-100 Smart Multifunctional Battery Charger User Manual</p> <p>User manual for the LiitoKala Lii-100, a smart multifunctional battery charger. Learn about its features, operations, and specifications for charging various battery types.</p>