

## UBeesize TBC001

# UBeesize 12 inch Ring Light with Stand User Manual

Model: TBC001 | Brand: UBeesize

## INTRODUCTION

Thank you for choosing the UBeesize 12 inch Ring Light with Stand. This versatile lighting solution is designed to enhance your live streams, makeup tutorials, YouTube videos, and photography by providing optimal illumination. This manual provides detailed instructions for setup, operation, maintenance, and troubleshooting to ensure you get the most out of your device.

## SAFETY INFORMATION

- Do not expose the device to water or excessive humidity.
- Keep away from heat sources and direct sunlight.
- Use only the provided power cable and adapter.
- Ensure the tripod is stable on a flat surface before attaching the ring light or phone.
- Do not attempt to disassemble or repair the device yourself. Contact customer support for assistance.

## WHAT'S IN THE BOX

- 12 inch Ring Light
- Extendable Tripod Stand (up to 50 inches)
- Phone Holder
- USB Power Cable with Controller
- Bluetooth Remote Control (1 Lithium Metal battery included)

## SETUP INSTRUCTIONS

### 1. Assemble the Tripod:

Unfold the tripod legs and extend them to your desired height. Ensure the legs are fully spread for maximum stability.

# HIGHLY ADJUSTABLE TRIPOD

Place it on the floor or table



*Image: The UBeesize tripod demonstrating its adjustable height from a compact 15.7 inches for tabletop use to an extended 62 inches for standing setups.*

## 2. Attach the Ring Light:

Securely screw the ring light onto the top of the tripod stand. Ensure it is tightened to prevent wobbling.



*Image: The complete UBeeSize 12 inch ring light setup, showing the ring light mounted on the tripod stand with the phone holder in the center, and the wired controller.*

### 3. Install the Phone Holder:

The phone holder is designed to be placed within the center of the ring light. Adjust the holder to securely grip your smartphone. It supports phones from 2.7 to 5.3 inches wide.

# WIDE COMPATIBILITY

Suitable for all cellphones



*Image: A close-up of the versatile phone holder, demonstrating its 360-degree rotation and adjustable width (2.7"-5.3") to accommodate various smartphone models.*

#### 4. Connect Power:

Plug the USB power cable into a compatible USB power source (e.g., wall adapter, power bank, computer USB port). The integrated controller is on the cable.

## OPERATING INSTRUCTIONS

#### 1. Power On/Off:

Press the 'On/Off' button on the inline controller to turn the ring light on or off.

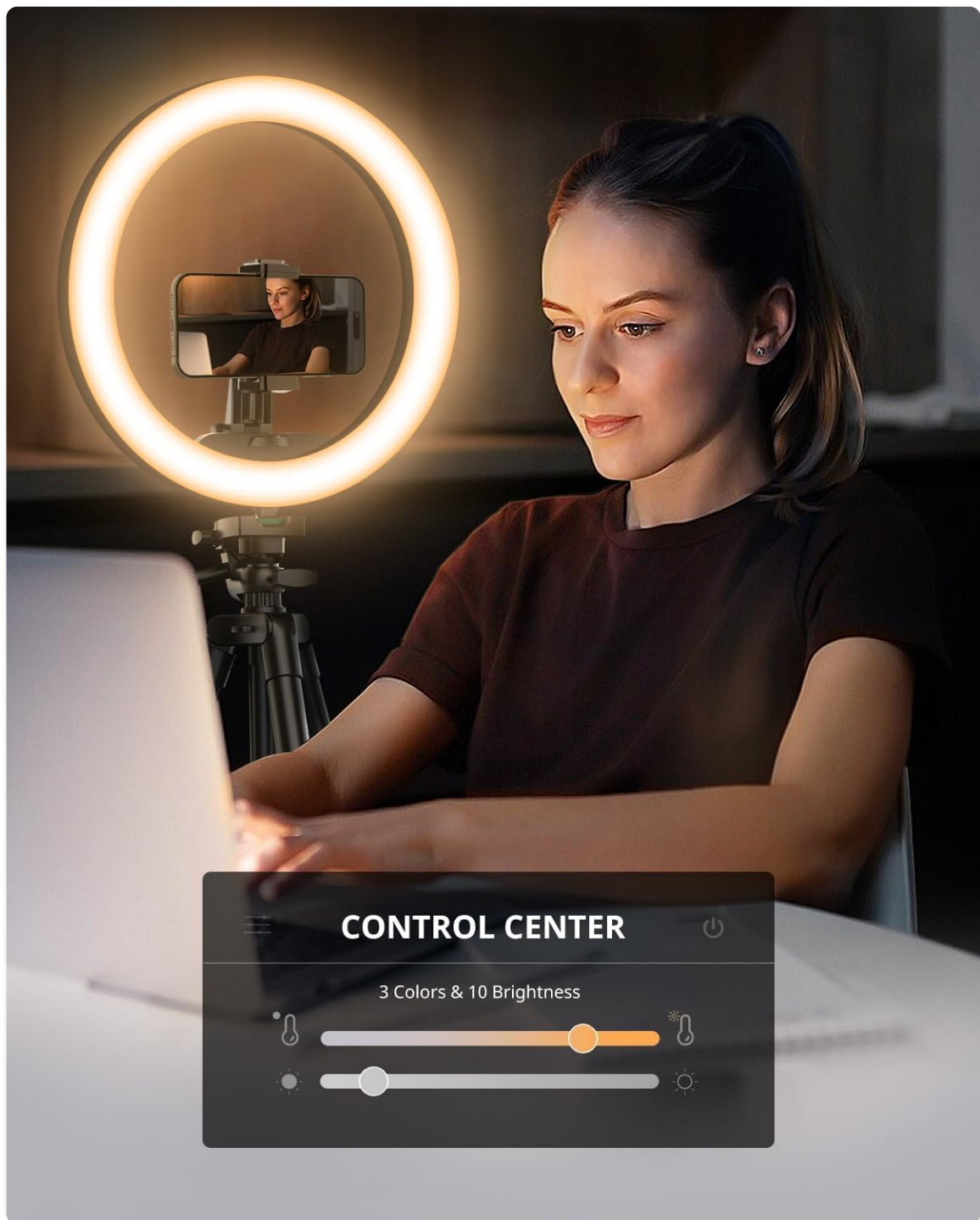

*Image: The control center for the UBeesize ring light, illustrating options for adjusting light color temperature and brightness levels.*

## 2. **Adjust Brightness:**

Use the '+' and '-' buttons on the controller to increase or decrease the brightness. There are 10 levels of brightness available.

## 3. **Change Color Temperature:**

Press the 'Mode' button (circular arrow icon) to cycle through the three light colors: Warm, Cool White, and Daylight.



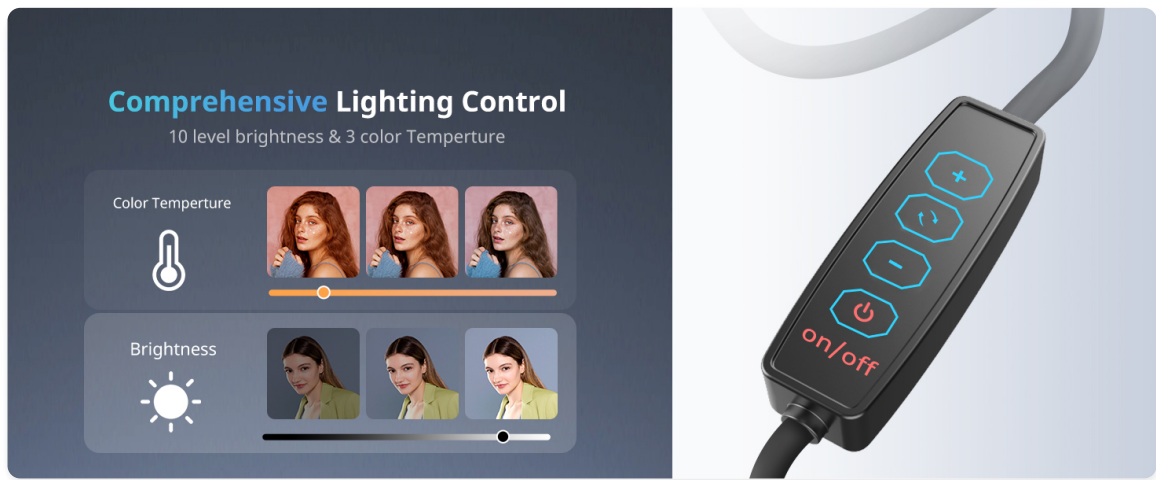

*Image: A visual representation of the comprehensive lighting control, showing options for 10 brightness levels and 3 color temperatures (Warm, Cool White, Daylight).*

#### 4. Adjust Angle:

The 3-way pan head allows for tilt and swivel motion. Loosen the handle to adjust the ring light to any desired angle (portrait or landscape) for optimal lighting. Tighten the handle to secure the position.

# FLEXIBLE ANGLE ADJUSTMENT

More range of motion



*Image: The UBeeSize ring light demonstrating its flexible angle adjustment capabilities, including 360-degree rotation, 90-degree tilt, and 180-degree swivel for various shooting needs.*

## 5. Using the Bluetooth Remote Control:

Pair the Bluetooth remote control with your smartphone to remotely trigger photos or start/stop video recording. This allows for hands-free operation.

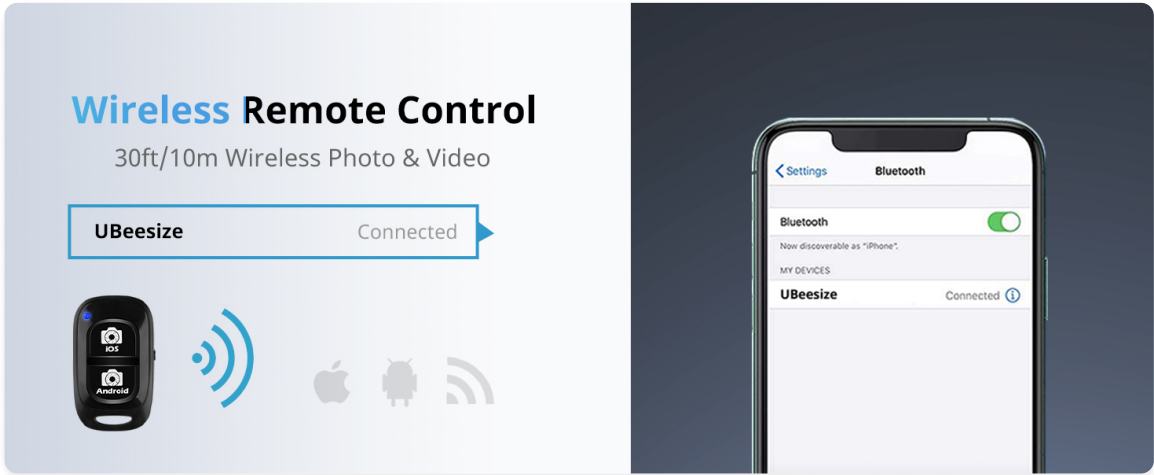

Image: The wireless remote control for the UBeeSize ring light, showing its compatibility with iOS and Android devices for remote photo and video capture.

MAINTENANCE

- Clean the ring light and tripod with a soft, dry cloth.
- Avoid using abrasive cleaners or solvents.
- Store the device in a cool, dry place when not in use.
- Ensure all parts are securely fastened before each use.

TROUBLESHOOTING

Problem	Possible Cause	Solution
Ring light does not turn on.	No power supply or loose connection.	Ensure USB cable is securely plugged into a power source. Try a different USB port or adapter.
Light is too dim or too bright.	Brightness level needs adjustment.	Use the '+' or '-' buttons on the inline controller to adjust brightness.
Phone holder is unstable.	Phone not securely gripped or holder not tightened.	Ensure phone is centered and gripped firmly. Tighten all adjustment knobs on the phone holder and tripod head.
Bluetooth remote not connecting.	Remote not paired or battery low.	Ensure Bluetooth is enabled on your phone and the remote is in pairing mode. Check remote battery.

SPECIFICATIONS

- **Product Dimensions:** 30 x 30 x 60 inches
- **Item Weight:** 1.19 pounds
- **Model Number:** TBC001
- **Batteries:** 1 Lithium Metal battery required (included for remote)
- **Connectivity Technology:** USB







- **Brand:** UBeesize
- **Manufacturer:** UBeesize
- **Country of Origin:** China

## WARRANTY AND SUPPORT

For warranty information and customer support, please refer to the official UBeesize website or contact their customer service directly. A digital version of the user manual is also available for download: [User Manual \(PDF\)](#).

### Related Documents - TBC001

<div> <div> 10" Ring Light with Tripod Stand Contact us: customercare@ubeesize.com </div>  <div> Instruction Manual </div> </div>	<div> <a href="#">UBeesize 10-Inch Ring Light with Tripod Stand: Instruction Manual</a> </div> <p>Comprehensive guide for the UBeesize 10-inch Ring Light with Tripod Stand, covering setup, operation, lighting modes, and Bluetooth remote shutter usage for photography and videography.</p>
<div> <div> 10.2" Ring Light with Tabletop Tripod </div>  <div> Operating Instructions </div> </div>	<div> <a href="#">UBeesize 10.2" Ring Light with Tabletop Tripod - Operating Instructions</a> </div> <p>Operating instructions for the UBeesize 10.2-inch Ring Light with Tabletop Tripod, covering setup, lighting modes, and phone holder attachment for content creators.</p>
<div>  </div>	<div> <a href="#">UBeesize 12-Inch Ring Light with 62-Inch Tripod Stand User Manual</a> </div> <p>This user manual provides instructions for the UBeesize 12-inch LED ring light and 62-inch tripod stand, detailing setup, assembly, phone holder attachment, lighting modes, and package contents.</p>
<div>  </div>	<div> <a href="#">UBeesize 62-inch Selfie Stick Tripod with Bluetooth Remote - User Guide</a> </div> <p>Learn how to set up and use your UBeesize 62-inch selfie stick tripod with Bluetooth remote for capturing photos and videos. Includes setup instructions, pairing guide, and feature descriptions.</p>
<div> <div> <b>UBeesize®</b> 10" Ring Light with Tripod TR50 customercare@ubeesize.com </div>  <div> Operating Instructions </div> </div>	<div> <a href="#">UBeesize 10" Ring Light with Tripod TR50 Operating Instructions</a> </div> <p>Comprehensive operating instructions and user guide for the UBeesize 10-inch Ring Light with Tripod TR50. Learn how to set up, use, and attach accessories for photography, vlogging, and live streaming.</p>



### [UBeesize 67-inch Selfie Stick Tripod with Bluetooth Remote - Features and Setup Guide](#)

Discover the UBeesize 67-inch Selfie Stick Tripod with Bluetooth Remote. This guide details its setup, features like adjustable height, phone holder compatibility, and tripod stability, making it ideal for photography and videography.