

## Iseebiz ISB-ZZL-0035

# Iseebiz Automatic Pet Feeder with Camera User Manual

MODEL: ISB-ZZL-0035

Iseebiz®

Your trusted companion for pet feeding and monitoring.

## Product Overview

The Iseebiz Automatic Pet Feeder with Camera is designed to provide convenient and reliable feeding for your pets, even when you are away. Featuring a 6-liter capacity, app control, 2-way audio, video recording, and compatibility with Alexa, this smart feeder ensures your pet's nutritional needs are met while allowing you to stay connected.



*Image: The Iseebiz 6L Automatic Pet Feeder shown with a child and a dog, highlighting its capacity and smart features.*

## 1. Setup

### 1.1 Package Contents

Verify that all components are present in the package:

- Iseebiz Automatic Pet Feeder
- Power Adapter
- USB Cable
- Instruction Manual

## App in Multi Platforms

---Easy Get , Easy Found

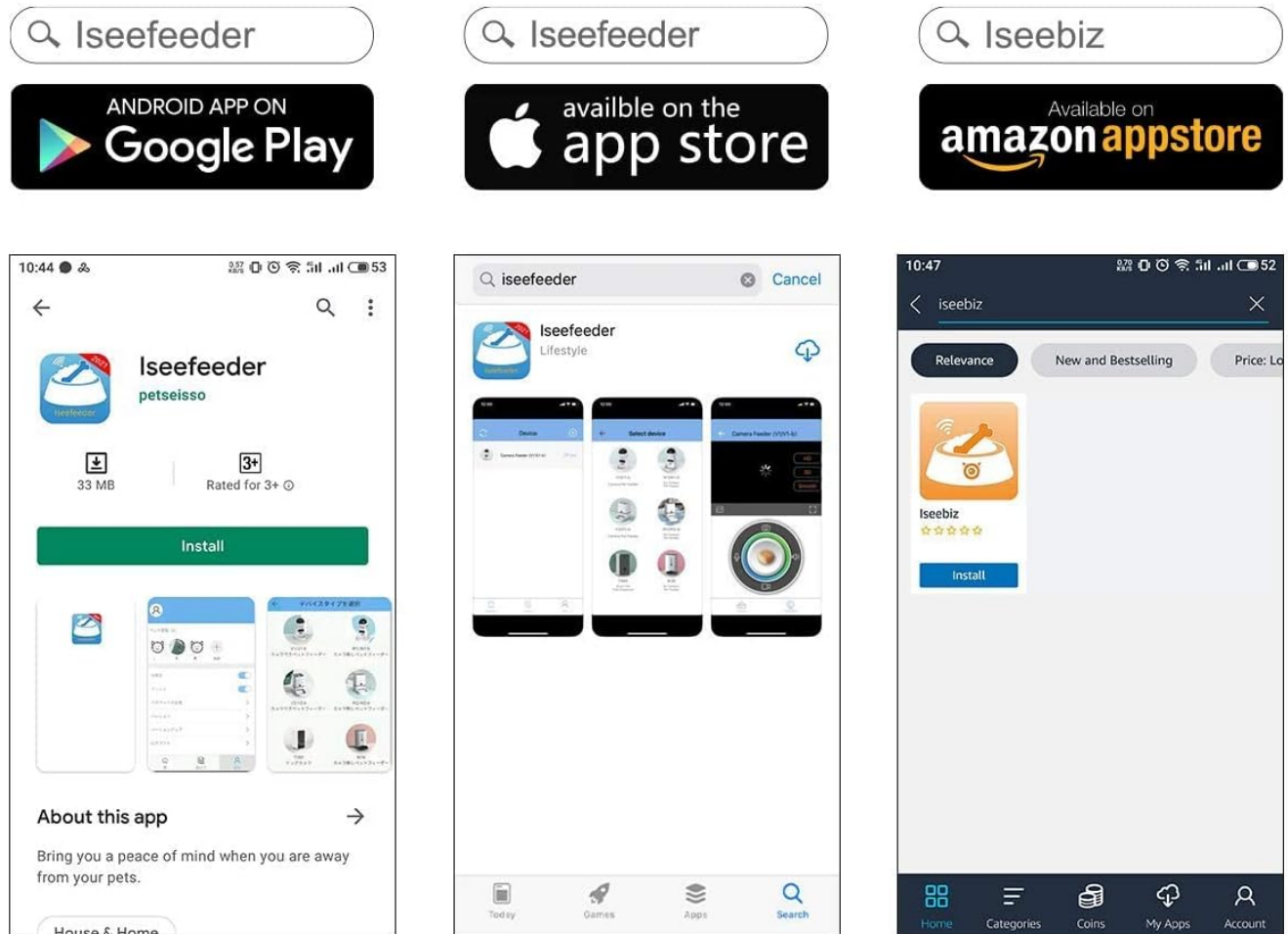

Image: The Iseebiz Automatic Pet Feeder along with its included power adapter, USB cable, and English user manual.

### 1.2 Power Supply Options

The feeder can be powered by two methods:

- **Power Adapter:** Connect the provided power adapter to a wall outlet.
- **Batteries:** For backup power, insert 3 Type D batteries (not included) into the battery compartment at the bottom of the unit. This ensures continued operation during power outages or Wi-Fi disruptions.

### 1.3 App Installation

To control the feeder remotely, download and install the "Iseebiz" app on your mobile device. Search for "Iseebiz" in your device's app store (e.g., Google Play Store for Android, Apple App Store for iOS).

# RECORD YOUR SOUND

Record your 10s voice or music to remind your fur kid for meals.



*Image: Screenshots illustrating the availability of the Iseebiz app across multiple platforms, including Google Play, Apple App Store, and Amazon Appstore.*

## 1.4 Wi-Fi Connection

After installing the app, register an account and log in. Follow the in-app instructions to connect your Iseebiz Smart Feeder to your home Wi-Fi network. Ensure your Wi-Fi is 2.4GHz, as the feeder only supports this frequency.

Your browser does not support the video tag.

*Video: Demonstrates the process of connecting the Iseebiz pet feeder to your phone application via Wi-Fi.*

## 2. Operating

### 2.1 Scheduling Meals

The feeder allows you to schedule up to 6 meals per day. You can customize the feeding time and portion size for

each meal through the app. Each portion is approximately 5g, with options from 1 to 20 portions per meal.

## 6 Feeding Times Per Day

Up to 6 feeding times per day to set in the APP, you could use your phone to add manual feeding whenever you want.



Image: The Iseebiz Automatic Pet Feeder with an overlay demonstrating the app's interface for setting up to 6 feeding times and customizing portion sizes.

Your browser does not support the video tag.

Video: A guide on how to set the feeding time and food portions using the mobile application.

### 2.2 Manual Feeding

In addition to scheduled meals, you can manually dispense food at any time via the mobile app.

Your browser does not support the video tag.

Video: An overview of the Iseebiz Smart Feeder 6L, demonstrating its features including manual feeding.

### 2.3 Voice Interaction

Record a 10-second voice message that will play automatically before each feeding. This feature helps comfort your pet and signals mealtime.



# Part and Accessories



Power adapter



English user manual



USB charging cable

*Image: The Iseebiz Automatic Pet Feeder with a speech bubble indicating "LUNCH TIME", illustrating the voice recording feature to call pets for meals.*

## 2.4 Camera Features & Two-Way Audio

The built-in camera allows you to monitor your pet, take photos, and record videos remotely. The 135° wide-angle HD camera includes night vision for clear viewing in low light. Utilize the 2-way audio feature to talk to your pet and hear their sounds from anywhere.

## APP Remote Control + Two Way Audio

- Stay connected with you fur kid with your phone while you are not at home.
- Check your fur kid with the 135° wide angle night vision capable HD cam.
- Hear and talk to your fur kid through your phone.
- Record videos, voice and take photos anytime anyplace.



*Image: The Iseebiz Automatic Pet Feeder with an accompanying smartphone displaying the app's interface for remote control and two-way audio communication with your pet.*

# Interactive Pet Feeder

Keep an eye on your pets, Check in and talk to them anytime even though you are not at home.

- 📺 Real-time Video
- 🗣️ Voice Interaction
- 📷 Catch the Special Moment



Image: An interactive pet feeder setup, emphasizing real-time video monitoring, voice interaction, and the ability to capture special moments with your pets.



Image: A smartphone screen displaying the night vision capability of the feeder's camera, showing a clear image of a dog in low light conditions.

## 2.5 Alexa Compatibility

The Iseebiz Smart Feeder is compatible with Amazon Alexa. Add Iseebiz to your Alexa skills to give an extra snack to your pet using voice commands when you are home.

### 3. Maintenance

#### 3.1 Cleaning

The food bowl and other removable parts should be cleaned regularly. Hand wash only. Ensure all parts are completely dry before reassembling to prevent moisture damage.

#### 3.2 Refilling Food

Monitor the food level in the 6L dispenser. Refill with dry pet food as needed. The feeder features an anti-clog design to ensure smooth food dispensing.

### 4. Troubleshooting

Problem	Possible Cause	Solution
Feeder is offline / App cannot connect.	Incorrect Wi-Fi frequency (not 2.4GHz), weak Wi-Fi signal, incorrect password, or temporary network issue.	Ensure your Wi-Fi is 2.4GHz. Check Wi-Fi signal strength near the feeder. Re-enter Wi-Fi password carefully. Restart your router and the feeder.
Food not dispensing.	Food hopper empty, food jammed, or dispenser mechanism blocked.	Check food level and refill if necessary. Clear any food jams in the dispenser. Ensure the food type is suitable for the feeder (dry food only).
Voice recording not playing.	No voice message recorded or recording corrupted.	Re-record your voice message through the app. Ensure the recording is saved successfully.
Pet can access food manually.	Physical button accessible or food door can be manipulated.	Consider placing the feeder in an area less accessible to curious pets. If the manual dispense button is easily pressed by pets, consider a temporary cover. Ensure the food bowl is securely attached.
Feeder not working on batteries.	Batteries are low, incorrectly inserted, or not Type D.	Replace batteries with fresh Type D batteries. Ensure correct polarity when inserting.

### 5. Specifications

- **Model:** ISB-ZZL-0035
- **Brand:** Iseebiz



- **Capacity:** 6 Liters (approx. 24 cups)
- **Dimensions (LxWxH):** 13.78 x 8.27 x 14.17 inches
- **Item Weight:** 4.63 pounds
- **Material:** Not specified (Note: Original data listed "Fur" which is incorrect for feeder material)
- **Power Supply:** Power Adapter (included) or 3 x Type D Batteries (not included)
- **Wi-Fi Frequency:** 2.4GHz only
- **Camera:** 135° wide-angle HD with night vision
- **Audio:** 2-Way Audio, Voice Recording
- **Feeding Schedule:** Up to 6 meals/day, 1-20 portions/meal (approx. 5g/portion)
- **Compatibility:** Mobile App (Iseebiz), Amazon Alexa

## 6. Warranty and Support

---

For warranty information, technical support, or any product-related inquiries, please contact Iseebiz customer service directly. Refer to the contact details provided in the product packaging or on the official Iseebiz website. Optional protection plans are available for purchase separately to extend coverage beyond the manufacturer's warranty. Please refer to the retailer for details on these plans.

© 2025 Iseebiz. All rights reserved.

This manual is for informational purposes only. Product specifications are subject to change without notice.