

## Manuals+

[Q & A](#) | [Deep Search](#) | [Upload](#)

manuals.plus /

> [K KASONIC](#) /

> [K KASONIC Outdoor Light Timer Outlet Instruction Manual](#)

## K KASONIC ZJ-PYP9-DJ49

# K KASONIC Outdoor Light Timer Outlet

Model: ZJ-PYP9-DJ49

Brand: K KASONIC

## INTRODUCTION

This manual provides detailed instructions for the safe and efficient use of your K KASONIC Outdoor Light Timer Outlet. This heavy-duty, waterproof mechanical timer is designed to automate the power supply for various outdoor appliances, helping you save time, energy, and money.

It features a 24-hour mechanical switch with up to 48 on/off settings per day, allowing for precise control in 30-minute intervals. The unit includes two grounded outlets and is ETL listed for safety and quality assurance.

## SAFETY INFORMATION

- **Electrical Rating:** This timer is rated for 15 Amp, 120 Volt, 1875 Watt. Do not exceed these ratings to prevent overheating and potential damage.
- **Grounding:** The timer features a 3-wire grounded plug and outlets for safe operation. Always ensure proper grounding when connecting to a power source.
- **Waterproof Design:** While designed for outdoor use and waterproof, ensure the unit is installed in a vertical position with the outlets facing downward to prevent water accumulation. Refer to Figure 7 for proper orientation.
- **Installation Height:** For optimal safety and performance, install the timer at least 2 feet (0.6 meters) above ground level.
- **Material Safety:** Constructed from waterproof and fireproof material for enhanced durability and safety.
- **ETL Listed:** This product is ETL listed, indicating it meets rigorous safety and quality standards.
- **Unplug When Not in Use:** Always unplug the timer from the power source before performing any maintenance or if it will not be used for an extended period.

## PRODUCT OVERVIEW

Familiarize yourself with the components of your K KASONIC Outdoor Light Timer Outlet:

- **Mechanical Timer Dial:** A central dial with 24-hour markings (AM/PM) and small pins for setting ON/OFF intervals.
- **Timer Pins:** Small, push-down pins around the dial, each representing a 30-minute interval.

- **Manual Override Switch:** A slider switch located below the dial, allowing you to select "Timer ON", "Outlet ON" (always on), or "OFF" (always off).
- **Protective Cover:** A clear, rain-tight cover that protects the timer dial and switch from weather elements.
- **Grounded Outlets:** Two 3-prong grounded outlets located at the bottom of the unit for connecting your appliances.
- **Power Cord and Plug:** A heavy-duty power cord with a 3-prong grounded plug for connecting to a wall outlet.
- **Mounting Hole:** A keyhole slot on the back for wall mounting.



Figure 1: Front view of the K KASONIC Outdoor Light Timer Outlet, showing the mechanical dial, protective cover, and dual grounded outlets.



**From 1 to  
2 Outlets**



Double the amount  
of outlets available



Figure 2: Close-up view of the two grounded AC outlets, doubling your available connections.



Figure 3: Illustration of the Timer Mode and Manual Mode switch, allowing for automated or continuous operation.



Figure 7: Overview of the timer's dimensions (6 inches H x 4.8 inches W), heavy-duty construction, rain-tight cover, mounting hold, and ETL listing.

## SETUP INSTRUCTIONS

Follow these steps to set up your K KASONIC Outdoor Light Timer Outlet:

1. **Lift All Pins:** Using a small tool like a screwdriver, lift all the small pins around the timer dial to their "up" position. This resets the timer for programming.
2. **Set Current Time:** Rotate the timer dial clockwise until the current time aligns with the arrow indicator on the dial. The dial is marked with AM/PM for clarity.
3. **Program ON/OFF Times:** Push down the pins corresponding to the desired "ON" periods. Each pin represents a 30-minute interval. For example, to have the timer on from 6:00 PM to 10:00 PM, push down all pins between 6 PM and 10 PM.
4. **Select Timer Mode:** Slide the manual override switch to the "Timer ON" position. This activates the programmed schedule.
5. **Mounting (Optional):** If mounting, use the keyhole slot on the back of the unit. Ensure the timer is mounted vertically

with outlets facing downwards and at least 2 feet above ground level.

6. **Plug In:** Connect the timer's plug into a grounded outdoor electrical outlet.

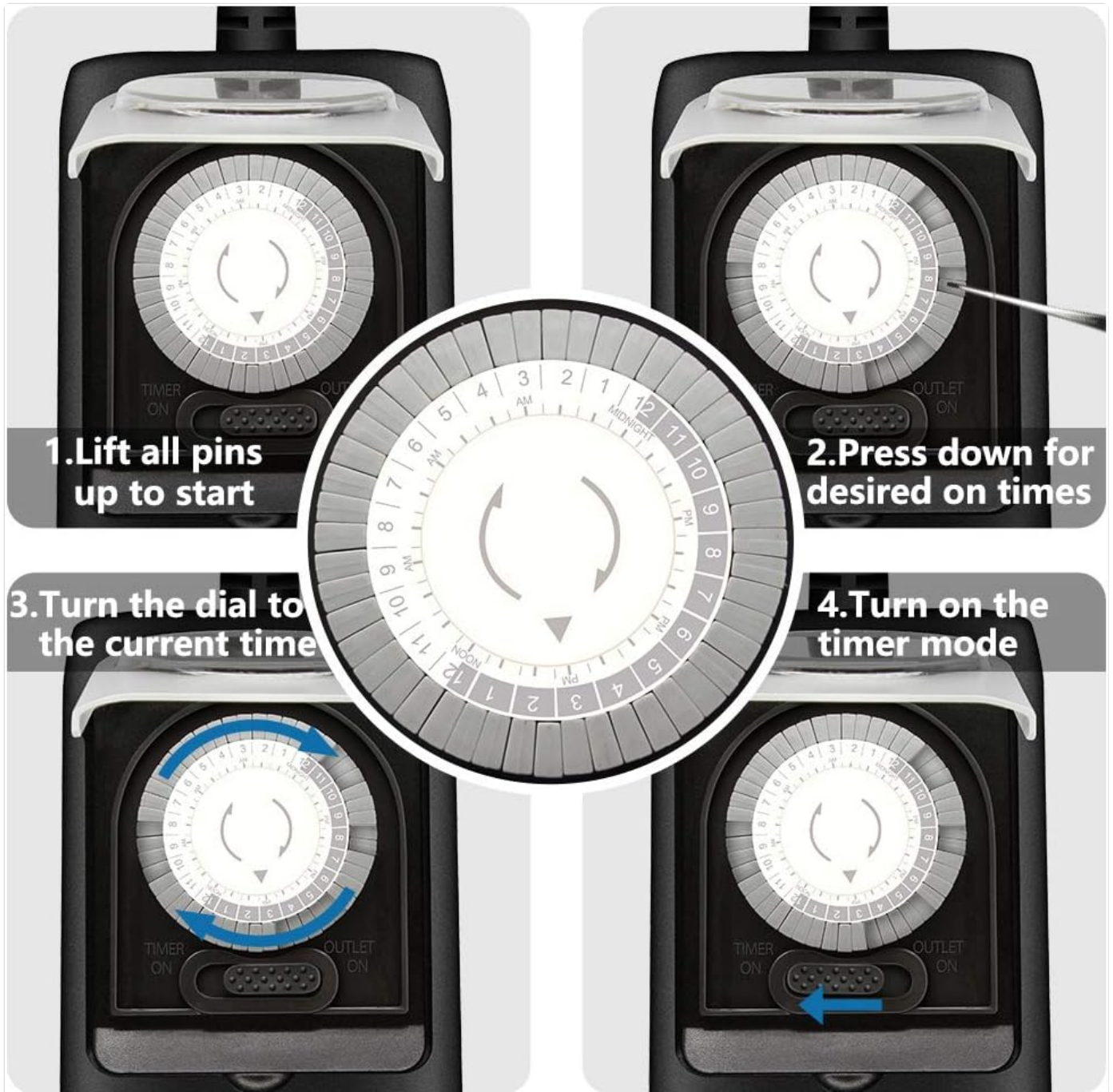

Figure 4: Visual guide for setting up the timer: 1. Lift all pins, 2. Press down for desired ON times, 3. Turn dial to current time, 4. Turn on timer mode.

Your browser does not support the video tag.

Video 1: A detailed demonstration of how to set the 24-hour mechanical timer switch, including lifting pins, setting desired ON times, and activating the timer mode.

## OPERATING INSTRUCTIONS

Once set up, operating your timer is straightforward:

- **Automatic Operation:** With the manual override switch set to "Timer ON", the connected appliances will automatically turn on and off according to the programmed pins. The dial will continuously rotate, advancing the time.
- **Manual Override:**

- To keep the connected appliances continuously ON, slide the switch to the "Outlet ON" position. This bypasses the timer settings.
  - To turn off the connected appliances completely, slide the switch to the "OFF" position. This also bypasses the timer settings.
  - To resume programmed operation, slide the switch back to the "Timer ON" position.
- **Connecting Appliances:** Plug your outdoor lights, pool pumps, fountains, or other compatible appliances into the two grounded outlets at the bottom of the timer.



Figure 5: The timer in an outdoor setting, controlling a fountain, demonstrating its practical application.



Figure 6: Examples of the timer's versatility, including use with holiday lights, garden sprinklers, and other outdoor electrical devices.

## MAINTENANCE

---

To ensure the longevity and optimal performance of your K KASONIC Outdoor Light Timer Outlet, follow these maintenance guidelines:

- **Regular Cleaning:** Periodically wipe the exterior of the timer with a damp cloth to remove dirt and debris. Ensure the protective cover is clean and free of obstructions. Do not use abrasive cleaners or immerse the unit in water.
- **Inspect for Damage:** Before each use, especially after severe weather, inspect the power cord, plug, outlets, and the unit's casing for any signs of damage, cracks, or fraying. Do not use if damaged.
- **Protective Cover:** Always ensure the clear protective cover is securely closed when the timer is in use outdoors to maintain its waterproof integrity.
- **Proper Storage:** When not in use for extended periods, store the timer in a cool, dry place, away from direct sunlight and extreme temperatures.

## TROUBLESHOOTING

If you encounter issues with your K KASONIC Outdoor Light Timer Outlet, refer to the following common problems and solutions:

Problem	Possible Cause	Solution
Timer is not turning ON/OFF at programmed times.	<ul style="list-style-type: none"><li>Manual override switch is not in "Timer ON" position.</li><li>Pins are not correctly pushed down/up for desired intervals.</li><li>Current time is not set accurately on the dial.</li></ul>	<ul style="list-style-type: none"><li>Ensure the manual override switch is set to "Timer ON".</li><li>Verify that the correct pins are pushed down for "ON" times and up for "OFF" times.</li><li>Adjust the dial to reflect the current time accurately.</li></ul>
No power to connected appliances.	<ul style="list-style-type: none"><li>Timer is not plugged into a live outlet.</li><li>Circuit breaker tripped.</li><li>Connected appliance is faulty.</li></ul>	<ul style="list-style-type: none"><li>Check the wall outlet with another device to ensure it has power.</li><li>Reset the circuit breaker if it has tripped.</li><li>Test the appliance by plugging it directly into a working outlet.</li></ul>
Timer dial is difficult to read.	Small markings on the dial.	Use a magnifying glass or ensure adequate lighting when setting the timer for better visibility of the small numbers and pins.
Difficulty mounting the unit.	Mounting hole size.	The mounting hole is designed for small screws. Ensure you use an appropriately sized screw for secure installation. Consider using a strap or clamp if a single screw mount is insufficient for your needs.

## SPECIFICATIONS

Feature	Detail
Model Number	ZJ-PYP9-DJ49
Brand	K KASONIC
Color	Black
Material	Acrylonitrile Butadiene Styrene
Product Dimensions (DxWxH)	2.75"D x 4.8"W x 6"H
Item Weight	7.8 ounces
Number of Settings	Up to 48 ON/OFF settings per day (30-minute intervals)
Electrical Rating	15 Amp, 120 Volt, 1875 Watt

Feature	Detail
Outlets	2 Grounded Outlets
Certification	ETL Listed
UPC	638183948583
Date First Available	March 20, 2019

## WARRANTY AND SUPPORT

---

K KASONIC stands behind the quality of its products. For any support needs or inquiries regarding your Outdoor Light Timer Outlet, please contact us via your order page on Amazon. We commit to responding to your request within 12 hours.

We also offer a 100% refund if you are not satisfied with your purchase. Your satisfaction is our priority.

