



Manuals.plus /

› Homeleader /

› Homeleader DF-600H1-7 Oil Filled Radiator Heater User Manual

Homeleader DF-600H1-7

Homeleader DF-600H1-7 Oil Filled Radiator Heater User Manual

Model: DF-600H1-7

1. IMPORTANT SAFETY INSTRUCTIONS

Please read all instructions carefully before using this heater. Failure to follow these instructions may result in fire, electric shock, or injury.

- Always plug heaters directly into a wall outlet/receptacle. Never use with an extension cord or relocatable power tap (outlet/power strip).
- This heater is hot when in use. To avoid burns, do not let bare skin touch hot surfaces. Use handles when moving this heater.
- Keep combustible materials, such as furniture, pillows, bedding, papers, clothes, and curtains at least 3 feet (0.9 meters) from the front of the heater and keep them away from the sides and rear.
- Extreme caution is necessary when any heater is used by or near children or invalids and whenever the heater is left operating and unattended.
- Always unplug heater when not in use.
- Do not operate any heater with a damaged cord or plug or after the heater malfunctions, has been dropped or damaged in any manner. Return heater to authorized service facility for examination, electrical or mechanical adjustment, or repair.
- Do not use outdoors. This heater is intended for indoor use only.
- Do not run cord under carpeting. Do not cover cord with throw rugs, runners, or similar coverings. Arrange cord away from traffic area and where it will not be tripped over.
- To disconnect heater, turn controls to OFF, then remove plug from outlet.
- Do not insert or allow foreign objects to enter any ventilation or exhaust opening as this may cause an electric shock or fire, or damage the heater.
- To prevent a possible fire, do not block air intakes or exhaust in any manner. Do not use on soft surfaces, like a bed, where openings may become blocked.

- This heater has an overheat safety feature that automatically shuts down the unit if it overheats. If this occurs, unplug the heater and allow it to cool for 30 minutes before restarting.

2. PRODUCT OVERVIEW

The Homeleader DF-600H1-7 is a compact oil-filled radiator heater designed for personal use in small to medium rooms, homes, and offices. It features an adjustable thermostat and overheat safety for reliable operation.

2.1 Key Features

- **Adjustable Thermostat:** Allows precise temperature control.
- **Noiseless Operation:** Provides quiet heating without fan noise.
- **Portable Design:** Lightweight with a built-in carry handle for easy movement.
- **Overheat Safety:** Automatically shuts off if the unit becomes too hot.
- **Oil-Filled Radiator:** Radiates heat through permanently sealed special endothermic oil.

2.2 Product Components

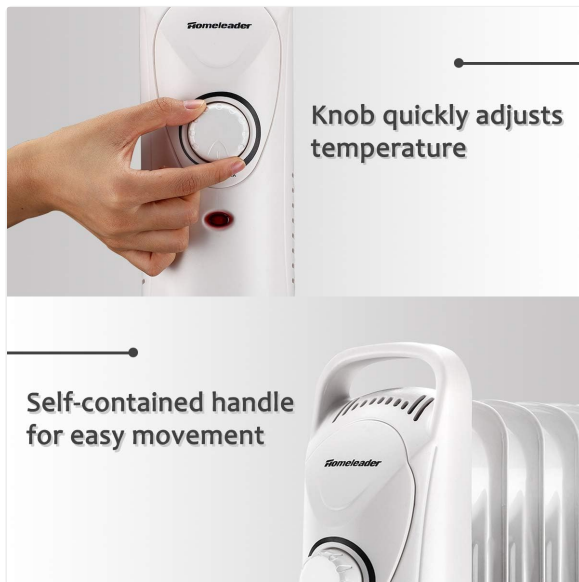

Image showing the control knob for temperature adjustment and the convenient carry handle for portability.

Adjustable Power



The temperature can be adjusted to meet your various needs

Front view of the heater, highlighting the adjustable thermostat dial for setting desired heat levels.

Built-in Overload Protector

automatically shut down overheating



Illustration of the heater's built-in overload protector, which automatically shuts down the unit if it overheats, and a 'DO NOT COVER' warning.



Diagram showing the compact dimensions of the heater:
15.35 inches (height), 11.40 inches (width), and 5.90
inches (depth).

3. SETUP

Before first use, ensure the heater is placed on a stable, level surface and is clear of any obstructions.

1. **Unpack:** Carefully remove the heater from its packaging. Retain packaging for future storage.
2. **Placement:** Place the heater on a firm, level surface. Ensure it is at least 3 feet (0.9 meters) away from walls, furniture, curtains, and other combustible materials. This heater is designed for indoor use only.
3. **Power Connection:** Plug the heater directly into a 120V AC electrical outlet. Do not use extension cords or power strips.
4. **First Use Odor:** It is normal for the heater to emit a slight odor during its first few hours of operation. This will dissipate quickly. Ensure the room is well-ventilated during this period.

4. OPERATING INSTRUCTIONS

The Homeleader DF-600H1-7 heater is simple to operate with a single control knob.

1. **Power On:** Plug the heater into a suitable electrical outlet.
2. **Adjust Thermostat:** Turn the control knob clockwise to the 'MAX' setting to begin heating. The red indicator light will illuminate, signifying that the heater is actively heating.
3. **Set Desired Temperature:** Once the room reaches your desired comfort level, slowly turn the control knob counter-clockwise until the red indicator light turns off. The heater will now maintain this temperature by cycling on and off automatically. The indicator light will illuminate when the heater is actively heating and turn off when the desired temperature is reached.
4. **Power Off:** To turn off the heater completely, turn the control knob counter-clockwise to the 'MIN'

position and unplug the unit from the wall outlet.



The compact heater positioned on the floor, illustrating its suitability for personal heating in various indoor settings.

5. MAINTENANCE

Regular cleaning and proper storage will ensure the longevity and efficient operation of your heater.

5.1 Cleaning

- Always unplug the heater and allow it to cool completely before cleaning.
- Wipe the exterior surfaces with a soft, damp cloth. Do not use abrasive cleaners or solvents.
- Do not immerse the heater in water or allow water to drip into the interior of the heater.
- Clean the air intake and exhaust openings regularly with a vacuum cleaner attachment to remove dust and lint.

5.2 Storage

- Store the heater in a cool, dry location when not in use.
- To prevent dust buildup, cover the heater with a cloth or its original packaging.

6. TROUBLESHOOTING

If your heater is not operating correctly, please refer to the following common issues and solutions:

Problem	Possible Cause	Solution
Heater does not turn on.	No power to the unit, thermostat set too low, or overheat protection activated.	Check if the heater is plugged in securely. Ensure the wall outlet is functional. Turn the thermostat knob to a higher setting. Unplug the heater for 30 minutes to reset overheat protection.
Heater produces insufficient heat.	Thermostat set too low, room size too large for heater capacity, or drafts in the room.	Increase the thermostat setting. Ensure the room is adequately insulated. This 700W heater is best for small to medium rooms.
Heater cycles on and off too frequently.	Thermostat set too high for the room temperature, or heater is placed too close to a heat source.	Lower the thermostat setting slightly. Relocate the heater away from other heat sources.
Unusual odor during operation.	New unit odor (first use), or dust accumulation on heating elements.	Ensure adequate ventilation for new units. Unplug and clean the heater as per maintenance instructions.

7. SPECIFICATIONS

Feature	Detail
Brand	Homeleader
Model Number	DF-600H1-7
Type	Oil Filled Radiator Heater
Power Output	700 Watts
Voltage	120 Volts
Amperage	5.83 Amps
Color	White
Product Dimensions (D x W x H)	5" x 11.4" x 15.35"
Item Weight	9 pounds
Special Features	Manual Thermostat, Noiseless, Portable, Overheat Safety
Indoor/Outdoor Usage	Indoor
Mounting Type	Floor Mount, Tabletop Mount
UPC	741663118472

8. WARRANTY & SUPPORT

Homeleader provides a 12-month replacement service and lifetime support for this product. For any questions, concerns, or warranty claims, please contact Homeleader customer service through the platform where the product was purchased or visit the official Homeleader website for support information.