

Manuals+

[Q & A](#) | [Deep Search](#) | [Upload](#)

manuals.plus /

- › [Carrera](#) /
- › [Carrera RC Mario Kart Mach 8 Luigi 1:18 Scale Remote Control Car Instruction Manual](#)

Carrera 370181067

Carrera RC Mario Kart Mach 8 Luigi 1:18 Scale Remote Control Car Instruction Manual

Model: 370181067

INTRODUCTION

This manual provides essential information for the safe and effective operation of your Carrera RC Mario Kart Mach 8 Luigi remote control car. Please read all instructions carefully before use and retain this manual for future reference.



Image: Carrera RC Mario Kart Mach 8 Luigi remote control car with Luigi figure seated in the driver's seat.

SAFETY INFORMATION

WARNING: CHOKING HAZARD - Small Parts. Not for children under 3 years.

- Always supervise children during operation.
- Avoid operating the vehicle near water, heat sources, or electrical outlets.
- Do not operate the vehicle in crowded areas or near pedestrians.
- Ensure all battery compartments are securely closed before use.
- Do not attempt to modify the vehicle or its components.

WHAT'S IN THE BOX

- Remote Control Vehicle (Luigi Mach 8)
- LiFePO4 Battery (for vehicle)
- Remote Controller
- Controller Batteries (AAA)
- USB Data Cable (for vehicle battery charging)

SETUP

1. Controller Battery Installation

1. Locate the battery compartment on the back of the remote controller.
2. Using a small Phillips head screwdriver, unscrew the battery compartment cover.
3. Insert the provided AAA batteries, ensuring correct polarity (+/-).
4. Replace the battery compartment cover and secure it with the screw.



Image: Carrera RC remote controller.

2. Vehicle Battery Installation and Charging

1. Locate the battery compartment on the underside of the vehicle.
2. Using a small Phillips head screwdriver, unscrew the battery compartment cover.
3. Connect the LiFePO4 battery to the vehicle's internal connector.
4. Place the battery securely within the compartment and replace the cover, securing it with the screw.
5. To charge the vehicle battery, disconnect it from the vehicle and connect it to the provided USB data cable.
6. Plug the USB data cable into a compatible USB power source (e.g., computer, USB wall adapter).
7. Charging time is approximately 50 minutes for a full charge.

3. Power On and Pairing

1. Turn on the remote controller using the ON/OFF switch. The indicator light will illuminate.
2. Turn on the vehicle using the ON/OFF switch located on its side. The vehicle's indicator light will blink.
3. The remote controller and vehicle will automatically pair. Once paired, the vehicle's indicator light will stop blinking and remain solid.

OPERATING INSTRUCTIONS

1. Basic Controls

- Use the left joystick on the remote controller to move the vehicle forward and backward.

- Use the right joystick on the remote controller to steer the vehicle left and right.

2. Dynamic Figure Motion

The Luigi figure in the driver's seat is designed to move dynamically, tilting into turns as the vehicle steers. This enhances the realistic driving experience.



Image: Carrera RC Mario Kart Mach 8 Luigi remote control car in motion.

3. 2.4 GHz Technology

The 2.4 GHz digital frequency system allows for uninterrupted play and enables up to 16 vehicles to be operated simultaneously without interference. This is ideal for multi-player racing.

4. Speed and Terrain

The vehicle can reach speeds of up to 5.6 mph (9 km/h). Its durable tires provide optimal grip on various terrains, making it suitable for both indoor and outdoor use.



Image: Multiple Carrera RC Mario Kart vehicles on a race track.

MAINTENANCE

1. Battery Care

- Always turn off both the vehicle and the remote controller when not in use to conserve battery life.
- Fully charge the vehicle's LiFePO4 battery before each use for optimal performance.
- Do not overcharge or completely drain the battery.
- Store batteries in a cool, dry place away from direct sunlight.

2. Cleaning

- Wipe the vehicle and controller with a soft, dry cloth.
- Avoid using water or chemical cleaners, as these can damage electronic components.
- Remove any debris from the wheels and axles to ensure smooth operation.

TROUBLESHOOTING

- **Vehicle not responding:** Ensure both the vehicle and controller are turned on and their batteries are charged. Repair the devices if necessary.
- **Short battery life:** Ensure the battery is fully charged. Operating the vehicle at high speeds or on rough terrain can reduce run time.
- **Poor steering/movement:** Check for debris in the wheels or axles. Ensure the steering trim on the controller is properly adjusted (if applicable).
- **Interference:** While 2.4 GHz technology minimizes interference, ensure no other strong radio signals are present in the immediate vicinity.

SPECIFICATIONS

- **Brand:** Carrera
- **Model:** 370181067 (Mario Kart Mach 8 - Luigi)

- **Scale:** 1:18
- **Frequency:** 2.4 GHz
- **Max Speed:** Up to 5.6 mph (9 km/h)
- **Run Time:** Up to 20 minutes (per charge)
- **Charge Time:** Approx. 50 minutes
- **Vehicle Battery:** LiFePO4 (included)
- **Controller Batteries:** AAA (included)
- **Product Dimensions:** 14.49 x 8.62 x 9.13 inches
- **Item Weight:** 1.7 pounds
- **Recommended Age:** 6 years and up
- **Release Date:** July 1, 2019

WARRANTY AND SUPPORT

For warranty information or technical support, please refer to the documentation included with your product packaging or visit the official Carrera website. Keep your proof of purchase for any warranty claims.

Related Documents - 370181067

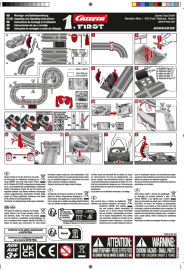
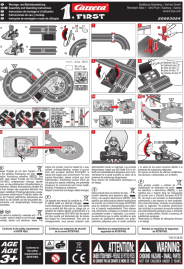
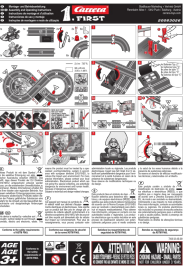
	<p>Carrera First Mario Kart Slot Car Race Track: Instructions and Safety Guide</p> <p>Comprehensive instructions and safety guidelines for the Carrera First Mario Kart slot car race track set, featuring battery-powered racing for kids aged 3+.</p>
	<p>Carrera FIRST Mario Kart Slot Car Race Track - Assembly and Operating Instructions</p> <p>Official assembly and operating instructions for the Carrera FIRST Mario Kart slot car race track set. Learn how to set up, operate, and maintain your race track. Includes safety warnings and technical specifications.</p>
	<p>Carrera FIRST Mario Kart Slot Car Race Track Assembly and Operating Instructions</p> <p>Assembly and operating instructions for the Carrera FIRST Mario Kart slot car race track set. Includes details on setup, safety precautions, battery installation, and maintenance.</p>

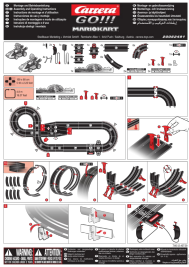

[Carrera GO!!! Mario Kart Autorennbahn: Montage- und Betriebsanleitung](#)

Finden Sie die offizielle Montage- und Betriebsanleitung für die Carrera GO!!! Mario Kart Autorennbahn. Erfahren Sie, wie Sie Ihre Carrera GO!!! Mario Kart Rennstrecke aufbauen und bedienen.

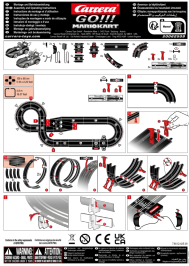

[Carrera GO!!! Mario Kart Slot Car Race Track Assembly and Operating Instructions](#)

Detailed assembly and operating instructions for the Carrera GO!!! Mario Kart slot car race track set, including track layout, car setup, and safety information.



[Carrera RC Remote Control Car - Assembly & Operating Instructions](#)

Comprehensive assembly and operating instructions for Carrera RC remote control cars, covering safety guidelines, charging procedures, operational details, troubleshooting, and product specifications. Includes information on various models like Mario Kart™, Ford F-150 Raptor, and Ford Bronco.