

Manuals.plus /

› VARICART /

› VARICART E27 10W RGB LED Bulb Instruction Manual

VARICART BR18-SH4Q

VARICART E27 10W RGB LED Bulb Instruction Manual

Model: BR18-SH4Q

1. INTRODUCTION

This manual provides comprehensive instructions for the VARICART E27 10W RGB LED Bulb. Please read this manual carefully before installation and use to ensure proper operation and safety. Keep this manual for future reference.

2. SAFETY INFORMATION

- Ensure the power supply is switched off before installing or replacing the bulb.
- This product is designed for indoor use only.
- Do not use this bulb with external dimmers. Dimming is controlled exclusively by the provided remote control.
- Do not disassemble or modify the bulb. This may cause damage and void the warranty.
- Avoid direct eye exposure to the light source when the bulb is on.

3. PACKAGE CONTENTS

Each package contains:

- 2 x VARICART E27 10W RGB LED Bulbs
- 2 x IR Remote Controls

4. PRODUCT FEATURES

- **RGB + Cool White (6000K):** Offers a wide range of 12 colors plus a bright 6000K cool white light.
- **High Brightness:** Provides up to 1000 lumens of light output.

- **Wide Beam Angle:** Features a 220° beam angle for broad illumination.
- **Eye Comfort:** Designed to be flicker-free and glare-free, reducing eye strain.
- **IR Remote Control:** Operates with an infrared remote control, offering a range of up to 8 meters.
- **Multiple Modes:** Includes 5 dynamic modes: Flash, Smooth, Energy-saving, One-Off Timer, and Daily Cycle Timer.
- **Dimmable:** Brightness is adjustable via the remote control.
- **Memory Function:** Automatically saves the last static color or dynamic mode used, restoring it upon next power-on.
- **Durable Design:** Constructed with high-quality materials for a long lifespan of approximately 50,000 hours.
- **Certifications:** CE and RoHS compliant.

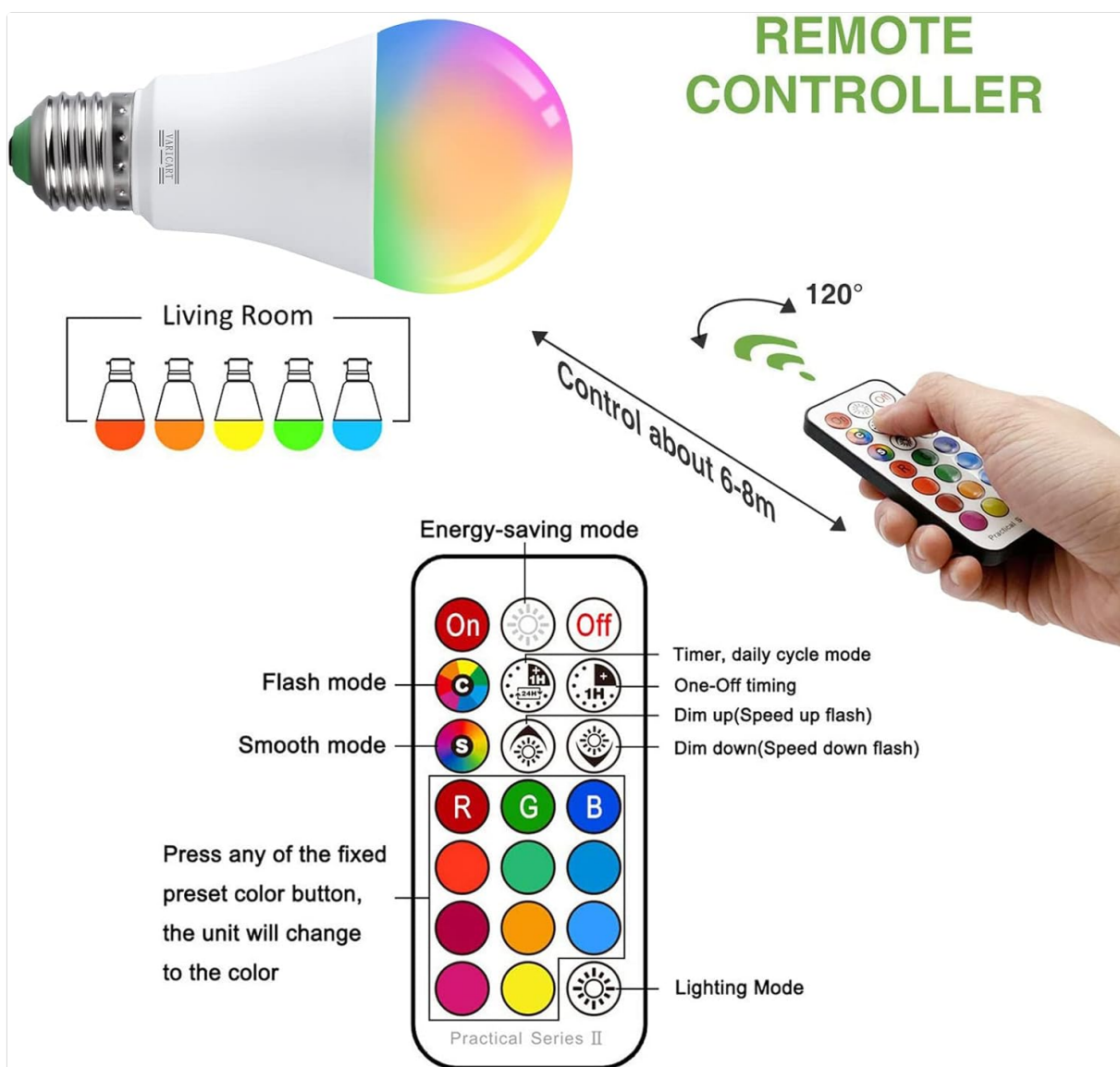

This graphic summarizes the main features of the VARICART E27 RGB LED bulb, including Warm White (3000K) and Cool White (6000K) options, remote control, memory function, time & schedule functions, 1000 lumens brightness, 10W power, 5 lighting modes, 12 colors, and an E27 screw base.

5. SETUP AND INSTALLATION

1. **Power Off:** Before installation, ensure the power supply to the light fixture is completely switched off at the main switch.

2. **Screw In:** Carefully screw the VARICART E27 LED bulb into a standard E27 light socket. Ensure it is securely fastened but do not overtighten.
3. **Power On:** Restore power to the light fixture. The bulb should illuminate in its last used setting (due to the memory function).



This image shows the physical dimensions of the VARICART E27 LED bulb, measuring 60mm in width and 122mm in height. It also highlights the E27 screw base, indicating compatibility with standard E27 sockets. The CE mark and a 'Dimmable' icon are also visible.

6. OPERATING INSTRUCTIONS

6.1 Remote Control Overview

The included IR remote control allows full functionality of the VARICART E27 LED bulb. Point the remote directly at the bulb for optimal response.



This image illustrates the infrared remote control for the VARICART E27 LED bulb. It details various buttons for power on/off, color selection (R, G, B, and other preset colors), dimming, flash mode, smooth mode, energy-saving mode, and timer functions. The remote has an effective control range of approximately 6-8 meters.

6.2 Basic Functions

- **On/Off:** Press the **ON** button to turn the bulb on, and the **OFF** button to turn it off.
- **Color Selection:** Press any of the 12 color buttons to change the bulb's color.
- **White Light:** Press the **Lighting Mode** button (sun icon) to switch to 6000K cool white light.
- **Brightness Adjustment:** Use the **Dim Up** and **Dim Down** buttons to adjust the brightness of the selected color or white light.

6.3 Dynamic Modes

- **Flash Mode:** Press the **Flash** button for a rapid color cycling effect.
- **Smooth Mode:** Press the **Smooth** button for a gradual and continuous color transition.
- **Energy-saving Mode:** Activates a low-power lighting setting.

6.4 Timing Functions

The remote offers two timing options:

- **One-Off Timer:** Sets the bulb to turn off after a specific duration.
- **Daily Cycle Timer:** Programs the bulb to turn on and off at the same time each day.

6.5 Memory Function

The bulb features a memory function that automatically saves the last static color or dynamic mode used. When the bulb is turned off and then back on, it will resume the previous setting without needing to be reset.

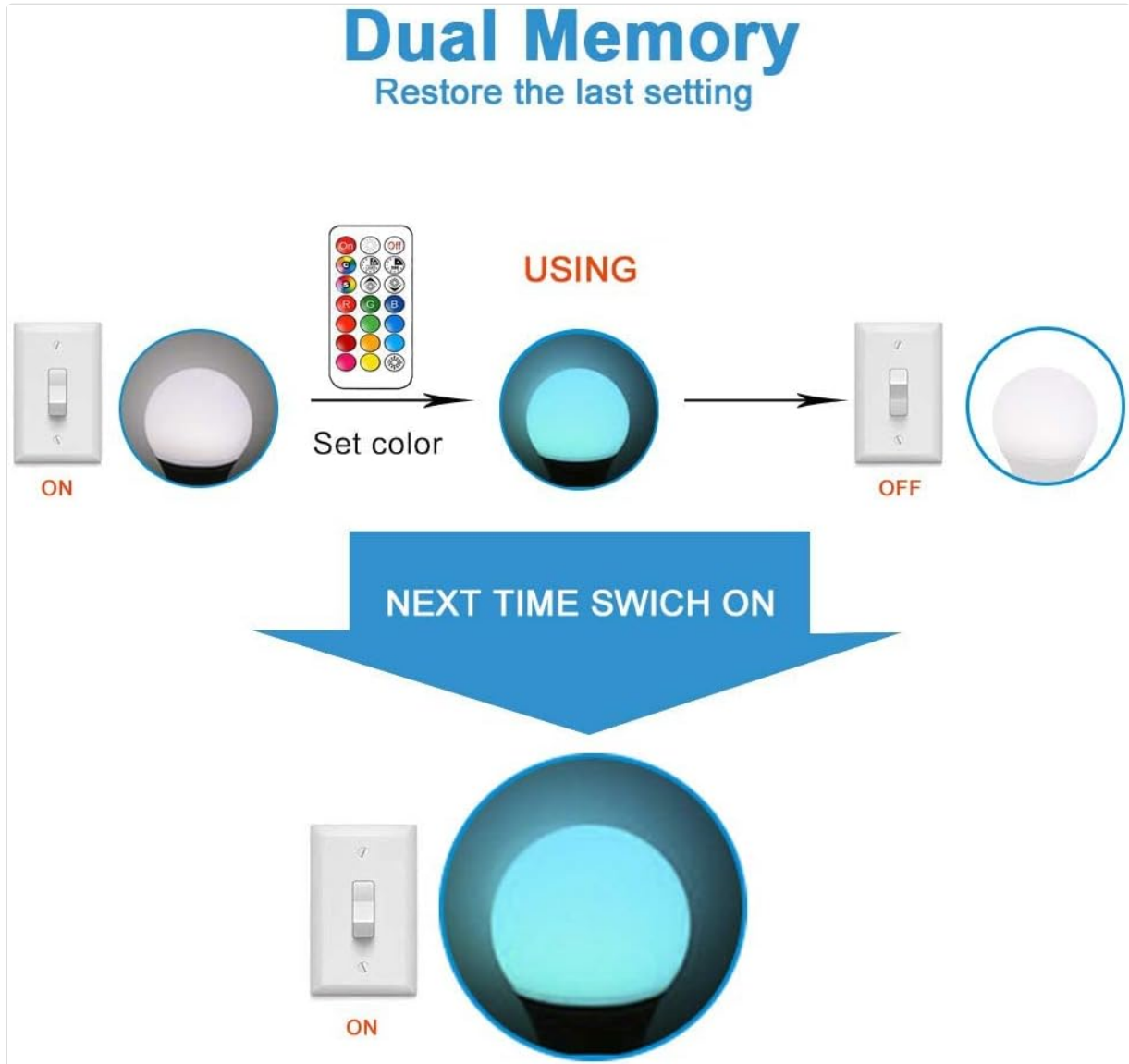

This diagram explains the dual memory function of the VARICART E27 LED bulb. It shows that after setting a color with the remote and turning the bulb off, the bulb will restore the last used color setting when switched on again.

7. MAINTENANCE

- **Cleaning:** To clean the bulb, ensure the power is off and the bulb is cool. Wipe gently with a soft, dry cloth. Do not use liquid cleaners or abrasive materials.
- **No User Serviceable Parts:** The bulb contains no user-serviceable parts. Do not attempt to open or repair it.

8. TROUBLESHOOTING

Problem	Possible Cause	Solution
Bulb does not turn on.	No power to the socket. Bulb not screwed in properly. Remote control battery is dead.	Check the main power switch. Ensure the bulb is securely screwed into the E27 socket. Replace the remote control battery.
Remote control is unresponsive.	Remote is too far from the bulb. Obstruction between remote and bulb. Remote control battery is dead.	Ensure the remote is within 8 meters of the bulb. Remove any obstructions. Replace the remote control battery.
Colors are not changing or dimming.	Remote not pointed directly at the bulb. Using an external dimmer.	Point the remote directly at the bulb. This bulb is not compatible with external dimmers; use only the provided remote for dimming.

9. SPECIFICATIONS

- **Brand:** VARICART
- **Model Number:** BR18-SH4Q
- **Dimensions (L x W x H):** 6 x 6 x 11 cm
- **Weight:** 180 g
- **Voltage:** 230 Volts
- **Power:** 10 Watts (100W Incandescent Equivalent)
- **Luminous Flux:** 1000 lumens
- **Color Temperature:** 6000K (Cool White)
- **Color Rendering Index (CRI):** ≥85
- **Beam Angle:** 220 Degrees
- **Base Type:** E27
- **Average Lifespan:** 50,000 Hours
- **Certifications:** CE, RoHS
- **Material:** Plastic
- **Special Features:** Color Changing, Dimmable, Timing, Memory Function

CRI \geq 85

The higher CRI, the more realistic the colors appear to the naked eye.

VARICART



Traditional light bulb



VS



This image compares the color rendering of the VARICART LED bulb (CRI \geq 85) against a traditional light bulb, demonstrating how a higher CRI makes colors appear more realistic to the naked eye, as shown with a plate of sushi.

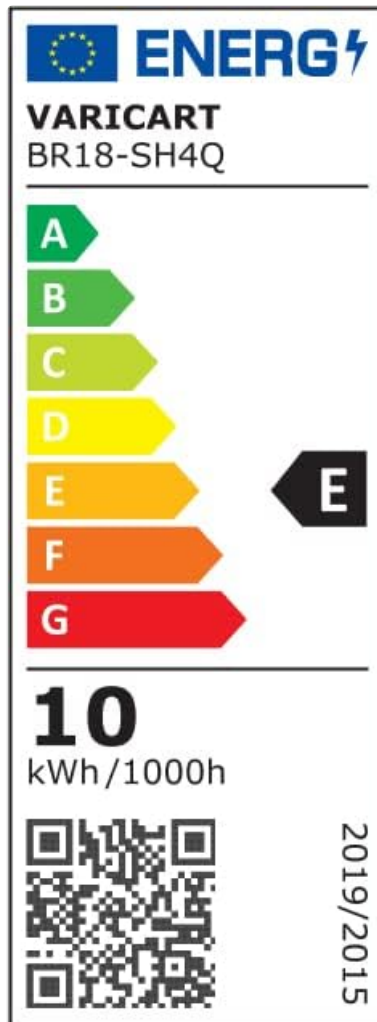

This is the EU energy label for the VARICART BR18-SH4Q LED bulb, showing an energy efficiency class of E and energy consumption of 10 kWh/1000h. A QR code is included for more product information, accessible via <https://eprel.ec.europa.eu/qr/1477450>.

10. WARRANTY AND SUPPORT

VARICART offers a **30-day money-back guarantee** and a **2-year warranty** for this product. If you have any questions, concerns, or require technical assistance, please do not hesitate to contact VARICART customer service. Our team is dedicated to providing support and ensuring your satisfaction. For customer service inquiries, please refer to the contact information provided on your purchase platform or VARICART's official website.