

Manuals+

[Q & A](#) | [Deep Search](#) | [Upload](#)

manuals.plus /

- › [Sukeen](#) /
- › [Sukeen Digital Alarm Clock EN8813 User Manual](#)

Sukeen EN8813

Sukeen Digital Alarm Clock EN8813 User Manual

Model: EN8813

INTRODUCTION

Thank you for choosing the Sukeen Digital Alarm Clock EN8813. This device features a large 6-inch LED display, dual USB charging ports, an automatic dimmer, and an easy-to-use snooze function. This manual provides detailed instructions to help you set up and operate your new alarm clock effectively.



Front view of the Sukeen Digital Alarm Clock EN8813, highlighting its large, clear LED display and mirror surface. The display shows the time 10:20, with a subtle reflection of the surrounding environment.

SETUP

1. **Unpacking:** Carefully remove the alarm clock and all accessories from the packaging.
2. **Protective Film:** Before use, gently peel off the protective film from the display surface.
3. **Power Connection:** Connect the provided power adapter to the "INPUT PORT" on the back of the clock and plug it into a standard electrical outlet. The clock requires continuous power to operate.
4. **Battery Backup:** The clock includes one CR2032 button battery for backup. This battery preserves time and alarm settings during a power outage. It does not power the display. Ensure the battery is correctly installed in the "Button Battery Slot" on the back.
5. **Stand Installation:** Attach the detachable stand to the bottom of the clock for desktop use. Alternatively, use the "Wall Hook" slot on the back for wall mounting.



This image provides the physical dimensions of the Sukeen Digital Alarm Clock EN8813 (6.2 inches wide, 3.1 inches high) and a detailed view of its rear panel, indicating the power cord port, two USB charger ports, wall hook, and button battery slot.

OPERATING INSTRUCTIONS

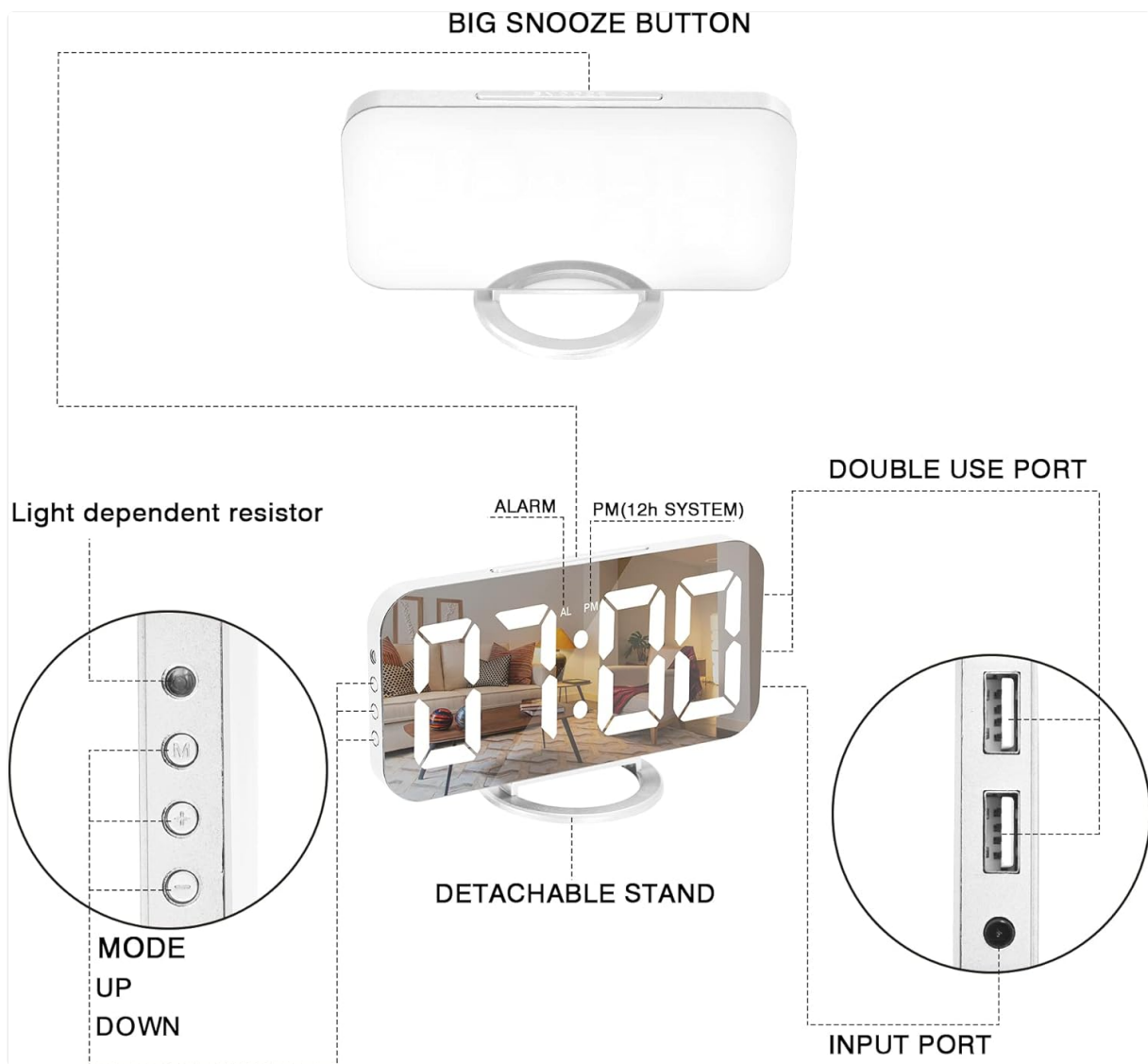

An exploded diagram of the Sukeen Digital Alarm Clock EN8813, labeling key components such as the large snooze button, control buttons (Mode, Up, Down), light-dependent resistor for auto-dimming, detachable stand, and dual USB charging ports.

1. Setting the Time

1. Press and hold the **MODE** button until the hour digits begin to flash.
2. Use the **UP** or **DOWN** buttons to adjust the hour.
3. Press the **MODE** button again to switch to minute adjustment. Use the **UP** or **DOWN** buttons to set the minutes.
4. Press the **MODE** button a third time to select 12-hour or 24-hour format. Use the **UP** or **DOWN** buttons to toggle between formats. In 12-hour mode, a 'PM' indicator will appear for afternoon hours.
5. Press the **MODE** button once more to confirm and exit time setting mode.

2. Setting the Alarm

1. Press the **MODE** button once to enter alarm setting mode. The 'AL' indicator will appear, and the alarm time will be displayed.
2. Press and hold the **MODE** button until the alarm hour digits begin to flash.
3. Use the **UP** or **DOWN** buttons to adjust the alarm hour.
4. Press the **MODE** button again to switch to alarm minute adjustment. Use the **UP** or **DOWN** buttons to set the alarm minutes.

5. Press the **MODE** button once more to confirm and exit alarm setting mode.
6. To activate or deactivate the alarm, short press the **UP** button while in normal time display mode. An alarm icon will appear on the display when the alarm is active.

3. Snooze Function

When the alarm sounds, press the large **SNOOZE** button located on the top of the clock. The alarm will pause for 5 minutes and then sound again. You can repeat this process. To turn off the alarm completely, press any other button (**MODE**, **UP**, or **DOWN**).

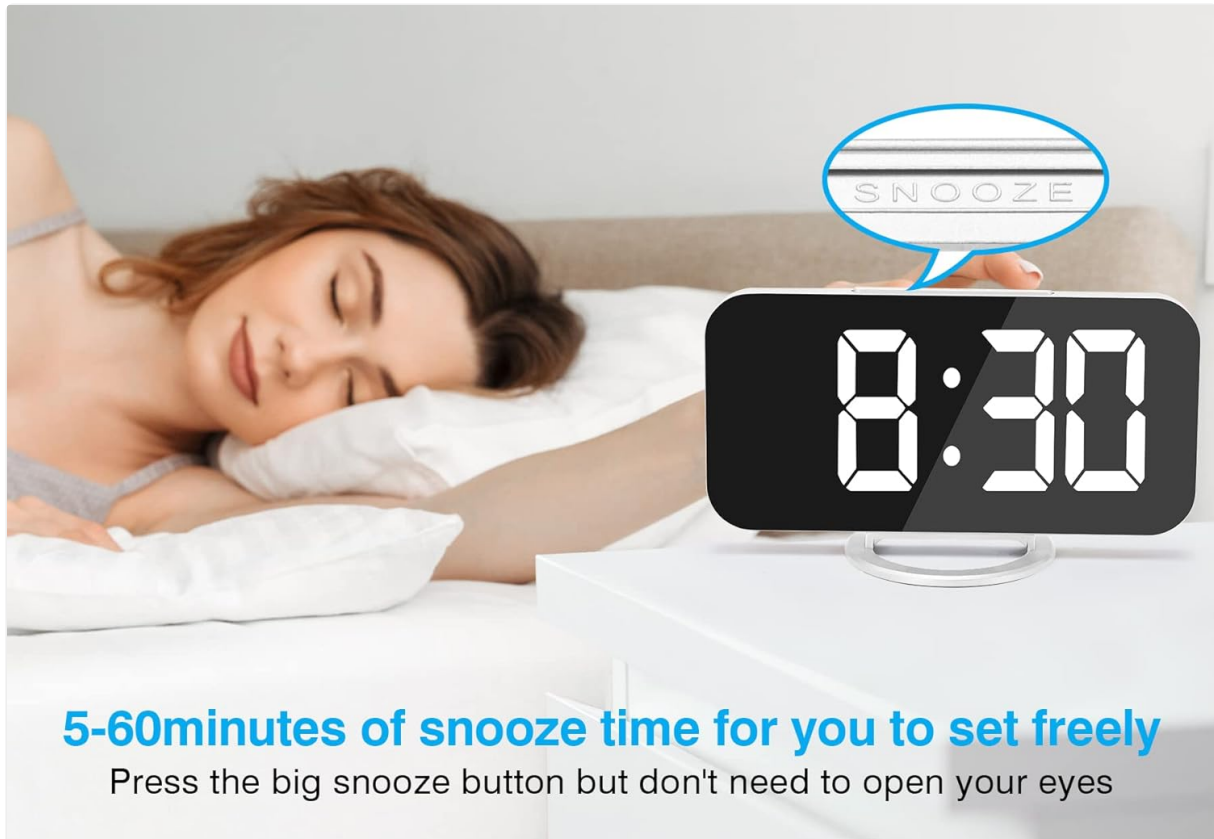

Illustration of the snooze function, showing a hand pressing the large button on top of the clock. The display shows 8:30, indicating an active alarm, with a detail of the 'SNOOZE' label on the button.

4. Brightness Adjustment & Night Mode

The clock offers 3 levels of brightness (Low, Medium, High) and an automatic dimmer mode.

- **Manual Adjustment:** In normal time display mode, short press the **UP** or **DOWN** buttons to cycle through the 3 brightness levels.
- **Auto Dimmer Mode:** Press and hold the **UP** button to activate or deactivate the auto dimmer. When active, the display brightness will automatically adjust based on ambient light conditions, dimming during nighttime hours to prevent disturbance.



3-LEVEL BRIGHTNESS DISPLAYS

Automatic/Manual/Adjustment

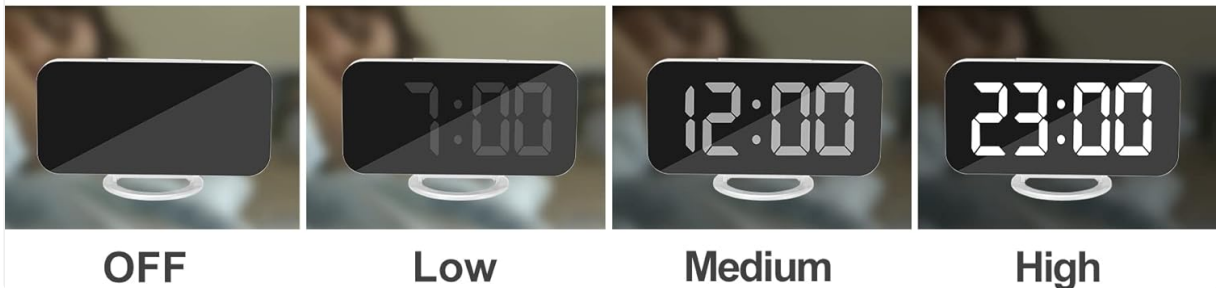

Visual representation of the 3-level brightness adjustment feature of the Sukeen Digital Alarm Clock EN8813. It demonstrates the display in Off, Low, Medium, and High brightness settings, along with an automatic adjustment option.

5. Dual USB Charging Ports

The clock is equipped with two USB charging ports on its side. These ports allow you to charge compatible electronic devices, such as smartphones and tablets, simultaneously. Connect your device's USB charging cable to one of the clock's USB ports.

DUAL USB CHARGING PORTS

Simultaneous high-speed charging for 2 devices



The Sukeen Digital Alarm Clock EN8813 features dual USB charging ports on its side, capable of simultaneously charging two electronic devices like a smartphone and a tablet, as shown in this image.

6. Mirror Surface

The display surface of the alarm clock also functions as a mirror, providing additional utility for daily use.

MIRROR SURFACE

It also can be used as a mirror in daily use



The Sukeen Digital Alarm Clock EN8813 doubles as a mirror, as demonstrated by a woman using it for personal grooming. This image highlights the versatile mirror surface feature.

MAINTENANCE

- **Cleaning:** To clean the clock, gently wipe the surface with a soft, dry cloth. Avoid using abrasive cleaners or solvents, as these may damage the finish or display.
- **Battery Replacement:** If the backup battery (CR2032) needs replacement, open the battery compartment on the back of the clock, remove the old battery, and insert a new one with the correct polarity.
- **Storage:** If storing the clock for an extended period, disconnect it from power and remove the backup battery.

TROUBLESHOOTING

Problem	Possible Cause	Solution
Display is blank.	No power connection.	Ensure the power adapter is securely plugged into the clock and a working electrical outlet.

Problem	Possible Cause	Solution
Alarm does not sound.	Alarm is not activated or set incorrectly.	Verify the alarm time is set correctly and the alarm icon is visible on the display (indicating activation).
USB charging not working.	Device not compatible or cable faulty.	Ensure your device is compatible with USB charging. Try a different USB cable. Confirm the clock is powered.
Display too dim/bright in auto mode.	Ambient light conditions affecting sensor.	Adjust brightness manually by short pressing UP or DOWN , or reposition the clock to optimize light sensor performance.
Time/settings lost after power outage.	Backup battery is dead or missing.	Replace the CR2032 backup battery.

SPECIFICATIONS

Feature	Detail
Brand	Sukeen
Model Number	EN8813
Display Type	Digital LED
Display Size	6.1 inches (approximate)
Product Dimensions	3.3"W x 6.2"H (approximate)
Item Weight	6.7 ounces
Power Source	Corded Electric
Backup Battery	1 x CR2032 (included)
Special Features	12/24H Mode, 3 Level Brightness, Auto Dimmable, Night Mode, Snooze, Dual USB Charger Ports
Material	Acrylonitrile Butadiene Styrene (ABS)
Mounting Type	Tabletop, Wall Mount

WARRANTY AND SUPPORT

The Sukeen Digital Alarm Clock EN8813 comes with a **Limited Warranty**. For specific details regarding warranty coverage, duration, and terms, please refer to the product packaging or contact Sukeen customer support directly. If you encounter any issues or have questions not covered in this manual, please reach out to Sukeen customer support for assistance. Contact information can typically be found on the product packaging or the official Sukeen website.

