

Paulmann 92924

Paulmann 92924 LED Recessed Wall Spot Instruction Manual

1. PRODUCT OVERVIEW

The Paulmann 92924 LED Recessed Wall Spot is designed for discreet wall installation, providing decorative lighting effects and enhancing safety in areas such as hallways or staircases. This round fixture integrates a 1.7-watt LED, emitting a warm white light at 2700 Kelvin, similar to traditional incandescent bulbs. Its compact design and energy-efficient LED technology make it suitable for various indoor applications.



Image 1.1: The Paulmann 92924 LED Recessed Wall Spot, a round white fixture with an oval light opening.

2. SAFETY INSTRUCTIONS

- **Electrical Safety:** Installation must be performed by a qualified electrician or a person with appropriate electrical knowledge to prevent electric shock or fire hazards. Always disconnect power at the main circuit breaker before installation, maintenance, or repair.
- **Intended Use:** This product is designed for indoor use only. Do not install in wet or damp locations.
- **Installation Height:** The maximum recommended installation height for this wall spot is 50 centimeters from the floor to ensure optimal lighting effect and safety.
- **Integrated LED:** The LED light source is permanently integrated into the fixture and cannot be replaced by

the user. Do not attempt to open or modify the LED module.

- **Cleaning:** Use a soft, dry cloth for cleaning. Do not use abrasive cleaners or solvents.

3. PACKAGE CONTENTS

Verify that all components are present before beginning installation:

- 1x Paulmann 92924 LED Recessed Wall Spot (with integrated LED bulb)
- Mounting instructions (this document)

4. SETUP AND INSTALLATION

Follow these steps for proper installation of your Paulmann 92924 LED Recessed Wall Spot. Ensure power is disconnected before proceeding.

1. **Prepare the Installation Location:** Choose a suitable wall location, ensuring it is within the recommended maximum height of 50 cm from the floor. A standard round electrical box (not included) is typically required for recessed installation.
2. **Wiring Connection:** Carefully connect the electrical wires from your mains supply to the terminals on the back of the fixture. Ensure correct polarity (Live, Neutral, Earth) according to local electrical codes. Refer to Image 4.1 for a visual guide to the wiring box and fixture.

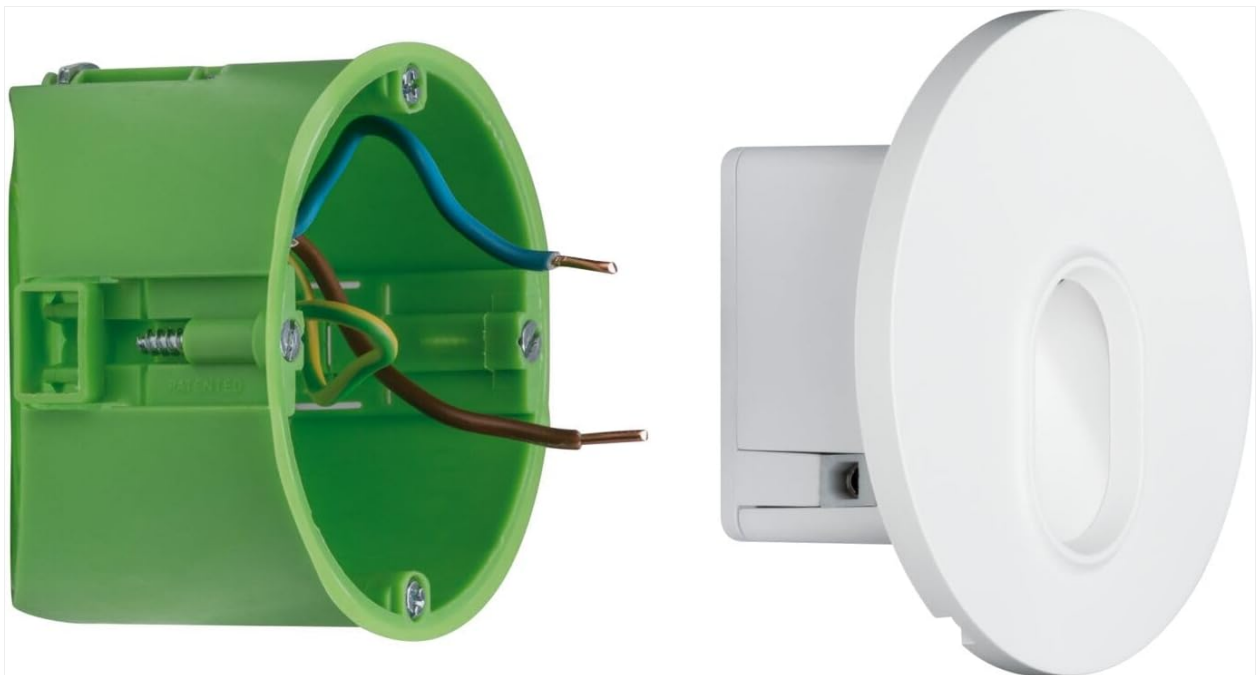

Image 4.1: An example of a green electrical wiring box with connected wires next to the Paulmann 92924 fixture, showing its rear connection points.

3. **Secure the Fixture:** Once wired, carefully insert the fixture into the prepared electrical box in the wall. Ensure it sits flush and is securely fastened. Refer to Image 4.2 for a visual guide.



Image 4.2: Hands guiding the Paulmann 92924 fixture into a green electrical box recessed in a white wall, showing the connection process.

4. **Attach the Front Cover:** Place the decorative front cover onto the main fixture body, ensuring it clicks into place or is securely attached as per the design. Refer to Image 4.3 for a visual guide.



Image 4.3: Hands carefully positioning the white round front cover onto the Paulmann 92924 recessed fixture, completing the installation.

5. **Restore Power:** Once installation is complete and all components are securely in place, restore power at the main circuit breaker.



Image 4.4: Multiple Paulmann 92924 recessed wall spots illuminating a hallway, demonstrating the installed appearance and light distribution.

5. OPERATING INSTRUCTIONS

The Paulmann 92924 LED Recessed Wall Spot operates via your standard wall switch connected to the electrical circuit. There are no additional controls on the fixture itself.

- **Turning On/Off:** Use the wall switch to turn the light fixture on or off.

6. MAINTENANCE

The Paulmann 92924 LED Recessed Wall Spot requires minimal maintenance.

- **Cleaning:** To clean the fixture, ensure power is off. Use a soft, dry, lint-free cloth to gently wipe the surface. Avoid using liquid cleaners, sprays, or abrasive materials, as these can damage the finish or electrical components.
- **LED Lifespan:** The integrated LED has an average lifespan of 30,000 hours. No bulb replacement is necessary or possible.

7. TROUBLESHOOTING

If you encounter issues with your Paulmann 92924 LED Recessed Wall Spot, refer to the following common problems and solutions:

Problem	Possible Cause	Solution
---------	----------------	----------

Problem	Possible Cause	Solution
Light does not turn on.	No power supply.	Check the wall switch and circuit breaker. Ensure power is restored to the circuit.
Light flickers or is dim.	Loose wiring connection.	<i>WARNING: Disconnect power before checking connections.</i> Verify that all electrical connections are secure. If unsure, consult a qualified electrician.
Fixture is hot to the touch.	Normal operation (LEDs generate some heat).	A slight warmth is normal. If it is excessively hot or emits a burning smell, immediately disconnect power and contact Paulmann support.

If the problem persists after attempting these solutions, please contact Paulmann customer support.

8. SPECIFICATIONS

Brand	Paulmann
Model Number	92924
Product Dimensions (L x W x H)	7.8 x 7.8 x 3.5 cm
Weight	91 grams
Material	Plastic
Color	White
Style	Traditional
Shape	Round
Number of Bulbs	1 (integrated LED)
Voltage	230 Volts
Specific Uses	Wall (Indoor)
Special Features	Low energy consumption
Installation Type	Recessed
Bulb Type	LED
Luminous Flux	107 lm
Wattage	1.1 Watts (LED)
Incandescent Equivalent	12 Watts

Color Temperature	2700 Kelvin (Warm White)
Average Lifespan	30,000 Hours
IP Rating	IP20



9. WARRANTY AND SUPPORT

For warranty information or technical support regarding your Paulmann 92924 LED Recessed Wall Spot, please refer to the official Paulmann website or contact their customer service department directly. Details regarding specific warranty periods and terms are typically provided with the product packaging or on the manufacturer's website.

Paulmann is a brand committed to quality lighting solutions. For further assistance, please have your model number (92924) and purchase details ready when contacting support.

© 2023 Paulmann. All rights reserved. Information subject to change without notice.

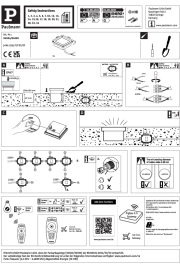
Related Documents - 92924

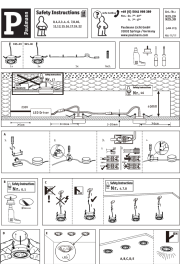
	<p>Paulmann 94504/94595 LED Ground Recessed Luminaire Smart Home Zigbee Installation Guide</p> <p>Detailed installation and safety instructions for the Paulmann 94504/94595 LED ground recessed luminaire. Features Smart Home Zigbee 3.0 connectivity, IP67 rating, and 230V power. Includes multilingual guidance on installation, replaceability, and disposal.</p>
	<p>Paulmann LED Recessed Luminaire Installation and Safety Guide</p> <p>Comprehensive guide for Paulmann LED recessed luminaires, covering installation, safety instructions, component replaceability, and energy efficiency information. Includes product numbers 934.39 through 934.45.</p>
	<p>Paulmann 925.29/925.30 LED Recessed Light Safety and Installation Guide</p> <p>Detailed safety instructions and installation guide for Paulmann 925.29 and 925.30 LED recessed lights. Includes step-by-step diagrams and essential electrical connection information.</p>

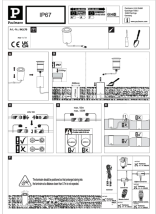

[Paulmann Plug & Shine Floor Individual Spot IP67 Installation Guide](#)

Comprehensive installation guide for the Paulmann Plug & Shine Floor Individual Spot IP67 LED luminaire, detailing mounting, electrical connections, component replaceability, and safety information.

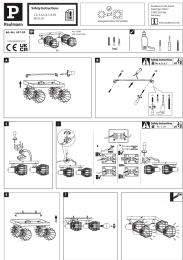

[Paulmann Lanka Spot Light Installation Guide](#)

Comprehensive installation instructions and safety guidelines for the Paulmann Lanka spot light fixture (Article No. 667.69). Covers electrical connections, component replaceability, and technical specifications for safe and proper use.

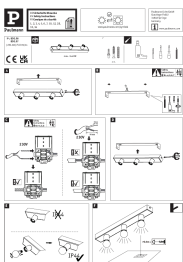

[Paulmann 800.96/800.97 Luminaire Installation Guide & Safety Instructions](#)

Comprehensive installation guide and safety instructions for the Paulmann 800.96 and 800.97 luminaires. Learn how to safely install, wire, and maintain your Paulmann lighting fixture.