

Lenz 46070022

Lenz Nexo 2 Single Lever Kitchen Faucet with Pull-Out Spray

Model: 46070022 | Brand: Lenz

INTRODUCTION

This manual provides comprehensive instructions for the installation, operation, and maintenance of your Lenz Nexo 2 Single Lever Kitchen Faucet. Designed for high flexibility and water/energy saving, this faucet features a durable matte nickel finish. Please read all instructions carefully before installation and use to ensure proper function and longevity of the product.

SAFETY INFORMATION

- Always turn off the main water supply before beginning any installation or maintenance work.
- Ensure all connections are secure to prevent leaks.
- If you are unsure about any step, consult a qualified plumber.
- Do not use abrasive cleaners or harsh chemicals on the faucet finish, as this may cause damage.
- Keep small parts out of reach of children.

PACKAGE CONTENTS

Verify that all components are present before starting installation:

- Nexo 2 Single Lever Kitchen Faucet with Pull-Out Spray
- 2 Flexible connection hoses (600 mm, G3/8)
- Water-saving 35 mm ceramic cartridge
- Quick attachment accessory
- Mounting hardware (washers, nuts, screws)



Figure 1: Exploded view of the mounting hardware, including gaskets, mounting plate, and screws.

SETUP AND INSTALLATION

Follow these steps for proper installation of your Lenz Nexo 2 kitchen faucet:

1. **Prepare the Sink:** Ensure the mounting hole on your sink or countertop is clean and free of debris. The faucet requires a single mounting hole.
2. **Install the Faucet:** Insert the faucet body into the mounting hole. Ensure the base gasket is correctly positioned between the faucet and the sink surface.
3. **Secure the Faucet:** From underneath the sink, slide the rubber washer, then the metal washer, and finally the mounting nut onto the threaded shank of the faucet. Hand-tighten the nut, then use a wrench to secure it firmly.
4. **Connect Water Hoses:** Attach the two flexible connection hoses to the corresponding inlets on the faucet body (typically marked for hot and cold). Connect the other ends of the hoses to your hot and cold water supply lines. Use a 19mm wrench for the water connections to ensure a tight seal.
5. **Install Pull-Out Spray Hose:** Connect the pull-out spray hose to the designated connection point on the faucet body. Ensure the hose moves freely.
6. **Attach Counterweight:** Secure the counterweight to the pull-out spray hose at an appropriate height to ensure smooth retraction of the spray head.

7. **Test for Leaks:** Slowly turn on the main water supply and check all connections for any leaks. Operate the faucet to ensure proper water flow and temperature control.

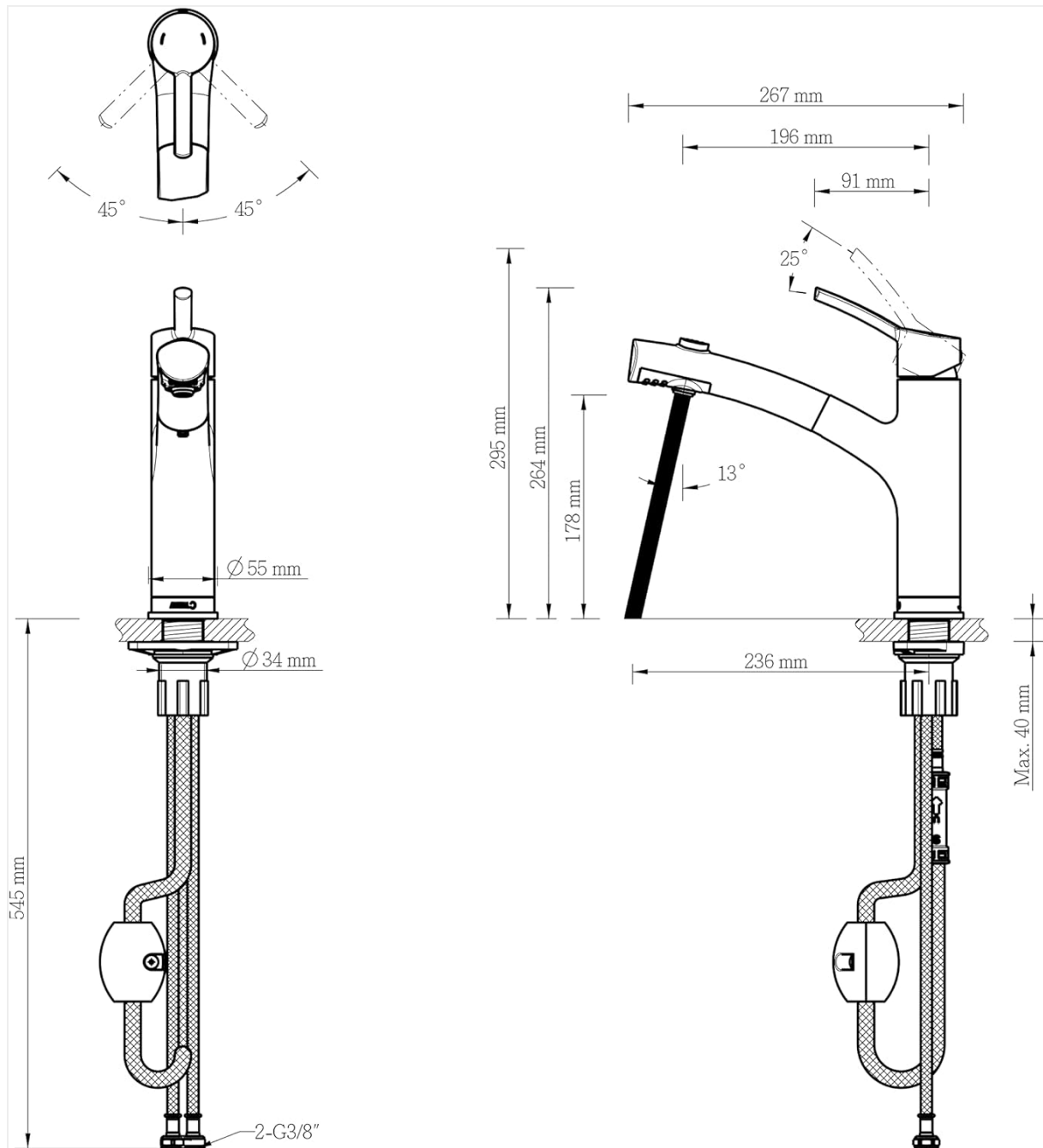

Figure 2: Detailed dimensional drawing showing installation measurements and hose connections.

OPERATING INSTRUCTIONS

Your Lenz Nexo 2 faucet is designed for ease of use:

- **Water Flow and Temperature:** The single lever controls both water flow and temperature. Lift the lever to increase flow. Move the lever left for hot water and right for cold water.
- **Pull-Out Spray:** Gently pull the spray head from the faucet spout. The flexible hose allows for extended reach.
- **Spray Functions:** The spray head features two functions. Press the button on the spray head to switch between a steady stream and a powerful spray.
- **Retracting the Spray:** When finished, guide the spray head back into the spout. The counterweight on the hose will assist in smooth retraction.

MAINTENANCE

Regular maintenance will help preserve the appearance and functionality of your faucet:

- **Cleaning the Finish:** Clean the matte nickel finish with a soft, damp cloth and mild soap. Rinse thoroughly and dry with a soft cloth to prevent water spots. Avoid abrasive cleaners, scouring pads, or harsh chemicals.
- **Aerator Cleaning:** If water flow becomes restricted, the aerator may be clogged. Unscrew the aerator from the tip of the spout, clean any debris, and rinse under running water before reattaching.
- **Ceramic Cartridge:** The faucet is equipped with a durable ceramic cartridge. In case of persistent drips or leaks, the cartridge may need to be replaced. This is a specialized task; contact customer support or a qualified plumber.

TROUBLESHOOTING

Problem	Possible Cause	Solution
Low water flow	Clogged aerator; partially closed shut-off valve	Clean aerator; ensure shut-off valves are fully open
Leaks from faucet base	Loose mounting nut; damaged gasket	Tighten mounting nut; inspect and replace gasket if damaged
Dripping from spout	Worn ceramic cartridge	Replace ceramic cartridge (professional assistance recommended)
Spray head does not retract fully	Counterweight improperly positioned or obstructed hose	Adjust counterweight position; check hose for obstructions

SPECIFICATIONS



Figure 3: Key dimensions of the Lenz Nexo 2 kitchen faucet.

- **Model Number:** 46070022
- **Material:** Brass
- **Finish:** Matte Nickel
- **Installation Method:** Single Hole Deck Mount
- **Number of Handles:** 2 (Lever for hot/cold, button for spray function)
- **Hose Length:** 600 mm (flexible connection hoses)
- **Faucet Spout Reach:** 19 cm
- **Product Dimensions:** 26.3 x 6 x 23.4 cm
- **Item Weight:** 2.29 Kilograms
- **Special Feature:** Water Saving
- **Included Components:** Faucet, 2 flexible connection hoses, 35mm ceramic cartridge, quick attachment, pull-out spray with two functions.

WARRANTY INFORMATION

The Lenz Nexo 2 Kitchen Faucet comes with a **10-year manufacturer's warranty** against defects in materials and workmanship. This warranty covers the original purchaser and is valid from the date of purchase. Please retain your proof of purchase for warranty claims. The warranty does not cover damage caused by improper installation, misuse, abuse, accident, or normal wear and tear.

SUPPORT

For technical assistance, replacement parts, or warranty inquiries, please contact Lenz customer support. Refer to the contact information provided with your purchase documentation or visit the official Lenz website.

Online Resources: For additional support and FAQs, please visit www.lenz.com (example link, replace with actual if available).