

IKRA IMH 2500 (Model 81003000)

IKRA Electric Garden Shredder IMH 2500 Instruction Manual

Model: IMH 2500 (Model 81003000) | Brand: IKRA

1. INTRODUCTION

This manual provides essential information for the safe and efficient operation, maintenance, and troubleshooting of your IKRA IMH 2500 Electric Garden Shredder. Please read this manual thoroughly before operating the machine and keep it for future reference.

Safety First: Always prioritize safety. Wear appropriate personal protective equipment (PPE) such as safety glasses, hearing protection, and sturdy gloves when operating the shredder. Ensure the work area is clear of bystanders and pets.



Figure 1: IKRA IMH 2500 Electric Garden Shredder with included 45L collection bag and pusher.

2. PRODUCT COMPONENTS

The IKRA IMH 2500 Electric Garden Shredder consists of several key components designed for efficient garden waste processing:

- **Main Unit:** Houses the powerful 2500W motor and shredding mechanism.
- **Hopper:** The top opening where garden waste is fed into the shredder. Designed to handle branches up to

approximately 45mm in diameter.

- **Reversible Blades:** Two hardened steel blades responsible for shredding material. These can be reversed for extended life.
- **Pusher:** A tool provided to safely push material into the hopper, especially shorter pieces.
- **Collection Bag (45L):** A durable bag designed to collect shredded material, attaching securely to the shredder.
- **Wheels and Transport Handle:** For easy mobility around the garden.
- **Safety Lock:** Ensures the machine does not operate when the hopper is open.
- **Overload Protection:** Automatically stops the motor to prevent damage in case of jamming or excessive load.
- **Restart Protection:** Prevents the shredder from automatically restarting after a power interruption.



Figure 2: The hopper opening with the pusher tool inserted, showing the maximum branch diameter warning.



Figure 3: Detail of the integrated bag holder for the 45L collection bag.

3. SETUP AND ASSEMBLY

Before first use, some assembly is required. Follow these steps carefully:

1. **Unpacking:** Carefully remove all components from the packaging. Check for any damage or missing parts.
2. **Wheel Assembly:** Attach the wheels to the robust chassis as per the instructions provided in the separate assembly guide (if applicable). Ensure they are securely fastened for stable operation and transport.



Figure 4: The robust chassis with wheels for easy transport.

3. **Attach Collection Bag:** The 45-liter collection bag is designed to attach to the integrated bag holder. Hook the bag's handles onto the designated clips on the shredder's body. Ensure the bag is fully open and positioned correctly to receive shredded material.



Figure 5: Attaching the 45L collection bag to the shredder's integrated holder.

4. **Positioning:** Place the shredder on a firm, level surface in a well-ventilated outdoor area. Ensure there is sufficient space around the machine for safe operation and material handling.
5. **Power Connection:** Connect the shredder to a suitable outdoor power outlet (230V). Ensure the power cord is in good condition and positioned to avoid tripping hazards or damage by the machine.

4. OPERATING INSTRUCTIONS

Follow these guidelines for safe and effective operation of your IKRA IMH 2500 shredder:

4.1. Preparing for Operation

- Ensure all safety features, including the safety lock for the hopper, are functioning correctly.
- Verify the collection bag is properly attached and empty before starting.
- Gather the material to be shredded. The shredder is designed for branches and woody garden waste up to 45mm in diameter. Avoid feeding soft, wet, or fibrous materials that may clog the machine.

4.2. Starting and Feeding

1. **Power On:** Locate the power switch (typically a red rocker switch) and turn the shredder ON. The motor will start.



Figure 6: The main power switch and control panel.

2. **Feeding Material:** Carefully feed branches and garden waste into the hopper. For longer branches, hold them with both hands and guide them into the opening.



Figure 7: User demonstrating proper feeding technique for branches.

3. **Using the Pusher:** For shorter pieces or when the material is no longer reachable by hand, use the provided pusher to safely guide the material into the blades. *Never use your hands or feet to push material into the hopper.*



Figure 8: The pusher tool is essential for safely feeding material.

4. **Monitor Collection Bag:** Regularly check the collection bag. Once full, turn off the shredder, disconnect from power, and empty the bag.



Figure 9: The 45L collection bag efficiently gathers shredded garden waste.

4.3. Stopping Operation

- To stop the shredder, turn the power switch to the OFF position.
- Always disconnect the machine from the power supply before performing any maintenance, cleaning, or if leaving the machine unattended.

5. MAINTENANCE

Regular maintenance ensures the longevity and optimal performance of your shredder. Always disconnect the power supply before any maintenance work.

5.1. Cleaning

- After each use, clean the shredder to prevent material buildup.
- Ensure the output chute is completely clear of shredded material to prevent blockages and potential overheating.
- The hopper can be opened for easier internal cleaning. The safety lock will automatically cut power when the hopper is opened.



Figure 10: The hopper can be opened for cleaning and blade access.

5.2. Blade Maintenance

The shredder is equipped with durable reversible blades. Over time, blade performance may decrease. To maintain optimal cutting efficiency:

- **Reversing Blades:** If the blades become dull, they can be reversed to utilize the other sharp edge. This extends their lifespan. Refer to the specific instructions in your assembly guide for blade reversal.



Figure 11: The hardened steel reversible blades are key to shredding performance.

- **Replacing Blades:** When both sides of the blades are dull, they should be replaced with genuine IKRA replacement blades.
- Always ensure the shredder is unplugged and the hopper is securely closed after blade maintenance.

6. TROUBLESHOOTING

This section provides solutions to common issues you might encounter:

Problem	Possible Cause	Solution
Shredder does not start.	No power supply, power switch OFF, safety lock not engaged, restart protection active.	Check power connection. Ensure power switch is ON. Close hopper securely. If power was interrupted, press the power button again to restart.
Shredder stops during operation.	Overload protection activated (jammed material, too thick branch), power interruption.	Turn off and unplug. Open hopper (power will cut). Clear any jammed material. Ensure output chute is clear. Wait a few minutes for motor to cool if overheated. Restart.
Material is not shredding effectively.	Dull blades, feeding too quickly, material type unsuitable.	Reverse or replace blades. Feed material at a slower, consistent pace. Ensure material is dry and within the specified diameter (max 45mm).
Excessive vibration or noise.	Unbalanced blades, loose components, foreign object.	Turn off and unplug. Inspect blades for damage or imbalance. Check all fasteners. Remove any foreign objects. If problem persists, contact service.

7. TECHNICAL SPECIFICATIONS

Feature	Specification
Brand	IKRA
Model Number	81003000
Product Name	IMH 2500 Electric Garden Shredder
Color	Grey / Red
Product Dimensions (L x W x H)	46 x 37 x 91 cm
Item Weight	10.5 Kilograms
Collection Bag Capacity	45 Liters
Power	2500 Watts

Feature	Specification
Voltage	230 Volts
Noise Level	106 dB
Max Branch Diameter	Approx. 45 mm



Figure 12: Product label with detailed technical specifications.

8. WARRANTY INFORMATION

IKRA products are manufactured to high-quality standards. For specific warranty terms and conditions, please refer to the warranty card included with your product or visit the official IKRA website. Keep your proof of purchase for any warranty claims.

9. CUSTOMER SUPPORT

If you have any questions, require technical assistance, or need to order spare parts, please contact your retailer or the official IKRA customer service. Contact details can typically be found on the IKRA website or on the product packaging.

For more information about IKRA products, visit:[IKRA Brand Store](#)

10. PRODUCT VIDEOS

No official seller videos were provided for this product in the available data. For product demonstrations or additional information, please check the manufacturer's official website or authorized retailers.

© 2023 IKRA. All rights reserved. Information in this manual is subject to change without notice.

Related Documents

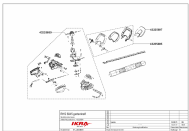
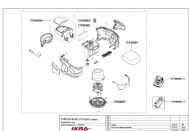
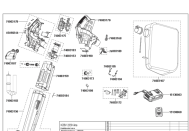
	<p>IKRA RHS 6045 Gartenkraft Parts List and Diagram</p> <p>Exploded view diagram and parts list for the IKRA RHS 6045 Gartenkraft garden tool, featuring part numbers and technical specifications.</p>
	<p>IKRA PMARM 4046S Primaster Exploded View Parts List</p> <p>Detailed exploded view diagrams and part numbers for the IKRA PMARM 4046S Primaster garden tool, covering motor, housing, and axle components. Includes part identification and revision history.</p>
	<p>ikra ICBV 2/20 ikra Parts List and Exploded View Diagram</p> <p>Detailed exploded view diagram and parts list for the ikra ICBV 2/20 ikra product, featuring part numbers, component identification, and revision history.</p>

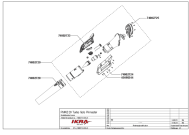

[IKRA PMAB 20 Turbo Solo Primaster Parts List and Diagram](#)

Detailed parts list and exploded view diagram for the IKRA PMAB 20 Turbo Solo Primaster, including part numbers, product information, and revision history.