

## Thule 145201

# Thule 145201 Roof Racks Custom Fit Kit User Manual

Model: **145201** | Brand: **Thule**

## INTRODUCTION

---

This user manual provides essential information for the proper installation, operation, and maintenance of your Thule 145201 Custom Fit Kit. This kit is designed to enable the secure mounting of a Thule roof rack system on vehicles that do not have pre-existing roof rack attachment points or factory-installed racks. Please read these instructions carefully before beginning installation to ensure safety and optimal performance.

## PRODUCT OVERVIEW

---

The Thule 145201 Custom Fit Kit is a specialized component that integrates with Thule Evo Clamp and Thule Edge Clamp foot packs. It provides a custom, secure interface between your vehicle's roof and the Thule roof rack system. The kit includes precisely engineered metal brackets and protective rubber pads to ensure a snug fit and prevent damage to your vehicle's paintwork.

**Important: Before purchasing or installing, always check the official Thule Buyer's Guide to confirm that this specific fit kit (145201) is compatible with your vehicle make, model, and year.**

## WHAT'S IN THE BOX

---

Upon opening the package, please verify that all components are present and undamaged:

- Metal brackets (specific to vehicle fit)
- Rubber pads (specific to vehicle fit)



This image displays the primary components of the Thule 145201 Custom Fit Kit: the black metal brackets and the corresponding rubber pads. These parts are designed to create a secure and custom attachment point for Thule roof rack systems on vehicles without pre-existing roof rack attachment points.

## SETUP AND INSTALLATION

The Thule 145201 Custom Fit Kit is an integral part of a complete Thule roof rack system. Installation requires careful attention to detail and adherence to the specific instructions provided with your Thule foot pack and load bars, as well as the vehicle-specific instructions for this fit kit.

1. **Preparation:** Ensure your vehicle's roof is clean and dry where the fit kit components will be placed.
2. **Identify Components:** Match the metal brackets and rubber pads to their designated positions on your vehicle, as indicated in the detailed instructions accompanying your Thule foot pack. The rubber pads are designed to protect your vehicle's paint and provide grip.
3. **Attach Rubber Pads:** Securely attach the rubber pads to the underside of the foot pack and/or the metal brackets as specified in the foot pack manual.
4. **Position Brackets:** Place the metal brackets onto the vehicle's door frame or designated attachment points. These brackets are shaped to precisely fit the contours of your vehicle.
5. **Assemble Foot Pack:** Integrate the foot pack with the metal brackets and load bars according to the foot pack's instructions. Ensure all bolts and fasteners are tightened to the specified torque settings.

6. **Final Check:** After installation, gently pull on the assembled roof rack system to confirm it is securely attached and does not move. Re-check all connections after the first short drive.

*For detailed, step-by-step installation instructions, always refer to the comprehensive manual included with your Thule foot pack and load bars, which will provide vehicle-specific diagrams and torque specifications.*

## OPERATING CONSIDERATIONS

---

Once your Thule roof rack system, including the 145201 Custom Fit Kit, is correctly installed, observe the following operational guidelines:

- **Load Capacity:** Do not exceed the maximum load capacity of 80 kg (176 lbs) for the roof rack system, or the maximum roof load capacity specified by your vehicle manufacturer, whichever is lower.
- **Weight Distribution:** Distribute cargo evenly on the roof rack to maintain vehicle stability.
- **Driving Speed:** Adjust driving speed to suit road conditions, especially when carrying cargo. Crosswinds and sudden braking can affect vehicle handling.
- **Height Clearance:** Be aware of the increased vehicle height when entering garages, car washes, or low-clearance areas.
- **Regular Checks:** Periodically check the tightness of all mounting bolts and connections, especially before long trips and after driving on rough roads.

## MAINTENANCE

---

Proper maintenance will extend the life of your Thule 145201 Custom Fit Kit and ensure continued safe operation:

- **Cleaning:** Clean the metal brackets and rubber pads regularly with mild soap and water. Avoid harsh chemicals or abrasive cleaners that could damage the finish or material.
- **Inspection:** Periodically inspect the rubber pads for signs of wear, cracking, or deterioration. Replace any damaged pads immediately to prevent damage to your vehicle.
- **Storage:** If removing the roof rack system for extended periods, store the fit kit components in a dry, clean place away from direct sunlight and extreme temperatures.
- **Fastener Check:** Regularly check the tightness of all fasteners, especially those connecting the fit kit to the foot pack and the foot pack to the vehicle.

## TROUBLESHOOTING

---

If you encounter issues with your Thule 145201 Custom Fit Kit, consider the following:

- **Loose Fit:** If the roof rack feels loose after installation, re-check all torque settings as specified in your foot pack manual. Ensure the correct fit kit for your vehicle has been used.
- **Noise:** Excessive wind noise can sometimes indicate improper installation or loose components. Verify all parts are securely fastened and correctly aligned.
- **Damage to Vehicle:** If you notice any marks or damage on your vehicle's paint, immediately remove the rack and inspect the rubber pads and contact points. Ensure pads are correctly positioned and free of debris.
- **Missing Parts:** If any parts are missing or damaged upon arrival, contact your retailer or Thule customer support immediately.

SPECIFICATIONS

Attribute	Detail
Model	Kit Clamp 5201
Manufacturer Part Number	145201
Color	Black
Item Dimensions (L x W x H)	6.3 x 6.3 x 6.3 inches
Load Capacity	80 kg
Mounting Type	Roof Mounted
Item Weight	1.85 pounds
Manufacturer	Thule

WARRANTY AND SUPPORT

Thule products are rigorously tested and are subject to strict quality controls. For information regarding warranty coverage, claims, or technical support, please visit the official Thule website or contact Thule customer service directly. Always retain your proof of purchase.

For further assistance, you may visit the [Thule Store on Amazon](#).

© 2023 Thule. All rights reserved. Information subject to change without notice.

Documents - Thule – 145201

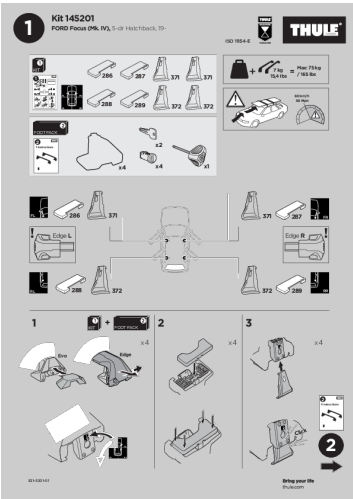

[\[pdf\]](#) User Manual Instructions

145201 kit user manual Thule Fitting Instructions 5637 c281db3600e075510559c0f3ffd4b2fb roof racks co  
 uk s products |||

1 Kit **145201** FORD Focus Mk. IV , 5-dr Hatchback, 19- 1 KIT 1 FL RL FL FR RL RR  
 FL Click RL FR RR 2 FOOT PACK 2 Instructions 286 287 371 288 289 372 x2 x4 x4  
 ISO 11154-E 371 372 7 kg 15,4 lbs Max: 75 kg / 165 lbs 80 km/h 50 Mph x1 FL 286  
 371 Edge L 371 287 FR Edge R...

lang:en score:52 filesize: 413.59 K page\_count: 2 document date: 2019-07-25

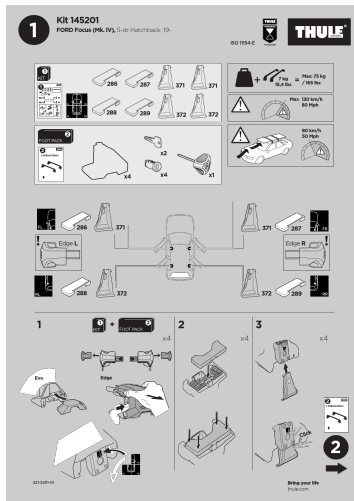

[\[pdf\]](#) Instructions

145201 shop1auto au Fitting instructions Thule |||

1 Kit **145201** FORD Focus Mk. IV , 5-dr Hatchback, 19- ISO 11154-E 1 KIT 1 FL RL FL FR RL RR FL Click RL FR RR 2 FOOT PACK 2 Instructions 286 287 371 288 289 372 x2 x4 x4 371 372 x1 7 kg 15,4 lbs Max: 75 kg / 165 lbs Max 130 km/h 80 Mph 80 km/h 50 Mph FL 286 371 Edge L ...

lang:en **score:48** filesize: 478.07 K page\_count: 2 document date: 2020-12-04



[Thule Guide 2021: Roof Racks & Bike Racks for Your Active Life](#)

Explore the Thule Guide 2021 for comprehensive information on Thule roof racks and rear door-mounted bike racks, helping you find the perfect fit for your vehicle and lifestyle. Discover solutions for carrying your gear and enjoying an active life.

lang:en **score:30** filesize: 8 M page\_count: 77 document date: 2021-03-22

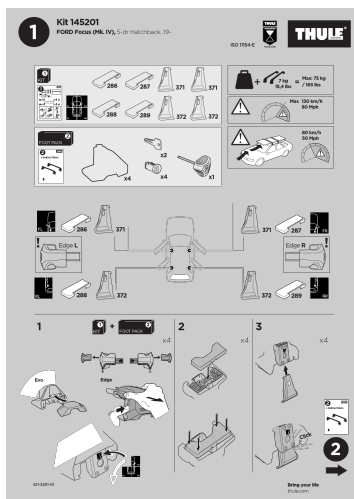

[\[pdf\]](#) Instructions

Brugervejledning 95 5201 Tagbøjler Ford Focus Mk Iv 5 Dr Hatchback 19 FDMshop dk fdmshop files |||

1 Kit **145201** FORD Focus Mk. IV , 5-dr Hatchback, 19- ISO 11154-E 1 KIT 1 FL RL FL FR RL RR FL Click RL FR RR 2 FOOT PACK 2 Instructions 286 287 371 288 289 372 x2 x4 x4 371 372 x1 7 kg 15,4 lbs Max: 75 kg / 165 lbs Max 130 km/h 80 Mph 80 km/h 50 Mph FL 286 371 Edge L ...

lang:en **score:16** filesize: 476.49 K page\_count: 2 document date: 2019-11-13