

## Reginox R31780

# Reginox Spring Stainless Steel Single Hand Mixer Sink Faucet User Manual

Model: R31780



Image: The Reginox Spring Stainless Steel Single Hand Mixer Sink Faucet, showcasing its sleek, brushed stainless steel finish and elegant curved spout.

## INTRODUCTION

---

Thank you for choosing the Reginox Spring Stainless Steel Single Hand Mixer Sink Faucet. This manual provides essential information for the safe and efficient installation, operation, and maintenance of your new faucet. Please read this manual thoroughly before installation and keep it for future reference. Proper installation and care will ensure long-lasting performance and satisfaction with your Reginox product.

## IMPORTANT SAFETY INSTRUCTIONS

---

- Always turn off the main water supply before beginning any installation or maintenance work.
- If you are unsure about any part of the installation process, it is recommended to consult a qualified plumber.
- Wear appropriate personal protective equipment, such as safety glasses and gloves, during installation.
- Ensure all connections are secure and watertight to prevent leaks.
- Do not use abrasive cleaners or harsh chemicals on the faucet's surface, as this may damage the finish.

## PACKAGE CONTENTS

---

Please verify that all components are present before beginning installation:

- Reginox Spring Stainless Steel Single Hand Mixer Sink Faucet (Main Unit)
- Mounting Hardware (nuts, washers, gaskets)
- Flexible Connection Hoses (G 3/8" standard)
- Installation Manual (this document)

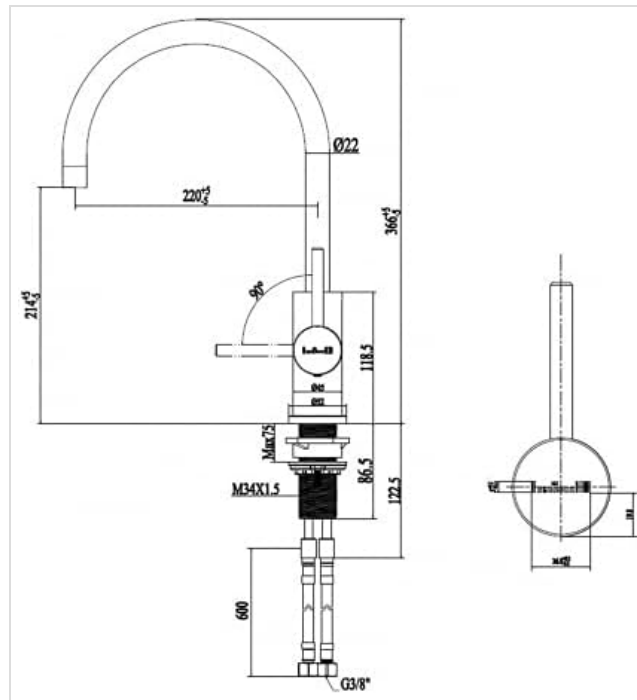

Image: Technical diagram illustrating the dimensions and connection points of the Reginox Spring faucet, including the G 3/8" connectors and mounting details.

## INSTALLATION GUIDE

This faucet is designed for single-hole, deck-mount installation. Follow these steps carefully:

1. **Prepare the Sink/Countertop:** Ensure the mounting hole in your sink or countertop is clean and free of debris. The faucet requires a standard single hole for installation.
2. **Install the Faucet:** Place the faucet base into the mounting hole. Ensure the rubber gasket is correctly positioned between the faucet base and the sink surface to prevent water leakage.
3. **Secure the Faucet:** From underneath the sink, slide the metal washer and then the mounting nut onto the threaded shank of the faucet. Tighten the nut securely using an appropriate wrench. Do not overtighten.
4. **Connect Water Supply Lines:** Attach the flexible hot and cold water supply hoses (G 3/8" standard) to the corresponding inlets on the faucet. Connect the other ends of the hoses to your hot and cold water supply valves. Ensure all connections are hand-tightened first, then gently tightened with a wrench.
5. **Check for Leaks:** Slowly turn on the main water supply. Check all connections for any signs of leakage. If leaks are detected, gently tighten the connections until the leak stops.
6. **Test Operation:** Operate the faucet handle to ensure proper hot and cold water flow and temperature mixing. Allow water to run for a few minutes to flush out any debris from the new installation.

## OPERATING YOUR FAUCET

The Reginox Spring faucet features a single lever for easy control of water flow and temperature. The swivel spout allows for flexible use in your sink area.

- **Water Flow Control:** Lift the lever handle upwards to increase water flow. Push it downwards to decrease or shut off the flow.
- **Temperature Control:** Move the lever handle to the left for hot water and to the right for cold water. Adjust the position to achieve your desired water temperature.
- **Swivel Spout:** The spout can be rotated to direct water flow as needed, providing convenience for various kitchen tasks.

This faucet is designed for economical consumption, providing efficient water usage without compromising performance.

## CARE AND MAINTENANCE

To maintain the pristine appearance and functionality of your Reginox faucet, follow these simple care instructions:

- **Regular Cleaning:** Clean the faucet regularly with a soft cloth and mild soap and water. Rinse thoroughly and dry with a soft cloth to prevent water spots.
- **Avoid Harsh Cleaners:** Do not use abrasive cleaners, scouring pads, ammonia-based cleaners, or any cleaners containing bleach, acids, or alcohol. These can damage the stainless steel finish and internal components.
- **Aerator Maintenance:** If water flow becomes restricted, the aerator at the tip of the spout may be clogged. Unscrew the aerator, clean any debris, and rinse it under running water before reattaching.
- **Ceramic Cartridge:** The faucet is equipped with a durable 35mm ceramic cartridge, designed for long-term, drip-free performance. If issues arise with water flow or temperature control, professional service may be required to inspect or replace the cartridge.

## TROUBLESHOOTING

If you encounter any issues with your faucet, refer to the table below for common problems and their solutions:

Problem	Possible Cause	Solution
Low Water Flow	Clogged aerator; partially closed shut-off valve; kinked supply line.	Clean the aerator; ensure shut-off valves are fully open; check supply lines for kinks.
Leaking from Spout	Worn ceramic cartridge.	Contact a qualified plumber for cartridge inspection or replacement.
Leaking from Base	Loose mounting nut; improperly seated gasket.	Tighten mounting nut; ensure gasket is correctly positioned.
No Hot/Cold Water	Supply valve closed; issue with water heater/supply.	Check hot/cold supply valves are open; consult a plumber if supply is confirmed.

If the problem persists after attempting these solutions, please contact Reginox customer support or a qualified plumber.

## PRODUCT SPECIFICATIONS

Feature	Specification
Model Number	R31780
Brand	Reginox
Material	Stainless Steel
Finish	Stainless Steel (Brushed)
Height	366 mm
Spout Reach (Exhaust)	214 mm
Connector Type	High Pressure
Connector Standard	G 3/8" (according to German standard)
Ceramic Cartridge Size	35 mm
Installation Method	Single Hole, Deck Mount
Number of Handles	1 (Lever Style)
Recommended Use	Kitchen Sink

## WARRANTY AND SUPPORT

Reginox products are manufactured to high quality standards and are designed for durability. For specific warranty information regarding your Reginox Spring Stainless Steel Faucet, please refer to the warranty card included with your purchase or visit the official Reginox website.

For technical assistance, spare parts, or any other inquiries, please contact Reginox customer support through their official channels. When contacting support, please have your model number (R31780) and purchase details ready.

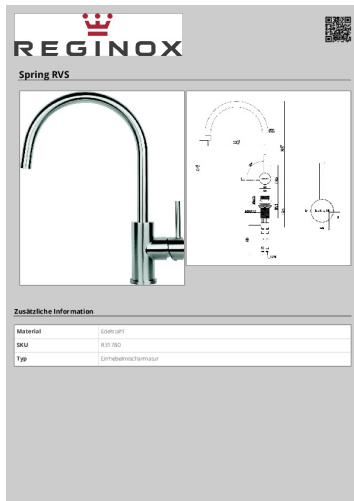

### [Reginox Spring RVS Faucet - Stainless Steel Single-Lever Mixer Tap](#)

Discover the Reginox Spring RVS faucet, a high-quality single-lever mixer tap crafted from durable stainless steel. Featuring a modern design with a high arc spout and precise dimensions, SKU R31780.

lang: **score:26** filesize: 1.32 M page\_count: 1 document date: 2021-12-15



### [\[pdf\] Instructions Accessories Catalog](#)

Reginox katalog 2019 Katalogy Alin eshop cz filename 410 alin editor image stranky3 soubory |||  
 PRODUCT CATALOGUE THE CROWN FOR YOUR KITCHEN 1 INDEX 3. DUTCH  
 QUALITY FOR THE KITCHEN 46. TEXAS ... 97 Brushed stainless steel Single-  
 handle tap only forward SPRING STAINLESS STEEL Article number **R31780**  
 Brushed stainless steel Single-handle tap only forward MODERN DESIGNED  
 KITCHEN TAPS 103 P...

lang:en **score:20** filesize: 24.11 M page\_count: 59 document date: 2019-10-09



### [\[pdf\] Instructions](#)

KITCHEN Ostermann Met een innovatief aanbod richten wij ons op de nationale én internationale keuken  
 en projectmarkt Op grond van onze ervaring weten wat consumenten Reginox Katalog 2019 NL content  
 ostermann eu webcontent hlr system Dokumente |||  
 P R O D U C T A T A L O G U S THE CROWN FOR YOUR KITCHEN 1 INHOUDS-  
 OPGAVE 3. WIE IS REGINOX 46. ... tikelnummer R31797 Geborsteld rvs Eenhendel  
 mengkraan enkel naar voren SPRING RVS Artikelnummer **R31780** Geborsteld rvs  
 Eenhendel mengkraan enkel naar voren MODERN VORMGEGEVEN  
 KEUKENKRANEN 103 P...

lang:nl **score:19** filesize: 22.16 M page\_count: 59 document date: 2019-08-27

[\[pdf\]](#)



REGINOX 2021 4 luik ECK Brio 02 10 — QUEEN 60 INCL RESTENBAKJE Kastmaat 600 mm Diepte 160  
130 Afmeting spoelbak 330 x 400 300 Totale afmeting 595 470 Reginox Programma engels be CataGH |||  
COLORADO COMFORT Kastmaat 450 mm Diepte 160 mm Afmeting spoelbak 403 x  
353 mm Totale afmeting ... T Artikelnummer R31681 362,50 JAPURA ZWART  
Artikelnummer R31551 412,00 SPRING RVS Artikelnummer **R31780** 179,50 HURON  
RVS Artikelnummer R34576 136,50 KELSO RVS Artikelnummer R34590 114,50  
LOGA...

lang:tl score:16 filesize: 1.88 M page\_count: 2 document date: 2021-02-09