



Manuals.plus /

› COSTWAY /

› Costway Portable Multifunctional Sewing Machine User Manual

COSTWAY 23469-CYPE-CS

Costway Portable Multifunctional Sewing Machine User Manual

Model: 23469-CYPE-CS

1. IMPORTANT SAFETY INSTRUCTIONS

When using an electrical appliance, basic safety precautions should always be followed, including the following:

- Read all instructions before using this sewing machine.
- Keep these instructions in a convenient place near the machine.
- Always unplug the machine from the electrical outlet immediately after using and before cleaning, making any adjustments, or removing covers.
- Do not allow to be used as a toy. Close attention is necessary when this appliance is used by or near children.
- Use this appliance only for its intended use as described in this manual. Use only attachments recommended by the manufacturer.
- Never operate this appliance if it has a damaged cord or plug, if it is not working properly, if it has been dropped or damaged, or dropped into water.
- Never operate the appliance with any air openings blocked. Keep air openings free of lint, dust, and loose cloth.
- Never drop or insert any object into any opening.
- Do not use outdoors.
- Do not operate where aerosol (spray) products are being used or where oxygen is being administered.
- To disconnect, turn all controls to the off position, then remove plug from outlet.
- Do not unplug by pulling on cord. To unplug, grasp the plug, not the cord.

2. PRODUCT OVERVIEW

The Costway Portable Multifunctional Sewing Machine (Model 23469-CYPE-CS) is designed for various sewing tasks, offering convenience and versatility. It features a compact design, making it suitable for small spaces and easy transport.

Key Features:

- **16 Built-In Stitch Patterns:** Offers a variety of stitch options for different fabric types and sewing projects.

- **Automatic Thread Rewind:** Simplifies bobbin preparation.
- **Built-in Lighting:** Provides illumination for the sewing area, enhancing visibility.
- **Foot Pedal Control:** Allows for hands-free speed control.
- **Reverse Sewing Function:** For reinforcing stitches at the beginning and end of seams.
- **Adjustable Stitch Density:** Control over stitch length and width.
- **One-Step Button Sewing:** Facilitates easy buttonhole creation.
- **Two Speed Settings:** Low and high speed options for different sewing needs.
- **Dual Control Switches:** Operate via foot pedal or machine button.
- **Lightweight and Portable Design:** Easy to move and store.
- **Anti-Skid Pads:** Ensures stability during operation.
- **Built-in Storage Drawer:** Conveniently stores small accessories.

Included Accessories:

The sewing machine comes with a comprehensive set of accessories to get you started:

- 64 windings (various colored threads)
- 1 Foot Pedal
- 2 Thread Spools
- 2 Bobbins
- Power Adapter
- Scissors
- Seam Ripper
- Other small sewing tools



Figure 2.1: Front view of the Costway Portable Multifunctional Sewing Machine. This image displays the machine's compact size, the stitch selection dial, and the main controls.



Figure 2.2: Diagram illustrating key features such as reverse sewing, 16 line types, adjustable needle spacing, anti-skid pads, storage drawer, adjustable speed, changeable pressure foot, and double thread design.



Figure 2.3: The sewing machine displayed alongside its comprehensive set of accessories, including various thread spools, bobbins, foot pedal, and power adapter.

3. SETUP AND INITIAL USE

3.1 Unpacking and Placement

- Carefully remove the sewing machine and all accessories from the packaging.
- Place the machine on a stable, flat surface. Ensure there is adequate space for sewing and fabric handling.
- Connect the power adapter to the machine's DC 6V input and then to a suitable electrical outlet.
- If using the foot pedal, plug it into the designated port on the machine.

3.2 Bobbin Winding

1. Place a spool of thread on the spool pin.
2. Guide the thread through the upper thread guide.

3. Place an empty bobbin onto the bobbin winder spindle.
4. Wrap the thread around the bobbin a few times clockwise.
5. Push the bobbin winder spindle to the right.
6. Turn on the machine (or press the foot pedal) to start winding. The machine will automatically stop when the bobbin is full.
7. Cut the thread and push the bobbin winder spindle back to the left. Remove the wound bobbin.

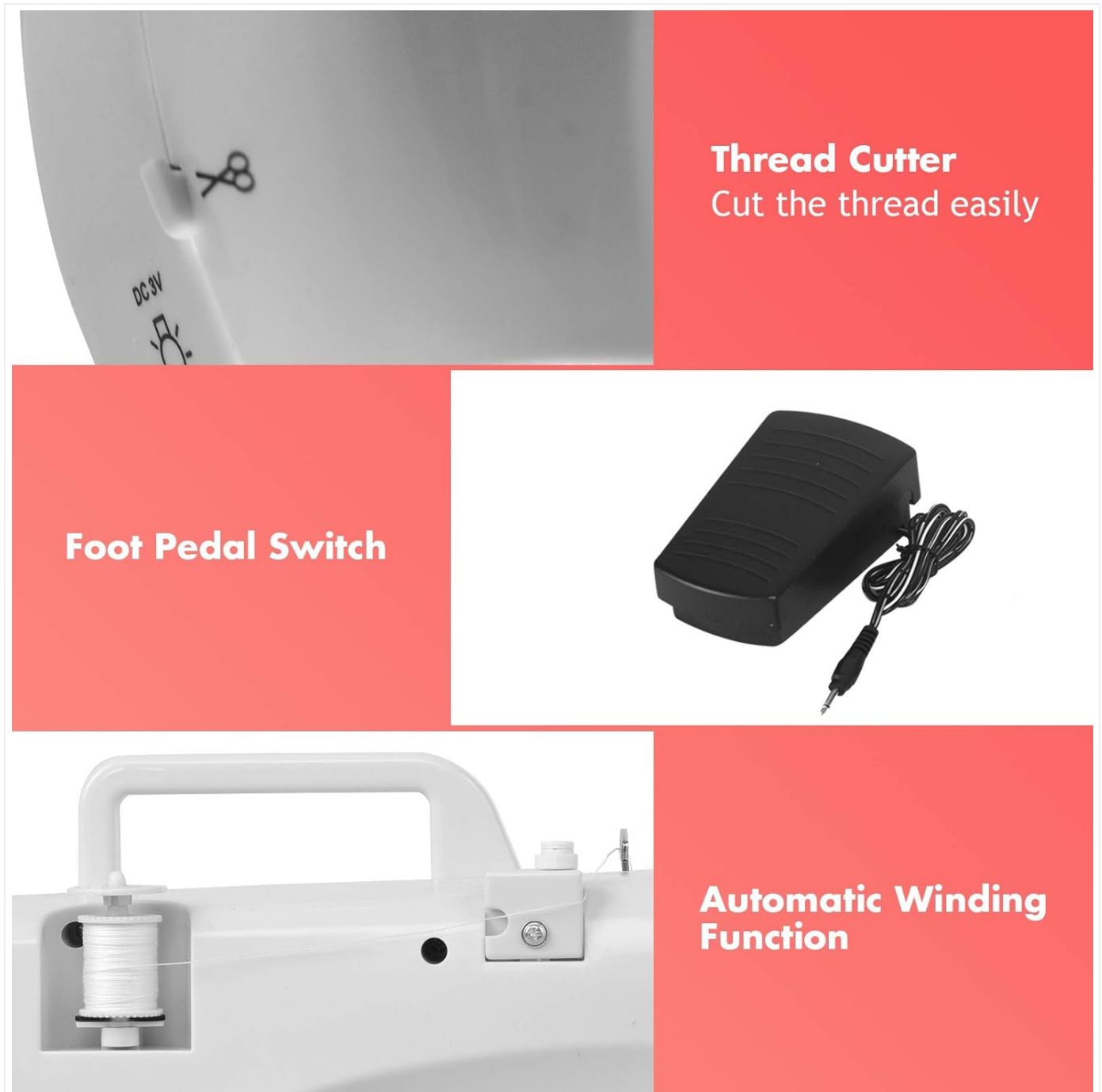

Figure 3.1: Close-up view showing the automatic winding function for bobbins, the thread cutter, and the foot pedal switch for operation.

3.3 Inserting the Bobbin

1. Open the bobbin cover plate located on the sewing bed.
2. Insert the wound bobbin into the bobbin case, ensuring the thread unwinds in the correct direction (usually counter-clockwise).
3. Guide the bobbin thread through the tension spring and out through the small opening.
4. Close the bobbin cover plate.

3.4 Upper Threading

1. Raise the needle to its highest position using the handwheel.
2. Place a spool of thread on the spool pin.
3. Guide the thread through the first upper thread guide.
4. Follow the threading path indicated by the arrows on the machine, ensuring the thread passes through the tension discs and the take-up lever.
5. Thread the needle from front to back.
6. Pull the upper thread under the presser foot and towards the back of the machine.

3.5 Bringing Up the Bobbin Thread

1. Hold the upper thread lightly with your left hand.
2. Turn the handwheel towards you (counter-clockwise) to lower the needle, then raise it again.
3. The needle thread will catch the bobbin thread, forming a loop.
4. Pull the loop up through the needle plate opening with the upper thread.
5. Pull both threads (upper and bobbin) under the presser foot and towards the back of the machine, about 6 inches long.

4. OPERATING INSTRUCTIONS

4.1 Selecting a Stitch Pattern

The machine offers 16 built-in stitch patterns. To select a stitch, rotate the stitch selection dial on the front of the machine until the desired stitch number aligns with the indicator mark.

SEWING MACHINE COMES WITH MULTIPLE FUNCTIONS CAN SEW KINDS OF FABRICS



Linen



Polyester



Cotton



Jeans

Figure 4.1: The sewing machine positioned on a desk, demonstrating its capability to sew various fabric types such as linen, polyester, cotton, and jeans.

4.2 Adjusting Stitch Density

The stitch density (length/width) can be adjusted using the dedicated dial or lever, if available, to suit your fabric and project requirements. Refer to the machine's markings for specific adjustments.

4.3 Starting to Sew

1. Place the fabric under the presser foot.
2. Lower the presser foot lever.
3. Select your desired speed using the L/H switch (Low/High).
4. Start sewing by pressing the ON/OFF button or by pressing the foot pedal.
5. Guide the fabric gently as it feeds through the machine. Do not pull or push the fabric forcefully.

4.4 Reverse Sewing

To reinforce a seam, press and hold the reverse sewing button/lever. The machine will sew backward. Release the button/lever to

resume forward sewing.

4.5 Built-in Light

The built-in light illuminates the sewing area. It can be turned on or off independently of the machine's operation, providing better visibility for intricate work.



Figure 4.2: A close-up view of the built-in light illuminating the needle area, designed to provide bright working conditions and reduce eye strain.

4.6 Finishing a Seam

1. Sew a few reverse stitches to secure the seam.
2. Raise the needle to its highest position.
3. Lift the presser foot lever.
4. Pull the fabric gently towards the back of the machine.
5. Use the thread cutter (if available) or scissors to cut the threads, leaving about 4-6 inches of thread.

5. MAINTENANCE

5.1 Cleaning the Machine

- Always unplug the machine before cleaning.
- Use a soft brush to remove lint and dust from the bobbin area, feed dogs, and around the needle plate.
- Wipe the exterior of the machine with a soft, damp cloth. Do not use harsh chemicals or abrasive cleaners.

5.2 Needle Replacement

- Ensure the machine is unplugged.
- Raise the needle to its highest position.
- Loosen the needle clamp screw.
- Remove the old needle and insert a new needle with the flat side facing the back of the machine.
- Push the needle up as far as it will go, then tighten the needle clamp screw securely.

6. TROUBLESHOOTING

This section addresses common issues you might encounter with your sewing machine. For problems not listed here, please contact customer support.

Problem	Possible Cause	Solution
Machine does not start	Power cord not plugged in. ON/OFF switch is off. Foot pedal not connected (if using).	Check power connection. Turn ON the machine. Ensure foot pedal is securely plugged in.
Thread breaks frequently	Incorrect threading. Needle bent or dull. Thread tension too tight. Wrong needle size for fabric.	Rethread the machine carefully. Replace the needle. Adjust thread tension. Use appropriate needle for fabric type.
Skipped stitches	Needle bent or incorrectly inserted. Wrong needle size. Incorrect threading.	Replace or reinsert needle correctly. Use correct needle size. Rethread the machine.
Fabric not feeding smoothly	Presser foot not lowered. Lint or debris in feed dogs.	Lower the presser foot. Clean the feed dogs.

7. SPECIFICATIONS

Feature	Detail
Brand	COSTWAY
Model Number	23469-CYPE-CS
Product Dimensions	5"D x 12"W x 10"H
Item Weight	9.49 pounds
Package Dimensions	16 x 13 x 9 inches
Color	White
Manufacturer	COSTWAY
Built-in Stitches	16
Power Source	Electric (DC 6V adapter)



Figure 7.1: Diagram illustrating the dimensions of the sewing machine: 12 inches wide, 10 inches high, and 5 inches deep.

8. WARRANTY AND SUPPORT

For warranty information, please refer to the documentation included with your purchase or contact COSTWAY customer support directly. Keep your proof of purchase for any warranty claims.

If you require technical assistance or have questions regarding the operation or maintenance of your Costway Portable Multifunctional Sewing Machine, please visit the official COSTWAY website or contact their customer service department.

Manufacturer: COSTWAY

Brand Store: Visit the COSTWAY Store on Amazon

