



[Manuals.plus](#) /

> [Coolife](#) /

> Coolife Luggage Model yd72 Instruction Manual

Coolife yd72

Coolife Luggage Model yd72 Instruction Manual

Durable and Lightweight Checked Luggage with PC+ABS Hardshell

INTRODUCTION

Thank you for choosing Coolife Luggage. This manual provides essential information for the setup, operation, maintenance, and troubleshooting of your new luggage. Please read these instructions carefully to ensure proper use and longevity of your product.

SETUP

1. Setting the TSA Combination Lock

Your Coolife Luggage is equipped with a TSA-approved combination lock for enhanced security. Follow these steps to set your personal combination:

1. The lock is preset to 0-0-0 at the factory.
2. Locate the small reset button (usually a small hole) on the side of the lock.
3. Using a pen or a pointed object, press and hold the reset button until you hear a click.
4. While holding the reset button, set your desired 3-digit combination by turning the dials.
5. Release the reset button. Your new combination is now set.
6. Test your new combination by scrambling the numbers and then entering your set combination to open the lock.

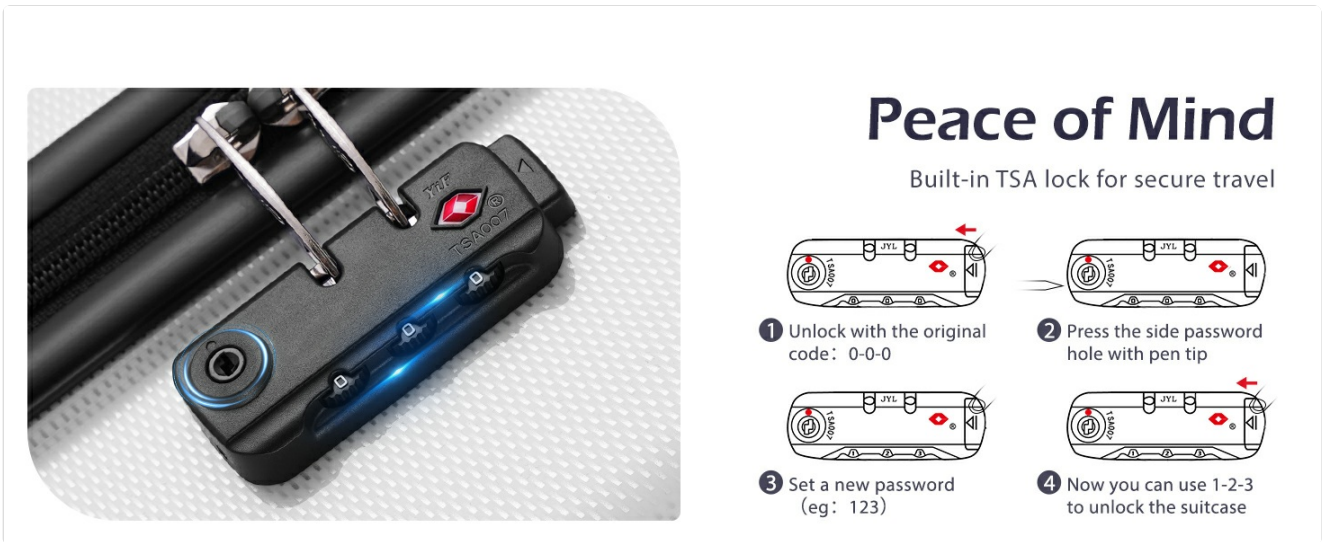

Image: Detailed steps for setting the TSA combination lock, showing the initial 0-0-0, pressing the reset button, setting a new code, and unlocking.

2. Adjusting the Telescopic Handle

The adjustable 3-level 100% pure aluminum telescoping handle allows for comfortable maneuvering. To adjust the handle:

1. Press the button located on the top of the handle.
2. Extend or retract the handle to your desired height.
3. Release the button to lock the handle in place.



Image: Visual guide demonstrating the three adjustable height levels of the telescopic handle.

OPERATING YOUR LUGGAGE

1. Using the Dual Spinner Wheels

Your luggage features quiet airplane dual spinner wheels designed for smooth 360° maneuverability on various surfaces.

- For effortless movement, push the luggage upright on all four wheels.
- The wheels are designed to glide smoothly over different terrains, including stairs, cobblestones, carpet, and grass.



Get Rolling

Smooth 360° dual spinner wheels for any surface

Mute Stable Smooth

WITHSTAND IT ALL



Staircase Cobblestones Carpet Grassland

Image: Close-up view of the dual spinner wheels, highlighting their 360-degree rotation and stability on various surfaces.

2. Packing the Interior

The fully lined interior includes multi-use organizational pockets and X-straps to keep your belongings secure and organized.

- Utilize the mesh pockets for smaller items, toiletries, or accessories.
- Secure clothing and other larger items using the adjustable X-straps to prevent shifting during transit.

Fits The Essentials

26.4" x 17.3" x 9.8" 58 L 4-7 Days



1 Mesh Pockets 2 X-strap



Image: An open suitcase showing the organized interior with mesh pockets and adjustable X-straps for efficient packing.

MAINTENANCE

1. Cleaning the Hardshell

The ABS+PC hardshell is durable and easy to clean:

- Wipe the exterior with a soft, damp cloth and mild soap.
- Avoid using abrasive cleaners or solvents, as these can damage the finish.
- For stubborn marks, a gentle cleaner designed for plastics can be used.

2. Wheel Care

To maintain the smooth operation of your spinner wheels:

- Periodically check the wheels for any debris (hair, lint, etc.) and remove it carefully.
- Avoid exposing wheels to excessive dirt or sand for prolonged periods.

3. Zipper Maintenance

Your luggage features durable YKK zippers. To ensure they remain smooth:

- Avoid overpacking, which can strain the zippers.
- If a zipper becomes stiff, apply a small amount of zipper lubricant or wax.

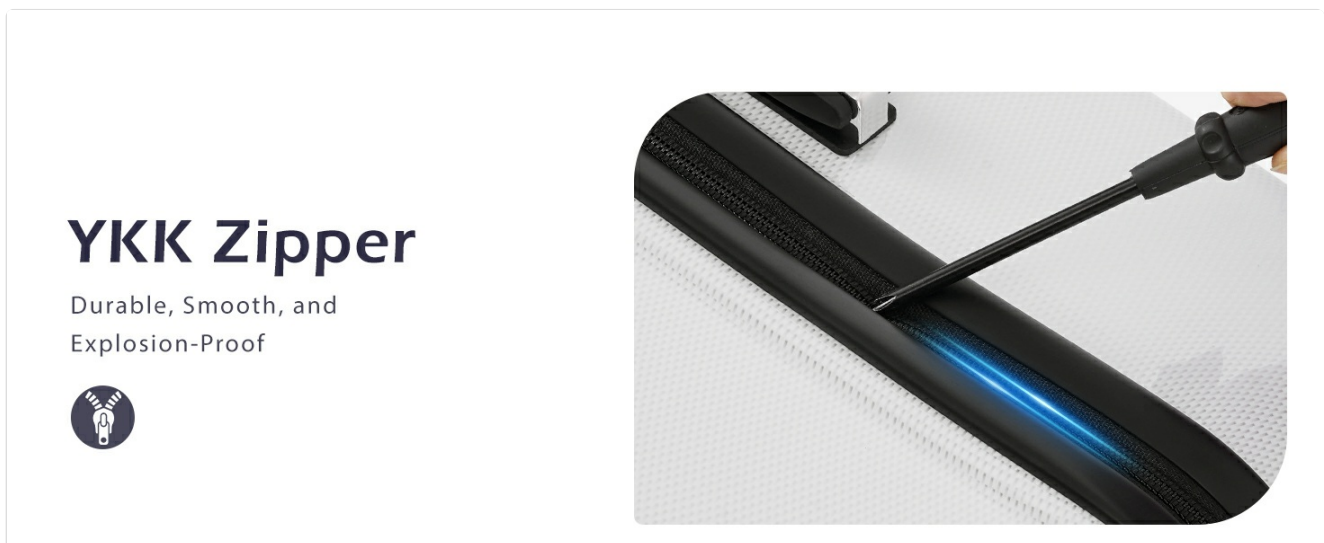

Image: A close-up of the YKK zipper, emphasizing its durability and smooth operation.

TROUBLESHOOTING

1. TSA Lock Not Opening

- Ensure you are using the correct 3-digit combination.
- If you forgot your combination, you may need to contact customer support for assistance or refer to the lock manufacturer's instructions.

2. Wheels Not Rolling Smoothly

- Check for any debris (hair, string, dirt) caught in the wheel mechanism. Clean as necessary.
- Ensure the luggage is not excessively overloaded, which can put strain on the wheels.

3. Zipper Sticking

- Check if any fabric or material is caught in the zipper teeth. Gently pull it free.
- Apply a small amount of zipper lubricant (e.g., beeswax, graphite pencil) to the teeth and slide the zipper back and forth.

SPECIFICATIONS

Feature	Detail
Model Number	yd72
Size	M (24in)
Item Dimensions (L x W x H)	17.3"L x 9.8"W x 26.4"H
Item Weight	8.1 Pounds
Storage Volume	58 Liters
Material Type	Acrylonitrile Butadiene Styrene (ABS) + PC
Shell Type	Hard
Wheel Type	Spinner (Dual)
Number of Wheels	4
Lock Type	TSA Combination Lock
Handle Type	Telescopic Extendable Handle (3-level)
Other Special Features	Expandable (28in only), Lightweight, Reinforced Grip Handle, Organized Interior Design

24" Size Reference

Dimensions	26.4" x 17.3" x 9.8"
Weight	8.1 lbs
Capacity	58 L
Travel days	4-7 days

*All measurements are manual and may vary by ±0.5 inch

Image: A visual size reference for the 24-inch luggage, showing dimensions, weight, capacity, and recommended travel days.

WARRANTY AND SUPPORT

For warranty information, product support, or to purchase replacement parts, please visit the official Coolife website or contact their customer service directly. Keep your purchase receipt for warranty claims.

For additional assistance, please refer to the contact information provided with your purchase or visit the [Coolife Store on Amazon](#).