

Locinox SNA60002

LOCINOX SNA60002 Lock with LCKX40 Cylinder for 40-50-60MM Square Profiles - Instruction Manual

Model: SNA60002 (Reference: 307950) | Brand: Locinox

1. INTRODUCTION

This manual provides comprehensive instructions for the installation, operation, and maintenance of the LOCINOX SNA60002 lock with an LCKX40 cylinder. This lock is specifically designed for integration with square profiles measuring 40mm, 50mm, or 60mm. Please read these instructions carefully before installation and use to ensure proper function and longevity of your lock.

2. PRODUCT OVERVIEW

The LOCINOX SNA60002 is a robust lock system featuring an LCKX40 cylinder, engineered for secure gate and door applications. Its design allows for versatile installation on various square profile sizes.

Key Features:

- Integrated LCKX40 cylinder for reliable key operation.
- Compatible with 40mm, 50mm, and 60mm square profiles.
- Durable construction for long-lasting performance.



Figure 1: The LOCINOX SNA60002 lock assembly, showing the main body, handle, cylinder, and accompanying keys. The lock features a silver finish and is designed for secure gate applications.

3. SETUP AND INSTALLATION

Proper installation is crucial for the optimal performance and security of your LOCINOX lock. Refer to the diagram below for precise measurements and component placement.

Required Tools (Not Included):

- Drill
- Drill bits (21mm, 24mm, and appropriate size for mounting screws)
- Measuring tape or ruler
- Marking tool
- Screwdriver

Installation Steps:

1. **Prepare the Profile:** Ensure the square profile (40mm, 50mm, or 60mm) is clean and free of obstructions.
2. **Mark Drilling Points:** Using the provided diagram (Figure 2) as a guide, mark the precise locations for drilling on your square profile.
 - Drill two holes with a diameter of **21mm** for the main lock bolts.
 - Drill two holes with a diameter of **24mm** for the cylinder and handle spindle.
 - Note the distances: 160mm between the top bolt and the bottom of the lock body, 90mm from the edge to the center of the cylinder, and 30mm for the backset.

3. **Drill Holes:** Carefully drill the marked holes. Ensure they are clean and smooth.
4. **Insert Lock Body:** Position the main lock body into the prepared openings on the square profile.
5. **Attach Components:**
 - Insert the LCKX40 cylinder into its designated slot.
 - Attach the handle spindle and handle.
 - Secure the lock using the provided fasteners and threaded sleeves, ensuring all components are aligned and tightened appropriately.
6. **Test Operation:** Before final tightening, test the lock mechanism with the key to ensure smooth operation of the latch and deadbolt. Adjust as necessary.

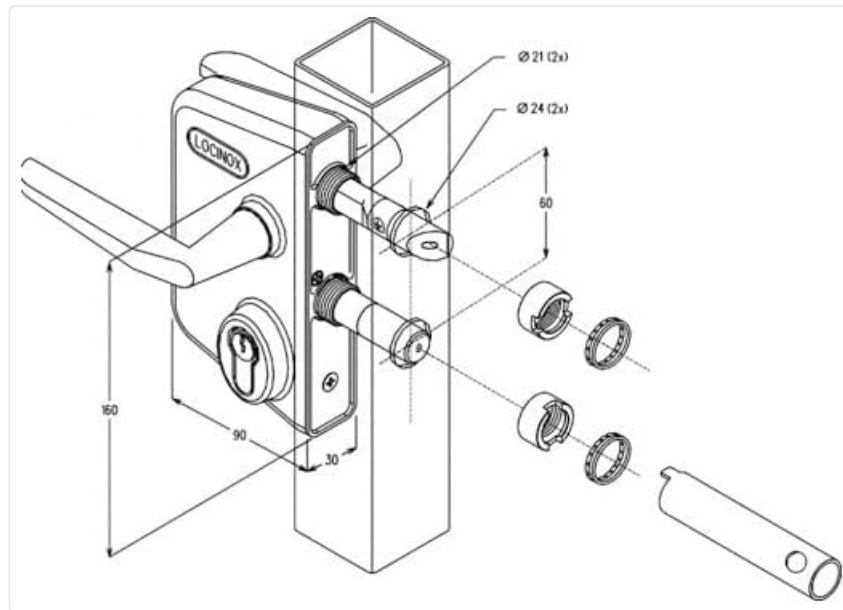

Figure 2: Exploded view and dimensional diagram for the LOCINOX SNA60002 lock installation. This illustration details the required drilling diameters (Ø21mm, Ø24mm) and key measurements (160mm, 90mm, 30mm) for mounting the lock onto a square profile.

4. OPERATING INSTRUCTIONS

The LOCINOX SNA60002 lock operates using a standard key mechanism for locking and unlocking.

To Lock:

1. Ensure the gate/door is fully closed and the latch is engaged.
2. Insert the key into the LCKX40 cylinder.
3. Turn the key to extend the deadbolt into the strike plate.
4. Remove the key. The lock is now secured.

To Unlock:

1. Insert the key into the LCKX40 cylinder.
2. Turn the key to retract the deadbolt.
3. Turn the handle to disengage the latch and open the gate/door.
4. Remove the key.

5. MAINTENANCE

Regular maintenance ensures the smooth operation and extends the lifespan of your LOCINOX lock.

- **Cleaning:** Periodically clean the exterior of the lock with a soft, damp cloth. Avoid abrasive cleaners or solvents that could damage the finish.
- **Lubrication:** Apply a small amount of graphite-based lubricant or a silicone-free lock lubricant into the keyway and moving parts of the latch and deadbolt mechanism once or twice a year. Do not use oil-based lubricants as they can attract dirt.
- **Inspection:** Regularly inspect the lock for any signs of wear, damage, or loose components. Ensure all screws are tight.
- **Key Care:** Avoid using bent or damaged keys, as this can harm the cylinder mechanism.

6. TROUBLESHOOTING

If you encounter issues with your LOCINOX lock, refer to the following common problems and solutions:

- **Key is difficult to turn or sticky:**
 - Apply a small amount of graphite or silicone-free lock lubricant into the keyway.
 - Check if the key is bent or damaged; try a spare key.
- **Latch or deadbolt does not retract/extend smoothly:**
 - Check for obstructions in the strike plate or around the bolt.
 - Lubricate the moving parts of the latch and deadbolt.
 - Ensure the lock is properly aligned and mounted securely. Loose mounting screws can cause misalignment.
- **Handle is loose:**
 - Tighten the screws securing the handle to the lock body.

If problems persist after attempting these solutions, contact customer support or a qualified locksmith.

7. SPECIFICATIONS

| Feature | Detail |
|--------------------------------|--|
| Brand | Locinox |
| Model Number | SNA60002 (Reference: 307950) |
| Product Dimensions (L x W x H) | 1 x 1 x 1 cm (0.39 x 0.39 x 0.39 inches) |
| Item Weight | 1 Kilogram (2.2 lbs) |
| Color | Silver |
| Material | NSP (Not Specified by Manufacturer) |
| Shape | Square (for profile compatibility) |
| Special Feature | Key Unlock |

| | |
|--------------------------|----------------------------------|
| Lock Type | Cylinder |
| Compatible Profile Sizes | 40mm, 50mm, 60mm Square Profiles |
| Batteries Required | No |

8. WARRANTY AND SUPPORT

For warranty information or technical support regarding your LOCINOX SNA60002 lock, please refer to the manufacturer's official website or contact your point of purchase. Keep your purchase receipt as proof of purchase.

Manufacturer: Locinox

Related Documents - SNA60002

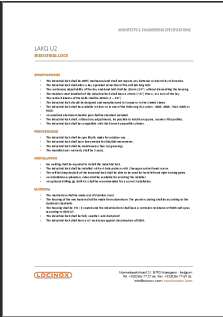
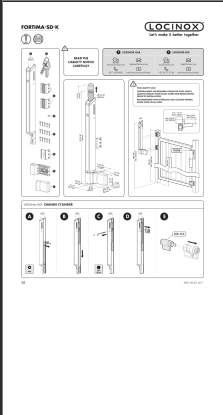
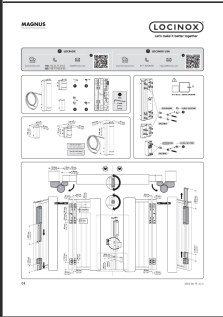
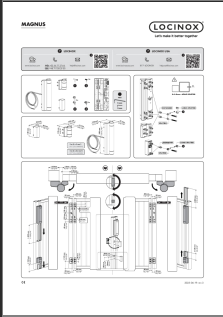
| | |
|---|---|
|  | <p>LAKQ U2 Industrial Lock - Specifications, Performance, and Material Details Locinox</p> <p>Comprehensive technical specifications, performance metrics, installation guidelines, and material composition for the Locinox LAKQ U2 Industrial Lock, designed for durability and professional use.</p> |
|  | <p>Locinox Fortima-SD-K Pool Safety Gate Lock Installation Guide</p> <p>Detailed installation instructions for the Locinox Fortima-SD-K pool safety gate lock. Learn how to properly install, adjust, and change the cylinder for secure gate operation. Includes safety guidelines and contact information.</p> |
|  | <p>LOCINOX MAGNUS Gate Motor: Installation, Safety, and Technical Guide</p> <p>This guide provides essential information for the installation, safe operation, and technical specifications of the LOCINOX MAGNUS gate motor. It covers safety notices, connection diagrams, and product details for automated swing gates.</p> |
|  | <p>Locinox Magnus Gate Motor: Installation Guide and Technical Specifications</p> <p>Comprehensive installation guide, safety notices, and technical specifications for the Locinox Magnus automated swing gate motor. Learn about setup, wiring, and intended use.</p> |

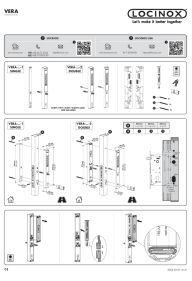
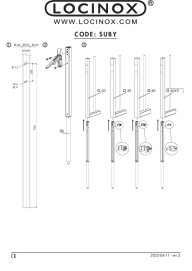
| | |
|---|--|
|  The image shows the cover of the Locinox Vera manual. It features the Locinox logo at the top, followed by the word 'VERA' and 'Electronic Code Lock'. Below this is a QR code and several small diagrams illustrating the lock's components and installation steps. | <p>Locinox Vera Electronic Code Lock: Installation, Programming, and User Manual</p> <p>A comprehensive guide to the Locinox Vera electronic code lock, covering installation, programming of PIN codes, access modes, maintenance, and troubleshooting. Features detailed instructions for setup and operation.</p> |
|  The image shows the cover of the Locinox SUBY manual. It features the Locinox logo at the top, followed by 'WWW.LOCINOX.COM' and 'CODE: SUBY'. Below this is a diagram showing the drop bolt assembly and its installation into a door. | <p>Locinox SUBY Drop Bolt Installation Guide</p> <p>Official installation manual for the Locinox SUBY drop bolt, detailing dimensions, components, and step-by-step assembly instructions for gate hardware.</p> |