

[Manuals.plus](#) /

> [SONGMICS](#) /

> SONGMICS Modular Storage Unit LPC36W Instruction Manual

SONGMICS LPC36W

SONGMICS Modular Storage Unit LPC36W Instruction Manual

Model: **LPC36W** | Brand: **SONGMICS**

1. INTRODUCTION

Thank you for choosing the SONGMICS Modular Storage Unit. This manual provides essential information for the safe assembly, operation, and maintenance of your new storage solution. Please read these instructions carefully before beginning assembly and retain them for future reference.



Image 1.1: Assembled SONGMICS Modular Storage Unit.

2. SAFETY INFORMATION

- Do not place this product outdoors. It is designed for indoor use only.
- Ensure all plastic panels are fully inserted into the connector slots. After assembling each cube, tap each connector with the provided rubber mallet to ensure stability and a secure fit.
- When assembling connectors, ensure the side with the 'SONGMICS' logo faces outwards for correct orientation.
- Do not overload the compartments. The maximum load capacity is 4.5 kg (9.9 lbs) per compartment.
- Use the included anti-tipping device to secure the unit to a wall, especially if children or pets are

present, to prevent accidental tipping.

- Keep small parts away from children during assembly to avoid choking hazards.

3. PACKAGE CONTENTS

Please verify that all components listed below are present before starting assembly:

- 17 x Semi-transparent panels (42 x 31 cm)
- 9 x Semi-transparent panels (31 x 31 cm)
- 24 x ABS plastic connectors
- 12 x Hooks
- 1 x Rubber mallet
- 2 x Anti-tipping devices
- 1 x Assembly instructions (FR, EN, DE, ES, IT)



17 Pcs 40 × 30 cm

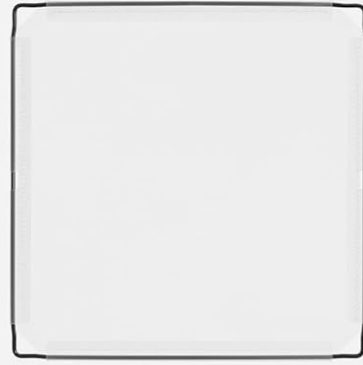

9 Pcs 30 × 30 cm



2 Pcs



12 Pcs



24 Pcs



1 Pc



1 Pc

Image 3.1: All included components.

4. SETUP AND ASSEMBLY INSTRUCTIONS

The storage unit features a simple structure for easy assembly and disassembly. Follow these steps for proper setup:

- 1. Unpack Components:** Lay out all panels, connectors, and accessories on a clean, flat surface. Refer to the package contents list to ensure all parts are present.
- 2. Connect Panels:** Insert the edges of the plastic panels firmly into the slots of the ABS plastic connectors. Ensure the 'SONGMICS' logo on the connectors faces outwards.
- 3. Secure Connections:** After forming each cube, use the provided rubber mallet to gently tap each

connector. This ensures the panels are fully seated and the structure is stable.

4. **Modular Configuration:** The unit is modular. You can arrange the cubes in various configurations to suit your space and needs. The included hooks allow you to divide larger cubes into smaller ones, offering flexible storage options.
5. **Install Anti-Tipping Device:** For safety, especially in households with children or pets, attach the anti-tipping device to the top of the unit and secure it to a wall using appropriate hardware.

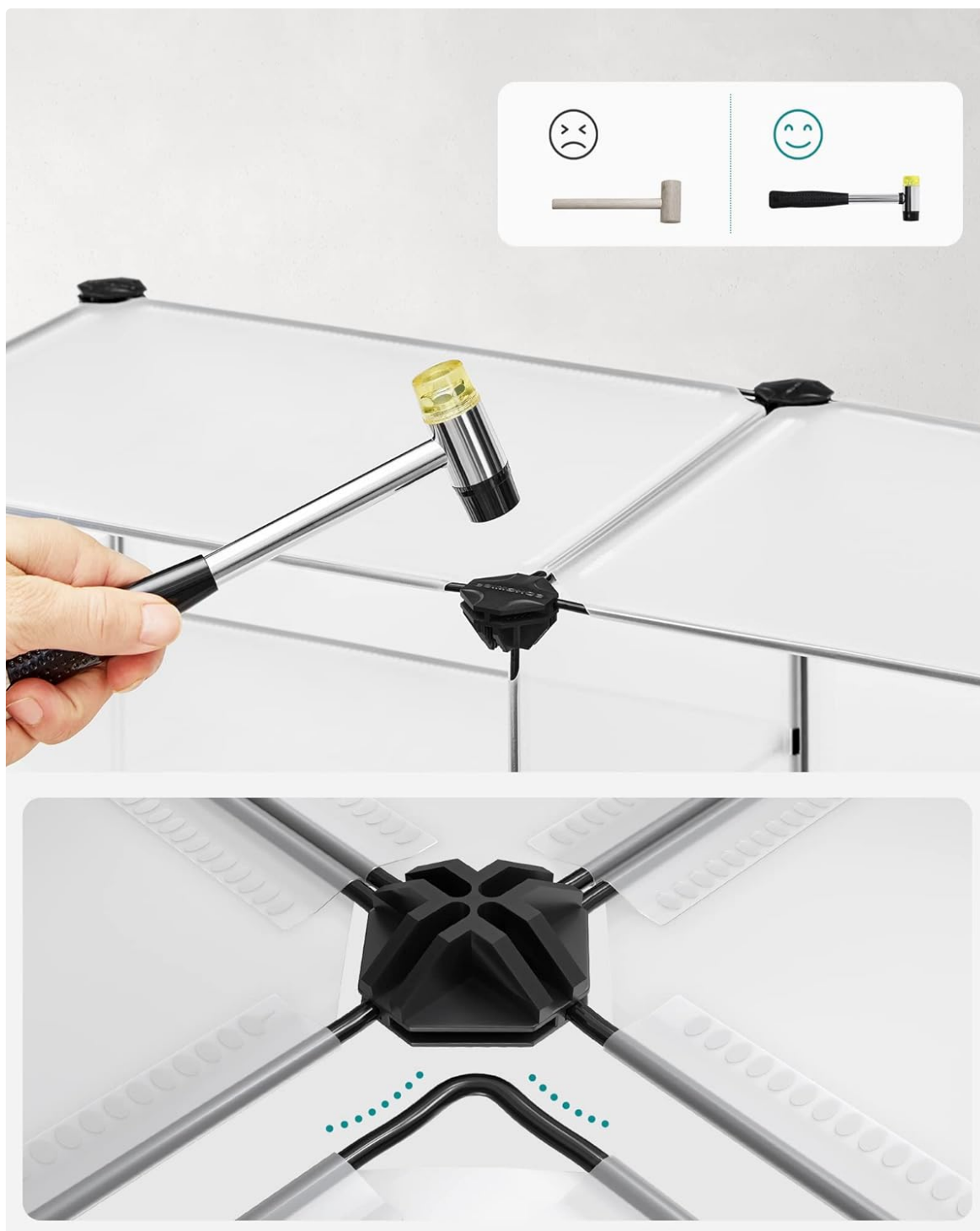

Image 4.1: Using the rubber mallet for secure assembly.

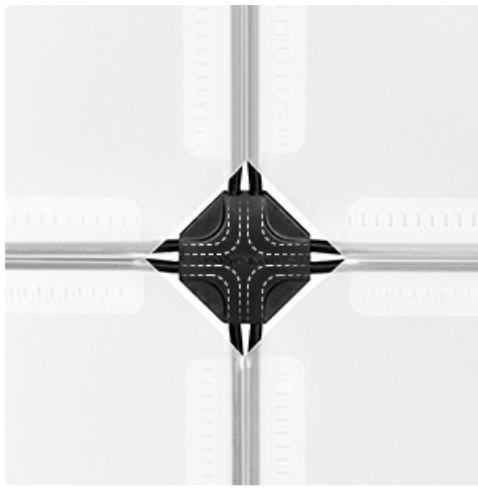

Image 4.2: Detail of a plastic connector.



Image 4.3: Installation of the anti-tipping device.

5. OPERATING INSTRUCTIONS (USAGE)

This modular storage unit offers versatile storage solutions for various items and rooms:

- **Flexible Storage:** Use the cubes to store folded clothes, shoes, books, toys, or toiletries. The modular design allows you to customize the layout to fit your specific storage needs.
- **Room Placement:** This unit can be placed in bedrooms for shoes and clothes, in playrooms as a toy organizer, or in bathrooms for towels and toiletries.
- **Weight Distribution:** Distribute weight evenly across the compartments to maintain stability. Avoid placing heavy items disproportionately in one area.



Image 5.1: Storage unit in a bedroom.



Image 5.2: Examples of modular configurations.

6. MAINTENANCE

- **Cleaning:** The semi-transparent PP plastic panels are easy to clean. Wipe the surfaces with a soft, damp cloth. Avoid using abrasive cleaners or harsh chemicals that could damage the material.
- **Inspection:** Periodically check all connectors to ensure they remain securely fastened. If any connections feel loose, gently tap them with the rubber mallet to re-secure.
- **Relocation:** If moving the unit, it is recommended to empty the contents first to prevent stress on the structure and potential damage.



Image 6.1: Cleaning and load capacity illustration.

7. TROUBLESHOOTING

- **Unit feels unstable:** Ensure all panels are fully inserted into the connector slots. Use the rubber mallet to tap each connector until it is snug. Verify that the 'SONGMICS' logo on the connectors faces outwards.
- **Difficulty inserting panels into connectors:** Apply firm, even pressure. If necessary, use the rubber mallet to gently tap the panel into the connector. Ensure the connector is oriented correctly.
- **Missing parts:** Refer to the 'Package Contents' section and contact SONGMICS customer support if any parts are missing.

8. SPECIFICATIONS

Feature	Detail
Model Number	LPC36W
Overall Dimensions (L x W x H)	87 x 32 x 96 cm (34.3 x 12.6 x 37.8 inches)
Weight	4.64 kg (10.2 lbs)
Material	PP plastic panels with metal wire frame, ABS plastic connectors
Color	Semi-transparent
Load Capacity per Compartment	4.5 kg (9.9 lbs)
Assembly Required	Yes

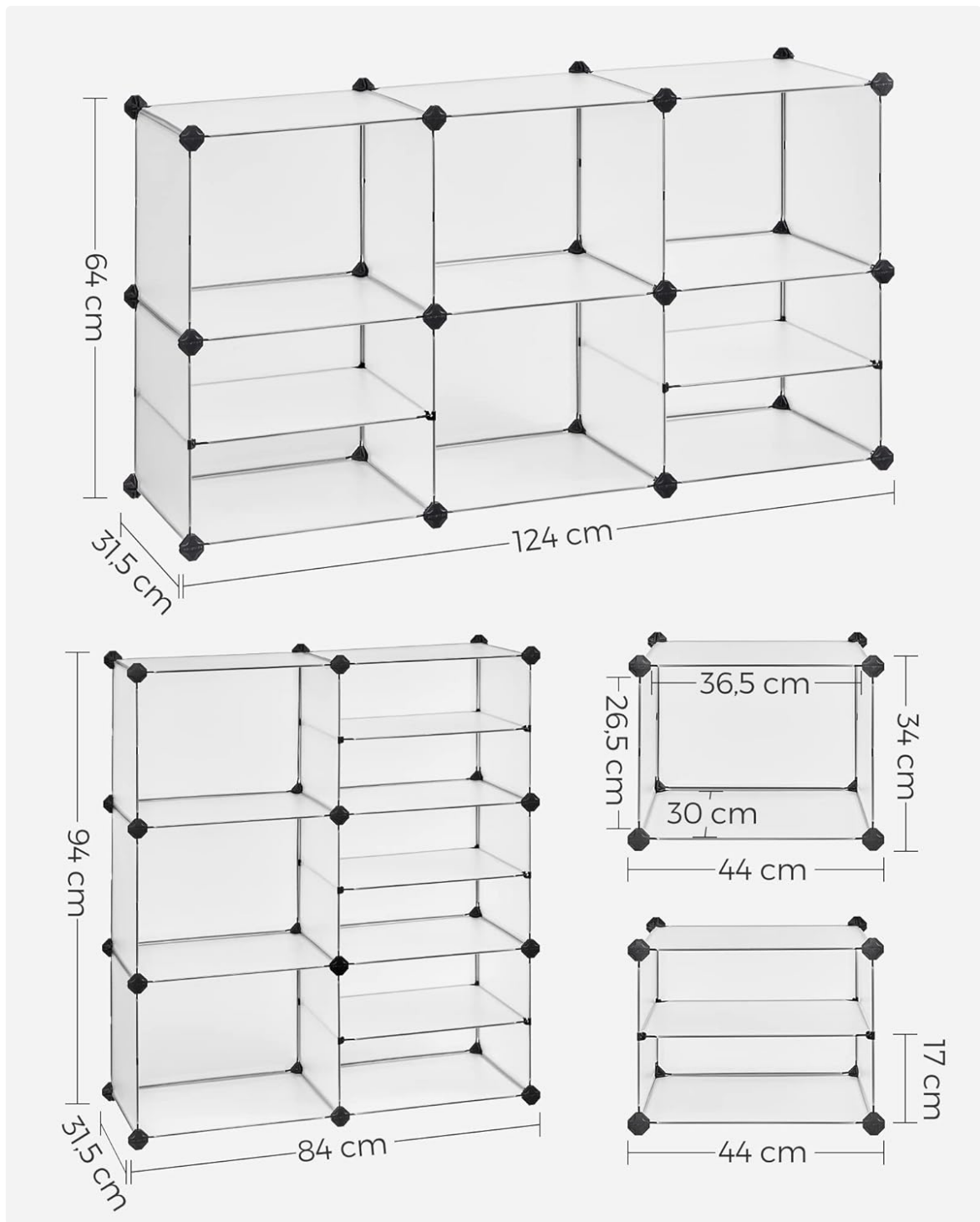

Image 8.1: Product dimensions.

9. WARRANTY AND SUPPORT

SONGMICS is committed to providing high-quality products. While specific warranty details are not provided in this manual, please refer to the product packaging or the official SONGMICS website for the most up-to-date warranty information.

For any questions, missing parts, or assistance with assembly, please contact SONGMICS customer support. Contact details can typically be found on the product packaging or on the official SONGMICS website.

