

## WilTec XXL Cat Enclosure

# WilTec Outdoor Cat Enclosure XXL Instruction Manual

Model: XXL Cat Enclosure

## INTRODUCTION

Thank you for choosing the WilTec Outdoor Cat Enclosure. This manual provides essential information for the safe assembly, operation, and maintenance of your new cat enclosure. Please read these instructions carefully before assembly and retain them for future reference.

## SAFETY INSTRUCTIONS

- Ensure all components are present and undamaged before assembly. Do not proceed with assembly if any parts are missing or broken.
- Assembly should be performed by at least two adults to ensure safety and ease of construction.
- Wear appropriate safety gear, such as gloves, during assembly to prevent injuries.
- Place the enclosure on a level, stable surface to prevent tipping.
- Regularly inspect the enclosure for any signs of wear, damage, or loose components. Tighten screws and replace damaged parts as necessary.
- Keep children and pets away from the assembly area to avoid accidents.
- This enclosure is designed for outdoor use only.
- Do not modify the product in any way, as this may compromise its structural integrity and safety.

## PACKAGE CONTENTS

Please verify that all the following components are included in your package:

- Pre-drilled fir wood panels and frames
- Galvanized steel mesh panels
- Bitumen roof sections
- Resting platforms (6 units)
- Lockable door assembly

- Hardware kit (screws, bolts, hinges, latches)
- Assembly instructions manual

If any parts are missing or damaged, please contact WilTec customer support immediately.

## SETUP AND ASSEMBLY

---

The WilTec Outdoor Cat Enclosure is designed for straightforward assembly with pre-drilled holes. Follow these steps carefully:

1. **Unpack and Organize:** Carefully unpack all components and lay them out on a clean, flat surface. Group similar parts together.
2. **Assemble Base Frame:** Connect the base frame sections using the provided hardware. Ensure all connections are secure.
3. **Attach Side Panels:** Secure the side panels, which include the galvanized steel mesh, to the base frame.
4. **Install Resting Platforms:** Attach the six resting platforms at various heights as indicated in the detailed assembly diagram (refer to the separate diagram sheet if provided).
5. **Mount Door:** Install the door frame and attach the lockable door using the hinges and latch mechanism. Test the locking function.
6. **Secure Roof:** Place and secure the bitumen roof sections onto the top frame. Ensure the roof is properly aligned to provide maximum weather protection.
7. **Final Inspection:** Double-check all screws and connections to ensure they are tight and secure. Verify the stability of the entire structure.

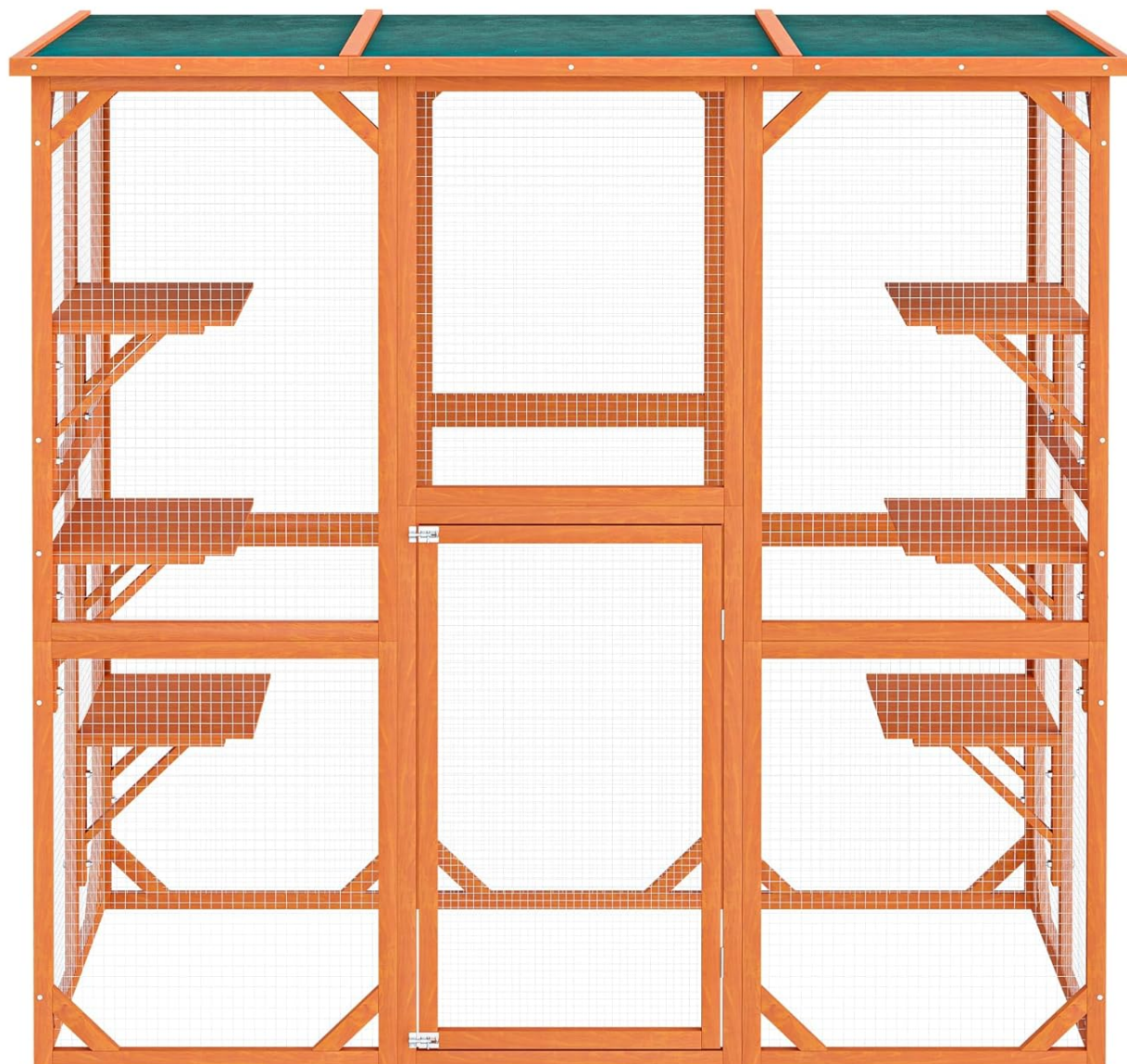

*Image 1: Fully assembled WilTec Outdoor Cat Enclosure XXL. This image shows the complete structure of the cat enclosure, highlighting its wooden frame, wire mesh, and green bitumen roof.*



# PARFAIT POUR SE DÉPENSER ET SE RELAXER

PLUSIEURS PLATE-FORMES D'OBSERVATION ET DE COUCHAGE  
POUR VOS AMIS VELUS



*Image 2: Interior view of the cat enclosure showing multiple resting platforms. This image provides a clear view of the six internal platforms designed for cats to rest and observe.*

# PORTES VERROUILLABLES

## ACCÈS FACILE ET SURPLUS DE SÉCURITÉ

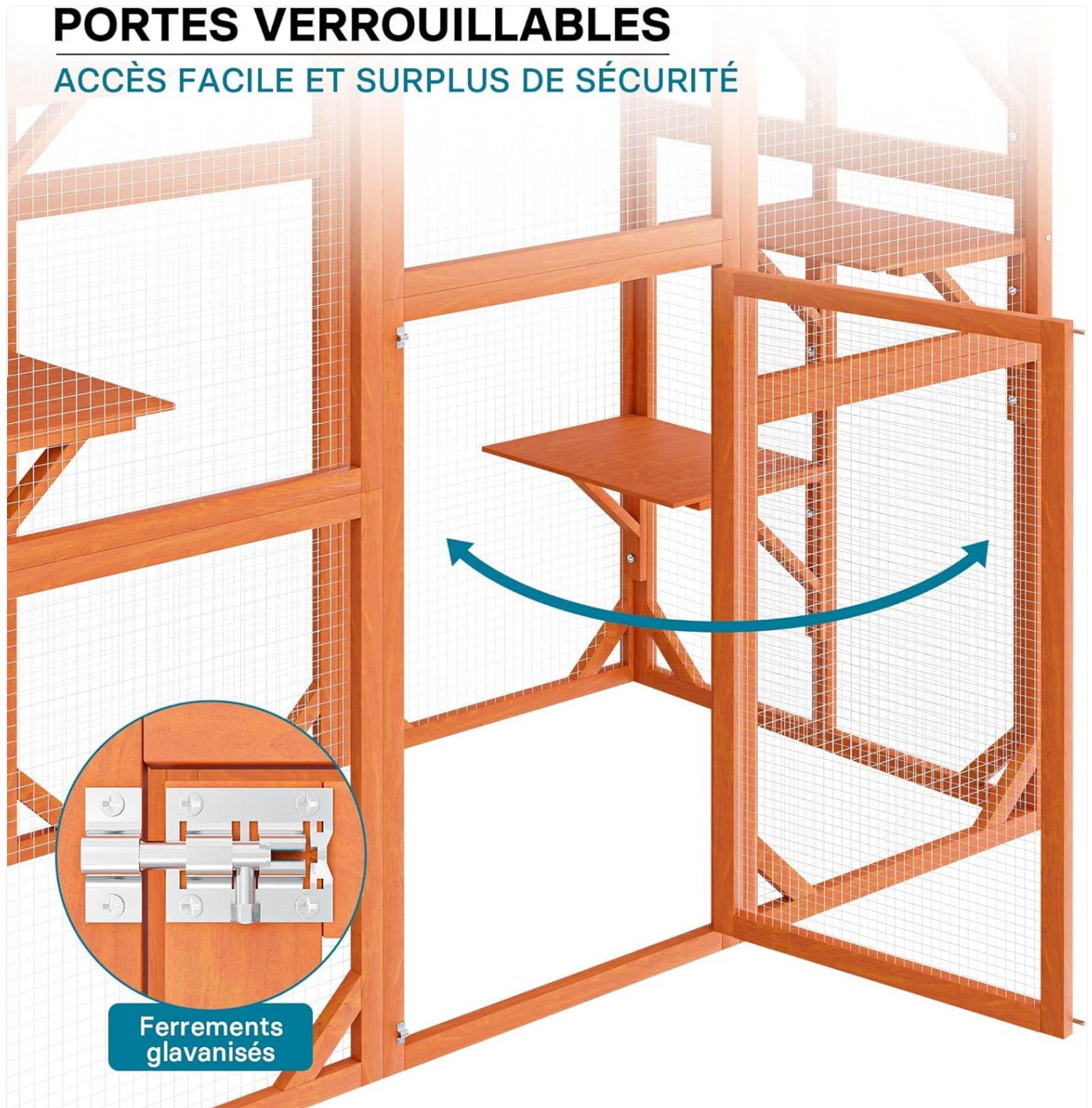

Image 3: Close-up of the lockable door and galvanized latch. This image details the secure locking mechanism on the enclosure's access door.

## OPERATING INSTRUCTIONS

This enclosure provides a safe and stimulating outdoor environment for your cats.

- **Placement:** Position the enclosure in a shaded or partially shaded area to protect your cats from direct sunlight during hot weather. Ensure it is on a stable, level surface.
- **Introducing Cats:** Allow your cats to explore the enclosure at their own pace. You may place familiar bedding, toys, or treats inside to encourage them.
- **Access:** Use the lockable door for easy access to your cats and for cleaning the enclosure. Always ensure the door is securely latched when cats are inside.
- **Supervision:** While the enclosure is secure, it is recommended to supervise your cats, especially during their initial uses.



- **Enrichment:** Utilize the multiple resting platforms to provide varied vantage points and opportunities for climbing and relaxation. Consider adding additional cat-safe enrichment items.

## ENCLOS EXTERIEUR POUR CHATS

### ICI, LES CHATS S'AÈRENT SANS AUCUN DANGER



*Image 4: Cat enclosure in a garden with cats enjoying the space. This image illustrates the enclosure in an outdoor setting, with cats comfortably using the platforms.*

## MAINTENANCE

Regular maintenance will extend the lifespan of your WilTec Cat Enclosure.

- **Cleaning:** Regularly clean the enclosure, including the platforms and mesh, using pet-safe cleaning solutions. Remove any debris or waste promptly.
- **Wood Care:** The fir wood is treated with a waterproof varnish. To maintain its weather resistance, periodically reapply a suitable non-toxic wood sealant or varnish, especially if the wood shows signs of wear or fading.
- **Mesh Inspection:** Check the galvanized steel mesh for any signs of damage, rust, or sharp edges that could harm your pets. Repair or replace damaged sections immediately.
- **Roof Inspection:** Inspect the bitumen roof for tears, cracks, or lifting sections. Ensure it remains watertight to protect the interior from rain and snow.



- **Hardware Check:** Periodically check all screws, bolts, hinges, and latches for tightness. Tighten any loose hardware to maintain structural integrity.

## TOIT RÉSISTANT À REVÊTEMENT DE BITUME

### PROTÈGE LES CHATS D'UN TEMPS RUDE



*Image 5: Close-up of the bitumen roof showing water resistance. This image highlights the protective bitumen layer on the roof, designed to repel water.*



# BOIS DE SAPIN DE HAUTE QUALITÉ

## STABLE, DURABLE ET HYDROFUGE



Image 6: Fir wood logs and the cat enclosure, emphasizing material quality. This image visually represents the high-quality fir wood used in the construction of the enclosure.

### TROUBLESHOOTING

Problem	Possible Cause	Solution
Enclosure feels unstable or wobbly.	Loose hardware; uneven ground.	Tighten all screws and bolts. Relocate the enclosure to a level surface or use shims to stabilize.
Door does not close or latch properly.	Misaligned hinges; bent latch; obstruction.	Check hinge alignment and adjust if necessary. Ensure the latch mechanism is clear of debris and not bent.



Problem	Possible Cause	Solution
Water leakage from the roof.	Damaged bitumen roof; improper installation.	Inspect the bitumen roof for tears or gaps. Seal any small cracks with appropriate roofing sealant. Ensure roof sections are correctly overlapped and secured.
Cats are not using the enclosure.	Unfamiliarity; lack of comfort items.	Place familiar bedding, toys, or treats inside. Allow cats to explore at their own pace. Ensure the enclosure is in a quiet, safe location.

## SPECIFICATIONS

- Brand:** WilTec
- Model:** XXL Cat Enclosure
- Material:** Fir wood, Bitumen, Galvanized steel
- Color:** Brown
- Overall Dimensions (L x W x H):** 180 cm x 88 cm x 169 cm
- Shape:** Rectangular
- Resting Platforms:** 6 units
- Usage:** Outdoor
- Assembly Required:** Yes

## WARRANTY AND SUPPORT

For warranty information, technical support, or to order replacement parts, please contact the seller or WilTec customer service directly. Please have your purchase receipt and product model information ready when contacting support. You can visit the [WilTec Brand Store](#) for more information.

© 2025 WilTec. All rights reserved.

### Related Documents - XXL Cat Enclosure

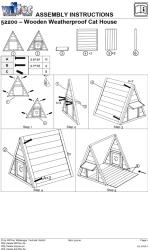
	<p><a href="#">WilTec 52200 Wooden Weatherproof Cat House Assembly Instructions</a></p> <p>Step-by-step assembly instructions for the WilTec 52200 Wooden Weatherproof Cat House. Includes parts list and detailed guidance for building your cat's shelter.</p>
---	--

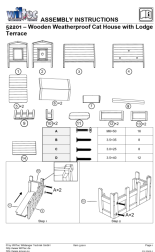

[Assembly Instructions for WilTec 52201 Wooden Weatherproof Cat House with Lodge Terrace](#)

Detailed assembly instructions for the WilTec 52201 Wooden Weatherproof Cat House, including a lodge and terrace. This guide provides step-by-step instructions and a parts list for easy construction.



[Manuale d'uso: Mini-incubatrice per 12 uova Wiltec 52016](#)

Scopri come utilizzare al meglio la tua mini-incubatrice Wiltec per 12 uova (modello 52016) con questo manuale d'uso completo. Include istruzioni dettagliate, consigli per l'incubazione e risoluzione problemi.

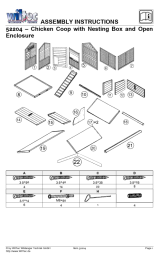

[WilTec 52204 Chicken Coop Assembly Instructions](#)

Detailed assembly instructions for the WilTec 52204 Chicken Coop with Nesting Box and Open Enclosure, including parts list and step-by-step diagrams.



[Manual de Usuario y Especificaciones Técnicas del Compresor de Aerógrafo WilTec AF189](#)

Este manual proporciona instrucciones detalladas para el uso seguro y eficiente del compresor de aerógrafo WilTec AF189 (Artículo 34205), incluyendo pautas de seguridad, especificaciones técnicas, manejo de la estación reductora, lista de piezas y normativas de conformidad.



[Wiltec Parcel Box 64118 Operation Manual and Assembly Guide](#)

Comprehensive operation manual and assembly guide for the Wiltec Parcel Box model 64118. Includes parts overview, step-by-step assembly instructions, safety precautions, and contact information.