

## CERSANIT 112479

# CERSANIT Floor-Standing WC with Cistern and Soft-Close Seat User Manual

Model: 112479

Brand: CERSANIT

## 1. INTRODUCTION

This manual provides comprehensive instructions for the installation, operation, and maintenance of your CERSANIT floor-standing WC with integrated cistern and soft-close Duroplast toilet seat. Designed for optimal hygiene and water efficiency, this ceramic toilet features CleanOn rimless technology for easy cleaning and a 3/5L dual-flush system. Please read this manual thoroughly before installation and use to ensure proper function and longevity of your product.

## 2. SAFETY INFORMATION

- Always ensure water supply is turned off before beginning any installation or maintenance work.
- Wear appropriate personal protective equipment (PPE) such as gloves and eye protection during installation.
- Handle ceramic components with care to prevent chipping or breakage.
- Ensure all connections are watertight to prevent leaks.
- Do not use abrasive cleaners or harsh chemicals on ceramic surfaces or the toilet seat, as this may damage the finish.
- Keep small parts out of reach of children.

## 3. PACKAGE CONTENTS

Verify that all components are present and undamaged before proceeding with installation.

- CERSANIT Floor-Standing WC Bowl
- Cistern (Water Tank)
- Duroplast Toilet Seat with Soft-Close Mechanism
- Internal Cistern Mechanism (Fill Valve and Flush Valve)
- Mounting Hardware (Floor Fixings, Cistern-to-Bowl Bolts, Seat Fixings)
- Sealing Gaskets and Washers
- Installation Manual (this document)



Image: Complete CERSANIT floor-standing WC unit, showing the ceramic bowl, cistern, and soft-close toilet seat.

## 4. SETUP AND INSTALLATION

---

Professional installation is recommended. Ensure you have the necessary tools (wrench, screwdriver, drill, level, sealant) before starting.

1. **Prepare the Installation Area:** Ensure the floor is clean, level, and the waste pipe connection (horizontal outlet) is correctly positioned. Turn off the main water supply.
2. **Assemble Cistern Mechanism:** Install the fill valve and flush valve inside the cistern according to their individual instructions. Ensure all seals are correctly seated.
3. **Attach Cistern to WC Bowl:** Place the large rubber gasket onto the water inlet hole on the WC bowl. Carefully align the cistern with the bowl, ensuring the flush valve tail piece passes through the gasket. Secure the cistern to the bowl using the provided bolts, washers, and nuts. Tighten evenly to create a watertight seal, but do not overtighten.
4. **Position the WC:** Carefully place the assembled WC unit over the waste pipe connection. Ensure it is level and correctly aligned.
5. **Secure to Floor:** Mark the drilling points for the floor fixings. Move the WC aside, drill the holes, and insert wall plugs if necessary. Reposition the WC and secure it to the floor using the provided screws and caps.
6. **Connect Water Supply:** Connect the water supply line to the fill valve inlet on the cistern. Use a flexible connector and ensure a watertight seal.
7. **Install Toilet Seat:** Attach the soft-close Duroplast toilet seat to the WC bowl using the provided fixings. Ensure it is centered and secure.
8. **Test and Seal:** Turn on the water supply and check for leaks. Allow the cistern to fill and perform several test flushes. Once satisfied, apply a silicone sealant around the base of the WC where it meets the floor for a hygienic and finished look.

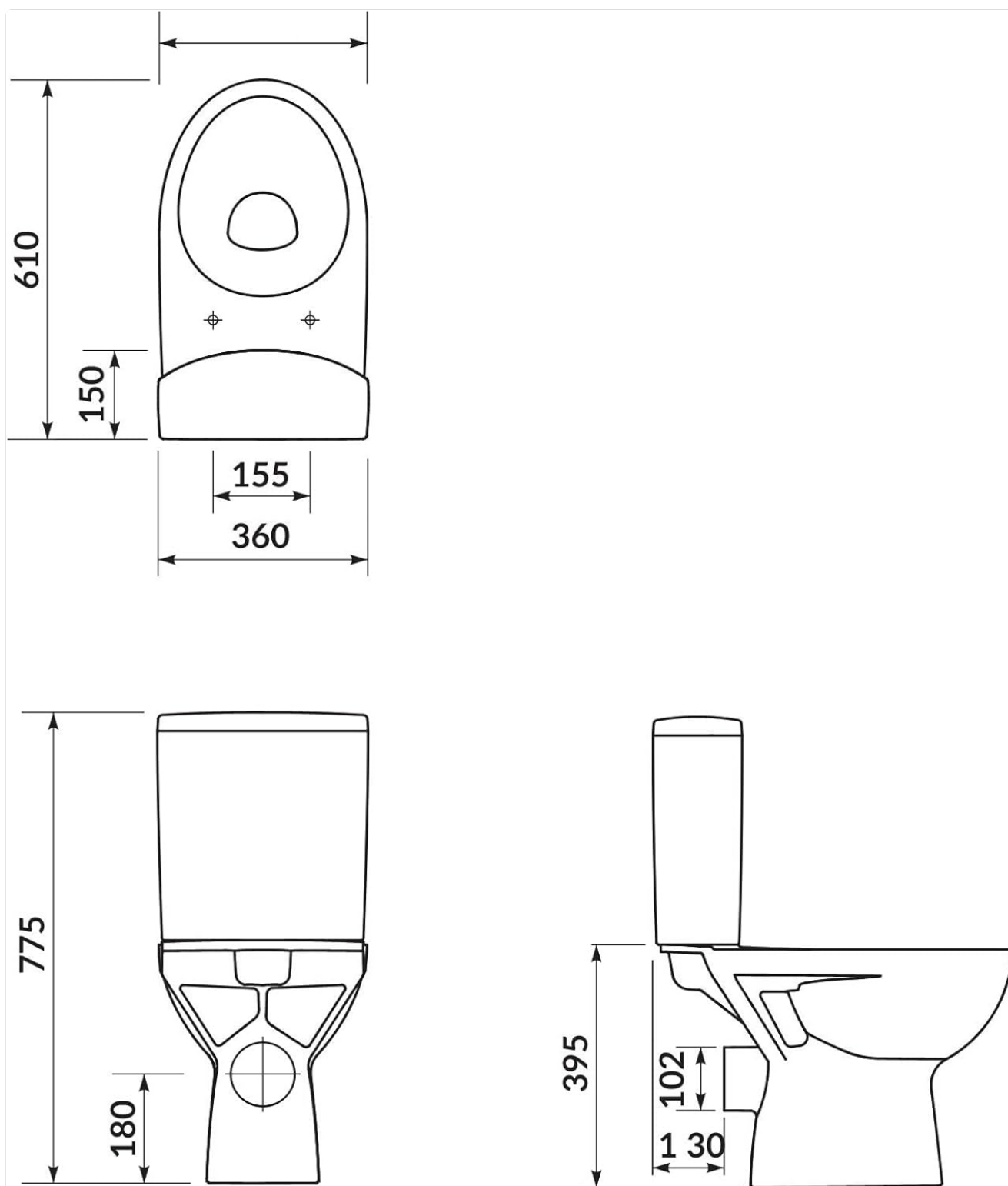

Image: Technical drawing illustrating the dimensions and horizontal outlet configuration of the CERSANIT WC. Dimensions are in millimeters.

## 5. OPERATING INSTRUCTIONS

### Flushing System (3/5L Dual Flush)

Your CERSANIT WC is equipped with a water-saving dual-flush system:

- **Small Flush (3 Liters):** Press the smaller button on the top of the cistern for a reduced water flush, ideal for liquid waste.
- **Full Flush (5 Liters):** Press the larger button for a full water flush, designed for solid waste.

### Soft-Close Toilet Seat

The Duroplast toilet seat features a soft-close mechanism for quiet and gentle closing. Simply push the seat or lid downwards slightly, and it will lower slowly and silently on its own.



Image: Icon depicting the soft-close function of the toilet seat, showing gentle lowering.

## 6. MAINTENANCE AND CLEANING

---

Regular cleaning and proper maintenance will ensure the longevity and hygiene of your CERSANIT WC.

### Cleaning the Ceramic Bowl (CleanOn Technology)

The innovative CleanOn rimless technology ensures thorough cleaning and prevents dirt and bacteria accumulation.

- Use a soft cloth or sponge with a mild, non-abrasive bathroom cleaner.
- Wipe down the entire inner surface of the bowl, paying attention to the rimless design which allows for easy access.
- Rinse thoroughly with water after cleaning.
- Avoid using harsh chemicals, abrasive pads, or wire brushes, as these can damage the ceramic glaze.





Image: Top-down view of the CERSANIT toilet bowl, highlighting the CleanOn rimless design for easy cleaning.



Image: Icon illustrating the CleanOn rimless technology, showing water flow thoroughly cleaning the bowl.

### **Cleaning the Duroplast Toilet Seat**

- Clean the toilet seat with a soft cloth and mild soap and water.
- Do not use abrasive cleaners, disinfectants containing chlorine, or solvents, as these can damage the seat's surface and soft-close mechanism.
- The Duroplast material is designed to be antibacterial, contributing to higher hygiene standards.



Image: Icon indicating the antibacterial properties of the Duroplast toilet seat material.

## 7. TROUBLESHOOTING

Problem	Possible Cause	Solution
Toilet constantly runs or leaks.	Faulty fill valve, flush valve seal, or cistern-to-bowl gasket.	Check and adjust the fill valve float. Inspect and clean/replace the flush valve seal. Ensure cistern-to-bowl bolts are tightened correctly and gasket is seated properly.
Weak flush.	Low water level in cistern, partially closed stopcock, or obstruction in the bowl.	Adjust fill valve to increase water level. Ensure stopcock is fully open. Check for blockages in the bowl or waste pipe.
Toilet seat does not soft-close.	Soft-close mechanism worn or damaged.	Inspect the hinges. If damaged, the toilet seat may need to be replaced.
Unpleasant odors.	Poor seal at the base, lack of water in the trap, or inadequate ventilation.	Check silicone seal around the base. Ensure toilet is flushed regularly. Verify bathroom ventilation.

## 8. SPECIFICATIONS

Feature	Detail
Brand	CERSANIT
Model Number	112479
Product Dimensions (L x W x H)	61 x 36 x 77.5 cm
Item Weight	34.8 Kilograms
Color	White
Style	Stand WC 6
Material	Ceramic
Surface Finish	Coated
Shape	Oval
Installation Method	Floor Mounted
Flush System	3/5L Dual Flush
Technology	CleanOn (Rimless)
Toilet Seat Material	Duroplast with Soft-Close

## 9. WARRANTY AND SUPPORT

For warranty information and customer support, please refer to the official CERSANIT website or contact your local distributor. Keep your proof of purchase for any warranty claims.

CERSANIT is a renowned brand for bathroom equipment, offering functional, high-quality, and stylish solutions. For more information, visit the [CERSANIT Brand Store](#).