



[Manuals.plus](#) /

> [GREX](#) /

> Nolan B601 R N-Com Bluetooth Communication System User Manual

GREX B601 R N-Com

Nolan B601 R N-Com Bluetooth Communication System

Model: B601 R N-Com | Brand: Nolan N-Com

1. INTRODUCTION AND OVERVIEW

The Nolan B601 R N-Com is an advanced Bluetooth communication system designed for seamless integration into compatible Nolan helmets. It provides a comprehensive solution for motorcycle riders, enabling communication, navigation, and entertainment on the go. This system is engineered for ease of use, even with motorcycle gloves, and offers robust performance for both solo riders and groups.

Key functionalities include rider-to-passenger intercom, bike-to-bike communication, phone calls, GPS navigation audio, and music streaming. The B601 R N-Com enhances the riding experience by keeping you connected and informed.



Figure 1.1: The Nolan B601 R N-Com Bluetooth Communication System packaging, showcasing the control unit and a compatible helmet.

2. FEATURES

The B601 R N-Com system is equipped with a range of features to optimize your riding communication:

- **Bluetooth Connectivity:** Connects wirelessly to mobile phones, GPS devices, and MP3 players for calls, navigation, and music.
- **Driver/Passenger Intercom:** Enables clear communication between the rider and a passenger.
- **Bike-to-Bike Intercom:** Supports communication between two motorcycles up to 250 meters in open terrain without obstacles. Features one-to-one conversations and a "Call motorcycle" function.
- **Music Sharing:** Allows sharing of music with a passenger.
- **Voice Prompts:** Provides audible feedback for system status and functions.
- **Compatibility:** Specifically designed for integration with Nolan N100-5, N104, N87, N70-2, N44, and N40 helmet models.

- **Ergonomic Keypad:** Features a 3-button keypad designed for easy operation even while wearing motorcycle gloves.
- **Software Updates:** Supports updates via Windows and Mac computers to ensure optimal performance and access to new features.

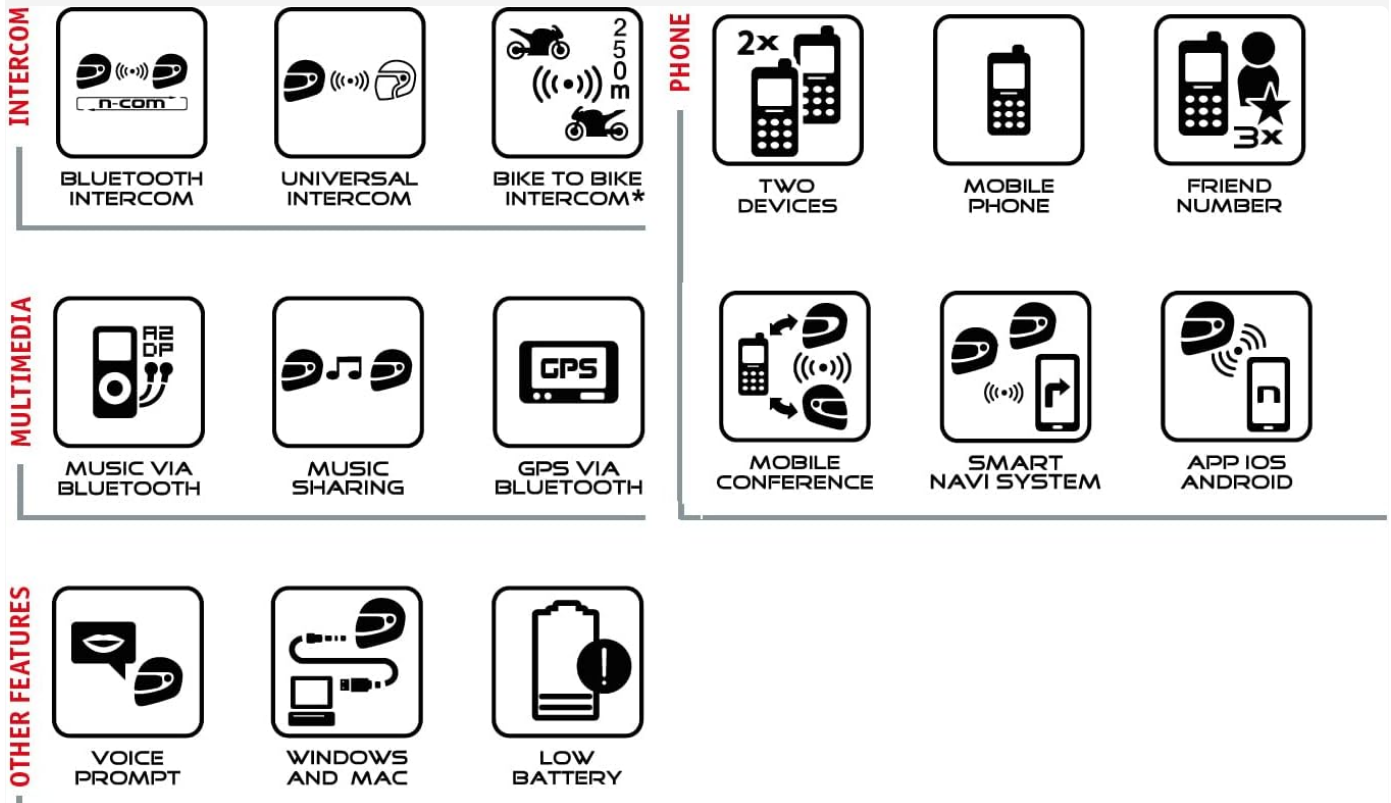

Figure 2.1: Overview of the N-Com system's capabilities, including various intercom modes, phone connectivity, multimedia options, and additional features.

3. PACKAGE CONTENTS

Upon opening the package, verify that all the following components are present:

- Nolan B601 R N-Com Control Unit
- Microphone (boom or wired, depending on helmet type)
- Speakers (left and right)
- USB Cable for charging and data transfer
- Mounting Hardware and Adhesives (if applicable)
- User Manual (this document)



Figure 3.1: The N-Com system's microphone, an essential component for voice communication.

4. SETUP AND INSTALLATION

The B601 R N-Com system is designed for straightforward installation into compatible Nolan helmets. Refer to your specific helmet model's instructions for precise speaker and microphone placement within the helmet's interior.

1. **Prepare the Helmet:** Remove the helmet's inner padding as instructed by your helmet's manual to access the speaker pockets and cable routing channels.
2. **Install Speakers:** Place the speakers into the designated ear pockets within the helmet. Ensure they are positioned comfortably and do not cause pressure points.
3. **Install Microphone:** Secure the microphone in the appropriate location. For full-face helmets, this is typically near the mouth. For modular or open-face helmets, a boom microphone is usually used. Route the microphone cable neatly.
4. **Mount Control Unit:** Attach the B601 R N-Com control unit to the side of the helmet using the provided mounting bracket. Ensure it is securely fastened and accessible for operation.
5. **Connect Cables:** Connect the speaker and microphone cables to the control unit. Ensure all connections are firm.
6. **Reassemble Helmet:** Carefully reinsert the helmet's inner padding, ensuring no cables are pinched or exposed.



Figure 4.1: A Nolan helmet with the B601 R N-Com control unit visibly installed on the left side.



Figure 4.2: Rear perspective of a Nolan helmet, illustrating the integrated communication system and internal cable management.

5. OPERATING INSTRUCTIONS

The B601 R N-Com control unit features an intuitive 3-button keypad for easy operation. Familiarize yourself with the button functions before riding.



Einzelpack Single Set

Figure 5.1: The ergonomic 3-button keypad of the B601 R N-Com control unit, designed for easy gloved operation.

5.1. Power On/Off

- **To Power On:** Press and hold the central button until you hear an audible confirmation.
- **To Power Off:** Press and hold the central button until you hear an audible confirmation of shutdown.

5.2. Bluetooth Pairing

To connect your B601 R N-Com system with a mobile phone, GPS, or MP3 player:

1. Ensure the B601 R N-Com is powered on.
2. Activate Bluetooth pairing mode on your device (e.g., phone settings).
3. On the B601 R N-Com, enter pairing mode (refer to the full digital manual for specific button combinations, usually a long press of a specific button).
4. Select "Nolan B601 R N-Com" from the list of available devices on your phone/GPS.

5. Confirm pairing if prompted.

5.3. Intercom Functions

- **Driver/Passenger Intercom:** Once paired, communication is typically initiated by a short press of a specific button.
- **Bike-to-Bike Intercom:** For motorcycle-to-motorcycle communication, both units must be within range (up to 250m) and paired. Follow the pairing procedure for intercom units.

5.4. Music and GPS Audio

- **Music Playback:** Once paired with an MP3 player or phone, music can be controlled directly from the B601 R N-Com unit (play/pause, skip tracks).
- **GPS Instructions:** Audio navigation prompts from a paired GPS device will automatically override other audio sources.

6. MAINTENANCE

Proper maintenance ensures the longevity and optimal performance of your Nolan B601 R N-Com system.

- **Cleaning:** Use a soft, damp cloth to clean the control unit. Avoid harsh chemicals or abrasive materials. Do not immerse the unit in water.
- **Battery Care:** Charge the unit regularly, especially if not used for extended periods. Avoid fully discharging the battery frequently.
- **Software Updates:** Periodically check the official Nolan N-Com website for firmware updates. Updates can improve performance, add new features, and resolve bugs. Connect the unit to your computer via the provided USB cable for updates.
- **Storage:** Store the unit in a cool, dry place when not in use.

7. TROUBLESHOOTING

If you encounter issues with your B601 R N-Com system, try the following troubleshooting steps:

Problem	Possible Cause / Solution
No Power / Unit Not Turning On	Battery is discharged. Charge the unit fully. Ensure the charging cable is properly connected.
Cannot Pair with Device	Ensure both devices are in pairing mode. Move devices closer. Turn off and on Bluetooth on both devices. Clear previous pairings and try again.
Poor Audio Quality / No Sound	Check speaker and microphone connections. Ensure speakers are correctly positioned in the helmet. Adjust volume. Check for obstructions to the microphone.
Intercom Not Working	Ensure both intercom units are powered on and within range. Re-pair the intercom units. Check for obstacles between units.
Unit Freezes / Unresponsive	Perform a soft reset (refer to the full digital manual for specific instructions, usually a long press of a combination of buttons). Ensure firmware is up to date.

For more detailed troubleshooting or advanced issues, please refer to the comprehensive digital user manual available on

the official Nolan N-Com website.

8. SPECIFICATIONS

Feature	Detail
Model Name	B601 R N-Com
Bluetooth Version	(Assumed modern, e.g., Bluetooth 4.1 or higher for features listed)
Intercom Range	Up to 250 meters (bike-to-bike, in open terrain)
Compatibility	Nolan N100-5, N104, N87, N70-2, N44, N40 helmets
Control Interface	3-button ergonomic keypad
Connectivity	Mobile phone, GPS, MP3 player
Software Updates	Via USB (Windows/Mac compatible)
Package Dimensions	26 x 17.5 x 5.9 cm
Weight	320 g (package weight)
Manufacturer	Nolan Helmets

n-com	NOLAN HELMETS N100-S; N104/EVO/A; N87; N70-2 GT/X; N44/EVO; N40/FULL/5 GT/5		NOLAN GREX HELMETS N91/EVO; N90-2; G9.1 EVOLVE; G4.2 PRO		X-LITE HELMETS X-1004; X-1003; X-903; X-702/GT X-661/ET; X-603; X-551GT; X-403/GT	
	B SERIES		S SERIES		X SERIES	
	B901L B901	B601	B901	B601	B901	B601
INTERCOM	BLUETOOTH® INTERCOM	✓	✓	✓	✓	✓
	UNIVERSAL INTERCOM	✓	✓	✓	✓	✓
	WIDE TO WIDE	700m*	250m*	600m*	✓	✓
	SMART CONFERENCE	✓	✓	✓	✓	✓
	UNIVERSAL CONFERENCE	✓	✓	✓	✓	✓
	VOX	✓	✓	✓	✓	✓
	VOX	✓	✓	✓	✓	✓
	VOX	✓	✓	✓	✓	✓
	VOX	✓	✓	✓	✓	✓
	VOX	✓	✓	✓	✓	✓
PHONE	MOBILE PHONE	✓	✓	✓	✓	✓
	MOBILE PHONE	✓	✓	✓	✓	✓
	MOBILE PHONE	✓	✓	✓	✓	✓
	MOBILE PHONE	✓	✓	✓	✓	✓
	MOBILE PHONE	✓	✓	✓	✓	✓
	MOBILE PHONE	✓	✓	✓	✓	✓
	MOBILE PHONE	✓	✓	✓	✓	✓
	MOBILE PHONE	✓	✓	✓	✓	✓
	MOBILE PHONE	✓	✓	✓	✓	✓
	MOBILE PHONE	✓	✓	✓	✓	✓
HIGH VISIBILITY	EMERGENCY STOP SIGNAL (ESS)	✓ (B901L)				
	INTERMITTENT LIGHT	✓ (B901L)				
	REAR LIGHT	✓ (B901L)				
MULTIMEDIA	GPS	✓	✓	✓	✓	✓
	MUSIC	✓	✓	✓	✓	✓
	MUSIC	✓	✓	✓	✓	✓
	MUSIC	✓	✓	✓	✓	✓
	MUSIC	✓	✓	✓	✓	✓
	MUSIC	✓	✓	✓	✓	✓
	MUSIC	✓	✓	✓	✓	✓
OTHER FEATURES	FM RADIO	✓	✓	✓	✓	✓
	MOTORCYCLE VIA CABLE	✓	✓	✓	✓	✓
	EMERGENCY STOP SIGNAL (ESS)	✓	✓	✓	✓	✓
	INTERMITTENT LIGHT	✓	✓	✓	✓	✓
	REAR LIGHT	✓	✓	✓	✓	✓
	AUTO ON/OFF	✓	✓	✓	✓	✓
	INTERCOM HD	✓	✓	✓	✓	✓
	VOICE PROMPT	✓	✓	✓	✓	✓
	WINDOWS AND MAC	✓	✓	✓	✓	✓
	LOW BATTERY	✓	✓	✓	✓	✓

- BLUETOOTH® INTERCOM**
Interfono via Bluetooth® Pilota-Passeggero.
Rider-Passenger Intercom via Bluetooth®.
- UNIVERSAL INTERCOM**
Collegamento Bluetooth® con sistemi Interfono di altre marche.
Bluetooth® connection with intercom systems of other brands.
- BIKE TO BIKE INTERCOM**
Interfono Moto-Moto; comunicazione uno a uno.
Funzione "Chiamata Moto-Moto".
Intercom Bike to Bike: one to one communication.
"Bike to Bike Call" function.
- SMART CONFERENCE**
Conferenza interfono tra 4 sistemi N-Com di serie «900».
Intercom conference between 4 N-Com "900" series systems.
- UNIVERSAL CONFERENCE**
Conferenza interfono tra sistemi N-Com di serie «900» e un sistema affiliato come «Universal Intercom».
Intercom conference between N-Com "900" series systems and an affiliate "Universal Intercom" system.
- VOX**
Attivazione e disattivazione vocale dell'Interfono.
Voice activation and de-activation of the intercom.
- MOBILE PHONE**
Compatibilità via Bluetooth® con i telefoni cellulari.
Risposta, riaggancio, comandi vocali, ripetizione ultimo numero (per i telefoni che lo consentono), gestione automatica Interfono/telefono.
Connection via Bluetooth® to mobile phones.
Answering, hanging up, voice commands, redialling the last number (for telephones allowing that), intercom/phone automatic management.
- TWO DEVICES**
Connessione due dispositivi via Bluetooth® (due telefoni oppure un telefono e un navigatore satellitare).
Two-devices connection via Bluetooth® (two mobile phones or one mobile phone and one satellite navigator).
- FRIEND NUMBER**
Numero Amico con comando di chiamata rapido.
Friend number with quick dialing command.
- MOBILE CONFERENCE**
Funzione "Conferenza Telefono": telefonata a 3 tra Pilota, Passeggero e chiamante.
"Conference Call" function: 3-way telephone call between Rider, Passenger and caller.
- VOCAL ANSWER**
Risposta vocale alla telefonata entrante.
Voice-activated answering for incoming calls.
- SMART NAVI SYSTEM**
Gestione intelligente del navigatore dello smartphone.
Intelligent management of smartphone navigator.
- APP IOS/ANDROID**
App N-Com compatibile con Android, iPhone, iPad. Comando remoto da Smartphone. Verifica la compatibilità del tuo sistema.
N-Com App compatible with Android, iPhone, iPad. Remote control from Smartphone. Check the compatibility of your system.
- MUSIC VIA BLUETOOTH®**
Compatibilità via Bluetooth® con i lettori Mp3 dotati del Profilo A2DP.
Play, Pause, Stop, Skip direttamente dal casco (profilo AVRCP).
Connection via Bluetooth® to Mp3 players with A2DP Profile. Play, Pause, Stop, Skip directly from the helmet (AVRCP profile).
- MUSIC SHARING**
Condivisione della musica via Bluetooth® con un secondo casco.
Sharing of music with a second helmet via Bluetooth®.
- MUSIC VIA CABLE**
Compatibilità via Bluetooth® con i lettori Mp3 dotati del Profilo A2DP.
Play, Pause, Stop, Skip direttamente dal casco (profilo AVRCP).
Connection via Bluetooth® to Mp3 players with A2DP Profile. Play, Pause, Stop, Skip directly from the helmet (AVRCP profile).
- GPS VIA BLUETOOTH®**
Compatibilità via Bluetooth® con i navigatori satellitari compatibili. Indicazioni stradali, musica Mp3, telefono cellulare (per i modelli che lo consentono).
Connection via Bluetooth® to compatible satellite navigators.
Directions, MP3 music, mobile phone (for models allowing that).
- FM RADIO**
Radio FM integrata con RDS; Ricerca stazioni; 6 pre-stazioni.
FM radio integrated with RDS; Search for radio stations, 6 pre-settings.
- MOTORCYCLE VIA CABLE**
Collegamento al sistema audio della moto Honda Goldwing e Harley Davidson con specifico cavo Multi-media Wire.
Connection to Honda Goldwing and Harley Davidson audio systems with specific Multimedia Wire.
- EMERGENCY STOP SIGNAL (ESS)**
Sistema ESS (Emergency Stop Signal): Segnalazione con luce LED intermittente delle forti decelerazioni del casco.
ESS (Emergency Stop Signal) system: Intermittent LED light signals sudden helmet decelerations.
- INTERMITTENT LIGHT**
Funzione Luce intermittente per situazioni di scarsa visibilità.
Intermittent light function in case of poor visibility.
- REAR LIGHT**
Funzione Luce di Posizione: luce LED fissa per segnalazione di presenza.
Stable rear light function: fixed LED lamp for visibility.
- AUTO ON/OFF**
Gestione automatica dell'accensione e dello spegnimento del sistema tramite accelerometro.
Automatic management of system ON/OFF through accelerometer.
- INTERCOM HD**
Riduzione dinamica del rumore durante il collegamento interfono.
Dynamic noise reduction during intercom communication.
- VOICE PROMPT**
Il sistema N-Com segnala con un'indicazione vocale il passaggio da una voce di menù all'altra e con-ferma l'attivazione / disattivazione di alcuni comandi riservati.
The N-Com system signals the change from one menu to another and confirms the activation / deactivation of some commands reserved.
- WINDOWS AND MAC**
Gestione da PC via cavo micro/mini USB. Aggiornamento Firmware, Regolazione dei parametri audio, Memorizzazione stazioni radio FM (se presente).
Management from PC via micro/mini USB wire. Firmware update, Adjustment of audio parameters, FM radio stations pre-setting (if present).
- LOW BATTERY**
Indicazione batteria in esaurimento con segnale acustico e visivo, funzione auto-spegnimento.
Battery low indicator with acoustic and visual signal, auto-off function.

Figure 8.1: Comprehensive feature comparison table for various Nolan N-Com communication systems, including the B601 R.

9. WARRANTY AND SUPPORT

The Nolan B601 R N-Com system is covered by a manufacturer's warranty against defects in materials and workmanship. Please retain your proof of purchase for warranty claims.

For detailed warranty information, technical support, frequently asked questions (FAQs), and the latest software updates, please visit the official Nolan N-Com website:

[Visit Nolan N-Com Official Website](#)

Regularly checking the website for updates is recommended to ensure your system operates with the latest features and optimal performance.

© 2024 Nolan N-Com. All rights reserved.

This manual is for informational purposes only. Specifications are subject to change without notice.