

LoraTap SP121SC-US-915

LoraTap Mini Wireless Remote Control Outlet Plug Adapter User Manual

Model: SP121SC-US-915

Brand: LoraTap

1. INTRODUCTION

This manual provides detailed instructions for the installation, operation, and maintenance of your LoraTap Mini Wireless Remote Control Outlet Plug Adapter. This device is designed to provide convenient wireless control for household appliances, offering ease of use and flexibility.

1.1 Package Contents

- 1 x LoraTap Mini Wireless Remote Control Outlet Plug Adapter
- 2 x LoraTap Wireless Remote Controls
- 2 x CR2032 Batteries (pre-installed in remotes)
- Adhesive Mounting Squares (for remote base)



Image 1.1: LoraTap Mini Wireless Remote Control Outlet Plug Adapter with two remotes.

The image above displays the main components included in your package: one plug adapter and two remote controls. The remote controls are circular with 'ON' and 'OFF' buttons, and the plug adapter is compact with a standard US three-prong plug.

2. SAFETY INFORMATION

- Do not exceed the maximum load capacity of 10 Amps or 1100 Watts. Overloading can cause damage to the device and potential fire hazards.
- This device is designed for indoor use only. Avoid exposure to moisture, extreme temperatures, or direct sunlight.
- Ensure the plug adapter is fully inserted into a grounded electrical outlet.
- Do not disassemble or modify the device. Refer all servicing to qualified personnel.
- Keep out of reach of children.

3. SETUP INSTRUCTIONS

3.1 Unpacking

Carefully remove all components from the packaging. Inspect for any signs of damage. If any components are damaged or missing, contact customer support.

3.2 Initial Placement and Powering On

1. Plug the LoraTap Mini Wireless Remote Control Outlet Plug Adapter into a standard 110V AC grounded wall outlet.
2. Connect the appliance you wish to control into the LoraTap plug adapter. Ensure the appliance's power switch is in the 'ON' position if it has one.



Image 3.1: Visual guide for the initial setup process. This image illustrates opening the package, plugging the device into a wall outlet, and then using the remote control to operate the connected appliance.

3.3 Pairing (Pre-paired from Factory)

Your LoraTap Mini Wireless Remote Control Outlet Plug Adapter and remotes are pre-paired at the factory. No additional pairing steps are required before initial use. Simply plug in the outlet and use the remote to control your appliance.

4. OPERATING INSTRUCTIONS

4.1 Basic On/Off Control

To turn the connected appliance ON, press the 'ON' button on the remote control. To turn it OFF, press the 'OFF' button. A blue LED indicator on the plug adapter will illuminate when the power is ON.

4.2 Remote Placement and Portability

The remote control features a magnetic base, allowing it to be mounted on magnetic surfaces like refrigerators or on the included magnetic plate base. The magnetic plate can be fixed to a wall using the provided adhesive tape. The remote can also be easily removed from its base for portable use, functioning as a handheld wireless switch.

Easy to Carry

Operate from anywhere in your home at any time.



Image 4.1: The remote control's versatility, showing it placed on a bedside table, a coffee table, a sofa armrest, and magnetically attached to a refrigerator, highlighting its portability and ease of access.

RF Remote Control

You can control the light with a RF remote control.

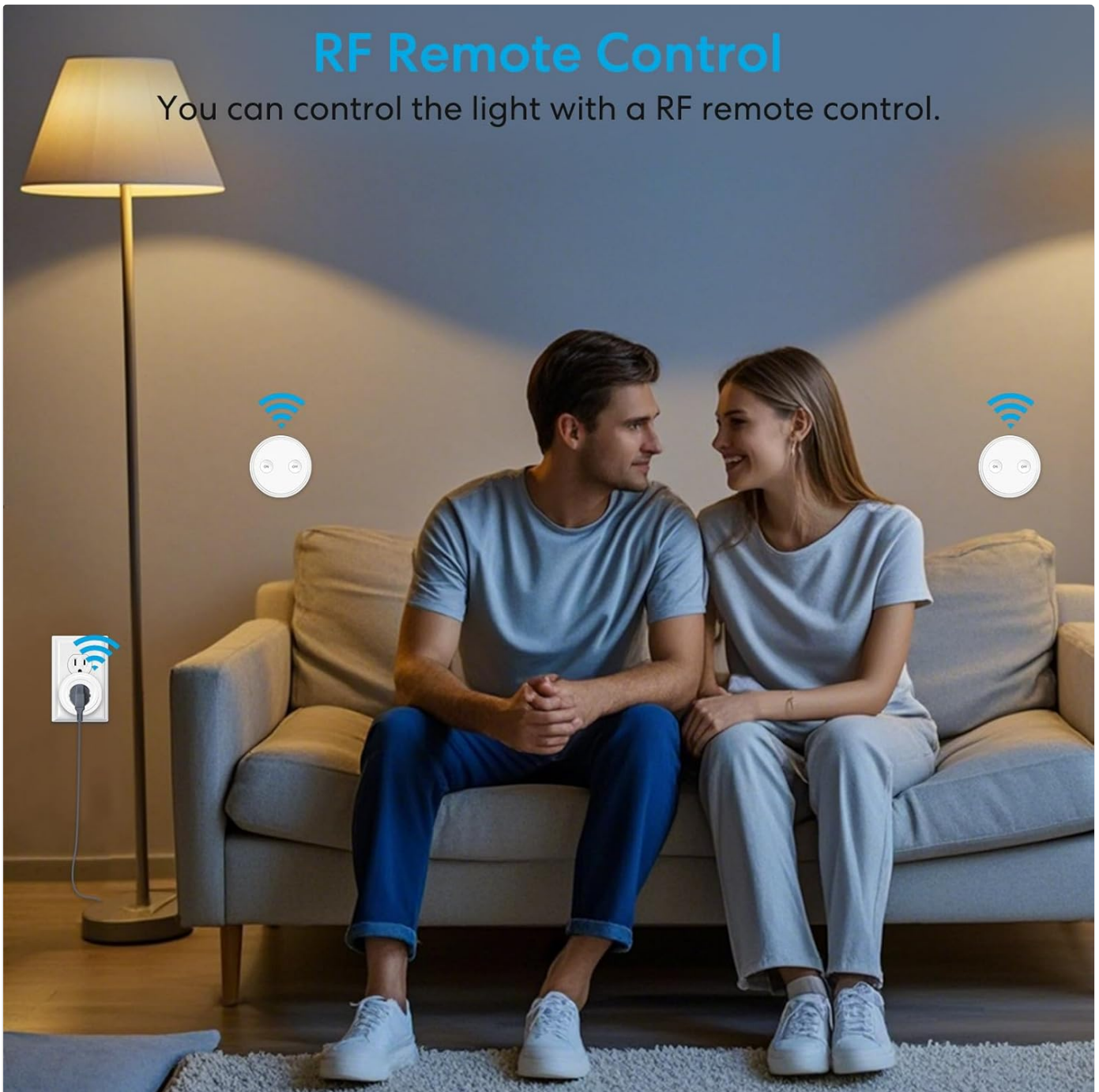

Image 4.2: A couple relaxing on a sofa, with LoraTap remotes mounted on the wall behind them, demonstrating how the RF remote control can operate a lamp connected to the plug adapter.

5. KEY FEATURES

5.1 Remote Control Range

The LoraTap system utilizes a 915MHz RF wireless signal, providing a strong and reliable connection. The indoor wireless control range extends up to 100 feet (30 meters), and the outdoor range can reach up to 656 feet (200 meters) in open areas. The signal is capable of penetrating walls, windows, and ceilings without interfering with other electronic devices.

Super Remote Control Distance

The indoor control range is up to 30 meters, and the strong signal can go through walls, windows, and ceilings.

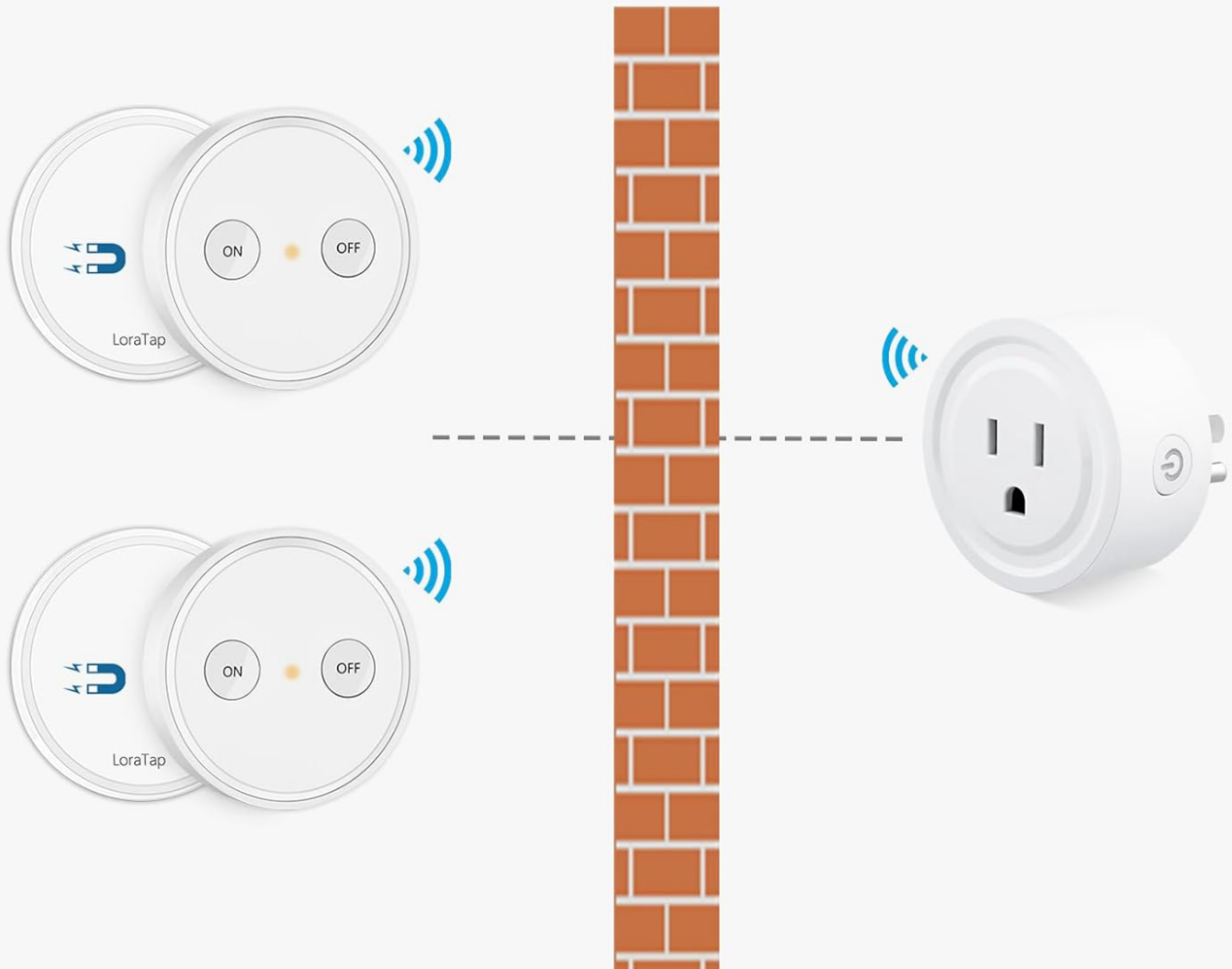

Image 5.1: This diagram visually represents the 'Super Remote Control Distance' feature, showing the wireless signal from the remote controls passing through a brick wall to operate the plug adapter, indicating its ability to work through obstacles.

5.2 Memory Function

The LoraTap wireless plug-in receiver is equipped with a memory function. In the event of a power outage, the outlet will retain its last ON/OFF state once power is restored. For example, if the appliance was OFF before a power failure, it will remain OFF after power returns, contributing to energy saving.



Image 5.2: This image illustrates the 'Outlet with Memory Function' by showing a lamp's state before a power failure (on), during a power failure (off), and after power is restored (remaining off), demonstrating that the outlet remembers its last state.

5.3 Non-Interference

Each LoraTap remote control and outlet kit has a unique ID. This design ensures that multiple LoraTap wireless plug outlet kits can operate in the same area or room without signal interference between them.



Image 5.3: This diagram demonstrates the 'No Interference' feature, showing two distinct LoraTap plug adapters (A and B) each paired with their respective remote controls (A1, A2 and B1, B2), indicating that they can operate simultaneously without signal conflict.

6. MAINTENANCE

6.1 Battery Replacement

The remote control is powered by a CR2032 coin cell battery. When the remote's performance diminishes or it stops responding, it may be time to replace the battery. To replace the battery:

1. Gently twist the back cover of the remote control counter-clockwise to open it.
2. Remove the old CR2032 battery.
3. Insert a new CR2032 battery with the positive (+) side facing up.
4. Align the back cover and twist clockwise to secure it.

Mountable and Movable

Remote Control with Magnetic Base

Dia: 2.68in



Image 6.1: This image details the 'Mountable and Movable' remote control, illustrating its magnetic base, the location of the CR2032 battery, and how to open the remote for battery replacement.

6.2 Cleaning

To clean the device, wipe it with a soft, dry cloth. Do not use liquid cleaners or abrasive materials, as these may damage the product.

7. TROUBLESHOOTING

- **Device not responding:**
 - a. Ensure the plug adapter is securely plugged into a live outlet.
 - b. Verify the appliance connected to the adapter is powered on and functioning correctly.
 - c. Check the battery in the remote control and replace if necessary.
- **Limited range:**
 - a. Ensure there are no major obstructions (e.g., thick concrete walls, large metal objects) between the remote and the plug adapter.

b. Move the remote closer to the plug adapter to test if the range improves.

• **Interference with other devices:**

The LoraTap system is designed to prevent interference. If you experience issues, ensure no other wireless devices are operating on the same frequency or are too close to the LoraTap units.

8. SPECIFICATIONS

Feature	Specification
Model Number	SP121SC-US-915
Operating Voltage	110 Volts (AC)
Current Rating	10 Amps
Load Power	Max 1100 Watts
Wireless Frequency	915MHz RF
Indoor Range	Up to 100 ft (30 meters)
Outdoor Range	Up to 656 ft (200 meters)
Remote Battery Type	CR2032 (included)
Product Dimensions (Outlet)	1.85 x 1.85 x 1.14 inches
Product Dimensions (Remote)	2.68 inch diameter, 0.63 inch thickness
Operation Mode	ON-OFF-ON
Contact Type	Normally Open
Certifications	FCC, CE, RoHS

Dimension

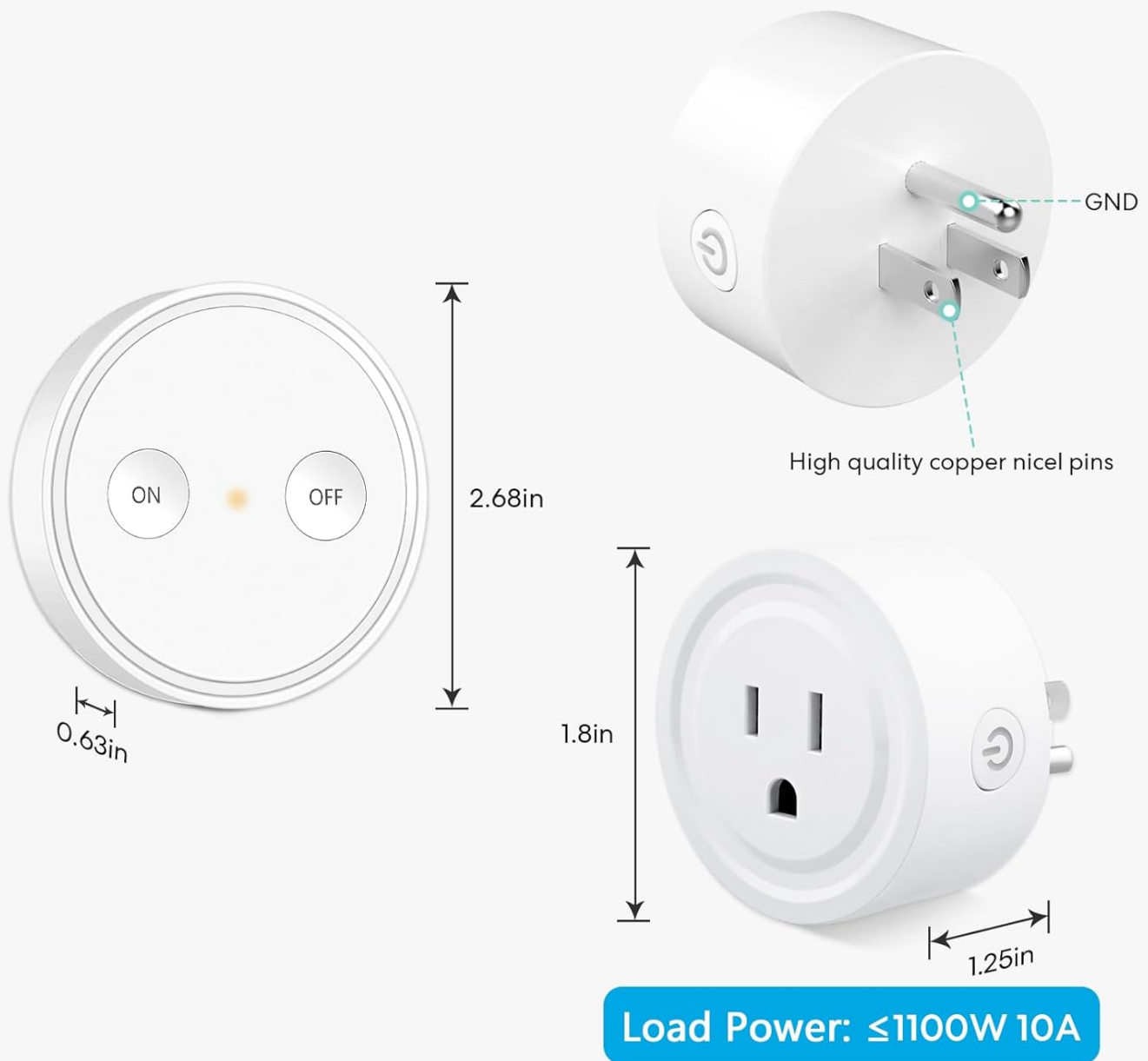

Image 8.1: This image provides detailed dimensions for both the remote control and the plug adapter, including their height, width, and depth, and reiterates the maximum load power of 1100W and 10A.

9. WARRANTY AND SUPPORT



9.1 Product Warranty

The LoraTap Mini Wireless Remote Control Outlet Plug Adapter comes with a 2-year warranty from the date of purchase. This warranty covers manufacturing defects and ensures the product functions as intended under normal use. Please retain your proof of purchase for warranty claims.

9.2 Customer Support

For technical assistance, troubleshooting, or warranty inquiries, please contact LoraTap customer support through the retailer's platform or the official LoraTap website. Please have your model number (SP121SC-US-915) and purchase date available when contacting support.

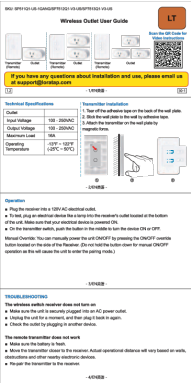
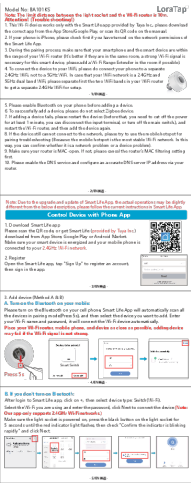
Related Documents - SP121SC-US-915

	<p>Loratap Wireless Outlet User Guide: Installation, Operation, and Troubleshooting</p> <p>Comprehensive user guide for Loratap wireless outlets (models SP511Q1, SP7512Q1, SP7513Q1). Learn about installation, operation, pairing, troubleshooting, and safety warnings for your smart home devices.</p>
	<p>LoraTap BA101KS Smart Wi-Fi Light Socket User Guide</p> <p>Comprehensive user guide for the LoraTap BA101KS Smart Wi-Fi LED Light Bulb Socket Adapter, covering setup, app control, troubleshooting, and specifications.</p>
	<p>LoraTap SC500W Roller Shutter Module User Guide and Installation</p> <p>Comprehensive user guide for the LoraTap SC500W Roller Shutter Module, covering installation, wiring, setup with the Smart Life app, and troubleshooting for smart home automation.</p>
	<p>Loratap Wireless Socket User Guide - SP511Q2-US-V3, SP512Q2-US-V3</p> <p>User guide for the Loratap Wireless Socket models SP511Q2-US-V3 and SP512Q2-US-V3. Includes installation, pairing, troubleshooting, and technical specifications.</p>

Installation Cautions:

- Turn off the AC power before installation!
- Do not connect DC powered motor, the device is dedicated to operating AC-powered electric motors.
- The device should be installed in a well-ventilated area with no direct sunlight.
- Works ONLY with roller blind motors with electronic or mechanical limit switches.

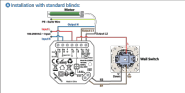

①-Output M1: Neutral Wire for Motor
②-Input N: Neutral Wire/Blue Wire or White Wire
③-Input L: Live Wire or Hot Wire/Red/Black Wire from AC Power
④-Input 1: Input Live Wire for trigger switch
⑤-Output L1: Brown Wire of Motor (for output terminal for shutter motor)
⑥-Output L2: Black Wire of Motor (for output terminal for shutter motor)
⑦-0V: Terminal for 0V channel
⑧-M2: Terminal for 2nd channel

The LoraTap module doesn't have a terminal for earth wire, so there's no need to connect the earth wire of the motor.

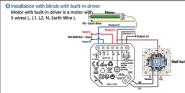

①-If you don't use physical manual switch, please refer to below wiring diagram.

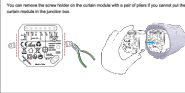
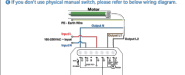

[LoraTap SC500W Smart Curtain Switch Installation Guide & Wiring Diagrams](#)

Detailed installation guide and wiring instructions for the LoraTap SC500W smart curtain switch module. This document covers installation cautions, wiring for standard blinds and blinds with built-in drivers, and options for use without a physical manual switch, ensuring proper AC power connection for smart home automation.

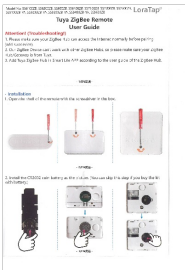

[Tuya ZigBee Remote User Guide - LoraTap Installation and Pairing](#)

Comprehensive user guide for the LoraTap Tuya ZigBee Remote. Includes installation instructions, pairing steps with ZigBee hubs, troubleshooting tips, and product specifications. Model numbers: SS6100ZB, SS6200ZB, SS600ZB, SS6400ZB, SS7100ZB, SS7200ZB, SS7300ZB, SS9100ZB-YA, SS9200ZB-YA, SS9300ZB-YA, SS9400ZB-YA, SS9600ZB.