



Manuals.plus /

› Walfront /

› Walfront LCD Digital Programmable Weekly Timer Switch (24V) Instruction Manual

Walfront 24V

Walfront LCD Digital Programmable Weekly Timer Switch (24V) Instruction Manual

Model: 24V

[Introduction](#)
[Instructions](#)

[Safety Information](#)
[Specifications](#)

[Product Overview](#)
[Maintenance](#)

[Setup & Installation](#)
[Troubleshooting](#)

[Operating](#)
[Warranty & Support](#)

1. INTRODUCTION

Thank you for choosing the Walfront LCD Digital Programmable Weekly Timer Switch. This device is designed for automatic control of various electrical appliances based on user-defined schedules. Please read this manual carefully before installation and operation to ensure proper use and to prevent damage.

2. SAFETY INFORMATION

Warning: Electrical installation should only be performed by qualified personnel. Disconnect power before installation or maintenance to prevent electric shock.

- Ensure the input voltage matches the timer's specifications (24V for this model).
- Do not exceed the maximum load capacity of 16A 250VAC (resistive load).
- Keep the device away from water and excessive humidity.
- Do not attempt to disassemble or repair the unit yourself. Contact support if issues arise.

3. PRODUCT OVERVIEW

The Walfront LCD Digital Programmable Weekly Timer Switch is a high-precision device built with durable, moisture-resistant, and corrosion-protected materials. It features a clear LCD display and supports up to 16 ON/OFF programs daily and weekly.

3.1 Key Features

- High-quality construction for long lifespan.
- Automatic ON/OFF control for various electrical devices.
- Built-in 1.2V/40mA rechargeable battery for memory retention.

- Industrial-grade chip for high precision and strong anti-interference.
- Up to 16 ON and 16 OFF programming settings per day/week.
- LCD display showing real-time, hour, minute, and ON/AUTO/OFF status.
- DIN rail mounting design.

3.2 Components



Image 1: Front view of the Walfront LCD Digital Programmable Weekly Timer Switch. Shows the LCD display and control buttons.

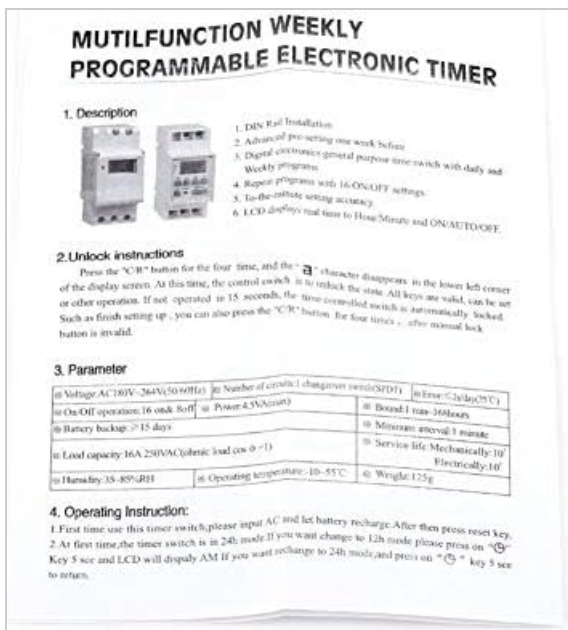

Image 2: Back view of the timer switch, illustrating the wiring terminals and basic electrical specifications printed on the unit.

4. SETUP & INSTALLATION

This timer is designed for DIN rail mounting. Ensure the DIN rail is securely installed before attaching the

timer.

4.1 Wiring Diagram

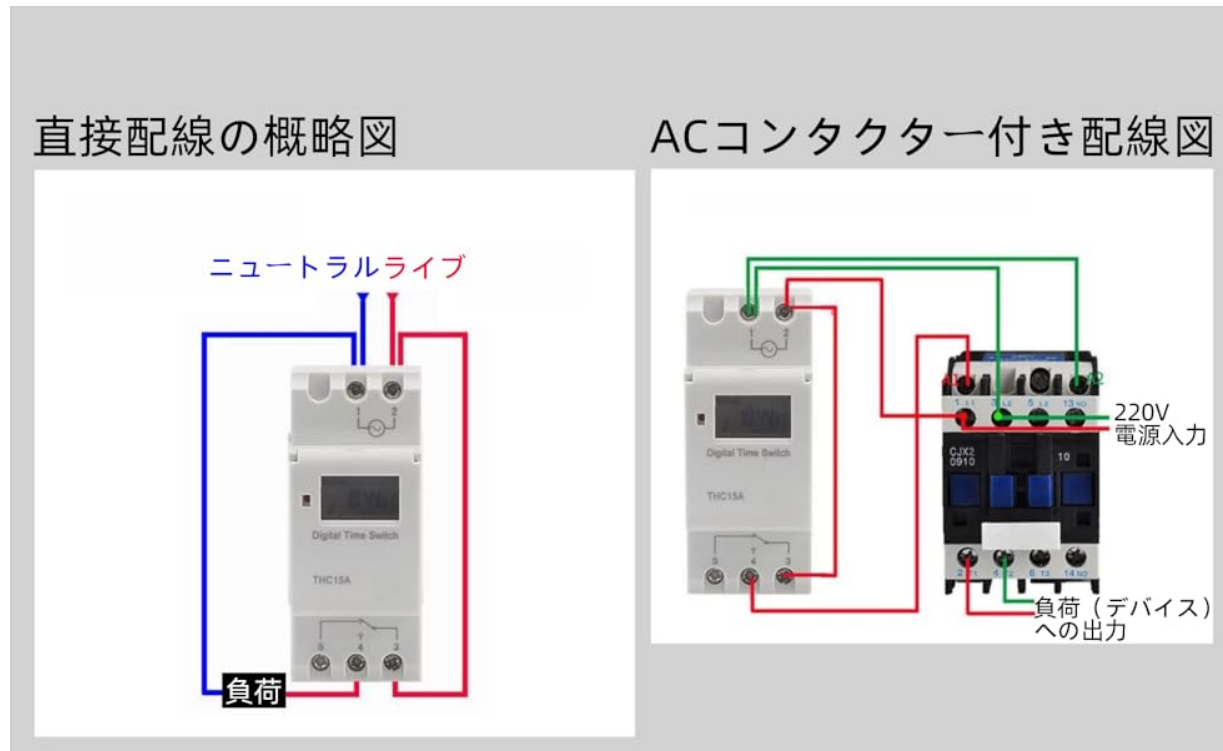

Image 3: Wiring diagrams showing direct connection (left) and connection with an AC contactor (right). The direct connection illustrates neutral and live wire inputs and load output. The AC contactor diagram shows 220V power input and output to the load device.

Direct Wiring: Connect the neutral and live wires to the designated input terminals (L and N). Connect the load to the output terminals (typically 3 and 4 for normally open, or 3 and 5 for normally closed, as indicated on the device). Refer to the diagram on the device for exact terminal numbering.

Wiring with AC Contactor: For higher loads, connect the timer to control an AC contactor. The timer's output will switch the coil of the contactor, which in turn controls the main power to the load. This setup is shown on the right side of Image 3.

4.2 Initial Power-Up and Battery Charging

Upon first use, connect the timer to power. The internal 1.2V/40mA rechargeable battery will begin charging. If the display is blank or shows incorrect time, allow it to charge for a few minutes. Press the **"Reset"** button (often labeled with a small 'R' or 'C' and requires a pointed object) to clear all settings and start fresh.

5. OPERATING INSTRUCTIONS

5.1 Setting Current Time

1. Press the **"CLOCK"** button (often labeled with a clock icon) and hold it.
2. While holding **"CLOCK"**, press the **"D+"** button to set the current day of the week.
3. While holding **"CLOCK"**, press the **"H+"** button to set the current hour.
4. While holding **"CLOCK"**, press the **"M+"** button to set the current minute.
5. Release the **"CLOCK"** button. The time is now set.

5.2 Setting 12/24 Hour Mode

By default, the timer operates in 24-hour mode. To switch between 12-hour (AM/PM) and 24-hour modes,

press and hold the **"CLOCK"** button for approximately 5 seconds. The display will show "AM" for 12-hour mode or switch back to 24-hour format.

5.3 Programming ON/OFF Schedules

The timer supports up to 16 ON and 16 OFF programs. Each program consists of an ON time and an OFF time.

1. Press the **"PROG"** button once. The display will show "1 ON".
2. Press **"D+"** to select the day(s) for this ON program (e.g., Mon-Fri, Sat-Sun, or specific days).
3. Press **"H+"** to set the desired ON hour.
4. Press **"M+"** to set the desired ON minute.
5. Press **"PROG"** again. The display will show "1 OFF".
6. Repeat steps 2-4 to set the OFF time for the first program.
7. Continue pressing **"PROG"** to cycle through "2 ON", "2 OFF", up to "16 ON", "16 OFF", setting each as needed.
8. After setting all desired programs, press the **"CLOCK"** button to exit programming mode and return to real-time display.

Note: If you need to cancel a program, press the **"PROG"** button to select the program, then press the **"MANUAL"** button until "----" appears on the display for that program's time slot.

5.4 Manual Override (ON/AUTO/OFF)

Press the **"MANUAL"** button to cycle through the operating modes:

- **ON:** The output is continuously ON, ignoring all programs.
- **AUTO:** The timer operates according to the programmed ON/OFF schedules.
- **OFF:** The output is continuously OFF, ignoring all programs.

Ensure the timer is in **"AUTO"** mode for programmed operation.

5.5 Key Lock Function

To prevent accidental changes to settings, the timer features a key lock function.



Image 4: The timer display showing the key lock symbol, indicating that the buttons are locked.

- To lock the keys: Press and hold the **"C/R"** (Cancel/Reset) button for approximately 4 seconds until a lock symbol appears on the LCD.
- To unlock the keys: Press and hold the **"C/R"** button again for approximately 4 seconds until the lock symbol disappears.

6. SPECIFICATIONS

Parameter	Value
Input Voltage	AC/DC 24V (This model)
Contact Rated Voltage	AC 180V~264V (50/60Hz)
Load Capacity	16A 250VAC (Resistive Load)
ON/OFF Operations	16 ON / 16 OFF (Manual/Auto)
Display	LCD
Power Consumption	4.5VA (Max)
Error	≤2 seconds/day (at 25°C)
Mounting Method	DIN Rail (sold separately)
Timing Range	1 minute to 168 hours
Minimum Interval	1 minute
Operating Temperature	-10°C to 55°C
Operating Humidity	35-85% RH
Dimensions (L x W x H)	86 x 36 x 65mm
Internal Battery	1.2V/40mA rechargeable, >15 days backup
Number of Circuits	Changeover switch (SPDT)
Service Life	Mechanical: 10 ⁷ , Electrical: 10 ⁵
Weight	125g



Image 5: Diagram illustrating the dimensions of the timer switch: 86mm length, 36mm width, and 65mm height.

7. MAINTENANCE

- Keep the timer clean and free from dust. Use a dry, soft cloth for cleaning.
- Do not use abrasive cleaners or solvents.
- Periodically check wiring connections to ensure they are secure.

- The internal battery is designed for long life and typically does not require replacement. If the timer loses settings frequently after power outages, the battery may need servicing by a qualified technician.

8. TROUBLESHOOTING

Problem	Possible Cause	Solution
Display is blank.	No power supply or internal battery discharged.	Check power connections. Allow the timer to charge for a few minutes after connecting to power.
Timer does not switch ON/OFF as programmed.	Timer is not in "AUTO" mode, programs are incorrect, or key lock is active.	Press "MANUAL" until "AUTO" is displayed. Review and correct programs. Unlock keys if necessary.
Buttons are unresponsive.	Key lock function is active.	Press and hold "C/R" for 4 seconds to unlock the keys.
Time is inaccurate.	Minor drift (within specifications) or internal battery issue.	Reset and re-set the time. If inaccuracy persists or settings are lost frequently, contact support.

9. WARRANTY AND SUPPORT

Walfront strives to provide high-quality products. If you encounter any issues with your product, please contact us for prompt assistance. We offer return and refund services for product defects.

For support, please refer to the contact information provided with your purchase or visit the Walfront store on Amazon: [Walfront Amazon Store](#).