

Kobalt SGY-AIR226

Kobalt SGY-AIR226 3-inch Cut Off Tool Instruction Manual

1. INTRODUCTION

This manual provides essential information for the safe and effective operation, setup, and maintenance of your Kobalt SGY-AIR226 3-inch Cut Off Tool. Please read all instructions carefully before using the tool to ensure proper function and to prevent injury.



Image 1.1: The Kobalt SGY-AIR226 3-inch Cut Off Tool shown with its included accessories, an Allen wrench and a spanner wrench. The tool features a blue body with the Kobalt logo, a cutting wheel with a protective guard, and an air inlet.

2. SAFETY INFORMATION

WARNING: Always wear appropriate personal protective equipment (PPE) including eye protection, hearing protection, and gloves when operating this tool. Read and understand all safety warnings and instructions before use.

- **Work Area Safety:** Keep the work area clean and well-lit. Do not operate power tools in explosive atmospheres, such as in the presence of flammable liquids, gases, or dust.
- **Electrical Safety:** This is an air tool, but ensure any associated electrical equipment (e.g., air compressor) is properly grounded and maintained.
- **Personal Safety:** Stay alert, watch what you are doing, and use common sense when operating a power tool. Do not use the tool while tired or under the influence of drugs, alcohol, or medication.
- **Tool Use and Care:** Do not force the tool. Use the correct tool for your application. Disconnect the air supply before making any adjustments, changing accessories, or storing the tool.
- **Air Supply Safety:** Ensure the air compressor is set to the correct pressure for the tool. Never exceed the maximum operating pressure. Use clean, dry, regulated compressed air.
- **Cutting Wheel Safety:** Always use cutting wheels rated for the tool's maximum RPM. Inspect cutting wheels for damage before each use. Never use a damaged or cracked wheel.

3. PACKAGE CONTENTS

Verify that all items are present upon unpacking:

- Kobalt SGY-AIR226 3-inch Cut Off Tool
- Allen Wrench
- Spanner Wrench
- Instruction Manual

4. PRODUCT FEATURES

The Kobalt SGY-AIR226 3-inch Cut Off Tool is designed for efficient cutting tasks with several user-focused features:

- **Reversible Operation:** Provides enhanced control during various cutting applications.
- **Spindle Lock:** Facilitates quick and easy accessory changes, reducing downtime.
- **Insulated Ergonomic Handle:** Designed for user comfort, helping to prevent cold hands during extended use.
- **Durable Cutting Guard:** Effectively blocks sparks and flying debris, enhancing user safety.
- **Built-in Muffler:** Reduces operational noise for a more comfortable working environment.

5. SETUP

Follow these steps to prepare your cut off tool for operation:

1. **Connect Air Supply:** Attach a suitable air hose (not included) to the tool's air inlet. Ensure the connection is secure and leak-free. Connect the other end of the hose to a regulated air compressor.
2. **Install Cutting Wheel:**
 - Ensure the tool is disconnected from the air supply.
 - Press and hold the spindle lock button.
 - Using the provided spanner wrench, loosen and remove the outer flange nut.

- Place the desired 3-inch cutting wheel onto the spindle, ensuring it is properly seated.
 - Replace the outer flange nut and tighten it securely with the spanner wrench while holding the spindle lock. Do not overtighten.
3. **Adjust Cutting Guard:** Position the cutting guard to provide maximum protection from sparks and debris for your specific cutting application. Ensure it is securely fastened.
 4. **Set Air Pressure:** Adjust your air compressor's regulator to the recommended operating pressure for the tool (refer to tool specifications or manufacturer guidelines).

6. OPERATING INSTRUCTIONS

Before operating, ensure all safety precautions are followed and the tool is properly set up.

1. **Secure Workpiece:** Always clamp or otherwise secure the material you intend to cut. Never hold the workpiece by hand.
2. **Grip the Tool:** Hold the tool firmly with both hands, maintaining a balanced stance.
3. **Start the Tool:** Depress the trigger to start the cutting wheel. Allow the wheel to reach full operating speed before contacting the workpiece.
4. **Perform the Cut:** Apply light, consistent pressure to the workpiece. Allow the tool to do the work. Do not force the tool, as this can lead to kickback, wheel damage, or injury.
5. **Control Direction:** The tool is reversible. Use the directional switch (if present) to select the desired rotation for optimal control and spark deflection.
6. **Finish the Cut:** Once the cut is complete, release the trigger and allow the cutting wheel to stop completely before setting the tool down.

7. MAINTENANCE

Regular maintenance ensures the longevity and safe operation of your tool.

- **Disconnect Air Supply:** Always disconnect the tool from the air supply before performing any maintenance.
- **Cleaning:** After each use, clean the tool with a dry cloth. Remove any dust or debris from the air vents and around the cutting wheel area.
- **Lubrication:** For air tools, apply a few drops of pneumatic tool oil into the air inlet before and after each use, or as recommended by the manufacturer, to lubricate internal components.
- **Inspect Cutting Wheels:** Regularly inspect cutting wheels for wear, cracks, or damage. Replace worn or damaged wheels immediately.
- **Check Air Connections:** Periodically check air hose connections and fittings for leaks or damage.
- **Storage:** Store the tool in a clean, dry place, out of reach of children.

8. TROUBLESHOOTING

If you encounter issues with your Kobalt SGY-AIR226, refer to the following common problems and solutions:

| Problem | Possible Cause | Solution |
|---------|----------------|----------|
|---------|----------------|----------|

| Problem | Possible Cause | Solution |
|------------------------------------|---|---|
| Tool does not start or runs slowly | Low air pressure; Clogged air inlet; Lack of lubrication | Check air compressor pressure; Clean air inlet filter; Apply pneumatic tool oil |
| Excessive vibration or noise | Damaged or improperly installed cutting wheel; Loose components | Inspect and replace cutting wheel; Ensure all fasteners are tight |
| Poor cutting performance | Worn or incorrect cutting wheel; Insufficient air pressure | Replace cutting wheel; Verify correct air pressure |

9. SPECIFICATIONS

| Specification | Value |
|--------------------|-------------------------|
| Model | SGY-AIR226 |
| Brand | Kobalt |
| Product Dimensions | 10.5 x 4.6 x 3.6 inches |
| Item Weight | 2.2 pounds |
| ASIN | B07JM5C25N |
| Manufacturer | Kobalt |

10. WARRANTY AND SUPPORT

For warranty information and customer support, please refer to the documentation provided at the time of purchase or contact Kobalt customer service directly. Keep your purchase receipt as proof of purchase.

Related Documents - SGY-AIR226

| | |
|---|--|
|  | <p>Kobalt SGY-AIR225 Air Hammer User Manual and Operating Guide</p> <p>Comprehensive user manual for the Kobalt SGY-AIR225 Air Hammer, covering product specifications, safety information, assembly, operation, maintenance, troubleshooting, and warranty details.</p> |
|---|--|

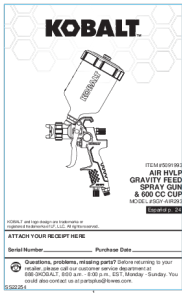

[Kobalt SGY-AIR293 HVLP Gravity Feed Spray Gun User Manual](#)

User manual for the Kobalt SGY-AIR293 HVLP Gravity Feed Spray Gun with 600 CC cup. Covers setup, operation, safety, maintenance, and troubleshooting for optimal performance.

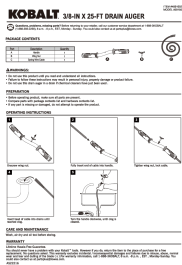

[Kobalt 3/8-in x 25-ft Drain Auger: Operating Manual & Instructions](#)

Comprehensive guide for the Kobalt 3/8-in x 25-ft Drain Auger (Item #4891692, Model #59185). Learn how to use, prepare, maintain, and understand the warranty for this plumbing tool.



[Kobalt 50 ft Pro Retractable Hose Reel with Premium Rubber Air Hose - Model SGY-AIR266 User Manual](#)

This manual provides instructions for the Kobalt 50 ft Pro Retractable Hose Reel with Premium Rubber Air Hose (Model SGY-AIR266). It covers package contents, safety precautions, preparation, assembly steps, operating instructions, care and maintenance, troubleshooting, and warranty information.

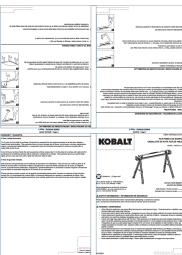

[Kobalt 43-inch Fixed Leg Sawhorse - Setup, Safety, and Warranty](#)

This document provides setup instructions, safety warnings, and limited warranty details for the Kobalt 43-inch Fixed Leg Sawhorse.

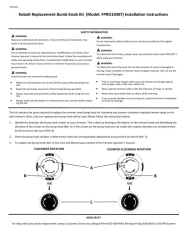

[Kobalt FPRO10407 Replacement Bump Knob Kit Installation Instructions](#)

Step-by-step installation instructions for the Kobalt FPRO10407 Replacement Bump Knob Kit for Kobalt string trimmers. Includes essential safety information and customer support contact details.