

KODAK RODESV25

KODAK 35mm Slide and Film Viewer (Model RODESV25) Instruction Manual

Brand: KODAK | Model: RODESV25

1. OVERVIEW

The KODAK 35mm Slide and Film Viewer is designed to enlarge and illuminate 35mm slides and film negatives for clear viewing. It features a built-in LED light box for optimal clarity and contrast, and a 3X magnification lens to make small images appear larger without losing sharpness or detail. This device offers both battery operation for portability and an optional DC power input for continuous use.

3x Magnification

Viewing Slides
Made Simple



Image: The KODAK 35mm Slide and Film Viewer showcasing a magnified 35mm slide, illustrating its 3X magnification capability for easy viewing.

2. SETUP

2.1 Battery Installation

For portable use, the viewer requires 4 AA batteries (not included). To install batteries:

1. Locate the battery compartment on the underside of the viewer.
2. Open the battery compartment cover.
3. Insert 4 AA batteries, ensuring correct polarity (+/-) as indicated inside the compartment.
4. Close the battery compartment cover securely.

Battery Operated

*AA Batteries
Not Included



Image: The KODAK 35mm Slide and Film Viewer with its battery compartment open, showing the placement of four AA batteries for power.

2.2 Optional AC Adapter

For continuous power, the viewer can be connected to a standard 6V AC/DC adapter (sold separately). Locate the DC 6V 500mA input port on the side of the device and plug in the adapter.



Optional Power Adapter Compatibility

*Power Adapter Sold Separately

Image: A detailed view of the KODAK 35mm Slide and Film Viewer highlighting the DC 6V 500mA port for an optional power adapter.

3. OPERATING INSTRUCTIONS

3.1 Device Components

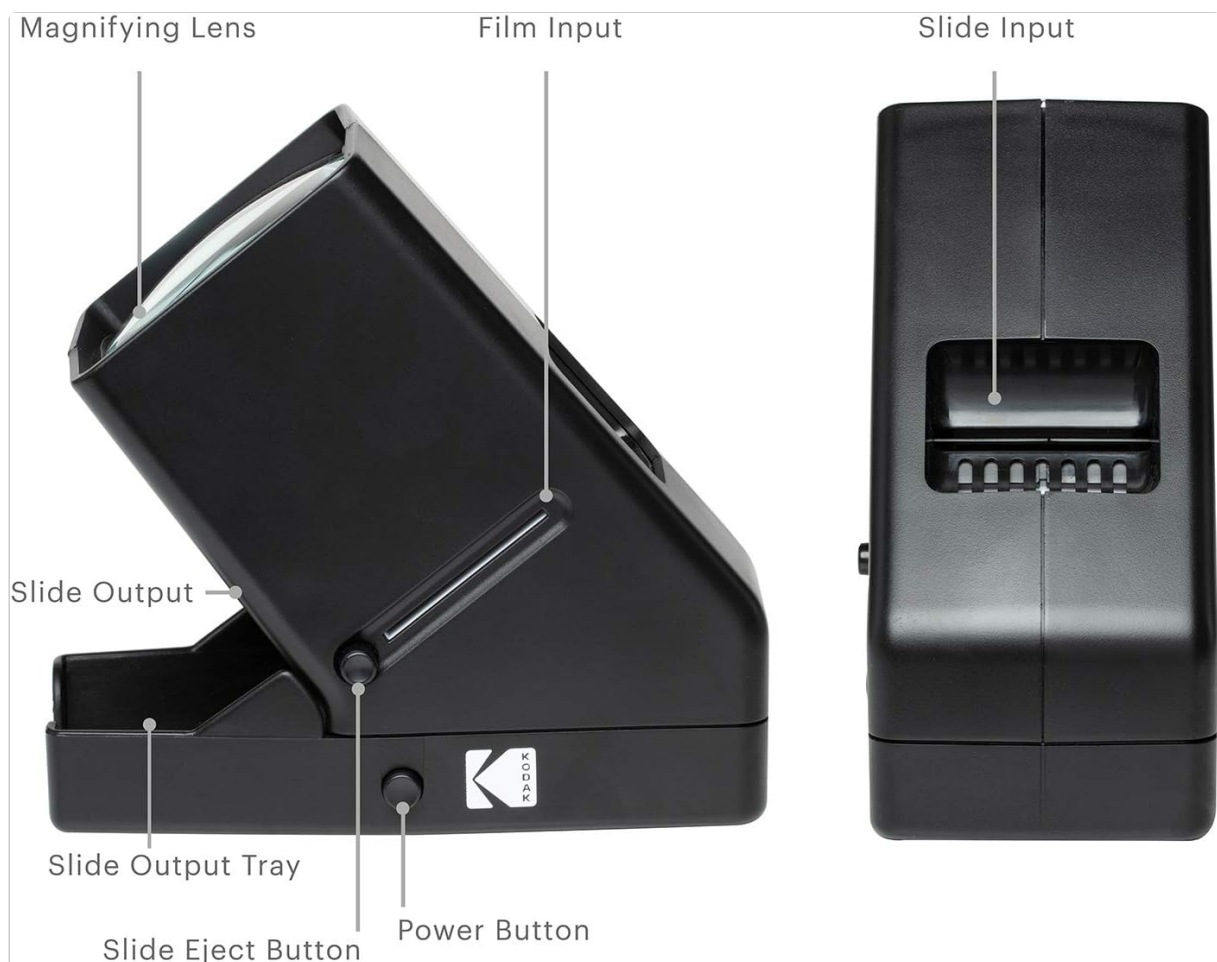

Image: A labeled diagram of the KODAK 35mm Slide and Film Viewer, indicating the Magnifying Lens, Film Input, Slide Input, Slide Output, Slide Output Tray, Slide Eject Button, and Power Button.

3.2 Powering On/Off

Press the Power Button located on the side of the viewer to turn the LED light on or off.

3.3 Inserting Slides

1. Ensure the viewer is powered on.
2. Locate the Slide Input slot at the top of the device.
3. Gently insert a 35mm slide into the Slide Input slot. The image will be projected onto the viewing screen.

Easy to Use

Insert Slide to View the Picture



Image: A hand demonstrating the insertion of a 35mm slide into the designated slot at the top of the KODAK 35mm Slide and Film Viewer.

3.4 Inserting Film Negatives

1. Ensure the viewer is powered on.
2. Locate the Film Input slot on the side of the device.
3. Carefully slide a strip of film negatives into the Film Input slot. Adjust the film strip to view different frames.

3.5 Viewing

Look into the magnifying lens to view the illuminated and magnified image of your slide or film negative. The backlit screen is positioned at an upward angle for comfortable viewing.

3x Magnification

Backlit Screen Allows You to
View Slides and Negatives



Image: The KODAK 35mm Slide and Film Viewer displaying magnified images of both a 35mm slide and a film negative on its illuminated screen.

3.6 Ejecting Media

To remove a slide, press the Slide Eject Button located on the side of the viewer. The slide will drop into the Slide Output Tray at the bottom.

Video: Official KODAK video demonstrating the features and ease of use of the 35mm Slide and Film Viewer, including inserting and ejecting slides.

Video: Official KODAK video highlighting the battery-powered operation of the 35mm Slide and Film Viewer and its simple slide viewing process.

4. MAINTENANCE

- **Cleaning the Lens:** Use a soft, dry cloth to gently clean the magnifying lens. Avoid abrasive materials or harsh chemicals.

- **Battery Storage:** If storing the device for an extended period, remove the batteries to prevent leakage and potential damage.
- **General Cleaning:** Wipe the exterior of the viewer with a soft, damp cloth. Do not immerse the device in water.

5. TROUBLESHOOTING

- **No Light:** Check if the batteries are correctly installed and not depleted. If using an AC adapter, ensure it is properly connected and functioning.
- **Blurred Image:** Ensure the slide or film negative is inserted correctly and is flat against the light source. The device has a fixed 3X magnification; no focus adjustment is available.
- **Slide Stuck:** Gently press the eject button multiple times. If a slide is still stuck, carefully remove it manually to avoid damage.

6. SPECIFICATIONS

Product Dimensions	6.5 x 3 x 6 inches (16.5 x 7.6 x 15.2 cm)
Item Weight	1 pound (0.45 kg)
Model Number	RODESV25
Magnification	3X
Light Source	LED (Natural White 6000K)
Power Source	4 AA Batteries (not included) or DC 6V 500mA Adapter (sold separately)
Compatible Media	35mm Slides, Film Negatives



Image: The KODAK 35mm Slide and Film Viewer with its physical dimensions clearly marked for reference.

7. WARRANTY AND SUPPORT

For warranty information and customer support, please refer to the documentation included with your product or visit the official KODAK website. Keep your purchase receipt as proof of purchase for any warranty claims.