

FENIFOX DF23SLUSKeyboard2DJ

FENIFOX Wireless Keyboard and Mouse Combo User Manual

Model: DF23SLUSKeyboard2DJ

1. INTRODUCTION

This manual provides detailed instructions for the setup, operation, maintenance, and troubleshooting of your FENIFOX Wireless Keyboard and Mouse Combo. Designed for ergonomic comfort and silent operation, this combo offers a stable 2.4G wireless connection for various devices.



Figure 1: FENIFOX Wireless Keyboard and Mouse Combo

2. SETUP

2.1. Battery Installation

The keyboard requires two (2) AA batteries, and the mouse requires two (2) AAA batteries. Batteries are not included and must be prepared in advance.

1. **For Keyboard:** Locate the battery slot on the underside of the keyboard. Gently open the cover and insert two AA batteries, ensuring correct polarity (+/-). Close the cover securely.
2. **For Mouse:** Locate the battery slot on the underside of the mouse. Open the lid and insert two AAA batteries, ensuring correct polarity (+/-). Close the lid smoothly.

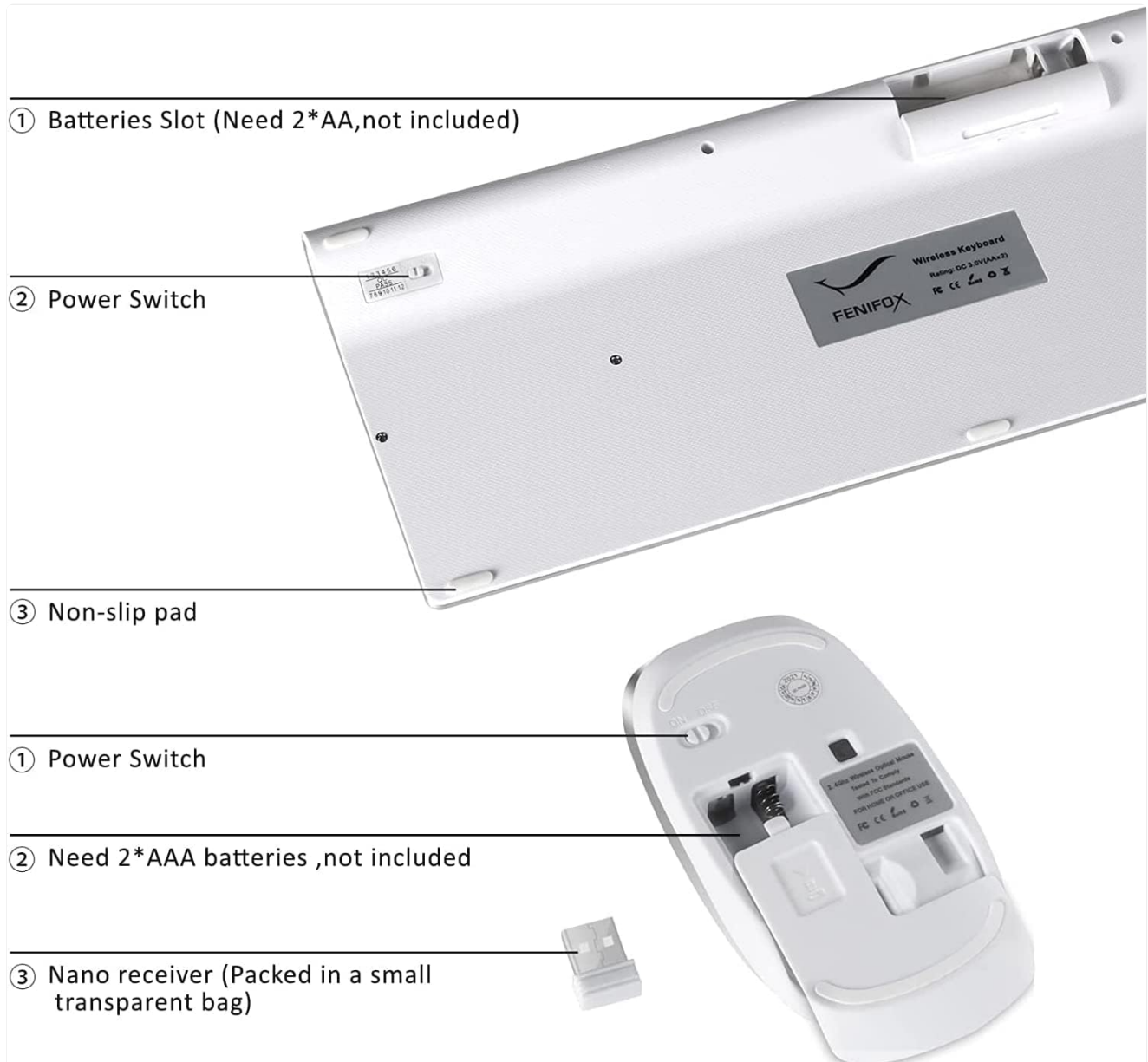

Figure 2: Battery Installation and Power Switches

2.2. Connecting the USB Receiver (Plug and Play)

The keyboard and mouse share a single USB receiver for convenient setup.

1. Locate the nano USB receiver, typically packed in a small transparent bag.
2. Plug the USB receiver directly into an available USB port on your computer (PC, Laptop, Tablet, or Television).
3. Wait for the system to automatically recognize and install the necessary drivers. No manual driver installation is required.
4. Ensure the power switches on both the keyboard and mouse are in the "ON" position.

3. OPERATING INSTRUCTIONS

3.1. Ergonomics and Comfort

The FENIFOX combo is designed for extended use comfort. The keyboard features a tilt angle and the mouse has a contoured curve to reduce fatigue. The keyboard utilizes scissor-foot "X" keys for a short click distance, and the mouse's left and right buttons are designed for light-gram force with a 5 million click lifespan, making long-term use easier on your hands.

ERGONOMIC DESIGN

lope Angle Design For Comfortable Use Feeling.
Your Hand Will Not Feel Tired After Using A While Time.

Lope Angle



Figure 3: Ergonomic Design for Comfortable Use

3.2. Silent and Power Saving Features

Enjoy a quiet working environment with the silent keyboard keys and mouse buttons. The combo incorporates a low-power intelligent power-saving chip. If inactive for 30 seconds, the keyboard's indicator light will turn off to conserve power. Simply click any key to wake it up. This feature is ideal for various settings including home, cafes, meetings, offices, libraries, and schools.

WHISPER-QUIET KEYS AND BUTTONS

Scissor-key-switch Provides Smooth Typing And Sensitive Response, Lowest Volume Keyboard Keys And Quiet Mouse Buttons.

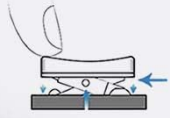

Figure 4: Whisper-Quiet Operation

3.3. Stable Wireless Transmission and Compatibility

Utilizing the latest 2.4G wireless technology, the combo provides a stable connection up to 10 meters (33 feet) in low-interference environments. This allows for flexible use, whether typing from a sofa or presenting from a distance, freeing you from messy cables. It is compatible with a wide range of devices and operating systems, including Windows, XP, Mac, MacBook Vista, Linux, and HTPS.



Figure 5: Wide and Stable Compatibility

3.4. Compact Design

The 102-key compact layout includes a number pad, saving 15% space and allowing for a shorter, more convenient use distance. Its light and thin design makes it highly portable, ideal for business travel.

FULL-SIZE AND SLIM SIZE

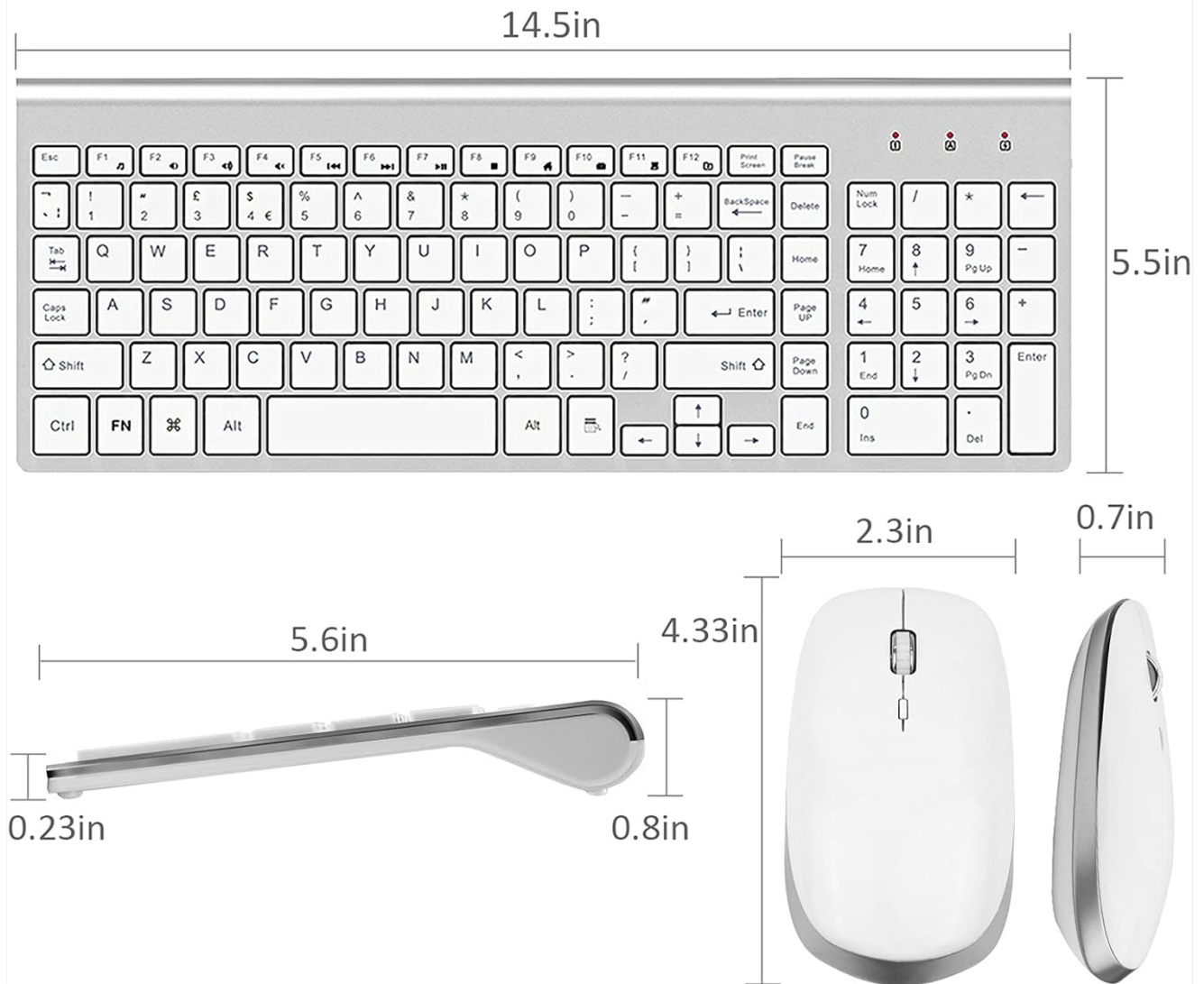

Figure 6: Full-Size and Slim Design with Dimensions

4. MAINTENANCE

4.1. Cleaning

To maintain optimal performance and appearance, regularly clean your keyboard and mouse. Use a soft, dry cloth to wipe surfaces. For deeper cleaning, a slightly damp cloth with mild soap can be used, ensuring no liquid enters the internal components. Avoid abrasive cleaners or solvents.

4.2. Battery Replacement

Replace batteries when performance degrades or devices become unresponsive. Refer to Section 2.1 for detailed battery installation instructions.

5. TROUBLESHOOTING

5.1. Keyboard/Mouse No Response

If your keyboard or mouse becomes unresponsive, follow these steps to re-pair them with the USB receiver:

- **Repair the keyboard:**

- a. Turn the keyboard ON.
- b. Press "ESC" and "+/=" keys simultaneously. The low voltage indicator will light up, indicating the keyboard has entered repair mode.
- c. Insert the USB receiver into your computer within 20 seconds. If successful, the LED will turn off immediately, and the keyboard will be available. If unsuccessful, the keyboard exits repair mode after 20 seconds, and the LED goes out. If you plug the USB after 20 seconds, you will need to restart from step 1. Ensure the keyboard enters pairing mode in step 2.

- **Repair the mouse:**

- a. Turn off the mouse power and remove the USB receiver from the computer.
- b. Turn the mouse ON. Press the left button, scroll wheel, and right button simultaneously and hold for 1 second. The mouse will enter a 20-second pairing mode.
- c. Plug the USB receiver into your computer within 20 seconds. The mouse should pair successfully if it begins to work. If you plug the USB after 20 seconds, you will need to restart from step 1.

5.2. Connection Interference

Interference can affect wireless performance. Factors such as hubs, Wi-Fi networks, metal surfaces, and USB 3.0/3.1 ports can cause signal disruption. Try moving the receiver to a different USB port or relocating the devices to minimize interference.

6. SPECIFICATIONS

Feature	Detail
Brand	FENIFOX
Model Number	DF23SLUSKeyboard2DJ
Product Dimensions	14.3 x 5.6 x 0.3 inches
Item Weight	1.1 pounds
Batteries Required	2 AA (Keyboard), 2 AAA (Mouse) - Not Included
Color	Silver White
Connectivity Technology	2.4G Radio Frequency, USB
Compatible Devices	Laptop, Personal Computer, Tablet, Television
Special Features	Compact full-size 102-key keyboard, Ergonomic, Light and thin, ultra-short key distance, Quiet, low-profile, low noise, Wireless 2.4G USB receiver, plug and play.

7. WARRANTY AND SUPPORT

For any product issues or concerns, even if the Amazon return period has passed, please contact the seller directly through your order details by selecting "Contact Seller." FENIFOX is committed to providing efficient and professional support to resolve your problems.

