



[Manuals.plus](#) /

› [MOMMED](#) /

› MomMed HCG Pregnancy Test Strips User Manual

## MOMMED Pregnancy Test Strips

# MomMed HCG Pregnancy Test Strips User Manual

Model: Pregnancy Test Strips

### INTRODUCTION

This manual provides detailed instructions for using the MomMed HCG Pregnancy Test Strips. These strips are designed for early detection of pregnancy by measuring the Human Chorionic Gonadotropin (HCG) hormone in urine. For accurate results, please read and follow all instructions carefully.

### SAFETY INFORMATION

- For in-vitro diagnostic use only. Do not ingest.
- Keep out of reach of children.
- Do not use the test after the expiration date printed on the foil pouch.
- Store in a dry place at room temperature (4-30°C or 39-86°F). Do not freeze.
- Do not use if the foil pouch is damaged or opened.
- Use each test strip only once. Discard after use.
- Statements regarding dietary supplements have not been evaluated by the FDA and are not intended to diagnose, treat, cure, or prevent any disease or health condition.

### PACKAGE CONTENTS

Each MomMed Pregnancy Test kit typically includes:

- Individually sealed HCG Pregnancy Test Strips
- Urine collection cups (quantity may vary, e.g., 20 cups for a 20-count pack)
- Instruction leaflet (this manual)



Image: A MomMed pregnancy test kit showing the box, individually wrapped test strips, and a urine collection cup.

## SETUP AND PREPARATION

1. Read the entire instruction manual before beginning the test.
2. Ensure the test strip is at room temperature before use.
3. Collect a urine sample in a clean, dry container (e.g., the provided urine cup). The first morning urine is recommended as it typically contains the highest concentration of HCG.



Image: A hand holding a urine collection cup, illustrating the first step of sample collection.

## OPERATING INSTRUCTIONS

Follow these steps for accurate testing:

1. Open the sealed foil pouch and remove the test strip. Do not touch the reaction areas.
2. Hold the test strip by the end with the blue handle.
3. Dip the absorbent tip (the end without the handle) into the urine sample for at least 5 seconds. Ensure the urine level does not exceed the MAX line indicated on the strip.
4. Remove the strip from the urine and lay it flat on a clean, dry, non-absorbent surface.
5. Wait for the colored lines to appear. Read the result within 3 to 5 minutes. Do not interpret results after 5 minutes, as this may lead to inaccurate readings (e.g., evaporation lines).

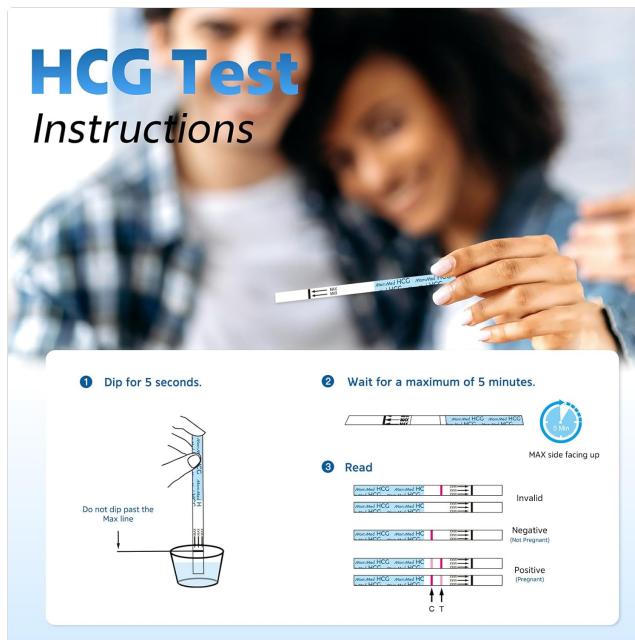

Image: A visual guide showing the steps: dipping the test strip into urine, waiting for 5 minutes, and then reading the results.

## INTERPRETING RESULTS

Observe the test strip within the 3-5 minute timeframe:

**Positive Result (Pregnant):** Two colored lines appear. One line in the control region (C) and another line in the test region (T). The intensity of the test line may vary depending on the concentration of HCG in the urine. Even a faint test line indicates a positive result.

**Negative Result (Not Pregnant):** Only one colored line appears in the control region (C). No line appears in the test region (T).

**Invalid Result:** No colored line appears in the control region (C), or only a line appears in the test region (T) without a control line. This indicates an error in the testing procedure or that the test strip is faulty. Discard the test and repeat with a new one.

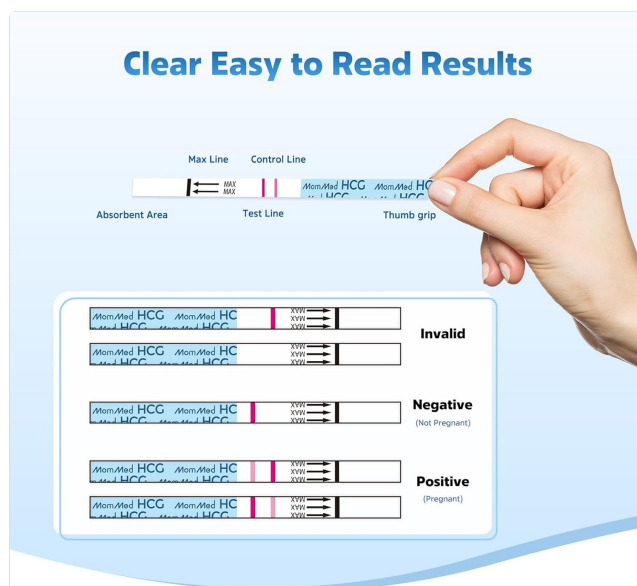

Image: Diagram illustrating how to interpret test results: positive (two lines), negative (one control line), and invalid (no control line).

## UNDERSTANDING HCG LEVELS AND TIMING

The MomMed HCG Pregnancy Test Strips have a sensitivity of 25 mIU/ml, allowing for early detection. HCG levels typically rise rapidly in early pregnancy. For the most accurate early detection, it is recommended to test using first

morning urine.

The concentration of HCG can start to appear in urine around 8 days before a missed period. The concentration increases significantly as pregnancy progresses.

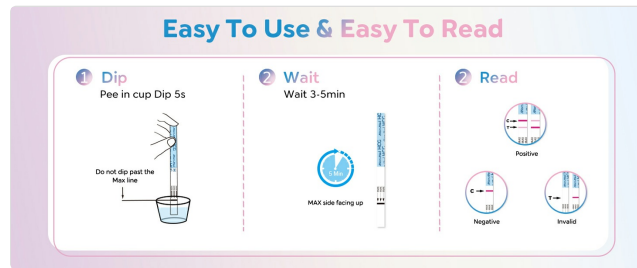

Image: A graph showing the average concentration of HCG in urine during early pregnancy, indicating how levels rise from ovulation to a missed period.

## TROUBLESHOOTING

- **No lines appear or only a test line appears:** The test is invalid. This could be due to insufficient urine, incorrect dipping technique (e.g., dipping past the MAX line), or a faulty test. Repeat the test with a new strip, ensuring all instructions are followed.
- **Faint test line:** A faint test line, even if very light, indicates a positive result. HCG levels may be low in very early pregnancy. If unsure, retest in a few days or consult a healthcare professional.
- **Evaporation lines:** Do not read results after the recommended 5-minute window. Evaporation lines can appear as faint, colorless lines and may be mistaken for a positive result.

## SPECIFICATIONS

Feature	Detail
Product Name	MomMed HCG Pregnancy Test Strips
Model Name	Pregnancy Test Strips
HCG Sensitivity	25 mIU/ml
Accuracy	Over 99%
Result Read Time	3-5 minutes
Storage Temperature	4-30°C (39-86°F)
Manufacturer	MOMMED

## SUPPORT AND CONTACT INFORMATION

For any questions, concerns, or assistance with your MomMed Pregnancy Test Strips, please contact our customer support team. Refer to the product packaging or the official MomMed website for the most current contact details.

**Online Resources:** [Visit the MOMMED Store on Amazon](#)

