

UHPPOTE HBK-R01

UHPPOTE HBK-R01 433.92MHz 12VDC Remote Control System for Access Control Locks

Instruction Manual

1. INTRODUCTION

This manual provides detailed instructions for the installation, operation, and maintenance of the UHPPOTE HBK-R01 433.92MHz 12VDC Remote Control System. This system is designed to provide wireless control for access control locks, allowing remote operation of door locking and unlocking mechanisms.

1.1 Key Features

- Wireless RF remote operation for access control locks.
- Supports programming of up to 40 remote controls.
- Operating range of up to 164 feet (50 meters) in open areas.
- Adjustable auto-lock time delay: 0, 5, or 10 seconds.
- Selectable working modes: Momentary or Toggle.
- Operating Frequency: 433.92MHz.
- Encoding Type: Learning code.
- Integrated buzzer with On/Off switch.

1.2 Package Contents

Verify that all components are present before proceeding with installation.

- 1 x UHPPOTE HBK-R01 Receiver
- 2 x Wireless Remote Controls
- 1 x DC 12V Power Adapter
- 1 x DC Power Connector Cable



Image 1.1: Overview of the UHPPOTE HBK-R01 remote control system, including the receiver, two remote controls, a power adapter, and a DC power connector cable.

2. SETUP AND INSTALLATION

Careful installation is essential for proper system function. Ensure power is disconnected before making any wiring connections.

2.1 Receiver Overview



Image 2.1: Front view of the HBK-R01 receiver, showing the lock type indicators (NO/NC) and RF signal indicator.



Image 2.2: Side view of the HBK-R01 receiver, highlighting the access keypad connection terminals.

2.2 Wiring Diagram

The following diagram illustrates typical wiring connections for the HBK-R01 receiver with an access keypad, exit button, and a fail-safe lock. Ensure correct polarity and connection types (Normally Open/Normally Closed) for your specific lock and access control components.

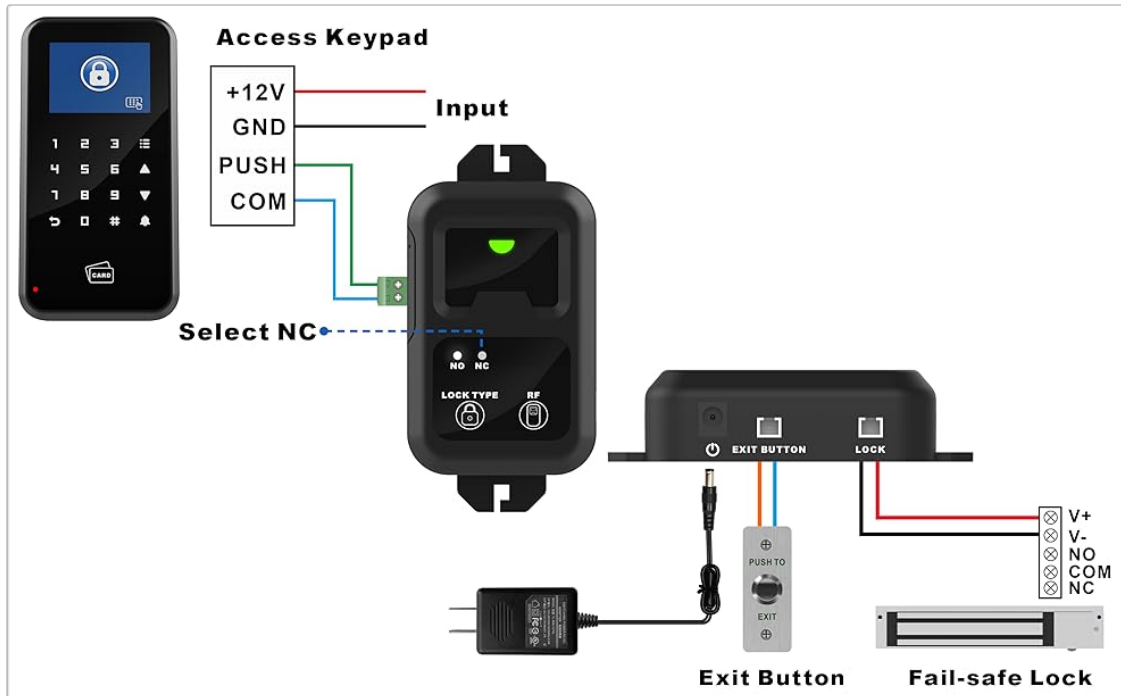

Image 2.3: Detailed wiring diagram showing connections for power, access keypad, exit button, and a fail-safe lock to the HBK-R01 receiver.

2.2.1 Power Connection

- Connect the provided DC 12V power adapter to the receiver's DC power input port.
- Ensure the power adapter is connected to a suitable power source.



Image 2.4: The included DC 12V power adapter.

2.2.2 Lock Connection

The receiver provides Normally Open (NO) and Normally Closed (NC) contacts for connecting to your access control lock. Refer to your lock's specifications to determine the correct connection type.

- **NO (Normally Open):** The circuit is open (no current flows) when the relay is de-energized. It closes when the relay is energized. Use for locks that require power to unlock (fail-secure).
- **NC (Normally Closed):** The circuit is closed (current flows) when the relay is de-energized. It opens when the relay is energized. Use for locks that require power to lock (fail-safe).

2.2.3 Exit Button / Access Keypad Connection

Connect an optional exit button or access keypad to the designated terminals on the receiver as shown in the wiring diagram (Image 2.3).

3. OPERATING INSTRUCTIONS

This section details how to program remote controls and adjust the receiver's settings.

3.1 Programming Remote Controls

The HBK-R01 receiver uses a learning code system to pair with remote controls. Up to 40 remotes can be programmed.



Image 3.1: Back view of the HBK-R01 receiver, showing the 'MODE', 'TIME', and 'BUZZER' switches, and the learning button (often labeled 'RF' or similar, or a small button near the RF indicator).

1. Ensure the receiver is powered on.
2. Locate the learning button on the receiver (refer to Image 3.1, typically a small button near the 'RF' indicator or labeled 'Learn').
3. Press and hold the learning button for approximately 3 seconds until the RF indicator light on the receiver illuminates or flashes, indicating it is in learning mode.
4. While the receiver is in learning mode, press any button on the remote control you wish to program.
5. The RF indicator light on the receiver should flash or turn off, confirming successful programming.
6. To program additional remotes, repeat steps 3-5 for each remote.
7. To clear all programmed remotes, press and hold the learning button for approximately 8 seconds until the RF indicator light flashes rapidly and then turns off. This will erase all stored remote codes.

EASY SETTING

FUNCTION KEYS DESIGNED OUTSIDE



Image 3.2: A hand pressing the button on a UHPPOTE remote control, indicating activation.

3.2 Adjusting Settings (Mode, Time, Buzzer)

The HBK-R01 receiver features external switches for easy adjustment of operating mode, auto-lock time delay, and buzzer function. These switches are located on the back of the receiver (refer to Image 3.1).

3.2.1 Working Mode Selection

The 'MODE' switch allows selection between Momentary and Toggle modes:

- **Momentary Mode (M):** The lock will activate (unlock or lock, depending on wiring) only while the remote button is pressed. Releasing the button returns the lock to its default state.
- **Toggle Mode (T):** Pressing the remote button once will activate the lock, and it will remain in that state until the button is pressed again to revert it.

3.2.2 Auto-Lock Time Delay

The 'TIME' switch adjusts the duration the lock remains activated after a remote signal is received (in Momentary mode) or after the initial press in Toggle mode before automatically reverting. Options are 0, 5, or 10 seconds.

- **0 Seconds:** Instantaneous activation/deactivation.

- **5 Seconds:** Lock remains active for 5 seconds. (Default setting)
- **10 Seconds:** Lock remains active for 10 seconds.

3.2.3 Buzzer Function

The 'BUZZER' switch allows you to enable or disable the audible buzzer sound from the receiver.

- **ON:** The receiver will emit an audible beep when a remote signal is received.
- **OFF:** The receiver will operate silently.

4. MAINTENANCE

Regular maintenance ensures optimal performance and longevity of your remote control system.

4.1 Remote Control Battery Replacement

The remote controls require 2 CR2 batteries. If the remote's indicator light does not illuminate or its range decreases significantly, it may be time to replace the batteries.

1. Carefully open the remote control casing.
2. Remove the old CR2 batteries.
3. Insert new CR2 batteries, ensuring correct polarity.
4. Close the remote control casing securely.



Image 4.1: Close-up view of a UHPOTE remote control, which uses CR2 batteries.

4.2 General Care

- Keep the receiver and remote controls dry and away from excessive moisture.
- Avoid exposing the devices to extreme temperatures.
- Clean the devices with a soft, dry cloth. Do not use harsh chemicals or abrasive cleaners.

5. TROUBLESHOOTING

If you encounter issues with your UHPPOTE HBK-R01 system, refer to the following common problems and solutions.

5.1 Remote Control Not Working

- **Check Batteries:** Ensure the remote control batteries are correctly installed and not depleted. Replace if necessary (refer to Section 4.1).
- **Range:** Verify that you are within the operating range of 164 feet (50 meters) and that there are no significant obstructions (e.g., thick walls, metal structures) between the remote and the receiver.
- **Re-program Remote:** The remote may have lost its pairing with the receiver. Follow the programming steps in Section 3.1 to re-pair the remote.
- **Interference:** Other 433MHz devices nearby may cause interference. Try operating the remote in a different location or temporarily disabling other 433MHz devices to test.

5.2 Lock Not Responding

- **Power Supply:** Ensure the receiver is properly powered and the DC 12V adapter is functioning.
- **Wiring:** Double-check all wiring connections between the receiver and the lock, as well as any exit buttons or keypads. Ensure correct NO/NC connections for your lock type.
- **Receiver Indicator:** Observe the RF indicator light on the receiver. If it does not illuminate when the remote is pressed, the remote may not be transmitting or is out of range.
- **Lock Functionality:** Test the lock independently to ensure it is functioning correctly without the remote system.

6. SPECIFICATIONS

Feature	Specification
Model Number	HBK-R01
Operating Voltage	12VDC
Operating Frequency	433.92MHz
Encoding Type	Learning Code
Max Remotes Supported	40
Remote Range	Up to 164 feet (50 meters)

Auto-Lock Time Delay	0, 5, 10 seconds (adjustable)
Working Modes	Momentary / Toggle (adjustable)
Compatible Devices	Access Control Locks
Receiver Dimensions	0.39 x 0.31 x 0.2 inches (approximate, based on product dimensions)
Receiver Weight	0.064 ounces (approximate, based on product weight)
Remote Battery Type	2 x CR2 batteries

7. WARRANTY AND SUPPORT



For warranty information and technical support, please contact UHPOTE directly or refer to the seller's policies where the product was purchased.

You can visit the official UHPOTE store for more information: [UHPOTE Store on Amazon](#)

© 2023 UHPOTE. All rights reserved.

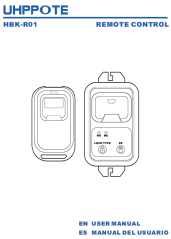
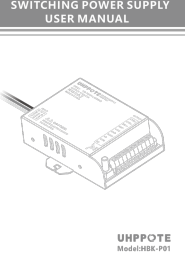
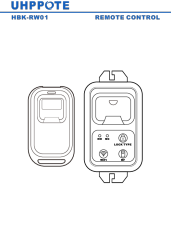
Related Documents - HBK-R01

 <p>UHPOTE HBK-R01 REMOTE CONTROL</p> <p>EN USER MANUAL ES MANUAL DEL USUARIO</p>	<p>UHPOTE HBK-R01 Remote Control User Manual</p> <p>This manual provides instructions and specifications for the UHPOTE HBK-R01 Remote Control system, including features, wiring diagrams, operating settings, and troubleshooting.</p>
 <p>SWITCHING POWER SUPPLY USER MANUAL</p> <p>UHPOTE Model:HBK-P01</p>	<p>UHPOTE HBK-P01 Switching Power Supply User Manual</p> <p>User manual for the UHPOTE HBK-P01 switching power supply, detailing its features, specifications, and wiring diagrams for access control systems. Provides 12VDC output for electric locks and access controllers.</p>
 <p>UHPOTE HBK-RW01 REMOTE CONTROL</p> <p>EN USER MANUAL</p>	<p>UHPOTE HBK-RW01 Remote Control User Manual</p> <p>User manual for the UHPOTE HBK-RW01 Remote Control, detailing features, specifications, wiring diagrams, operating settings, and WiFi pairing instructions using the Tuya Smart app.</p>

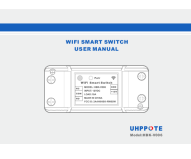
 <p>UHPOTE HBK-A02 ACCESS CONTROL KEYPAD</p> <p>EN USER MANUAL ES MANUAL DEL USUARIO</p>	<p>UHPOTE HBK-A02 Access Control Keypad User Manual</p> <p>Comprehensive user manual for the UHPOTE HBK-A02 Access Control Keypad, detailing installation, specifications, operation, wiring, and troubleshooting. Supports RFID cards and PIN access.</p>
 <p>UHPOTE HBK-A04T 2.4-inch TFT RFID Access Control Terminal</p> <p>USER MANUAL</p>	<p>UHPOTE HBK-A04T 2.4-inch TFT RFID Access Control Terminal User Manual</p> <p>User manual for the UHPOTE HBK-A04T 2.4-inch TFT RFID Access Control Terminal, detailing installation, setup, user management, door settings, device configuration, and Tuya Smart APP integration.</p>
 <p>WiFi SMART SWITCH USER MANUAL</p> <p>UHPOTE</p>	<p>UHPOTE HBK-V006 WiFi Smart Switch User Manual</p> <p>User manual for the UHPOTE HBK-V006 WiFi Smart Switch, detailing features, specifications, wiring diagrams, and setup instructions using the eWeLink app.</p>

Documents - UHPOTE – HBK-R01

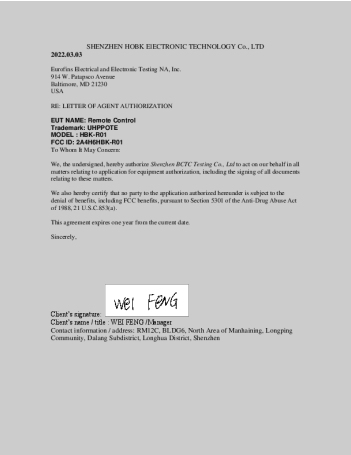

[pdf] Agent Authorization

Date bctcm005 Agent Authorization SHENZHEN HOBK ELECTRONIC TECHNOLOGY CO LTD HBK R01 Remote Control 2A4H6HBK 2A4H6HBKR01 hbk r01

SHENZHEN HOBK ELECTRONIC TECHNOLOGY Co., LTD 2022.03.03 Eurofins Electrical and Electronic Testing NA, Inc. 914 W. Patapsco Avenue Baltimore, MD 21230 USA RE: LETTER OF AGENT AUTHORIZATION EUT NAME: Remote Control Trademark: UHPOTE MODEL : **HBK-R01** FCC ID: 2A4H6**HBK-R01** To Whom It May Concern: We, th...

lang:en score:36 filesize: 68.59 K page_count: 1 document date: 2022-03-03

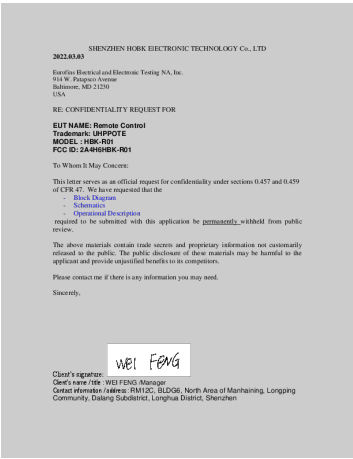

[pdf] Confidentiality Request Letter

Please produce a letter on your company letterhead with the following information bctcemc005

Confidentiality Letter SHENZHEN HOBK ELECTRONIC TECHNOLOGY CO LTD HBK R01 Remote Control 2A4H6HBK 2A4H6HBKR01 hbk r01

SHENZHEN HOBK ELECTRONIC TECHNOLOGY Co., LTD 2022.03.03 Eurofins Electrical and Electronic Testing NA, Inc. 914 W. Patapsco Avenue Baltimore, MD 21230 USA RE: CONFIDENTIALITY REQUEST FOR EUT NAME: Remote Control Trademark: UHPPOTE MODEL : **HBK-R01** FCC ID: 2A4H6**HBK-R01** To Whom It May Concern: This let...

lang:en score:35 filesize: 90.34 K page_count: 1 document date: 2022-03-03

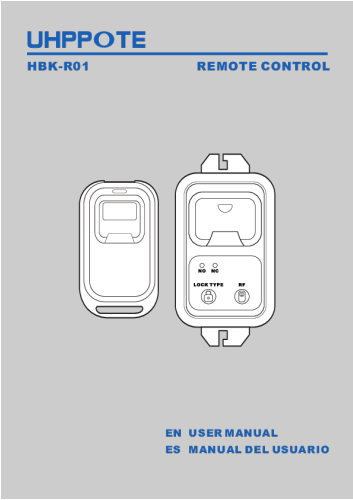

UHPPOTE HBK-R01 Remote Control User Manual

This manual provides instructions and specifications for the UHPPOTE HBK-R01 Remote Control system, including features, wiring diagrams, operating settings, and troubleshooting.

lang:en score:27 filesize: 404.78 K page_count: 20 document date: 2023-12-26