

## ROMECH RM-005

# ROMECH RM-005 200W Pro Electric Hot Knife Foam Cutter Instruction Manual

## 1. INTRODUCTION

---

Thank you for choosing the ROMECH RM-005 200W Pro Electric Hot Knife Foam Cutter. This tool is designed for precise and efficient cutting of various foam and plastic materials, providing clean edges without debris. Please read this manual thoroughly before operation to ensure safe and effective use.

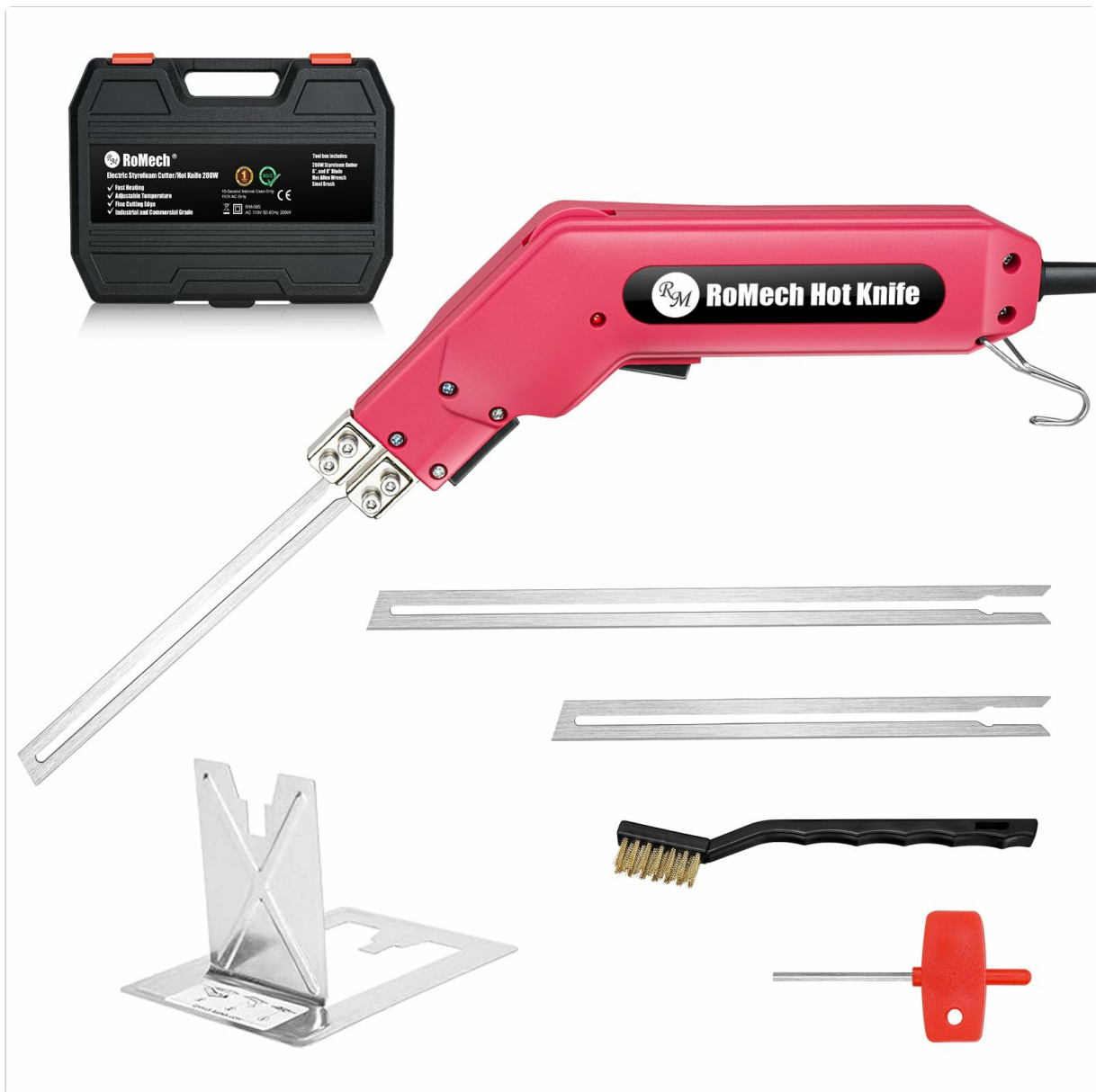

Figure 1: ROMECH RM-005 200W Pro Electric Hot Knife Foam Cutter with accessories.

## 2. SAFETY INFORMATION

**WARNING: Failure to follow these safety instructions may result in electric shock, fire, and/or serious injury.**

- Always operate the hot knife in a well-ventilated area to avoid inhaling fumes produced during cutting.
- The blade becomes extremely hot during operation. Avoid direct contact with skin or flammable materials.
- Wear appropriate personal protective equipment, including heat-resistant gloves and eye protection.
- Ensure the power cord is not damaged and is kept away from the hot blade.
- Do not leave the hot knife unattended while powered on.
- Unplug the tool when not in use or before changing blades.
- Keep out of reach of children.
- Verify the voltage compatibility for your region (110V AC for this model).

## 3. WHAT'S IN THE BOX

Your ROMECH RM-005 kit includes the following components:

- ROMECH 200W Hot Knife Unit
- 6-inch Flat Blade
- 8-inch Flat Blade
- Heavy-Duty Carrying Case
- Hex Wrench (for blade installation)
- Cleaning Brush



Figure 2: All components included in the ROMECH RM-005 kit.

## 4. SETUP

### 4.1 Blade Installation

1. **Loosen Screws:** Using the provided hex wrench, loosen the four screws on the copper blade holders by turning them counter-clockwise. Ensure they are loose enough to allow the blade to slide in.

## INSTALLATION GUIDE



Figure 3: Loosening screws and inserting the blade.

- 2. Insert Blade:** Carefully insert your chosen blade (6-inch or 8-inch) into the grooves of the copper blade holders. Ensure the blade is fully seated and centered.
- 3. Tighten Screws:** Tighten the four screws by turning them clockwise with the hex wrench. Ensure the blade is securely fastened and makes firm contact with the holders for proper heating.

## INSTALLATION GUIDE

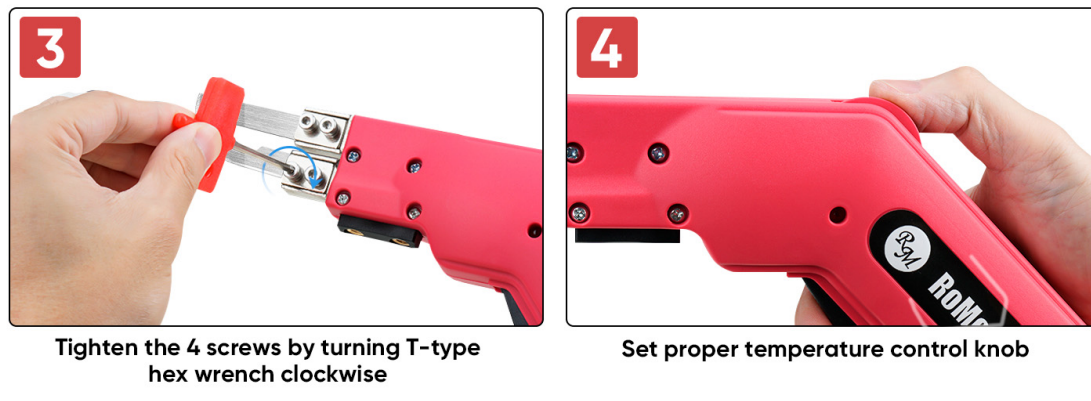

Figure 4: Tightening screws and setting temperature.

## 5. OPERATING INSTRUCTIONS

### 5.1 Temperature Adjustment

The ROMECH RM-005 features a 15-stage temperature adjustment knob located on the handle. This allows you to control the heat intensity for different materials and cutting requirements.

- Rotate the dial towards the '+' symbol for higher temperatures, suitable for denser materials.
- Rotate the dial towards the '-' symbol for lower temperatures, ideal for thinner or more delicate materials.
- Always start with a lower setting and gradually increase the temperature until the desired cutting performance is achieved.



Figure 5: Close-up of the 15-stage temperature adjustment knob.

## 5.2 Cutting Procedure

1. **Power On:** Plug the hot knife into a compatible 110V AC power outlet. The indicator light will illuminate.
2. **Preheat:** Allow the blade to preheat for approximately 10-15 seconds. The blade will reach cutting temperature quickly.
3. **Cut Material:** Gently press the blade into the foam or plastic material. Apply steady, even pressure. The hot blade will melt through the material, creating a clean, sealed edge.



Figure 6: Demonstrating the hot knife cutting through foam.

4. **Continuous Use:** The ROMECH RM-005 is designed for continuous operation. For optimal performance and to prevent overheating, avoid prolonged cutting without brief pauses.
5. **Material Compatibility:** This tool is suitable for cutting lightweight foam, KT board, pink foam, polyurethane, polyethylene, expanded polystyrene (EPS), extruded polystyrene (XPS), styrofoam, polyester foam, sponge, and rubber.



Figure 7: Examples of materials that can be cut with the ROMECH Hot Knife.

### 5.3 Instructional Videos

Video 1: An overview of the RoMech Hot Knife, demonstrating its smooth cutting capabilities on various foam types. This video highlights the clean, debris-free cuts achieved by the tool.

Video 2: A full test and review of the ROMECH 200 Watt Pro Foam Electric Hot Knife, including details on its fan-cooled design, case, blades, and accessories. This video provides an in-depth look at the product's features and performance.

## 6. MAINTENANCE

- **Cleaning the Blade:** After each use, allow the blade to cool completely. Use the included cleaning brush to remove any melted material residue from the blade. For stubborn residue, a small amount of rubbing alcohol can be used on a cloth (ensure the tool is unplugged and cold).

## INSTALLATION GUIDE

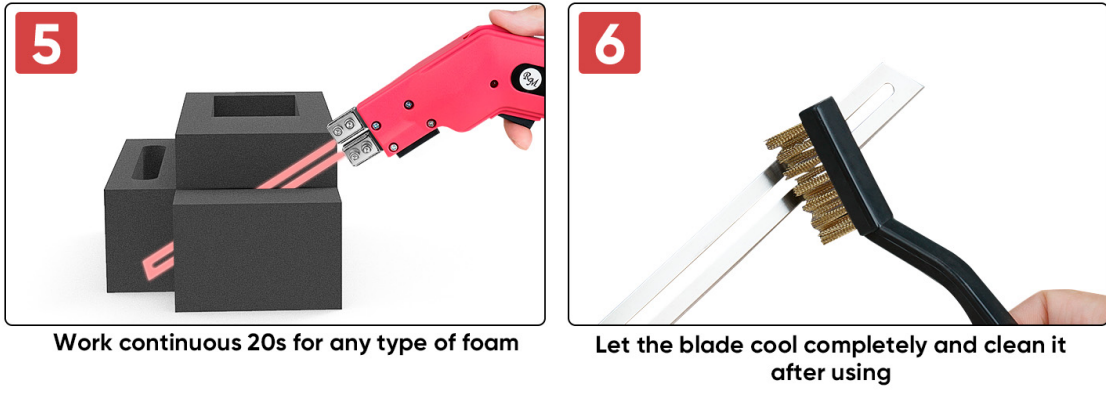

Figure 8: Cleaning the blade with the provided brush after use.

- **Storage:** Store the hot knife and its accessories in the heavy-duty carrying case in a dry, safe place when not in use.
- **Blade Replacement:** If a blade becomes dull or damaged, replace it with a new ROMECH compatible blade following the installation steps in Section 4.1.

## 7. TROUBLESHOOTING

- **Blade not heating:** Ensure the power cord is securely plugged in and the power switch is on. Check that the blade is correctly installed and the screws are tightened, ensuring good electrical contact.
- **Uneven cuts or excessive smoke:** Adjust the temperature setting. Too high a temperature can cause excessive melting and smoke, while too low may result in uneven cuts. Ensure a steady, consistent cutting speed.
- **Tool not powering on:** Check the power outlet and ensure the tool is receiving power. If the issue persists, contact customer support.
- **Voltage Compatibility:** This product is designed for 110V AC. Using it with incompatible voltage (e.g., 240V) can damage the unit and is not recommended. Always check your local power supply.

## 8. SPECIFICATIONS

Feature	Detail
Brand	ROMECH
Model Number	RM-005
Power	200W
Voltage	110V AC
Material	Copper, Plastic
Blade Lengths Included	6 inches, 8 inches
Handle Material	Plastic, Rubber
Item Weight	3 Pounds
UPC	726152990531

## 9. WARRANTY & SUPPORT

---

The ROMECH RM-005 200W Pro Electric Hot Knife Foam Cutter comes with a **1-year manufacturer's warranty**. This warranty covers defects in materials and workmanship under normal use.

For warranty claims, technical support, or any questions regarding your product, please contact ROMECH customer service through the retailer where the product was purchased. Please have your purchase receipt and product model number (RM-005) available when contacting support.