

## Manuals+

[Q & A](#) | [Deep Search](#) | [Upload](#)

[manuals.plus](#) /

› [DOUXURY](#) /

› [DOUXURY 9-inch LCD Reversing Camera System User Manual](#)

## DOUXURY The 2023 Latest Version

# DOUXURY 9-inch LCD Reversing Camera System User Manual

Model: The 2023 Latest Version

## PRODUCT OVERVIEW

---

The DOUXURY 9-inch LCD Reversing Camera System is designed to enhance vehicle safety and visibility, particularly for large vehicles. It features a quad-view monitor, allowing simultaneous display from multiple cameras, and includes an integrated DVR for recording. The system is built with IP69 waterproof cameras and offers 1080P HD night vision for clear imaging in various conditions.



Figure 1: The DOUXURY 9-inch LCD monitor and four included cameras, showcasing the quad-view capability. An SD card is also visible, indicating the DVR function.

### Key Features:

- **Quad-View Display:** The 9-inch monitor supports simultaneous display from up to four cameras (front, rear, and two side views), eliminating blind spots.
- **IP69 Waterproof Cameras:** Cameras are rated IP69 for water resistance, featuring infrared LED lights for night vision and wide viewing angles.
- **1080P AHD Resolution:** Provides clear, sharp images, suitable for 12-24V DC power systems in various large vehicles.
- **Integrated DVR Recording:** The system includes a DVR function that records video data to an included SD card, with local playback support.
- **Wide Vehicle Compatibility:** Designed for use with semi-trailers, trucks, 5th wheels, trailers, buses, and RVs.

### PACKAGE CONTENTS

Verify that all components are present and in good condition before proceeding with installation.

 <p>9 Inch LCD Monitor</p>	 <p>Rear view camera x 2</p>	<div>DOUXURY</div>  <p>Side View Camera x 2</p>
 <p>66ft AV Cable</p>	 <p>32g TF Card</p>	 <p>Remote Control</p>
 <p>33ft AV Cable x 2</p>	 <p>16ft AV Cable</p>	<div><p>User Manual</p><p>Power Cable</p></div>

Figure 2: Comprehensive view of all items included in the DOUXURY Backup Camera System package.

Table 1: Package Components

Item	Quantity	Description
9-inch LCD Monitor	1	Main display unit with DVR function.
Rear View Camera	2	Cameras for rear visibility.
Side View Camera	2	Cameras for side visibility.
66ft AV Cable	1	Long cable for camera connection.
33ft AV Cable	2	Medium cables for camera connection.
16ft AV Cable	1	Short cable for camera connection.

Item	Quantity	Description
32GB TF Card	1	Memory card for DVR recording.
Remote Control	1	For convenient system operation.
Power Cable	1	For connecting the system to power.
User Manual	1	Instruction guide for setup and operation.

## SETUP AND INSTALLATION

---

Proper installation is crucial for optimal performance. It is recommended to have this system installed by a qualified professional if you are not familiar with vehicle electrical systems.

### 1. Planning Camera Placement:

Determine the best locations for your cameras to achieve desired viewing angles. The system supports front, rear, and side camera placements.

# 9" 1080P BACKUP CAMERAS SYSTEM 360° SECURITY

DOUXURY

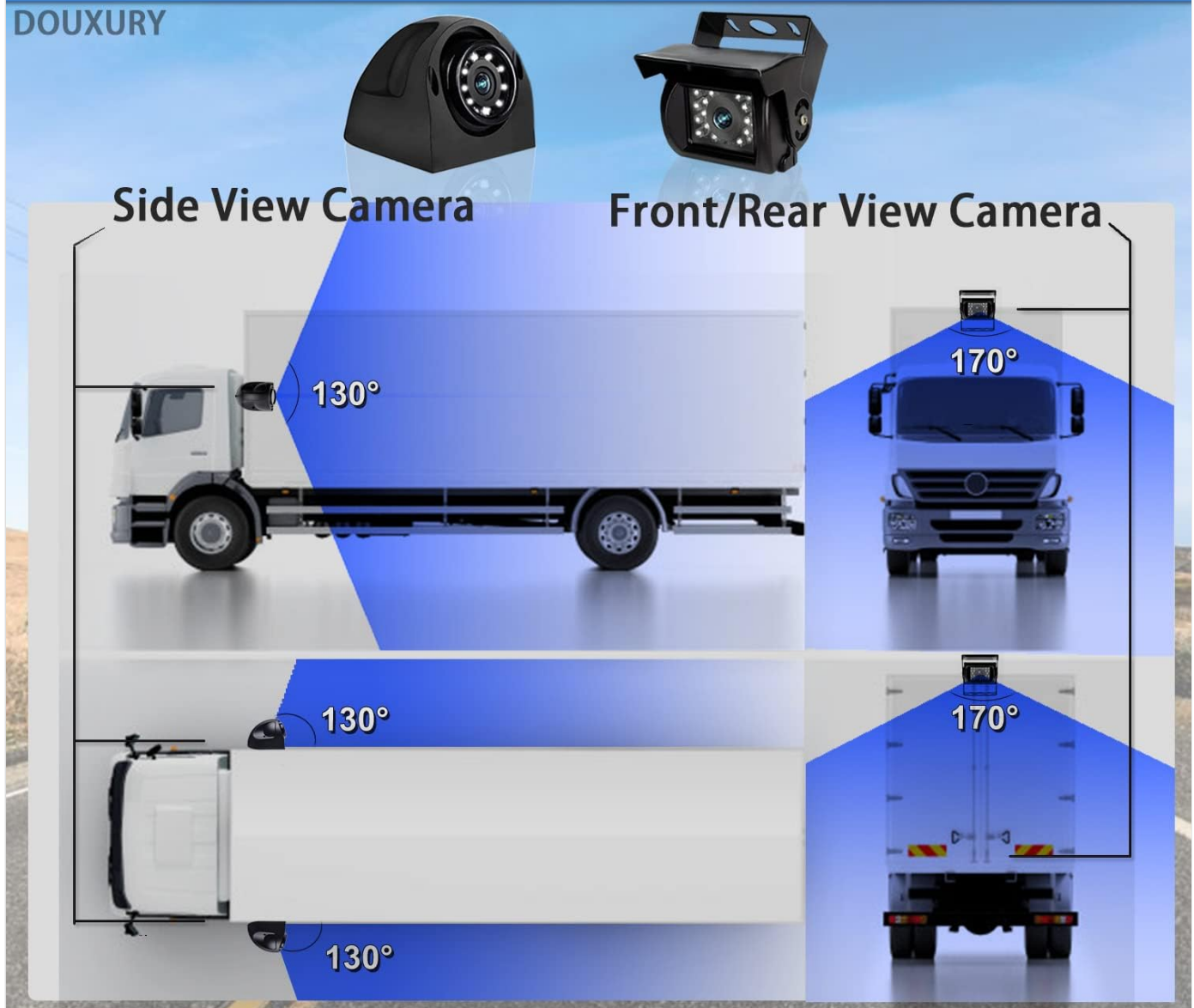

Figure 3: Camera placement and viewing angles for comprehensive 360-degree coverage.

## 2. Wiring Diagram:

Follow the wiring diagram carefully to connect the cameras to the monitor and the system to your vehicle's power supply. Ensure all connections are secure and waterproof.



# HOW TO INSTALL

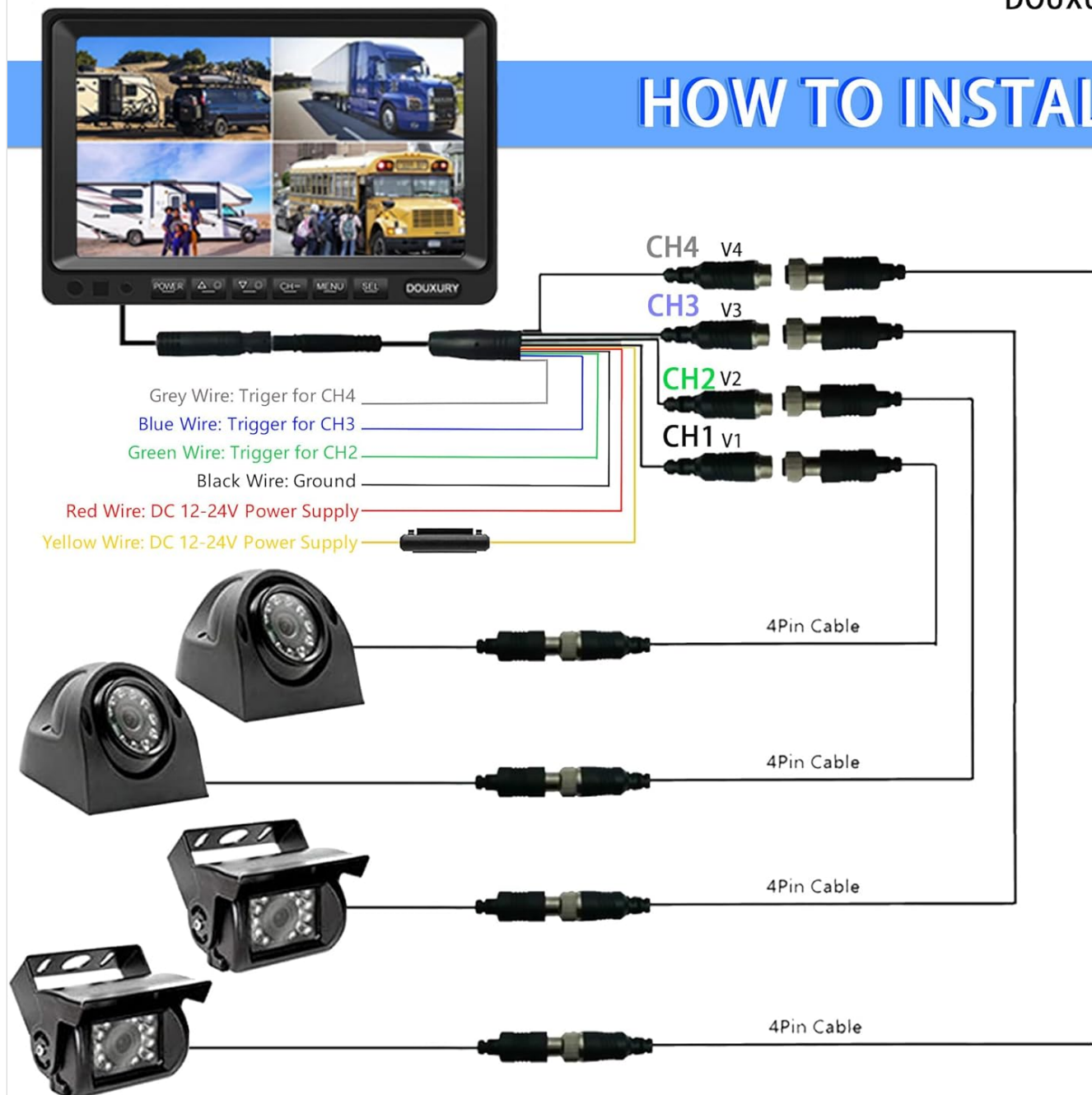

Figure 4: Wiring connections for the monitor and cameras, including power and trigger wires.

- **Power Connection:** Connect the Red and Yellow wires to a 12-24V DC power source. Connect the Black wire to ground.
- **Camera Connections:** Connect each camera to its corresponding channel (CH1-CH4) on the monitor using the provided 4-pin AV cables.
- **Trigger Wires:** The Green, Blue, and Grey wires are trigger inputs for CH2, CH3, and CH4 respectively. These can be connected to turn signals or reverse lights to automatically switch views.

### 3. Mounting the Monitor and Cameras:

The monitor can be mounted on the dashboard or any suitable surface. Cameras should be securely mounted in their chosen locations, ensuring a clear line of sight.



Figure 5: Dimensions of the monitor and cameras for mounting reference.

Ensure all external connections, especially for cameras, are properly sealed to maintain the IP69 waterproof rating. Use the waterproof protective covers provided for cable connections.

# IP69 WATERPROOF LEVEL IR LED NIGHT VISION



Figure 6: IP69 waterproof features and night vision capability.

## OPERATING INSTRUCTIONS

### 1. Powering On/Off:

Press the **POWER** button on the monitor or remote control to turn the system on or off.

### 2. Switching Camera Views:

Use the **CH-** or **CH+** buttons on the monitor or remote to cycle through individual camera views (CH1, CH2, CH3, CH4). The monitor also supports quad-view display.



# 1080P HD BACKUP CAMERA SYSTEM

Big screen, high pixel - Good visual experience



Figure 7: Monitor interface showing key features like split screen and recording.

### 3. DVR Recording Function:

The system automatically records video to the inserted 32GB TF card. Ensure the card is properly inserted before operation.

- **Loop Recording:** The system supports loop recording, overwriting the oldest footage when the SD card is full.
- **Local Playback:** Recorded videos can be played back directly on the monitor. Refer to the user manual for detailed navigation of recorded files.

# LOOP RECORDING + LOCAL PLAY

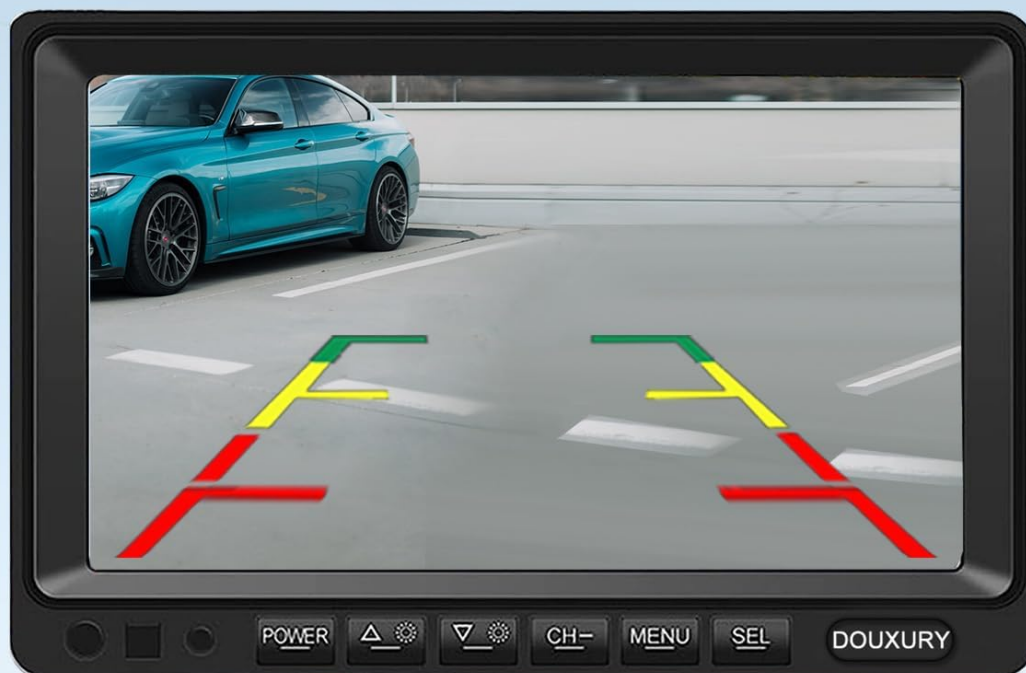

Figure 8: DVR recording and playback interface.

## 4. Parking Assist Lines:

The monitor can display adjustable parking assist lines to aid in reversing. This feature can typically be toggled on or off via the menu settings.



Figure 9: Parking assist lines feature, showing both off and on states.

## MAINTENANCE

- **Regular Cleaning:** Clean the monitor screen and camera lenses periodically with a soft, damp cloth. Avoid abrasive cleaners.
- **Cable Inspection:** Periodically check all cables and connections for wear, damage, or loose fittings. Ensure waterproof seals are intact.
- **Firmware Updates:** Check the manufacturer's website for any available firmware updates for improved performance or new features.
- **SD Card Management:** Format the SD card regularly (e.g., monthly) to maintain optimal recording performance and prevent data corruption. Back up important footage before formatting.

## TROUBLESHOOTING

Table 2: Common Issues and Solutions

Problem	Possible Cause	Solution
Monitor does not power on.	No power supply; loose power cable connection; blown fuse.	Check power connections; ensure vehicle ignition is on; inspect fuse in power cable.
No image on screen / "No Signal".	Loose camera cable connection; faulty camera; incorrect channel selected.	Verify all camera cables are securely connected; try switching channels; test camera on another channel if possible.
Image is blurry or distorted.	Dirty camera lens; moisture inside lens; cable interference.	Clean camera lens; check for condensation (allow to dry); ensure cables are not routed near strong electrical interference sources.
Night vision not working.	IR LEDs obstructed or faulty; insufficient ambient light.	Ensure IR LEDs are clear; verify power to camera.
DVR not recording.	SD card full or faulty; SD card not inserted correctly.	Insert or reinsert SD card; format SD card (backup data first); try a different SD card.

If the problem persists after attempting these solutions, please contact customer support.

## SPECIFICATIONS

Table 3: Product Specifications

Feature	Detail
Brand	DOUXURY
Model Number	The 2023 Latest Version
Color	Black
Screen Size	9 Inches
Display Technology	LCD
Special Features	DVR, Quad View, IP69K Waterproof, Night Vision Function
Compatible Devices	Semi-truck, Trailer, Van, RV
Product Dimensions	2.48L x 0.29W x 0.2H meters
Installation Type	Dashboard mount, Surface mount
Video Recording Resolution	640p
Voltage	12-24 Volts DC
Optical Sensor Technology	Infrared, CMOS
Lens Type	Wide Angle

WARRANTY AND SUPPORT

DOUXURY provides comprehensive customer support for this product:

- **24-Hour Online Customer Service:** Assistance is available around the clock.
- **30-Day Money-Back Guarantee:** If you are not satisfied, you may return the product within 30 days for a full refund.
- **365-Day Replacement Warranty:** The product is covered by a 365-day replacement warranty for manufacturing defects.
- **Lifetime Support:** Ongoing technical support is provided for the lifetime of the product.

For any questions, troubleshooting assistance, or warranty claims, please contact DOUXURY customer service. Your inquiries will receive full attention.



	<p><a href="#">Changzhou JANA Electronic Technology Co., LTD LCD-S866 Manual Control Panel User Guide</a></p> <p>This guide provides detailed information on the LCD-S866 manual control panel from Changzhou JANA Electronic Technology Co., LTD. It covers appearance, materials, working voltage, connection methods, function descriptions, display content, settings, and button operations for the 2018 Latest Version - V1.0.</p>
	<p><a href="#">Qubii Pro User Manual: Automatic Photo Backup for iPhone &amp; iPad</a></p> <p>Comprehensive user manual for the Maktar Qubii Pro automatic backup device. Learn how to set up, use, and troubleshoot your device for seamless photo and data backup from iPhones and iPads. Supports iCloud, social media, and desktop access.</p>
	<p><a href="#">Handy Backup User Manual Version 8 - Comprehensive Guide to Data Protection</a></p> <p>Explore the features and functionalities of Handy Backup Version 8 with this comprehensive user manual. Learn about data backup, restore, synchronization, and advanced features for home and business environments.</p>
	<p><a href="#">Airstream 2023 Caravel Parts Book</a></p> <p>Comprehensive parts book for the 2023 Airstream Caravel, detailing components for appliances, exterior shell, interior shell, chassis, electrical systems, entertainment, floor coverings, furniture, hardware, safety equipment, labels, plumbing, and more. Includes part numbers and descriptions for easy identification and replacement.</p>
	<p><a href="#">BVMS Release Notes: Comprehensive Guide to Bosch Video Management System Updates</a></p> <p>Detailed release notes for Bosch Video Management System (BVMS) versions, covering new features, resolved issues, known issues, and hardware compatibility for various BVMS versions from 3.0 to 10.0.</p>
	<p><a href="#">2022 Ford RV &amp; Trailer Towing Guide - Capacities and Technology</a></p> <p>Explore the 2022 Ford RV &amp; Trailer Towing Guide for detailed towing capacities, technologies, and specifications for F-150, Super Duty, Ranger, Maverick, Bronco, Expedition, Explorer, Edge, Escape, Transit, and RV chassis models. Learn about Built Ford Tough® capability.</p>