

HENDUN SZSF03R

HENDUN Wireless Remote Door Alarm User Manual

Model: SZSF03R

Important Safety Information:

- Keep out of reach of small children.
- Do not expose to extreme temperatures or moisture.
- Ensure proper battery installation to avoid damage.
- The alarm produces a loud sound (105 dB). Avoid prolonged exposure to prevent hearing discomfort.

1. INTRODUCTION

The HENDUN Wireless Remote Door Alarm is designed to enhance security and provide alerts for various applications, including doors, windows, pools, and for monitoring children or individuals with specific care needs. This compact, magnetically triggered alarm system includes a main alarm unit, a magnetic sensor, and a remote control for convenient operation.

It features multiple modes, including a loud alarm (105 dB) and a chime setting, making it versatile for different security and notification requirements.

2. PACKAGE CONTENTS

- 2 x HENDUN Alarm Units
- 2 x Magnetic Sensors
- 2 x Remote Controllers (Keyfobs)
- 2 x User Manuals (this document)
- Self-adhesive mounting pads

3. PRODUCT OVERVIEW



Figure 3.1: Main components of the HENDUN Wireless Remote Door Alarm system.

Structure & Dimensions

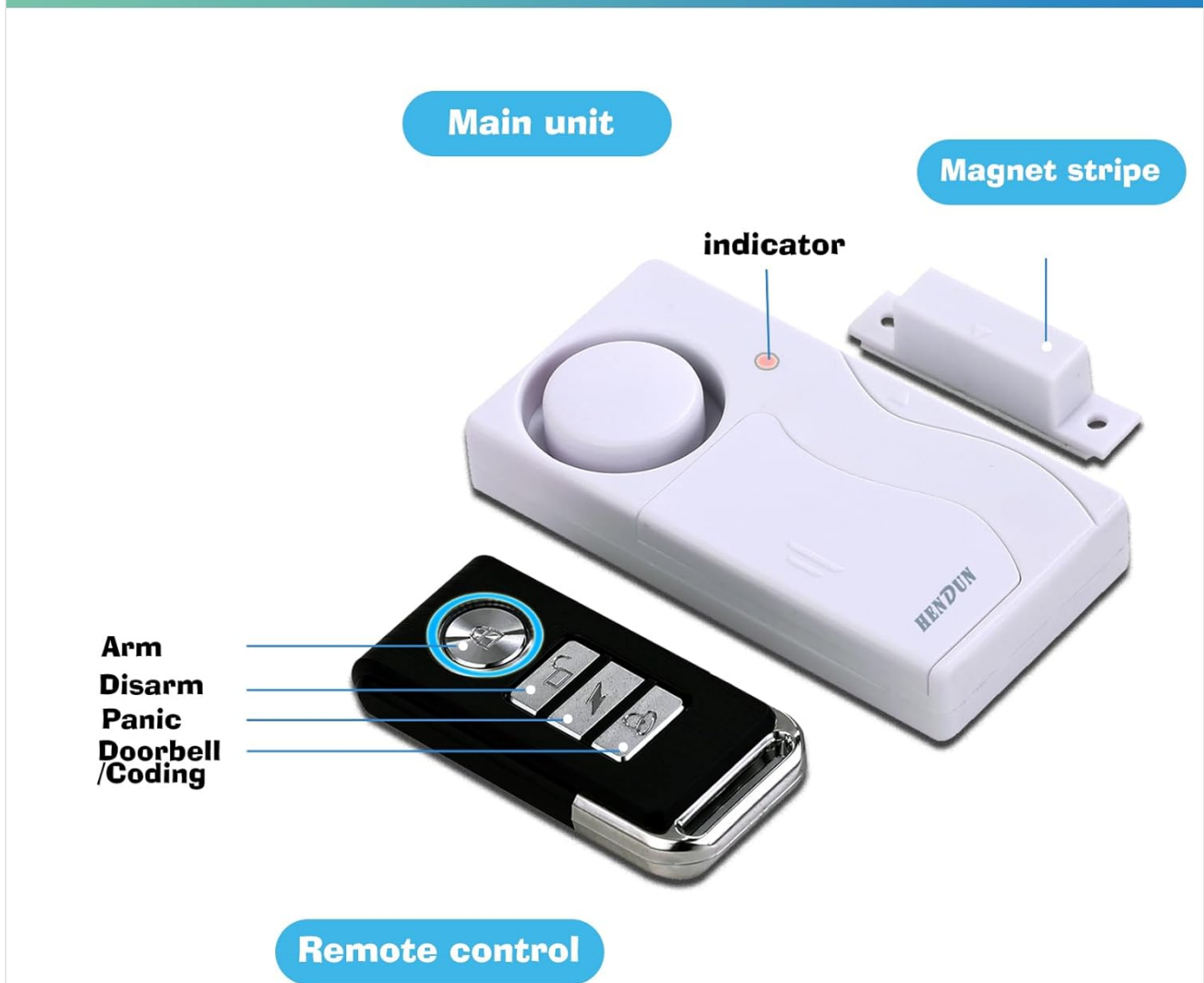

Figure 3.2: Detailed view of the alarm unit and remote control with labeled functions.

3.1 Main Alarm Unit

- **Speaker:** Emits alarm or chime sounds.
- **Indicator Light:** Shows status (e.g., armed, disarmed, low battery).
- **Battery Compartment:** Holds 2 x AAA alkaline batteries (not included).

3.2 Magnetic Sensor

- Works in conjunction with the main unit.
- Triggers the alarm when separated from the main unit.

3.3 Remote Control (Keyfob)

- **Arm Button:** Activates the alarm mode.
- **Disarm Button:** Deactivates the alarm.
- **Panic Button:** Triggers the alarm immediately.
- **Doorbell/Coding Button:** Switches to chime mode or used for pairing.

- Powered by 1 x 12V/27A alkaline battery (included).

4. SETUP AND INSTALLATION

4.1 Battery Installation

1. For the Alarm Unit:

- Locate the battery compartment on the back of the main alarm unit.
- Slide open the battery cover.
- Insert two (2) AAA alkaline batteries (not included), ensuring correct polarity (+/-).
- Close the battery cover securely.

2. For the Remote Control:

- The remote control comes with a 12V/27A alkaline battery pre-installed.
- If replacement is needed, open the small screw on the back and replace the battery, observing polarity.

4.2 Mounting the Alarm System

The alarm system is designed for easy installation using the provided self-adhesive pads. Ensure the mounting surface is clean, dry, and smooth for optimal adhesion.

Where & How



Figure 4.1: Various installation locations for the alarm system.

Applicable Scenarios



Figure 4.2: Applicable scenarios for the HENDUN alarm system.

1. Identify the desired location for the alarm, such as a door, window, cabinet, or drawer.
2. Clean the surface thoroughly where the alarm unit and magnetic sensor will be placed.
3. Attach one self-adhesive pad to the back of the main alarm unit and another to the back of the magnetic sensor.
4. Peel off the protective film from the adhesive pads.
5. Mount the main alarm unit on the fixed frame (e.g., door frame, window frame).
6. Mount the magnetic sensor on the moving part (e.g., door, window sash) directly adjacent to the main unit. Ensure the two parts are aligned and the gap between them is no more than 10mm when the door/window is closed. The indicator light on the main unit should be facing the magnetic sensor.
7. Press firmly for a few seconds to ensure strong adhesion.

4.3 Pairing Additional Remotes/Sensors (Coding)

One magnetic sensor can be paired with up to 8 remotes. One remote can control several sensors.

1. Ensure the alarm unit has batteries installed and is powered on.
2. Press and hold the "Doorbell/Coding" button on the remote control for approximately 3-5 seconds until the alarm

unit emits a short beep, indicating it's in pairing mode.

3. Within 5 seconds, press any button on the remote control you wish to pair. The alarm unit will beep again to confirm successful pairing.
4. To pair additional remotes, repeat the process.
5. To clear all paired remotes, press and hold the "Doorbell/Coding" button for about 10 seconds until you hear a long beep.

5. OPERATING INSTRUCTIONS

The HENDUN alarm system offers three main modes: Alarm, Chime, and Disarmed (Off).



Figure 5.1: Remote control operating range (60-160 feet).

5.1 Arming the Alarm

- Press the **Arm** button (lock icon) on the remote control.
- The alarm unit will emit a short beep to confirm it is armed.
- In this mode, if the magnetic sensor is separated from the main unit (e.g., door/window opens), the alarm will

sound loudly (105 dB).

5.2 Disarming the Alarm

- Press the **Disarm** button (unlocked icon) on the remote control.
- The alarm unit will emit a short beep to confirm it is disarmed.
- In this mode, opening the door/window will not trigger the alarm.

5.3 Chime Mode (Doorbell)

- Press the **Doorbell/Coding** button (bell icon) on the remote control.
- The alarm unit will emit a short beep to confirm it is in chime mode.
- In this mode, when the magnetic sensor is separated from the main unit, a pleasant chime sound will play instead of the loud alarm. This is ideal for entry alerts or monitoring children.

5.4 Panic Function

- Press the **Panic** button (lightning bolt icon) on the remote control.
- The alarm will immediately sound loudly, regardless of the current arming status.
- Press the **Disarm** button to stop the panic alarm.

6. MAINTENANCE

6.1 Battery Replacement

The alarm unit and remote control are designed for low power consumption, with batteries lasting at least a year under normal use.

- **Alarm Unit:** Replace the two (2) AAA alkaline batteries when the alarm unit's indicator light flashes or the sound becomes weak. Follow instructions in Section 4.1.
- **Remote Control:** Replace the 12V/27A alkaline battery if the remote control's range decreases or it becomes unresponsive. Follow instructions in Section 4.1.

Warning:

- Do not mix old and new batteries.
- Do not mix alkaline, standard (carbon-zinc), or rechargeable (nickel-cadmium) batteries.
- Dispose of used batteries responsibly according to local regulations.

6.2 Cleaning

Wipe the alarm unit and remote control with a soft, dry cloth. Do not use abrasive cleaners or solvents, as they may damage the surface or internal components.

7. TROUBLESHOOTING

Problem	Possible Cause	Solution
---------	----------------	----------

Problem	Possible Cause	Solution
Alarm does not sound when door/window opens.	<ul style="list-style-type: none"> Alarm is disarmed. Batteries are low or incorrectly installed. Magnetic sensor and main unit are too far apart. Alarm unit and remote are not paired. 	<ul style="list-style-type: none"> Press the Arm button on the remote. Replace batteries in the alarm unit, ensuring correct polarity. Adjust placement so the gap is less than 10mm when closed. Re-pair the remote and alarm unit (see Section 4.3).
Remote control is unresponsive.	<ul style="list-style-type: none"> Remote battery is low or dead. Out of range. Interference. 	<ul style="list-style-type: none"> Replace the 12V/27A battery in the remote. Move closer to the alarm unit (within 60-160 ft). Ensure no large metal objects or strong electronic devices are blocking the signal.
Alarm sounds continuously or falsely.	<ul style="list-style-type: none"> Magnetic sensor and main unit are misaligned or too far apart. Vibrations or unstable mounting. 	<ul style="list-style-type: none"> Re-align the magnetic sensor and main unit, ensuring they are close and stable when closed. Re-mount the alarm on a stable, flat surface.

8. SPECIFICATIONS

Model Number	SZSF03R
Brand	HENDUN
Noise Level	105 dB
Control Method	Remote
Mounting Type	Window Mount (Self-adhesive)
Sensor Technology	Contact Sensor (Magnetic)
Power Source	Battery Powered
Alarm Unit Batteries	2 x AAA alkaline batteries (not included)
Remote Control Battery	1 x 12V/27A alkaline battery (included)
Product Dimensions (Alarm Unit)	10.5 x 7 x 6 cm (approx. 4.1 x 2.8 x 2.4 inches)
Item Weight	68 g (approx. 2.4 oz)
UPC	664248681751

9. WARRANTY AND SUPPORT

For warranty information or technical support, please contact HENDUN customer service through the retailer where the product was purchased or refer to the contact information provided on the product packaging.
Please retain your proof of purchase for warranty claims.