



[Manuals.plus](#) /

> [AgPubs](#) /

> AgPubs Service Manual for Cub Cadet 1050, 1204, 1210, 1211, 1810, 1811, 1812, 2072, 1572, 1772, 1872 Lawn Garden Tractors

AgPubs 1050, 1204, 1210, 1211, 1810, 1811, 1812, 2072, 1572, 1772, 1872

AgPubs Service Manual for Cub Cadet Lawn Garden Tractors

Models: 1050, 1204, 1210, 1211, 1810, 1811, 1812, 2072, 1572, 1772, 1872

INTRODUCTION

This document serves as an instruction guide for utilizing the AgPubs Service Manual, a comprehensive resource for the repair, overhaul, and troubleshooting of specific Cub Cadet Lawn Garden Tractors. This manual is a quality reproduction designed to provide durable and clear access to original manufacturer specifications and procedures.

The AgPubs Service Manual is an essential tool for owners and technicians performing maintenance and repairs on the listed Cub Cadet models. It contains detailed information to assist in diagnosing issues and executing corrective actions.

MODELS COVERED

This AgPubs Service Manual specifically covers the following Cub Cadet Lawn Garden Tractor models:

- Cub Cadet 1050
- Cub Cadet 1204
- Cub Cadet 1210
- Cub Cadet 1211
- Cub Cadet 1810
- Cub Cadet 1811
- Cub Cadet 1812
- Cub Cadet 2072
- Cub Cadet 1572
- Cub Cadet 1772
- Cub Cadet 1872

Always verify your tractor's model number against this list to ensure compatibility with the manual's content.

UNDERSTANDING MANUAL TYPES

It is important to distinguish between different types of manuals available for equipment. The AgPubs Service Manual is specifically a **Service Manual**. Below are definitions for common manual types:

- **Service Manual:** This type of manual, like the AgPubs product, provides detailed instructions for *repair, overhaul, and troubleshooting*. It includes in-depth procedures, specifications, and diagrams necessary for complex mechanical and electrical work.
- **Operators Manual:** Focuses on *basic maintenance, operation procedures, fluid types, quantities, and adjustments*. It is intended for daily users of the equipment.
- **Parts Catalog:** Contains *exploded views, parts names, and factory (OEM) parts numbers*. This manual is used for identifying and ordering specific replacement components.

The AgPubs Service Manual is designed for technical repair tasks, not routine operation or parts identification, though it may contain some relevant diagrams.

MANUAL STRUCTURE OVERVIEW

The AgPubs Service Manual is organized into distinct sections to facilitate easy navigation and access to specific information. The primary sections typically include:

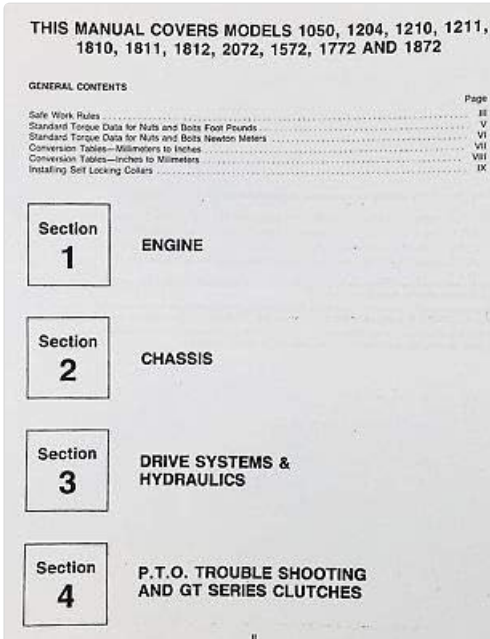

THIS MANUAL COVERS MODELS 1050, 1204, 1210, 1211, 1810, 1811, 1812, 2072, 1572, 1772 AND 1872

GENERAL CONTENTS		Page
Safe Work Rules		III
Standard Torque Data for Nuts and Bolts Foot Pounds		V
Standard Torque Data for Nuts and Bolts Newton Meters		VI
Conversion Tables—Inches to Millimeters		VII
Conversion Tables—Millimeters to Inches		VIII
Installing Self Locking Coils		IX

Section 1	ENGINE
Section 2	CHASSIS
Section 3	DRIVE SYSTEMS & HYDRAULICS
Section 4	P.T.O. TROUBLE SHOOTING AND GT SERIES CLUTCHES

Figure 1: General Contents page of the Cub Cadet Service Manual. This page outlines the main sections of the manual, including Engine, Chassis, Drive Systems & Hydraulics, and PTO Troubleshooting & GT Series Clutches. It also lists general information such as safe work rules and torque data.

- **Engine:** Covers all aspects of engine repair, maintenance, and troubleshooting.
- **Chassis:** Details on the tractor frame, steering, and suspension components.
- **Drive Systems & Hydraulics:** Information on transmissions, axles, and hydraulic systems.
- **P.T.O. Troubleshooting & GT Series Clutches:** Specific guidance for power take-off systems and clutch mechanisms.

Each section contains detailed procedures, diagrams, and specifications relevant to its topic.

USING THE SERVICE MANUAL FOR REPAIR AND OVERHAUL

To effectively use this service manual for repairs or overhauls, follow these general steps:

1. **Identify the Problem:** Clearly define the issue you are addressing.
2. **Locate Relevant Section:** Navigate to the section of the manual that pertains to the component or system you are working on (e.g., Engine, Chassis, Hydraulics).
3. **Review Safety Information:** Before beginning any work, always consult the "Safe Work Rules" or similar safety guidelines provided within the manual.
4. **Follow Step-by-Step Procedures:** The manual provides detailed, illustrated instructions for disassembly, inspection, repair, and reassembly. Adhere to these steps precisely.
5. **Consult Diagrams and Specifications:** Refer to wiring diagrams, hydraulic schematics, exploded views, and torque specifications as needed.

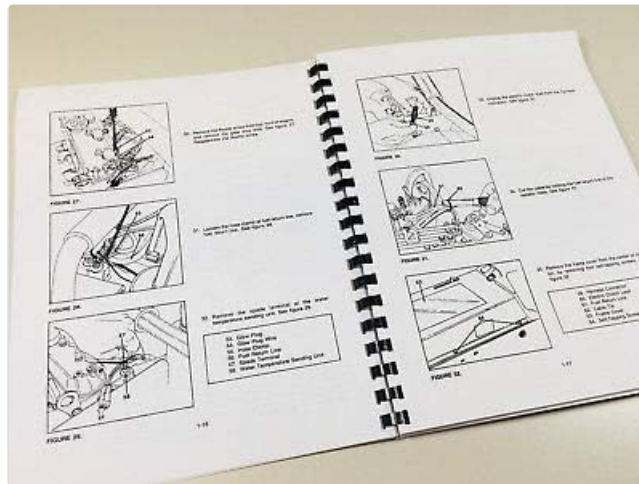

Figure 2: Example pages from the manual illustrating detailed diagrams and step-by-step instructions for engine-related repair procedures, such as removing engine components.

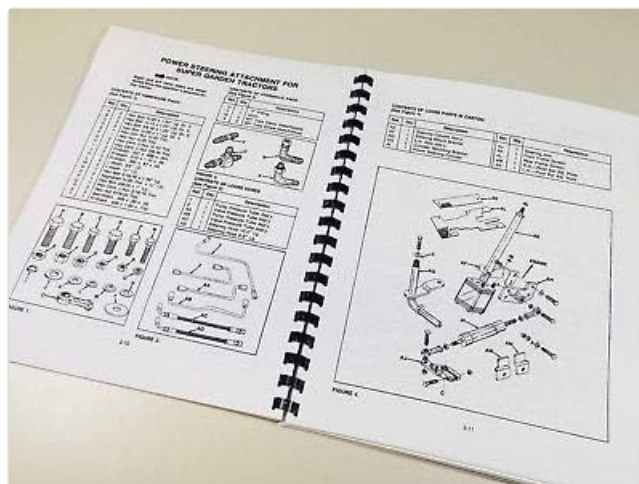

Figure 3: Pages displaying diagrams and parts lists for a power steering attachment, useful for understanding component assembly and identification.

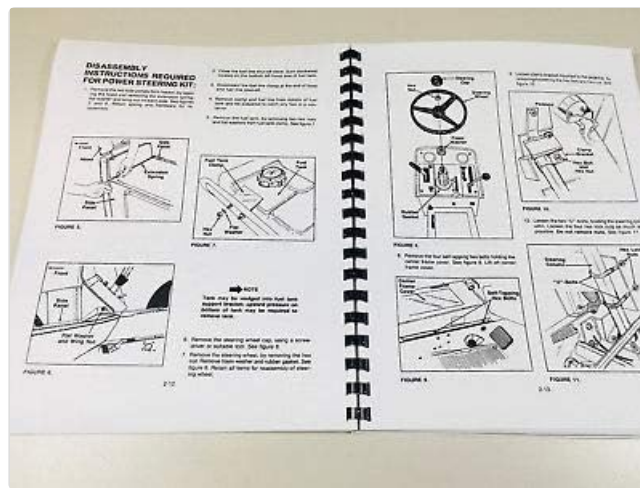

Figure 4: Instructions for disassembling a power steering kit, including visual aids for each step.

Engine Section

The Engine section provides comprehensive details on engine components, diagnostics, and repair procedures. This includes:

- Disassembly and reassembly of engine parts.
- Specifications for clearances, torque values, and wear limits.
- Troubleshooting guides for common engine problems.

Chassis Section

This section covers the structural and foundational elements of the tractor. It includes information on:

- Frame inspection and repair.
- Steering system components and adjustments.
- Wheel and tire maintenance.

Drive Systems & Hydraulics Section

Detailed information on the tractor's power transmission and hydraulic functions can be found here. This includes:

- Transmission overhaul and repair.
- Axle and differential service.
- Hydraulic pump, cylinder, and valve diagnostics and repair.

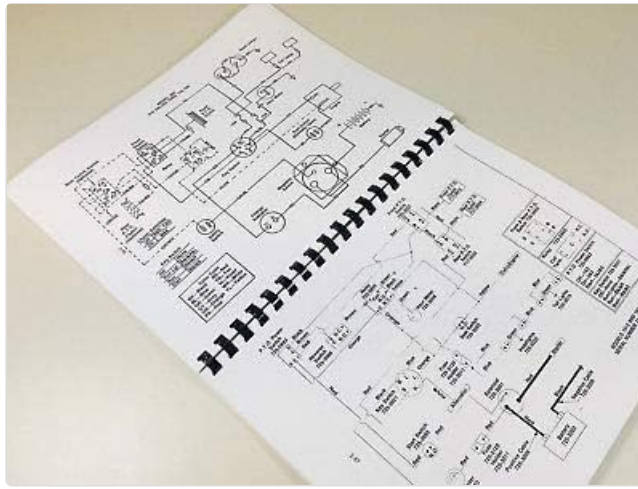

Figure 5: A detailed diagram illustrating the components and flow of a hydraulic system, crucial for troubleshooting and repair.

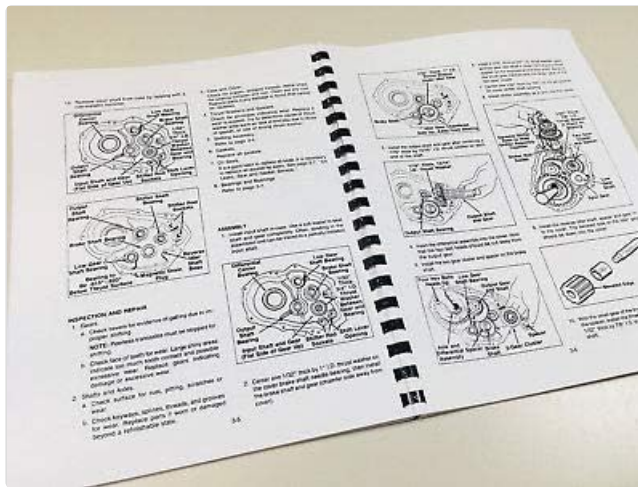

Figure 6: Pages detailing the inspection and repair procedures for drive system components, including various gears and shafts.

P.T.O. Troubleshooting & GT Series Clutches Section

This specialized section addresses issues related to the Power Take-Off system and specific GT Series clutches. It provides:

- Diagnostic charts for PTO malfunctions.
- Clutch adjustment and replacement procedures.
- Electrical schematics related to PTO engagement.

INTERPRETING DIAGRAMS AND SPECIFICATIONS

The service manual relies heavily on diagrams, charts, and tables to convey complex information. When reviewing these:

- **Wiring Diagrams:** Trace circuits carefully, noting wire colors and component symbols.
- **Exploded Views:** Use these to understand the assembly order of components and identify individual parts.
- **Torque Specifications:** Always apply the specified torque values when tightening fasteners to prevent damage or loosening. These are often found in dedicated tables within the manual.

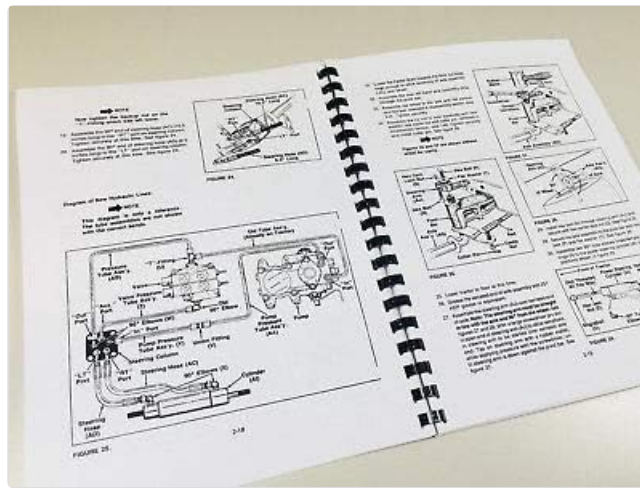

Figure 7: A comprehensive electrical wiring diagram, essential for diagnosing electrical faults and understanding the tractor's electrical system.

SAFETY INFORMATION

The AgPubs Service Manual includes critical safety information. It is imperative to read and understand all safety warnings and precautions before attempting any repair or maintenance. Key safety rules often include:

- Always disconnect the battery before working on electrical components.
- Use appropriate personal protective equipment (PPE).
- Ensure the tractor is stable and supported before working underneath it.
- Follow proper procedures for handling fuels, lubricants, and other chemicals.

Refer to the initial pages of the service manual for a complete list of safety guidelines.

SUPPORT

As this is a reproduction service manual, support for the content itself is provided by the original manufacturer's specifications detailed within the manual. For inquiries regarding the physical manual's quality or delivery, please contact the seller, Peaceful Creek Supply.