



[Manuals.plus](#) /

› [BarberPub](#) /

› BarberPub Model 9089 Backwash Shampoo Station Chair with Legrest - Off White Instruction Manual

## BarberPub 6154-9090

# BarberPub Model 9089 Backwash Shampoo Station Chair with Legrest - Off White Instruction Manual

Professional Salon Equipment for Hair Washing and Styling

## 1. INTRODUCTION

---

This manual provides detailed instructions for the assembly, operation, and maintenance of your BarberPub Model 9089 Backwash Shampoo Station Chair. Designed for professional salon, barbershop, and home studio use, this unit combines ergonomic comfort with durable construction. Please read this manual thoroughly before installation and use to ensure proper function and longevity of your product.

## 2. SAFETY INFORMATION

---

- Ensure all connections, especially plumbing, are secure and leak-free before use.
- Do not exceed the maximum weight capacity of 330 lbs (150 kg).
- Keep children and pets away from the unit during assembly and operation.
- Use only approved cleaning agents for PVC leather and ceramic surfaces. Avoid abrasive cleaners.
- Regularly inspect the chair and plumbing for any signs of wear, damage, or leaks.
- Ensure proper drainage is established according to local plumbing codes.

## 3. PACKAGE CONTENTS

---

Please verify that all components are present before beginning assembly. If any parts are missing or damaged, contact customer support immediately.

- Shampoo Chair Base with Legrest Mechanism
- Ceramic Shampoo Bowl
- Faucet Assembly (UPC certified)
- Showerhead and Hose

- Drain Assembly
- Neck Rest Cushion
- Assembly Hardware and Tools
- Instruction Manual

## **4. SETUP AND ASSEMBLY**

---

Assembly requires basic tools, which are included. It is recommended to have two people for certain steps.

### **4.1 Unpacking**

1. Carefully remove all components from the packaging.
2. Lay out all parts and compare them with the package contents list.
3. Keep packaging materials until assembly is complete in case of returns or missing parts.

### **4.2 Chair Assembly**

1. Attach the chair backrest to the seat base using the provided bolts.
2. Secure the armrests to the chair frame.
3. Ensure all bolts are tightened securely.

### **4.3 Bowl and Plumbing Installation**

1. Mount the ceramic shampoo bowl to the chair's support structure.
2. Install the faucet assembly, showerhead, and hose onto the bowl.
3. Connect the drain assembly to the bowl, ensuring a watertight seal.
4. Connect the hot and cold water supply lines to the faucet. Ensure all plumbing connections are tight to prevent leaks.
5. Connect the drain hose to your salon's waste system. This unit is compatible with both wall and floor drainage systems.

# Adjustable Shampoo Basin

Making your shoulders and neck comfortable

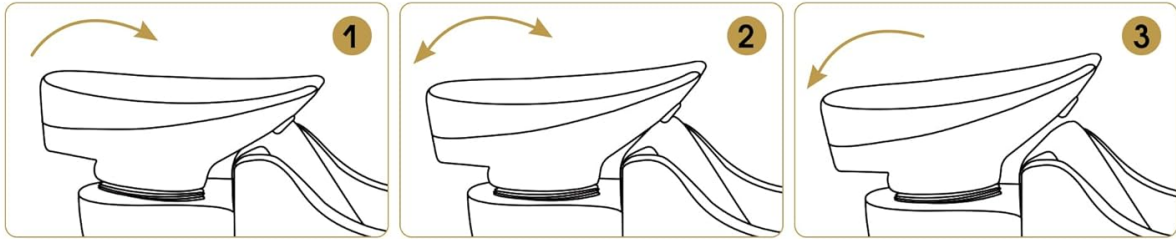

Figure 1: Product Dimensions and Components Overview.

## High-quality Ceramic Basin

UPC certification



Figure 2: Adjustable Shampoo Basin Mechanism. The basin can be tilted to accommodate various client heights and preferences.



Figure 3: Leg Baffle Adjustment. The lever on the side of the chair allows for lifting or dropping the leg support for client comfort.

## 5. OPERATING INSTRUCTIONS

---

### 5.1 Client Seating

- Guide the client to sit comfortably in the chair. The 18.9-inch seat height is designed for easy entry and exit.
- Ensure the client's head is positioned correctly in the neck-contoured ceramic bowl.

### 5.2 Adjusting the Legrest

- To adjust the legrest, locate the lever on the side of the chair.
- Push or pull the lever to raise or lower the leg baffle to the desired position for client comfort.

### 5.3 Adjusting the Shampoo Bowl

- The ceramic bowl's angle can be adjusted to suit different client heights and prevent water spills.
- Gently tilt the bowl to achieve the optimal angle for hair washing.

## 5.4 Water Control

- Use the faucet handles to control water temperature and flow.
- The showerhead provides a convenient spray for rinsing hair.



### **Waterproof Pvc Leather & High Density Sponge**

High quality material will give you comfortable sitting experience

Figure 4: Ergonomic Design in Reclined Position. The chair features a 128-degree reclining backrest and an adjustable legrest for full-body support.

## 6. MAINTENANCE

### 6.1 Cleaning the PVC Leather

- For daily cleaning, wipe the waterproof PVC leather with a damp cloth.
- For tougher stains, such as hair dye or chemical residues, use a specialized leather cleaner or a small amount of gasoline applied to a cloth. Test on an inconspicuous area first.
- Avoid harsh chemicals or abrasive scrubbing that could damage the material.

### 6.2 Cleaning the Ceramic Bowl

- Clean the ceramic bowl regularly with a non-abrasive cleaner and a soft cloth or sponge.

- Rinse thoroughly after cleaning to remove any chemical residues.
- The ceramic is scratch-resistant but can be damaged by heavy impacts.

### 6.3 Plumbing Maintenance

- Periodically check all plumbing connections for leaks. Tighten any loose fittings.
- Clean the showerhead and faucet aerator as needed to remove mineral buildup.



Figure 5: Waterproof PVC Leather. This material is designed for easy cleaning and durability in a salon environment.

# Ergonomic Design

Comfortable lying down angle 124 °



Figure 6: High-Quality Ceramic Basin. The basin is UPC certified, ensuring compliance with U.S. plumbing standards.

## 7. TROUBLESHOOTING

- **Water Leaks:** Check all plumbing connections for tightness. Ensure rubber gaskets and seals are correctly seated. If leaks persist, professional plumbing assistance may be required.
- **Legrest Not Adjusting:** Inspect the adjustment mechanism for any obstructions or damage. Ensure the lever is fully engaged.
- **Water Flow Issues:** Check water supply valves. Clean the faucet aerator and showerhead for mineral buildup.
- **Chair Instability:** Verify that the chair is placed on a flat, stable surface. Check all assembly bolts for tightness.

## 8. SPECIFICATIONS

Brand	BarberPub
Model Number	6154-9090

<b>Color</b>	Off White
<b>Overall Dimension (without footrest)</b>	25"(W) x 58"(D) x 39"(H)
<b>Overall Dimension (with footrest)</b>	25"(W) x 71"(D) x 39"(H)
<b>Seat Area</b>	19.6"(W) x 22"(D)
<b>Backrest Area</b>	19.6"(W) x 17.7"(H)
<b>Height from floor to armrest</b>	25.2"
<b>Height from floor to top of bowl</b>	39"
<b>Bowl Dimension</b>	23.6"(W) x 20.0"(D) x 7.9"(H)
<b>Depth of Bowl</b>	5.5"
<b>Weight Capacity</b>	330 lbs (150 kg)
<b>Materials</b>	Waterproof PVC Leather, High-Density Sponge, Solid Wood Frame, Ceramic Bowl, Chrome-plated Stainless Steel

## 9. WARRANTY INFORMATION

BarberPub provides a **1-year free replacement parts warranty** for this product. This warranty covers the bowl, backrest, armrests, seat, and legrest. Please retain your proof of purchase for warranty claims. For service or replacement parts, refer to the Customer Support section.

## 10. CUSTOMER SUPPORT

For any questions, assistance with assembly, troubleshooting, or warranty claims, please contact BarberPub customer support. Refer to the contact information provided with your purchase or visit the official BarberPub website.

We are committed to providing quality products and support to ensure your satisfaction.