



Manuals.plus /

› Intex /

› Intex Easy Set Round Above Ground Inflatable Swimming Pool System User Manual

## Intex B07HCNWZDT

# Intex Easy Set Round Above Ground Inflatable Swimming Pool System User Manual

Model: B07HCNWZDT

## INTRODUCTION

---

This manual provides essential instructions for the safe and efficient setup, operation, and maintenance of your Intex Easy Set Round Above Ground Inflatable Swimming Pool System. Please read all instructions carefully before installation and use. Retain this manual for future reference.

## IMPORTANT SAFETY INFORMATION

---

**WARNING: This product contains chemicals known to the State of California to cause cancer and birth defects or other reproductive harm. For more information, go to [www.P65Warnings.ca.gov](http://www.P65Warnings.ca.gov).**

Always supervise children in and around the pool. Ensure proper fencing and safety barriers are in place according to local regulations. Do not dive or jump into the pool. Always follow all chemical handling and storage instructions.

## PRODUCT COMPONENTS

---

Your Intex Easy Set Pool System includes the following main components:

- Intex Easy Set Inflatable Ring Pool (18 feet x 48 inches)
- Krystal Clear Filter Pump (110-120 volts, 1,500 GPH pump flow rate)
- Filter Cartridges
- Pool Ladder
- Ground Cloth
- Debris Cover
- Deluxe Maintenance Kit

# INCLUDED ACCESSORIES



Krystal Clear™  
Cartridge Filter Pump



Removable Ladder



Pool Cover



Ground Cover

**INTEX®**

Image: Overview of included accessories: Krystal Clear Cartridge Filter Pump, Removable Ladder, Pool Cover, and Ground Cover.

## SPECIFICATIONS

Key specifications for the Intex Easy Set Round Above Ground Inflatable Swimming Pool:

- **Brand:** Intex
- **Model:** B07HCNWZDT
- **Shape:** Round
- **Product Dimensions:** 18 feet (diameter) x 48 inches (height)
- **Water Depth:** 41 inches (104 cm)
- **Water Capacity:** 5,455 gallons (20,649 L) at 80% full
- **Material Type:** 3-ply Vinyl (puncture-resistant)
- **Filter Pump Flow Rate:** 1,500 gallons per hour (GPH)
- **Voltage:** 110-120V
- **Weight:** Approximately 132.2 pounds (package)

# SPECIFICATIONS

# INTEX®



Image: Visual representation of pool specifications including 18 ft diameter, 48 in height, 5,455 gal water capacity, and 41 in water depth.

## SETUP INSTRUCTIONS

1. **Site Preparation:** Choose a firm, level ground surface for installation. Do not install on sand, mud, or any soft soil conditions. Clear the area of any sharp objects or debris.
2. **Lay Out Pool:** Carefully unroll the pool liner on the prepared ground. Ensure the drain plug is facing the desired drainage area.
3. **Inflate Top Ring:** Inflate the top ring of the pool using an air pump (not included unless specified in kit). Ensure it is firm but not over-inflated.
4. **Install Filter Pump:** Connect the Krystal Clear Filter Pump according to the separate pump manual. Ensure all hoses are securely attached.
5. **Fill with Water:** Begin filling the pool with water. As the water level rises, the pool walls will expand. Smooth out any wrinkles on the bottom of the pool as it fills. Stop filling when the water reaches the fill line indicated on the pool wall.
6. **Install Ladder:** Assemble and install the pool ladder according to its separate instructions. Ensure it is stable

and securely placed.

## EASY SET UP

# INTEX®



1

Lay out pool on  
level ground



2

Inflate the top ring  
(optional pump shown)



3

Fill pool with  
water and enjoy

**30**  
**MIN.**  
SETUP

Image: Three-step visual guide for easy setup: 1. Lay out pool on level ground, 2. Inflate the top ring, 3. Fill pool with water and enjoy. Estimated setup time: 30 minutes.

### Pool Liner Construction

The pool features a 3-ply material designed for durability and puncture resistance. This construction includes an extra-thick PVC layer and a high-strength polyester mesh for enhanced resilience.

# INTEX®

## 3-PLY SIDE WALL LINER

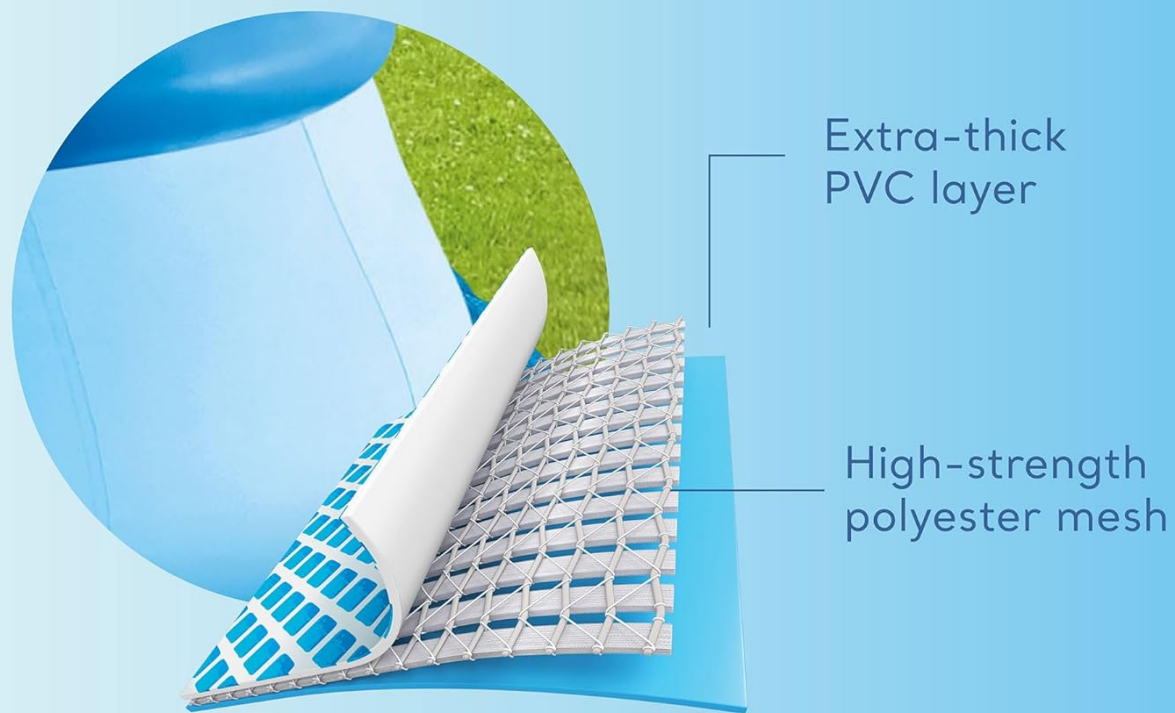

Image: Diagram illustrating the 3-ply side wall liner, showing an extra-thick PVC layer and high-strength polyester mesh for durability.

### OPERATING THE FILTER PUMP

---

The Krystal Clear Filter Pump is crucial for maintaining clean and clear pool water. It features Hydro Aeration Technology for improved water quality.

- **Hydro Aeration Technology:** This system enhances circulation and filtration, improves water clarity, and increases negative ions at the water surface.
- **Automatic Filtration:** The pump provides automatic daily filtration with adjustable cycles (e.g., 2-12 hours).
- **Filter Cartridge:** The pump uses easy-to-clean filter cartridges. Refer to the pump manual for specific cartridge type and replacement frequency.

INTEX®

# KRYSTAL CLEAR CARTRIDGE FILTER PUMP C1500

- Easy-to-clean filter cartridge
- Automatic daily filtration with 2-12 hour cycles
- Voltage: 110-120V
- Pump Flow Rate:  
**1500 GPH**



INTEX's patented HydroAeration® Technology is precision engineered to improve filtration, clarity and freshness in above ground pools.

Image: Details of the Krystal Clear Cartridge Filter Pump C1500, highlighting its easy-to-clean filter cartridge, automatic daily filtration with 2-12 hour cycles, 110-120V voltage, and 1500 GPH pump flow rate, along with the Hydro Aeration Technology logo.

## Filter Pump Operation Overview

Your browser does not support the video tag.

Video: An overview of the Intex Krystal Clear Pool Filter Pump, explaining its function in circulating and filtering pool water, featuring an air release valve and sediment flush valve for easy maintenance. The pump can filter 1500 gallons per hour and is double insulated for safety and longevity.

## MAINTENANCE

Regular maintenance is essential for the longevity and cleanliness of your pool system.

### Filter Pump Maintenance

- **Air Release Valve:** The pump features an air release valve to expel trapped air from inside the filter chamber, ensuring efficient operation.
- **Sediment Flush Valve:** A sediment flush valve is located at the bottom of the filter chamber for easy removal

of accumulated debris.

- **Cartridge Cleaning/Replacement:** Regularly clean or replace the filter cartridges as indicated in the pump manual to maintain optimal filtration.

## Deluxe Maintenance Kit

The included deluxe maintenance kit assists in keeping your pool clean:

- 110-inch telescoping aluminum pole
- 24ft 7in hose with connector for filter
- Deluxe vacuum head (comes with 2 nozzles, 1 scrubber)
- Leaf rake head with deep skimmer net
- Curved wall brush head

## Pool Maintenance Kit *PARTS*

1 110in telescoping aluminum pole

2 24ft 7in hose with connector for filter

3 Deluxe vacuum head  
comes with 2 nozzles, 1 scrubber

4 Leaf rake head with deep  
skimmer net

5 Curved wall brush head

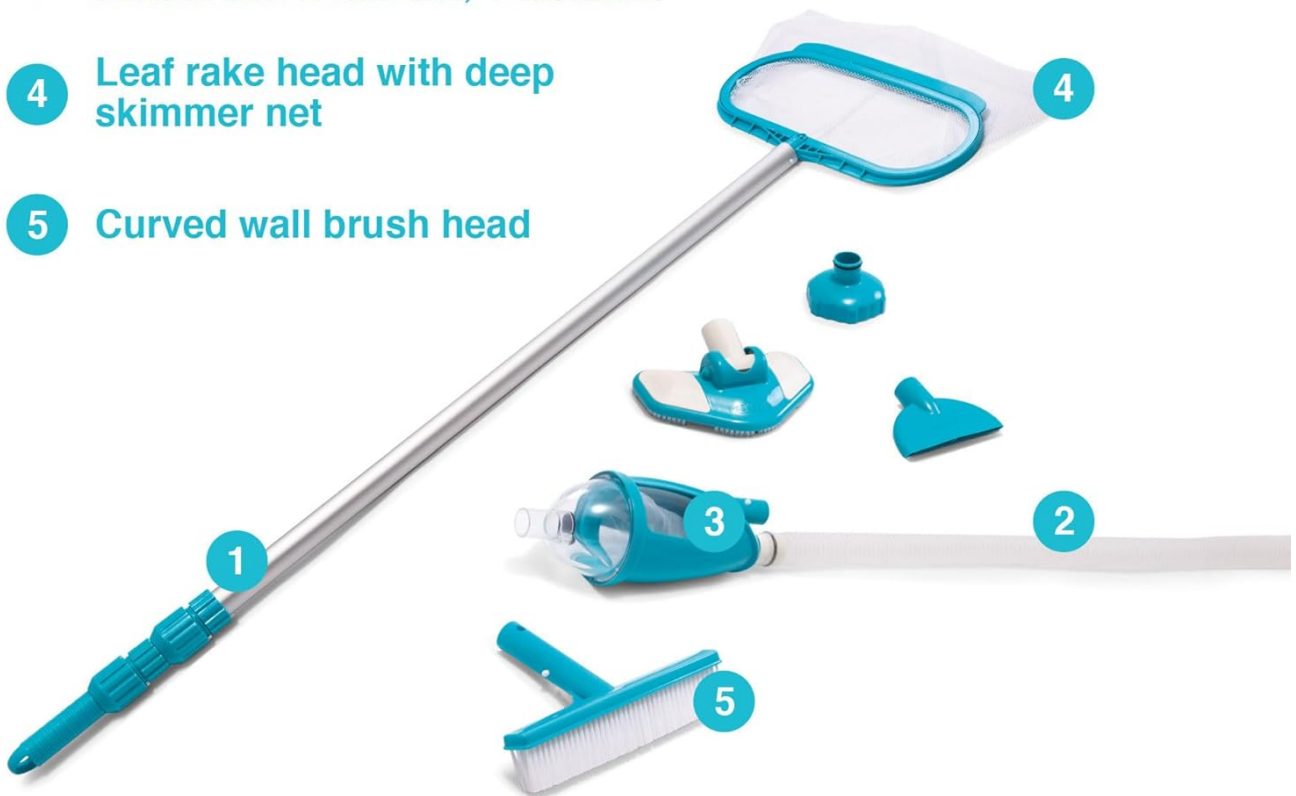

Image: Detailed view of the Pool Maintenance Kit parts, including a telescoping pole, hose, vacuum head, leaf rake, and curved wall brush.



Image: A person demonstrating the use of the pool maintenance kit to clean an above-ground pool.

## TROUBLESHOOTING

---

If you encounter issues with your Intex Easy Set Pool System, please refer to the specific troubleshooting section in the separate filter pump manual or contact customer support. Common issues may include:

- Poor water circulation
- Cloudy water
- Pump not operating
- Water leaks

Always ensure the power supply is disconnected before attempting any inspection or repair.

## WARRANTY INFORMATION

---

Specific warranty details for the Intex Easy Set Round Above Ground Inflatable Swimming Pool System are not provided in this document. Please refer to the warranty card included with your product or visit the official Intex

website for comprehensive warranty terms and conditions.

## **CUSTOMER SUPPORT**

---

For further assistance, technical support, or to order replacement parts, please contact Intex customer service. Contact information can typically be found on the product packaging, the official Intex website, or in the separate filter pump manual.