

## Z Z10wganying-BG-touguangdeng-heike

# Z 10W Motion Sensor LED Flood Light Instruction Manual

Model: Z10wganying-BG-touguangdeng-heike

## 1. INTRODUCTION

This manual provides detailed instructions for the installation, operation, and maintenance of your Z 10W Motion Sensor LED Flood Light. This product is designed for both indoor and outdoor use, offering efficient and reliable lighting with integrated motion detection capabilities. Please read this manual thoroughly before use to ensure proper function and safety.



Image 1.1: Overview of the Z 10W Motion Sensor LED Flood Light.

## 2. PRODUCT FEATURES

- **Intelligent Motion Detection:** Equipped with a PIR (Passive Infrared) motion detector, featuring adjustable settings for sensing time (6-360 seconds), detection distance (1-12 meters), and ambient light sensitivity (day/night operation).
- **Energy Efficient LED:** Utilizes a 10W LED lamp, providing illumination equivalent to an 80W traditional bulb, with an estimated lifespan of 50,000 hours. Operates efficiently within an AC 85-265V range.
- **Durable and Safe Construction:** Features a die-cast aluminum casing and an advanced aluminum heat sink for optimal heat dissipation. Includes a high-quality glass mask and is designed for a long service life.
- **IP65 Waterproof Rating:** Designed to withstand various weather conditions, including rain, sleet, and snow,

making it suitable for diverse outdoor environments.

- **Flexible Installation:** Comes with a widened and thickened adjustable metal bracket, allowing for secure mounting on ceilings, walls, and floors.

### 3. PACKAGE CONTENTS

Verify that all components are present in the package:

- 1 x Z 10W Motion Sensor LED Flood Light
- 1 x User Manual (built-in)

### 4. SPECIFICATIONS

## DIMENSION



Image 4.1: Product dimensions for installation planning.

Specification	Value
Brand	Z
Model Number	Z10wganying-BG-touguangdeng-heike
Wattage	10 Watts
Voltage	AC 85-265 Volts
Brightness	1200 Lumens
Color Temperature	6500 Kelvin (Daylight White)
Material	Aluminum
Water Resistance Level	IP65 Waterproof
Product Dimensions (L x W x H)	5.9" x 4.48" x 3.38"
Power Source	AC (US 3-Plug)
Special Features	Dusk to Dawn LED Light, Human Body PIR Induction
Switch Type	Motion Sensor
Light Source Type	LED
Beam Angle	120 degrees
Detection Range	1-12 meters (adjustable)
Detection Angle	180 degrees (twistable up/down, left/right)

## 5. SAFETY INFORMATION

- Always disconnect power before installation, maintenance, or adjustment.
- Ensure proper grounding to prevent electrical shock.
- Do not install in highly corrosive environments.
- Ensure the mounting surface is stable and can support the weight of the fixture.
- Keep the environment temperature between -30 to 50 degrees Celsius.
- Ensure adequate ventilation around the fixture.
- If any abnormal operation (e.g., not bright, flashing) occurs, contact customer support.

## 6. SETUP AND INSTALLATION

The Z Motion Sensor LED Flood Light is designed for easy installation on various surfaces. Follow these steps for secure mounting:

1. **Choose a Location:** Select a suitable location for the flood light, considering the desired illumination area and motion detection coverage. The adjustable bracket allows for wall, ceiling, or floor mounting.
2. **Mount the Bracket:** Use appropriate screws (not included) to securely attach the widened and thickened

metal bracket to the chosen surface. Ensure the bracket is firmly fixed before attaching the light fixture.

3. **Attach the Light Fixture:** Secure the flood light to the mounted bracket using the provided hardware. The bracket allows for 270-degree adjustment to direct the light as needed.
4. **Connect Power:** Plug the US 3-plug power cord into a compatible outdoor-rated electrical outlet. The power cord length is approximately 59 inches (150 cm). Ensure the connection is secure and protected from moisture.
5. **Adjust Sensor Angle:** The motion sensor can be twisted 180 degrees horizontally and vertically to optimize its detection area.

# User Manual

## Motion Sensor LED Flood Light

### 1. Application

LED Flood Light is a semiconductor Lighting fixture which using the high-performance constant current source made it energy-saving, environmental friendly and long-lasting. It can be used in mining operations, building outlines, stadiums, flyovers, monuments, flower beds, home, office, meeting room, hotel, cabinet, shopping mall, show windows, ship hoardings and parking lots, etc.

### 2. Features

With constant current source, semiconductor lighting fixture the advantages of high luminous efficiency, long lifespan, instant on, low power consumption, high CRI, non-flicker etc. It also can be adapted to the actual situation of the global grid voltage. LED flood lights save up to 70% electricity cost compared with traditional halogen lamps with the same lighting effect. It is the ideal lighting for energy-saving and green project.

Image 6.1: Examples of typical installation locations such as garages and entryways.



Image 6.2: The IP65 waterproof design ensures durability in outdoor conditions.

## 7. OPERATING INSTRUCTIONS: SENSOR SETTINGS

The motion sensor features three adjustable dials to customize its operation:



Image 7.1: Close-up of the SENS, TIME, and LUX adjustment dials on the motion sensor.

- **SENS (Sensitivity):** Adjusts the motion detection distance from approximately 1 meter (minimum position) to 12 meters (maximum position). Turn the knob clockwise to increase sensitivity and detection range.
- **TIME (Illumination Duration):** Sets how long the light remains on after motion is detected. Adjustable from 6 seconds (minimum position) to 480 seconds (maximum position). Turn the knob clockwise for a longer illumination time.
- **LUX (Ambient Light Sensor):** Determines when the motion sensor activates based on ambient light levels.
  - Turn to 'SUN' position: The lamp will operate 24 hours a day, activating with motion regardless of ambient light.
  - Turn to 'MOON' position: The lamp will only operate at night or in low-light conditions, activating with motion when it's dark.

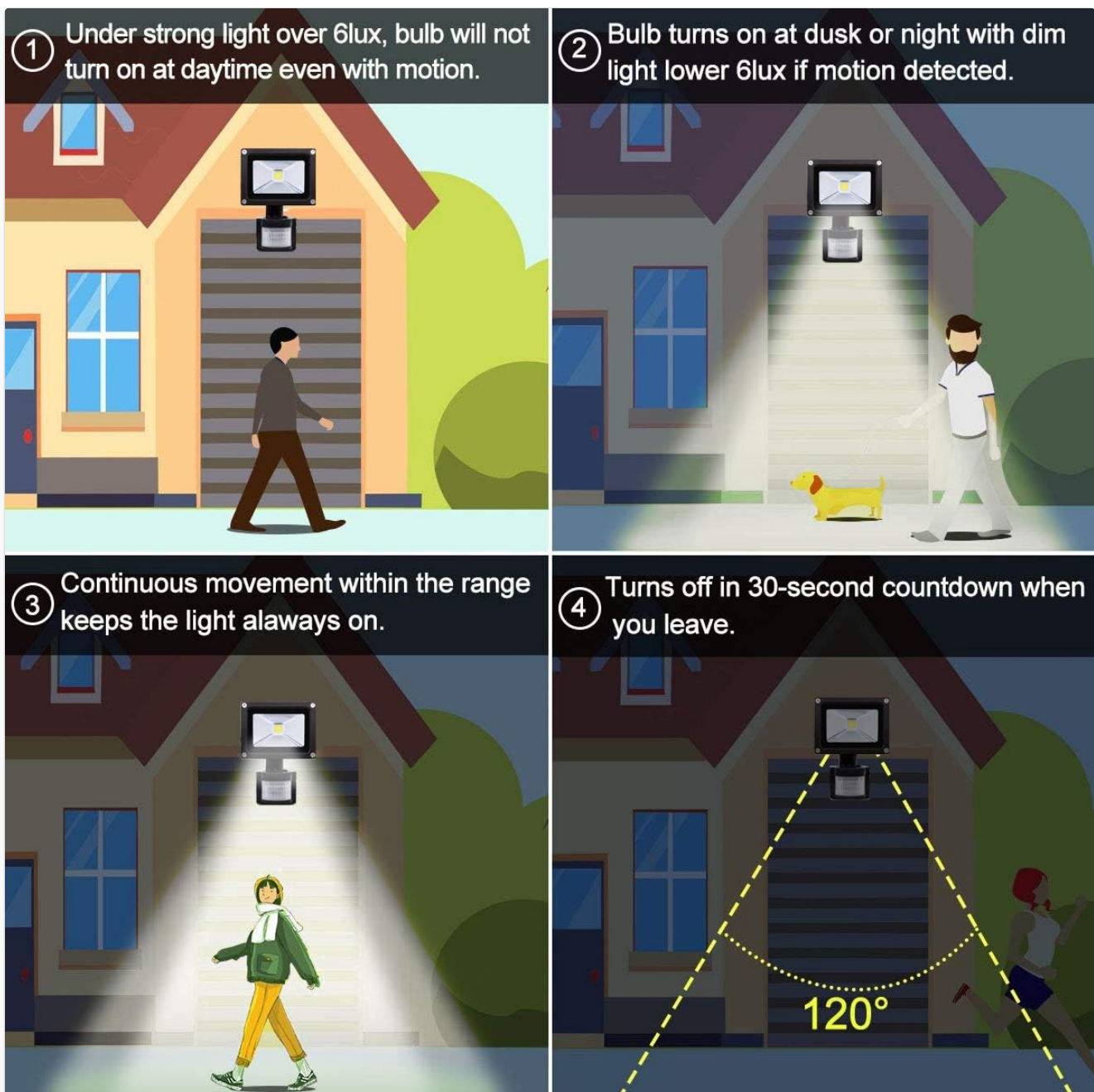

Image 7.2: Visual explanation of motion sensor behavior under different conditions.

### Video: Z 10W Motion Sensor Floodlight Overview

Your browser does not support the video tag.

Video 7.1: This video provides a visual demonstration of the Z 10W Motion Sensor Flood Light, including its features, adjustable settings, and operational modes. It illustrates how to set the SENS, TIME, and LUX dials and shows the light's response to motion in different environments.

## 8. MAINTENANCE

- **Cleaning:** Periodically clean the light fixture and sensor lens with a soft, damp cloth. Do not use abrasive cleaners or solvents.
- **Inspection:** Regularly inspect the power cord for any damage, fraying, or loose connections. Check the mounting bracket for stability.
- **Lens Care:** Ensure the motion sensor lens is clear of obstructions (e.g., dirt, spiderwebs) to maintain optimal detection performance.

## 9. TROUBLESHOOTING

Problem	Possible Cause	Solution
Light does not turn on.	No power; LUX setting too high (daytime); Sensor obstructed; Faulty bulb/fixture.	Check power connection; Adjust LUX setting to 'MOON' for night operation or 'SUN' for 24/7; Clear sensor lens; Contact support if faulty.
Light stays on continuously.	LUX setting on 'SUN'; Continuous motion in detection zone; TIME setting too long.	Adjust LUX setting to 'MOON' if only night operation is desired; Ensure no constant movement; Reduce TIME setting.
Light turns on for no apparent reason.	Sensor too sensitive; Environmental factors (e.g., moving branches, small animals, heat sources).	Reduce SENS setting; Reposition sensor to avoid false triggers; Ensure sensor is not facing direct sunlight or heat vents.
Detection range is too short/long.	SENS setting incorrect; Sensor angle not optimized.	Adjust SENS dial; Adjust the angle of the motion sensor.

## 10. WARRANTY AND SUPPORT

This Z Motion Sensor LED Flood Light comes with a limited warranty. The manufacturer provides 365 days of after-sales service. If you encounter any issues or have questions regarding your product, please contact customer support. We are committed to providing a satisfactory solution within 12 hours.

For support, please refer to the contact information provided with your purchase or visit the official Z brand store online.